

F.A.P. RTE. 0387/0382	SECTION 09-00168-08-TL	COUNTY DU PAGE	TOTAL SHEETS 39	SHEET NO. 9
FED. ROAD DIST. NO. 1		ILLINOIS		CONTRACT NO. 63484

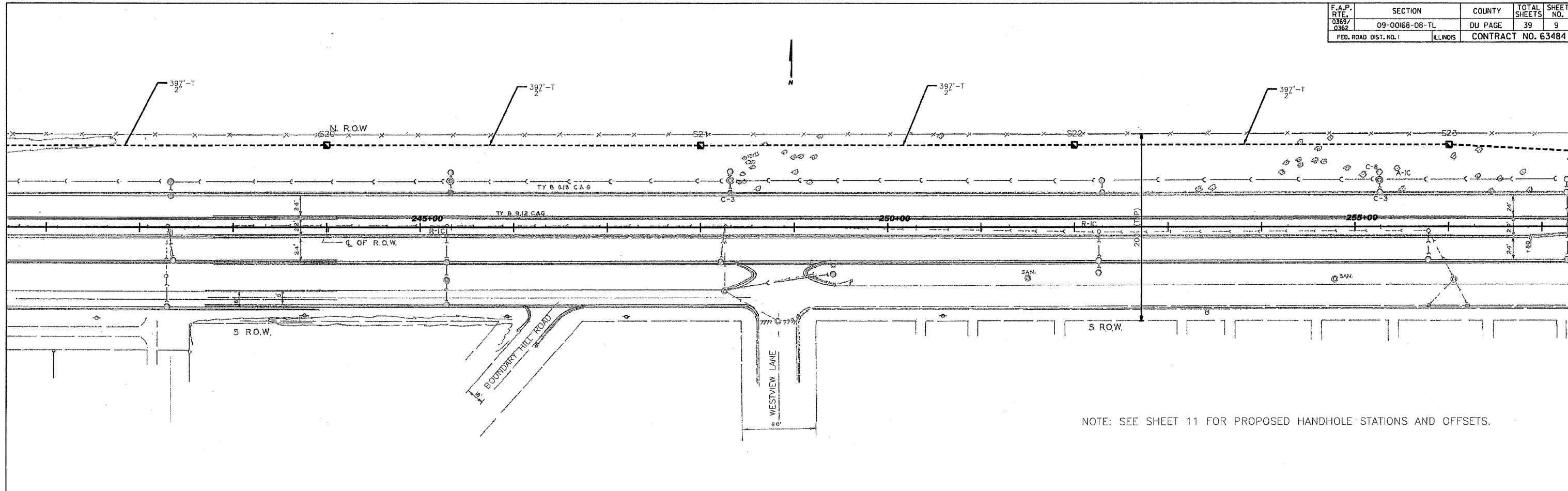

NOTE: SEE SHEET 11 FOR PROPOSED HANDHOLE STATIONS AND OFFSETS.

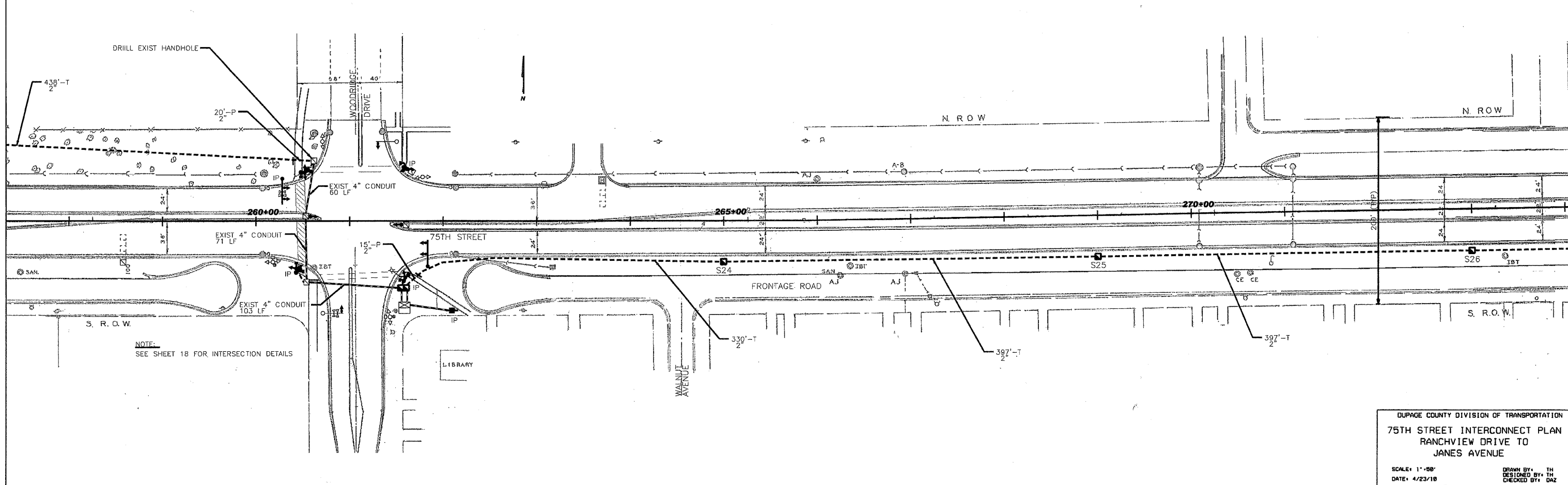

NOTE: SEE SHEET 18 FOR INTERSECTION DETAILS

DUPAGE COUNTY DIVISION OF TRANSPORTATION
 75TH STREET INTERCONNECT PLAN
 RANCHVIEW DRIVE TO
 JANES AVENUE
 SCALE: 1"=50'
 DATE: 4/23/18
 DRAWN BY: TH
 DESIGNED BY: TH
 CHECKED BY: DAZ

PLOT DATE = 04/23/18
 SCALE = 1"=50'
 USER NAME = DAZ