

KANKAKEE BEAVERVILLE, AND SOUTHERN RR

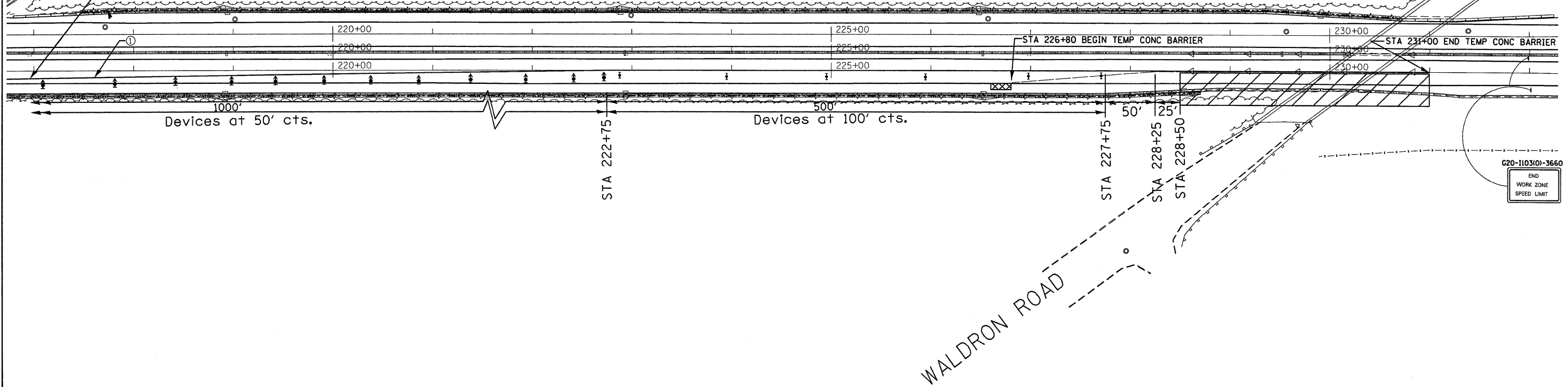

RUN TEMP PVT MK LINE TO EOP AT STA 212+75.  
PLACE ARROWBOARD AT STA 215+75. SEE DETAIL  
FOR STD 70400 (SPECIAL) FOR APPROACH  
START OF LAND CLOSURE TAPER



**SYMBOLS**

- ↑ Arrow board
- ⊥ Sign
- ↑ Direction indicator barricade with steady burn monodirectional light
- ◁ Monodirectional Barrier Wall/Guardrail Marker
- ⊥ Type II barricade, drum, or vertical barricade with steady burn monodirectional light
- ① Wet temporary pavement marking tape - TY III shall be placed throughout the taper and along-side the work area. The edge lines shall be white and the line near the barrier shall be yellow.
- Temporary Concrete Barrier
- ▨ Work area
- XXXX Impact Attenuator, Temporary

SEE STANDARD 701402 FOR DETAILS NOT SHOWN

FILE NAME =	USER NAME = braboypc	DESIGNED -	REVISED -
ct:\pw_work\p\dot\braboypc\d0179153\d366	A23-sht-detail.dgn	DRAWN -	REVISED -
	PLOT SCALE = 50,0000' / IN.	CHECKED -	REVISED -
	PLOT DATE = May 13, 2010 - 12:44:16 PM	DATE -	REVISED -

STATE OF ILLINOIS  
DEPARTMENT OF TRANSPORTATION

**TRAFFIC CONTROL 701402 (SP)**

SCALE: \_\_\_\_\_ SHEET NO. \_\_\_\_ OF \_\_\_\_ SHEETS STA. \_\_\_\_\_ TO STA. \_\_\_\_\_

F.A.I. RTE.	SECTION	COUNTY	TOTAL SHEETS	SHEET NO.
51	146-31.1-2	KANKAKEE	10	5
CONTRACT NO. 66A23				
ILLINOIS FED. AID PROJECT				