

S:\GEN-DRAFT-STD&PLNS-SQUAD14-BRIDGE CONTRACTS-STEEL BEAM REF-68976 SN090-0091-SN090-0091 PinecrestDr.cvr-1-74.dgn

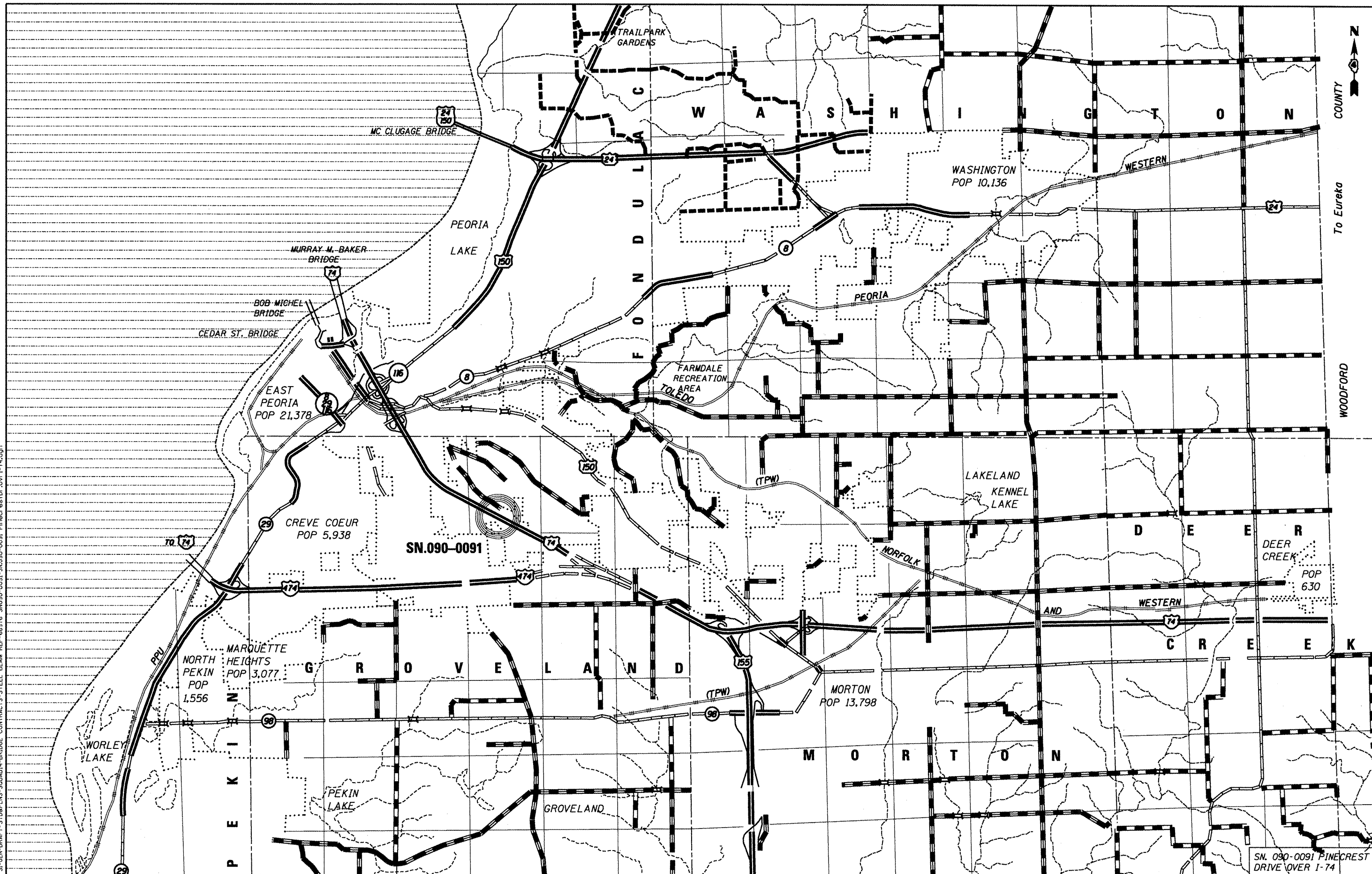

FILE NAME = SN.090-0091 Straighten&Strengthen.dgn

USER NAME = jonesce  
 PLOT SCALE = 1/83.7051" / IN.  
 PLOT DATE = 5/24/2010

DESIGNED - CEJ	REVISED -
DRAWN - CEJ	REVISED -
CHECKED -	REVISED -
DATE - 04/06/2010	REVISED -

**STATE OF ILLINOIS  
 DEPARTMENT OF TRANSPORTATION**

**GENERAL LAYOUT**

SCALE: \_\_\_\_\_ SHEET NO. \_\_\_\_ OF \_\_\_\_ SHEETS STA. \_\_\_\_\_ TO STA. \_\_\_\_\_

F.A.I. RTE.	SECTION	COUNTY	TOTAL SHEETS	SHEET NO.
74	[90-14HB-1(BR)]I	TAZEWELL	17	6
STEEL BEAMS REP./REPL.		CONTRACT NO. 68976		
FED. ROAD DIST. NO. 4 [ILLINOIS] FED. AID PROJECT				

SN. 090-0091 PINECREST DRIVE OVER I-74