

STATE OF ILLINOIS
DEPARTMENT OF TRANSPORTATION

Bench Mark 551: Chiseled square on top of slope wall on east side of Little Wabash River Station 2005+86.10, 25.7' off of centerline I-70 West. Elev. 521.58

Existing Structures: S.N. 025-0009 (E.B.) and 025-0010 (W.B.) were built as F.A.I. Route 70, Section 25-3B in 1959. They are seven span dual structures 422'-3" back to back abutments, consisting of 3 units: 2 two span continuous units (45'-0", 45'-7 1/2") at each end and a three span continuous unit (72'-7 1/2", 92'-2", 72'-7 1/2") in the center. The out to out of deck is 35'-8" and is supported on six steel wide flange beams. The substructure consists of pile bent abutments and hammerhead piers. All substructure units are supported by concrete piles. Existing structures are to be removed and replaced with new structures. One lane of traffic to be maintained on each structure by utilizing Stage Construction.

No Salvage.

For Sections A-A & B-B see sheet 2 of 58.

- * Location 1, Underwater Structure Excavation Protection
- ** Location 2, Underwater Structure Excavation Protection
- *** Location 3, Underwater Structure Excavation Protection
- **** Location 4, Underwater Structure Excavation Protection

INDEX OF SHEETS

1. General Plan & Elevation
2. General Data
3. Stage Construction & Temporary Soil Retention System
4. Cofferdam Details
5. Footing Layout
6. Temporary Concrete Barrier for Stage Construction
- 7.-18. Top of Slab Elevations
- 19.-20. Approach Pavement Top of Slab Elevations (W.B.)
- 21.-22. Approach Pavement Top of Slab Elevations (E.B.)
23. Superstructure (W.B.)
24. Superstructure (E.B.)
25. Superstructure Detail
26. Preformed Joint Strip Seal
27. Blank Sheet
28. Bridge Approach Slab (W.B.)
29. Bridge Approach Slab (E.B.)
30. Bridge Approach Slab Details
31. Abutment Diaphragm Details
32. Pier Diaphragm Details (W.B.)
33. Pier Diaphragm Details (E.B.)
34. Framing Plan
35. 72" PCC Bulb T-Beam Spans 1 & 5
36. 72" PCC Bulb T-Beam Spans 2 & 4
37. 72" PCC Bulb T-Beam Span 3
38. 72" PCC Bulb T-Beam Details
39. Bearing Details
- 40.-43. Abutment Details
44. Pier 1 & 4 (W.B.)
45. Pier 1 & 4 (E.B.)
46. Pier 2 & 3 (W.B.)
47. Pier 2 & 3 (E.B.)
48. Pier 2 & 3 Footing Plan
49. Bar Splicer Assembly Details
50. HP Pile Details
- 51-58. Boring Logs

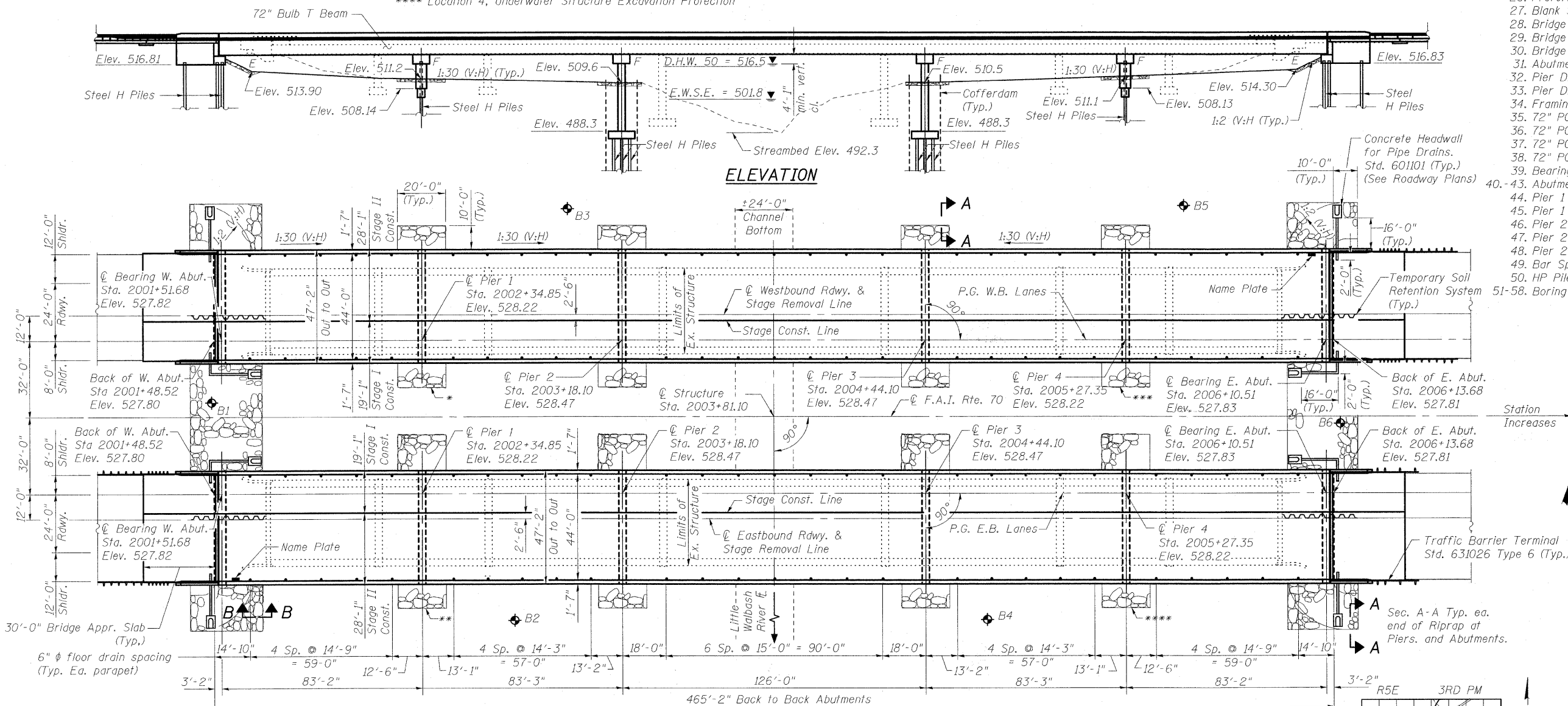

STATION 2003+81.10
BUILT 20__ BY
STATE OF ILLINOIS
F.A.I. RT. 70 SEC. (25-3)B
LOADING HL-93
STRUCTURE NO. 025-0107

STATION 2003+81.10
BUILT 20__ BY
STATE OF ILLINOIS
F.A.I. RT. 70 SEC. (25-3)B
LOADING HL-93
STRUCTURE NO. 025-0108

NAME PLATE
See Std. 515001

DESIGN SCOUR ELEVATION TABLE

Design Scour Elevation (ft.)	W. Abut.	Pier 1	Pier 2	Pier 3	Pier 4	E. Abut.
	516.60	504.3	488.3	488.3	505.3	516.62

WATERWAY INFORMATION

Exist. Low Grade Elev. 526.2 ft. @ Sta. 2003+81.10
Drainage Area = 243.8 sq. mi. Pr. Low Grade Elev. 527.22 ft. @ Sta. 2008+31.10

Flood	Freq. Yr.	Q	Opening Sq. Ft.		Nat. H.W.E.		Head - Ft.		Headwater El.	
			Exist.	Prop.	Exist.	Prop.	Exist.	Prop.	Exist.	Prop.
Design	10	12218	3182	3414	515.1	0.7	0.7	515.8	515.8	
Base	50	18252	3956	4279	516.5	1.3	1.3	517.8	517.8	
Max. Calc.	100	21009	4217	4630	517.0	1.6	1.5	518.6	518.5	
	500	27899	4895	5259	518.1	2.2	2.0	520.3	520.1	

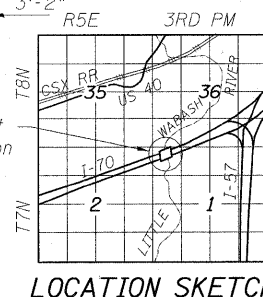

GENERAL PLAN
I-70 OVER LITTLE WABASH RIVER
F.A.I. ROUTE 70 - SECTION (25-3)B
STATION 2003+81.10
STRUCTURE NO. 025-0107 (E.B.)
STRUCTURE NO. 025-0108 (W.B.)

DESIGNED B.B.
CHECKED A.C.S.
DRAWN W.J.S.
CHECKED C.J.F. & B.B.

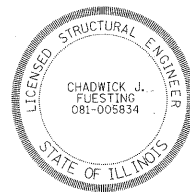

APPROVED
FOR STRUCTURAL ADEQUACY ONLY
Roland E. Anderson (TOP)
ENGINEER OF BRIDGES AND STRUCTURES



Illinois Design Firm Number 184.001670
BERNARDIN
LOCHMUELLER &
ASSOCIATES, INC.
3 Oak Drive
Maryville, IL 62062-5655
Local (618) 288-4995
Fax (618) 288-4995

SHEET NO. 1 58 SHEETS	F.A.I. RTE.	SECTION	COUNTY	TOTAL SHEETS	SHEET NO.
	70	(25-3)B	EFFINGHAM	1416	33
SN 025-0107 & 025-0108			CONTRACT NO. 74296		
FED. ROAD DIST. NO. 7 [ILLINOIS] FED. AID PROJECT 70					