

EXIST. CURVE I57SRC-1  
 PI STA. = 5032+76.40  
 $\Delta = 42^\circ 31' 30''$  (RT)  
 $D = 3^\circ 10' 09''$   
 $R = 1,807.88'$   
 $T = 703.50'$   
 $L = 1,341.81'$   
 $E = 132.05'$   
 $e = 6.00\%$   
 $T.R. = 56.70'$   
 $S.E. RUN = 170.00'$   
 $P.C. STA. = 5025+72.90$   
 $P.T. STA. = 5039+14.71$

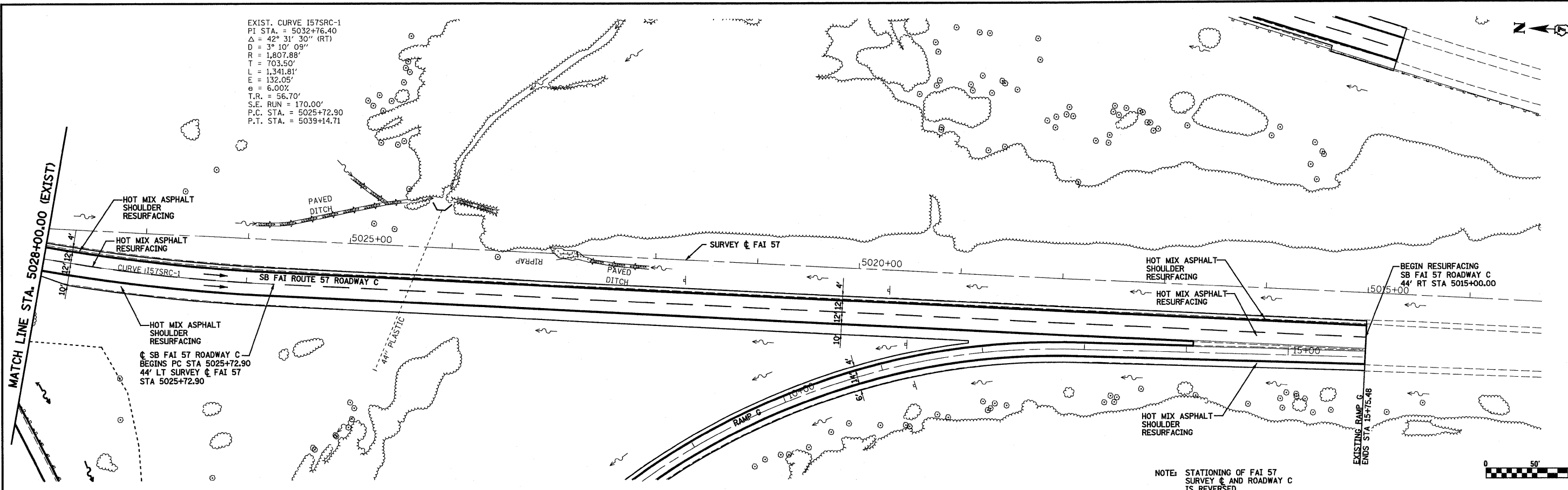

DATE	
BY	
REVISIONS	
PLANNED	
ALIGNED	
CHECKED	
NOTE BOOK	
NO.	
FILE NAME	

DATE	
BY	
REVISIONS	
PLANNED	
ALIGNED	
CHECKED	
NOTE BOOK	
NO.	
FILE NAME	

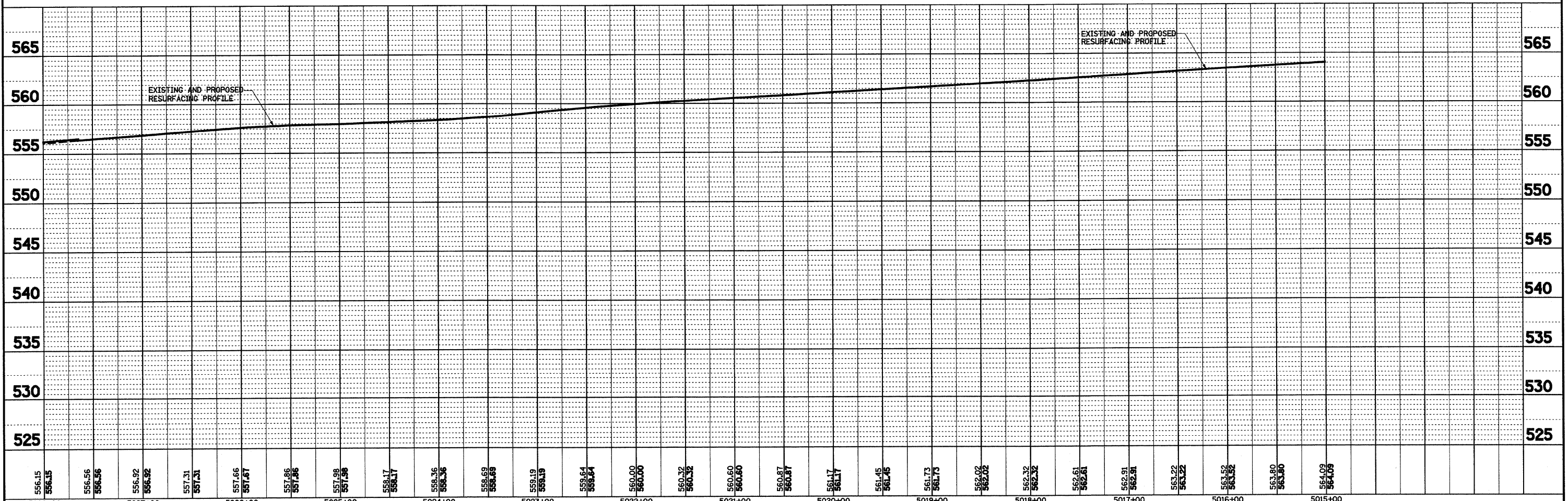

5028+00	5027+00	5026+00	5025+00	5024+00	5023+00	5022+00	5021+00	5020+00	5019+00	5018+00	5017+00	5016+00	5015+00							
556.15 556.15	556.56 556.56	556.92 556.92	557.31 557.31	557.66 557.67	558.06 558.06	558.46 558.46	558.86 558.86	559.26 559.26	559.66 559.66	560.06 560.06	560.46 560.46	560.86 560.86	561.26 561.26	561.66 561.66	562.06 562.06	562.46 562.46	562.86 562.86	563.26 563.26	563.66 563.66	564.06 564.06

FILE NAME =  
 USER NAME = paul

DESIGNED - JWS  
 DRAWN - PDB  
 CHECKED - BRM  
 DATE - 2-25-08

REVISED -  
 REVISED -  
 REVISED -  
 REVISED -

STATE OF ILLINOIS  
 DEPARTMENT OF TRANSPORTATION

PLAN AND PROFILE, SOUTH TRI LEVEL ROADWAY C  
 SCALE: 1"=50'  
 SHEET NO. 17 OF 27 SHEETS  
 STA. 5028+00.00 TO STA. 5015+00.00

F.A.I. RTE.	SECTION	COUNTY	TOTAL SHEETS	SHEET NO.
57/70	(25-3)R	EFFINGHAM	1416	188
FED. ROAD DIST. NO.		ILLINOIS FED. AID PROJECT		
		CONTRACT NO. 74296		