

REVISIONS	DATE
BY	
PLAN	
NOTE BOOK	
NO.	
REVISIONS	DATE
BY	
PROFILE	
NOTE BOOK	
NO.	

REVISIONS	DATE
BY	
PROFILE	
NOTE BOOK	
NO.	
REVISIONS	DATE
BY	
PROFILE	
NOTE BOOK	
NO.	

EXIST. RAMP F
 EXIST. CURVE I70STR1.F2
 PI STA. = 12+67.74
 $\Delta = 115^\circ 16' 56''$ (RT)
 $D = 8^\circ 12' 35''$
 $R = 697.9'$
 $T = 1,101.47'$
 $L = 1,404.23'$
 $E = 606.05'$
 $e = 7.90\%$
 $T.R. = N/A$
 $S.E. RUN = N/A$
 $P.C.C. STA. = 1+66.27$
 $P.T. STA. = 15+70.50$

PROP. RAMP F CURVE C202
 PI STA. = 11+97.53
 $\Delta = 33^\circ 55' 47''$ (LT)
 $D = 8^\circ 50' 56''$
 $R = 647.50'$
 $T = 197.53'$
 $L = 383.44'$
 $E = 29.46'$
 $e = 8.00\%$
 $T.R. = N/A$
 $S.E. RUN = N/A$
 $P.C. STA. = 10+00.00$
 $P.C.C. STA. = 13+83.44$
 $SE ATTAINED STA. 10+00.00$
 $TO STA 10+65.64 (7.62\% TO 8.00\%)$

34 STA 10+26.38, 5.34' LT
 PROPOSED TYPE C INLET BOX,
 STANDARD 609001 (SPECIAL)
 GR. 569.31
 FL 567.33

PC STA 10+00.00 RAMP F
 7.99' RT STA 5+33.22
 EXISTING \bar{C} RAMP F

STA 10+76.38
 PROPOSED PIPE DRAIN, 15" WITH
 CONCRETE THRUST BLOCKS AND CONCRETE
 ANCHORS AND METAL END SECTIONS, 15",
 FOR DETAILS SEE RAMP F CROSS SECTIONS
 GR. 567.33
 FL 525.06

STA. 10+50.00 (PROP.)
 MATCH LINE

STA 11+18.32
 EXTEND EXISTING 10' X 6'
 CONCRETE BOX ON BOTH SIDES
 WITH PROPOSED CONCRETE BOX
 CULVERTS, 10' X 6'
 FOR DETAILS SEE BOX CULVERT
 DETAIL SHEETS
 USFL 517.73
 DSFL 515.64

PROPOSED
 STONE RIPRAP,
 CLASS A4

RT STA 36+20.00
 SB FAI 57
 ROADWAY C=
 STA 5030+71.74
 EXISTING ROADWAY C

PROPOSED
 STONE RIPRAP,
 CLASS A3

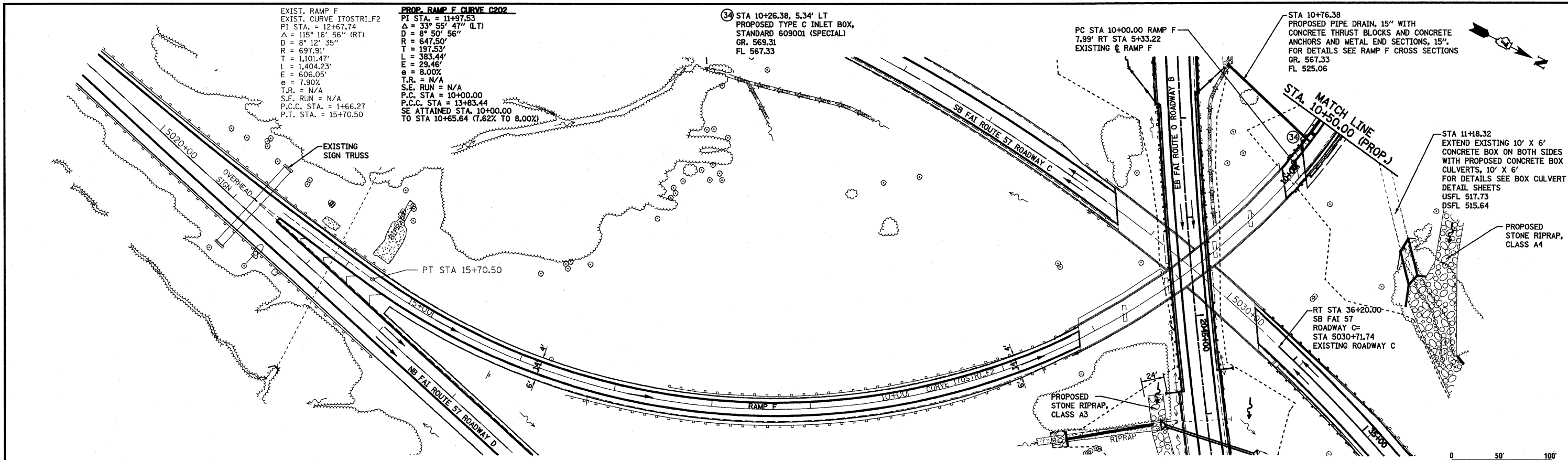

NOTE: STATIONING EXISTING
 \bar{C} RAMP F IS REVERSED

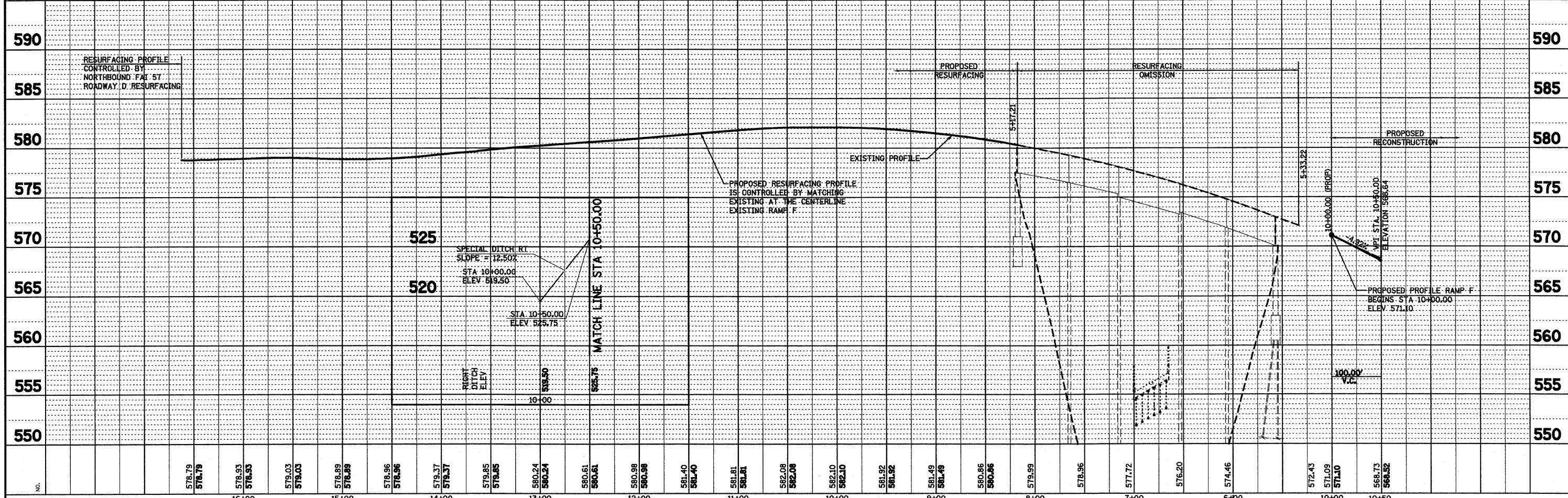
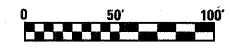

FILE NAME =	USER NAME = paul	DESIGNED - JWS	REVISED -
DRAWN - PDB	CHECKED - BRM	DATE - 0-25-08	REVISED -
STATE OF ILLINOIS DEPARTMENT OF TRANSPORTATION			
SCALE: 1"=50'		SHEET NO. 22 OF 27 SHEETS	
STATIONING: STA. 15+70.50 (E) TO STA. 10+50.00 (P)		CONTRACT NO. 74296	
F.A.I. RTE. 57/70	SECTION (25-3)R	COUNTY EFFINGHAM	TOTAL SHEETS 1416 SHEET NO. 281
ILLINOIS FED. AID PROJECT			