

ROADWAY C						
POINT	ELEVATION	NORTHING	EASTING	ROADWAY STATION	☐ ROADWAY OFFSET	RAMP STATION
ROADWAY B						
223	568.61	885,434.91	915,270.81	2063+75.00	28.00	5045+50.59
224	568.87	885,455.82	915,284.79	2064+00.00	28.05	5045+75.74
225	569.14	885,476.81	915,298.66	2064+25.00	28.08	5046+00.89
226	569.41	885,497.88	915,312.40	2064+50.00	28.11	5046+26.05
227	569.68	885,519.03	915,326.01	2064+75.00	28.12	5046+51.20
228	569.94	885,540.26	915,339.50	2065+00.00	28.12	5046+76.36
229	570.21	885,561.57	915,352.86	2065+25.00	28.11	5047+01.51
230	570.47	885,582.96	915,336.10	2065+50.00	28.09	5047+26.66
231	570.74	885,604.42	915,379.21	2065+75.00	28.06	5047+51.82
232	571.00	885,625.96	915,392.20	2066+00.00	28.02	5047+76.97
233	571.27	885,647.58	915,405.05	2066+25.00	27.97	5048+02.12
234	571.53	885,669.28	915,417.78	2066+50.00	27.90	5048+27.27
235	571.79	885,691.05	915,430.38	2066+75.00	27.83	5048+52.43
236	572.05	885,712.89	915,442.85	2067+00.00	27.74	5048+77.58
237	572.32	885,734.80	915,455.20	2067+25.00	27.64	5049+02.73
238	572.58	885,756.79	915,467.41	2067+50.00	27.54	5049+27.88
239	572.84	885,778.85	915,479.49	2067+75.00	27.42	5049+53.03
240	573.10	885,800.98	915,491.44	2068+00.00	27.29	5049+78.18
241	573.36	885,823.17	915,503.26	2068+25.00	27.14	5050+03.33
242	573.61	885,845.44	915,514.95	2068+50.00	26.99	5050+28.48

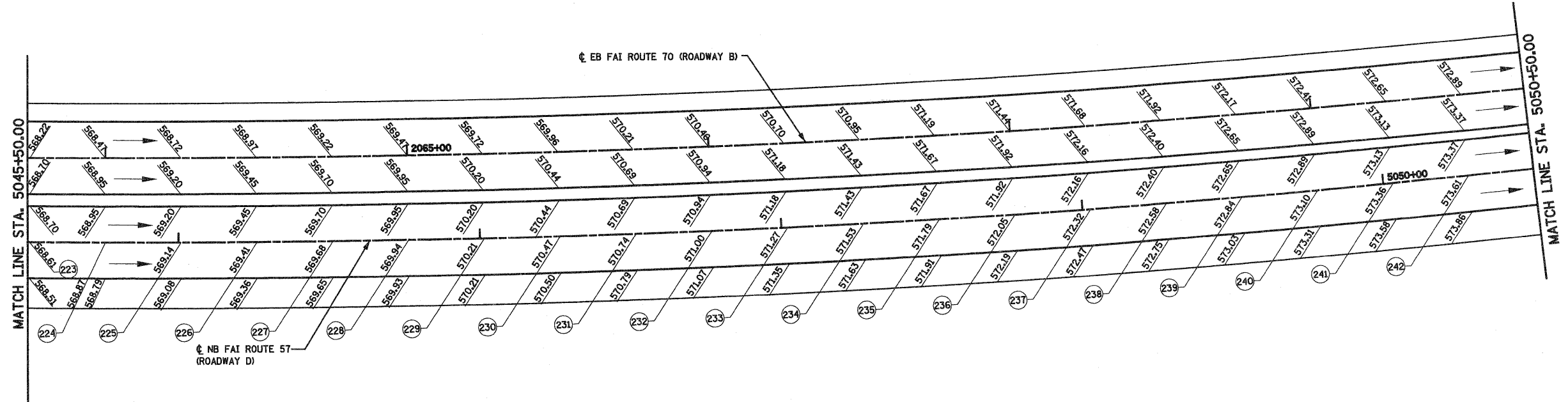

FILE NAME =	USER NAME = paul	DESIGNED - ESW	REVISED -	STATE OF ILLINOIS DEPARTMENT OF TRANSPORTATION	PAVEMENT ELEVATION DETAIL, ROADWAY D, SOUTH TRI LEVEL			F.A.I. RTE.	SECTION	COUNTY	TOTAL SHEETS	SHEET NO.
5:\projects\MS-88872-57-70\paul\57-70.dwg		DRAWN - PDB	REVISED -					57/70	(25-3)R	EFFINGHAM	1416	324
PLOT SCALE = 48.0000' / IN.		CHECKED - BRM	REVISED -		SCALE: 1"=20'			SHEET NO. 6 OF 12 SHEETS			STA. 5045+50.00 TO STA. 5050+50.00	
PLOT DATE = 2/11/2010		DATE - 2-29-08	REVISED -		FED. ROAD DIST. NO.			ILLINOIS FED. AID PROJECT				