

BEGIN RESURFACING
NB FAI 57 ROADWAY D
STA 5015+00.00

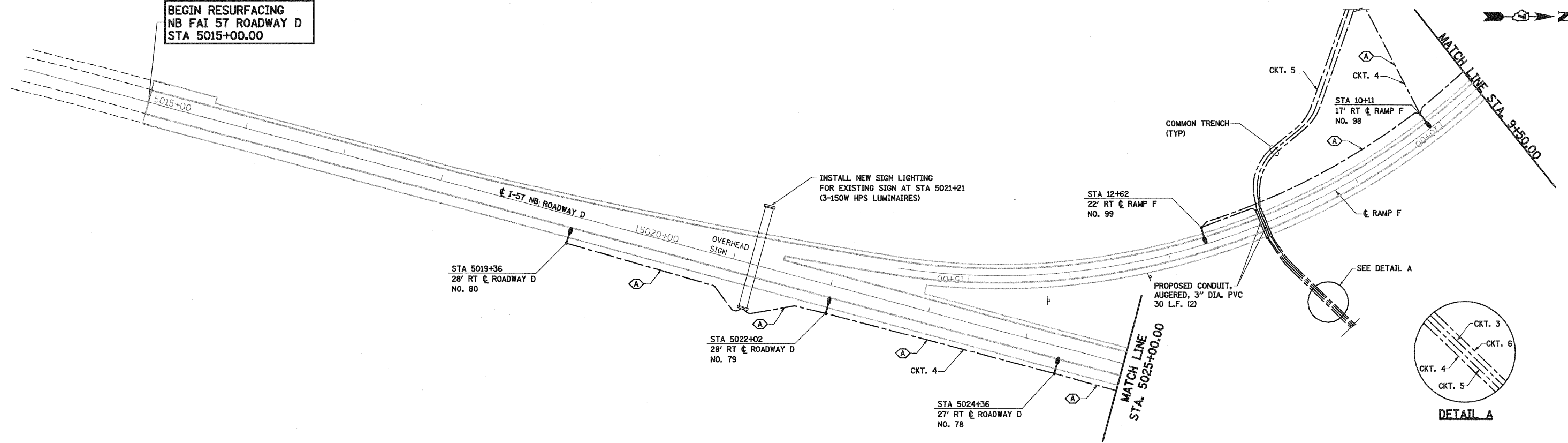

LEGEND

- PROPOSED LIGHTING UNIT, 50 FT ALUMINUM POLE, 15 FT DAVIT ARM, 400W HPS LUMINAIRE, M-C-III
- PROPOSED LIGHTING CONTROLLER
- SERVICE INSTALLATION
- JUNCTION BOX, STAINLESS STEEL, ATTACHED TO STRUCTURE, SIZE AS NOTED
- PROPOSED UNIT DUCT
- PROPOSED CONDUIT ATTACHED TO STRUCTURE
- PROPOSED CONDUIT, AUGERED, PVC, SIZE AS NOTED

CABLE / CONDUIT SCHEDULE

- A** UNIT DUCT, 600V, 2-1C NO. 8, 1/C NO. 8 GROUND, (XLP-TYPE USE), 3/4" DIA. POLYETHYLENE
- B** UNIT DUCT, 600V, 2-1C NO. 6, 1/C NO. 8 GROUND, (XLP-TYPE USE), 1" DIA. POLYETHYLENE
- C** UNIT DUCT, 600V, 2-1C NO. 4, 1/C NO. 6 GROUND, (XLP-TYPE USE), 1" DIA. POLYETHYLENE
- D** ELECTRIC CABLE IN CONDUIT, 600V, (XLP-TYPE USE), 2-1C NO. 10, 1/C NO. 10 GROUND IN 1" GALVANIZED STEEL CONDUIT ATTACHED TO STRUCTURE
- E** ELECTRIC CABLE IN CONDUIT, 600V, (XLP-TYPE USE), 2-1C NO. 8, 1/C NO. 8 GROUND IN 2" GALVANIZED STEEL CONDUIT ATTACHED TO STRUCTURE
- F** ELECTRIC CABLE IN CONDUIT, 600V, (XLP-TYPE USE), 2-1C NO. 6, 1/C NO. 8 GROUND IN 2" GALVANIZED STEEL CONDUIT ATTACHED TO STRUCTURE

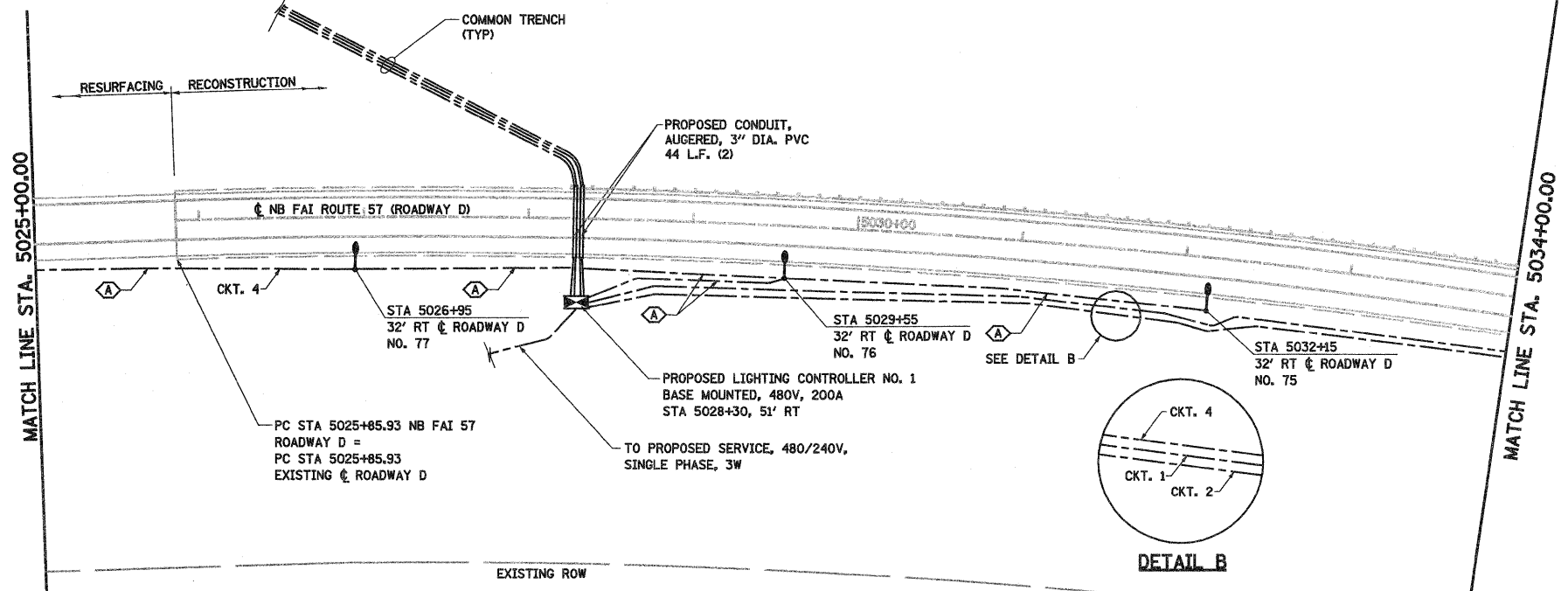

FILE NAME =	USER NAME = paul	DESIGNED - JWS	REVISED - 4-26-10	STATE OF ILLINOIS DEPARTMENT OF TRANSPORTATION	PROPOSED LIGHTING SOUTH TRI LEVEL			F.A.I. RTE.	SECTION	COUNTY	TOTAL SHEETS	SHEET NO.
3:\Projects\NB FAI 57\Drawings\Lighting\prop.ctb	PLOT SCALE = 1/8" = 1' IN.	DRAWN - PDB	REVISED -		SCALE: 1"=50'	SHEET NO. 21 OF 34 SHEETS	STA. 5015+00.00 TO STA. 5034+00.00	(25-3)R	EFFINGHAM	1416	410	
PLOT DATE = 4/27/2010	DATE - 3-4-08	CHECKED - BRM	REVISED -					FED. ROAD DIST. NO.	ILLINOIS	FED. AID PROJECT	CONTRACT NO. 74296	
		DATE - 3-4-08	REVISED -									