

DATE	
BY	
SURVEYED	
PLOTTED	
NOTE BOOK	
AREAS CHECKED	

DATE	
BY	
ORIGINAL SURVEY	
PLOTTED	
NOTE BOOK	
AREAS CHECKED	

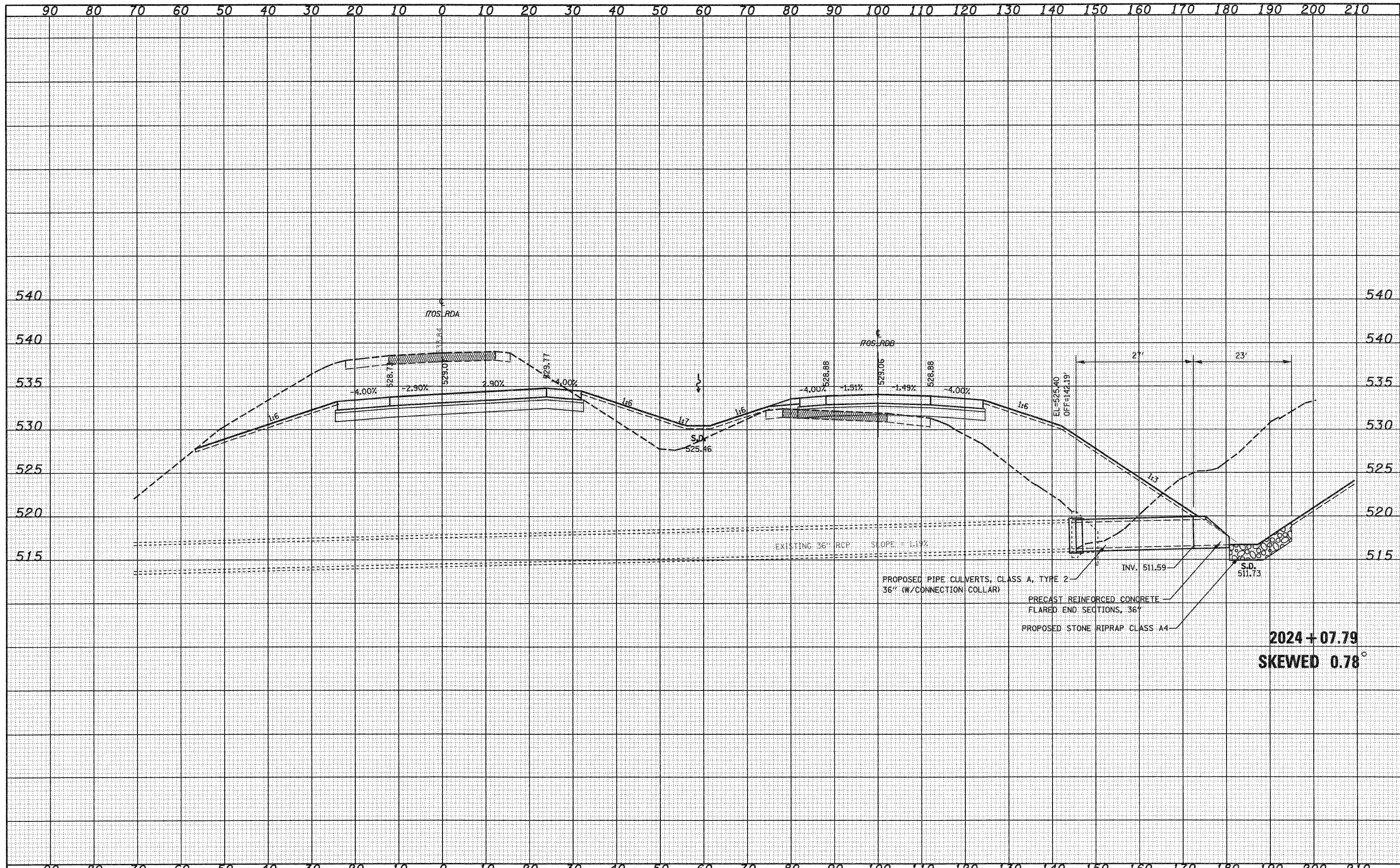

FILE NAME =	USER NAME = psul	DESIGNED - JWS	REVISED -	<b>STATE OF ILLINOIS</b> <b>DEPARTMENT OF TRANSPORTATION</b>	<b>CULVERT PROFILES, SOUTH TRI LEVEL ROADWAY A</b>		F.A.I. RTE.	SECTION	COUNTY	TOTAL SHEETS	SHEET NO.	
Project: MD 072.57 (Rd) 15 Trk Vash. Lake to 350 Adp	PLOT SCALE = 20,0000' / IN.	DRAWN - LEC	REVISED -		SCALE: 1"=10'	SHEET NO. 1 OF 17 SHEETS	STA. 2015+00.00 TO STA. 2024+07.79	57/70	(25-3)R	EFFINGHAM	1416	476
PLOT DATE = 2/11/2010	DATE - 2-25-08	CHECKED - BRM	REVISED -		PROPOSED PIPE CULVERTS, CLASS A, TYPE 2- 36" (W/CONNECTION COLLAR) PRECAST REINFORCED CONCRETE FLARED END SECTIONS, 36" PROPOSED STONE RIPRAP CLASS A4			INV. 511.59 S.D. 511.73		CONTRACT NO. 74296		
		DATE - 2-25-08	REVISED -		2024 + 07.79 SKEWED 0.78°		FED. ROAD DIST. NO. ILLINOIS FED. AID PROJECT					