

STATE OF ILLINOIS
DEPARTMENT OF TRANSPORTATION

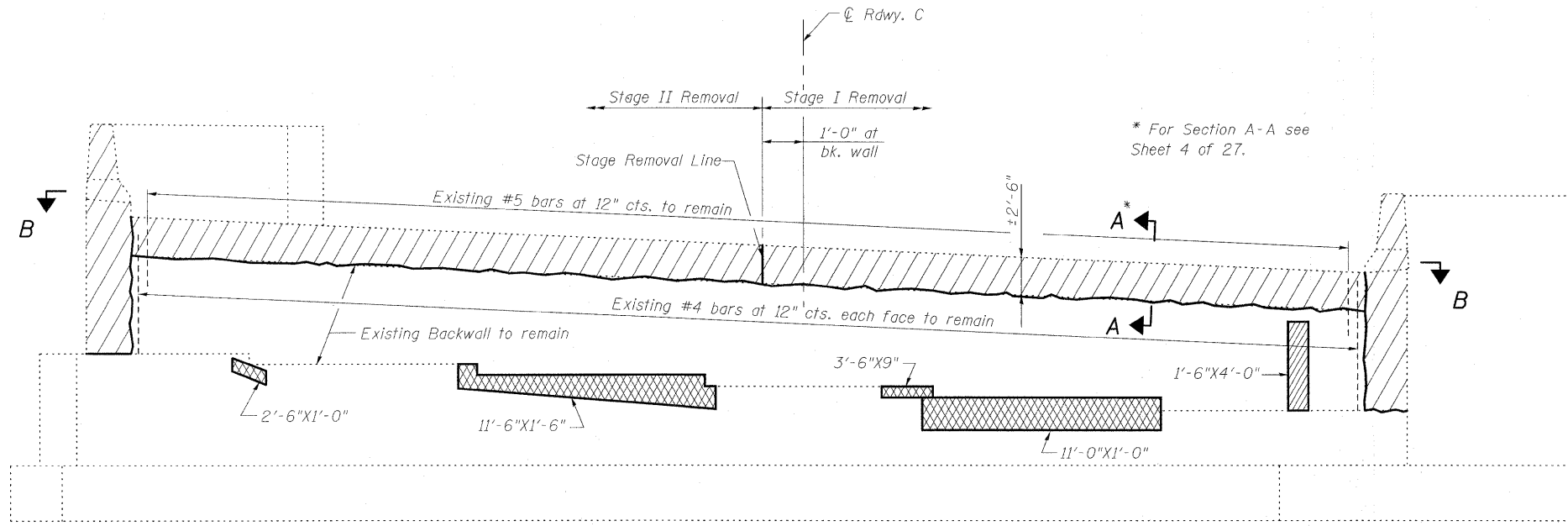

ELEVATION
(Looking North)

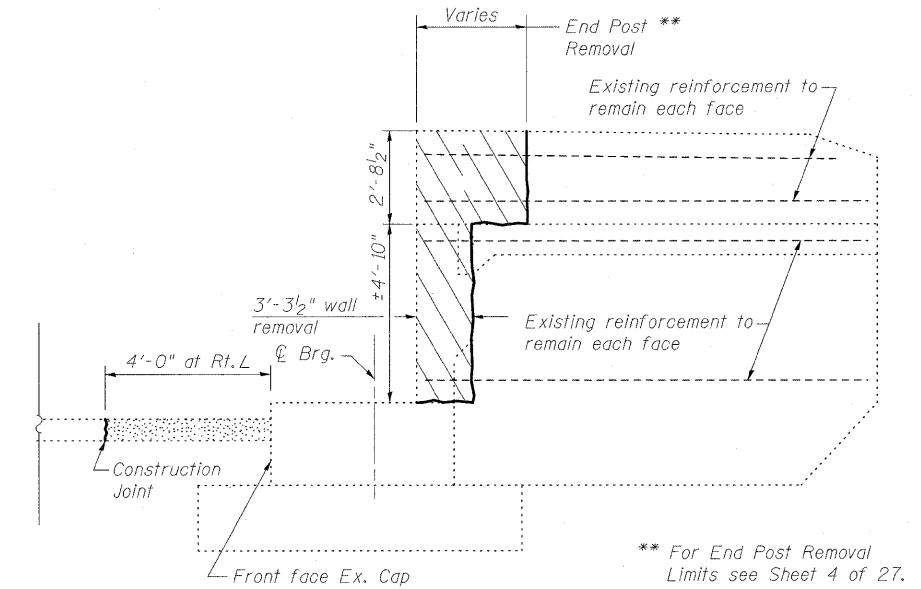

EAST WING WALL

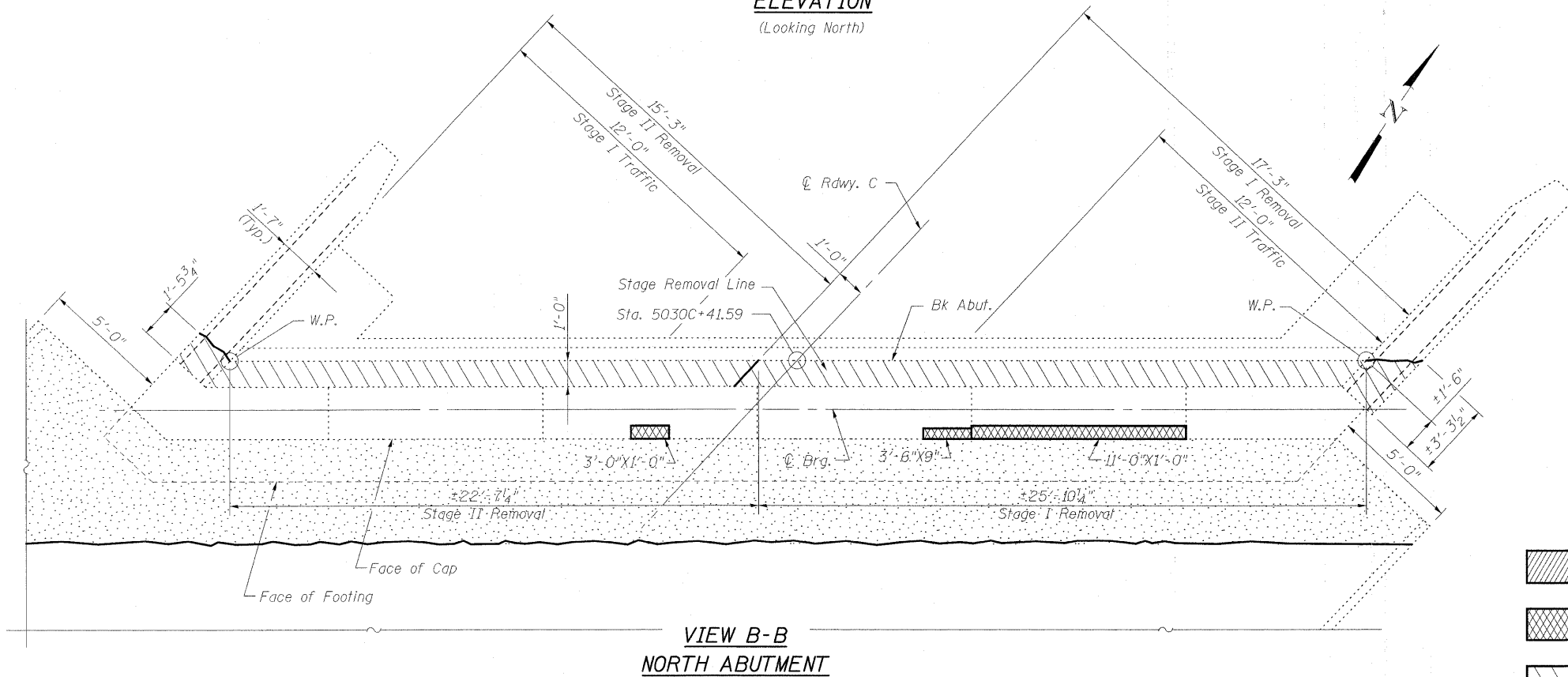

VIEW B-B
NORTH ABUTMENT

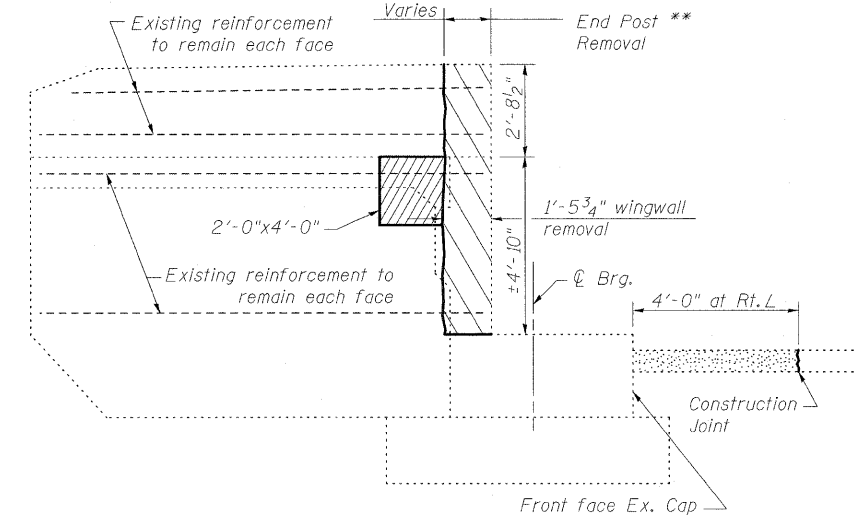

WEST WING WALL

LEGEND

- Indicates Structural Repair of Concrete
- Indicates Unsound Concrete Removal
- Indicates Concrete Removal
- Indicates Slope-wall Removal

BILL OF MATERIAL

Item	Unit	Total
Concrete Removal	Cu. Yd.	5.8
Structural Repair of Concrete (Depth equal to or less than 5")	Sq. Ft.	14
Unsound Concrete Removal	Sq. Yd.	5.5

CONCRETE REMOVAL & REPAIR
NORTH ABUTMENT
STRUCTURE NO. 025-0001

DESIGNED	B.B.
CHECKED	C.J.F.
DRAWN	W.J.S.
CHECKED	C.J.F. & B.B.



**BERNARDIN
LOCHMUELLER &
ASSOCIATES, INC.**

3 Oak Drive
Maryville, IL 62052-9535
Local (618) 288-4665
Fax 618-288-4666

SHEET NO. 18 27 SHEETS	F.A.I. RTE.	SECTION	COUNTY	TOTAL SHEETS	SHEET NO.
	57	(25-3HB)I-2	EFFINGHAM	1416	1372
SN 025-0001			CONTRACT NO. 74296		
FED. ROAD DIST. NO. 7 ILLINOIS FED. AID PROJECT					