

STATE OF ILLINOIS
DEPARTMENT OF TRANSPORTATION

Notes:
See sheet 9 of 36 for Sections A-A & B-B and View C-C.
a₁₀(E) thru a₁₃(E) bar spacings measured along \varnothing Rdwy.
Bars indicated thus 15x2-#4 indicates 15 lines of #4 bars with 2 lengths per line.

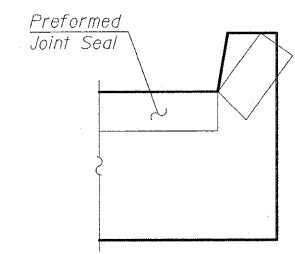

VIEW D-D
Angle Preformed Joint Seal at 45°
at curbs when req'd for drainage.

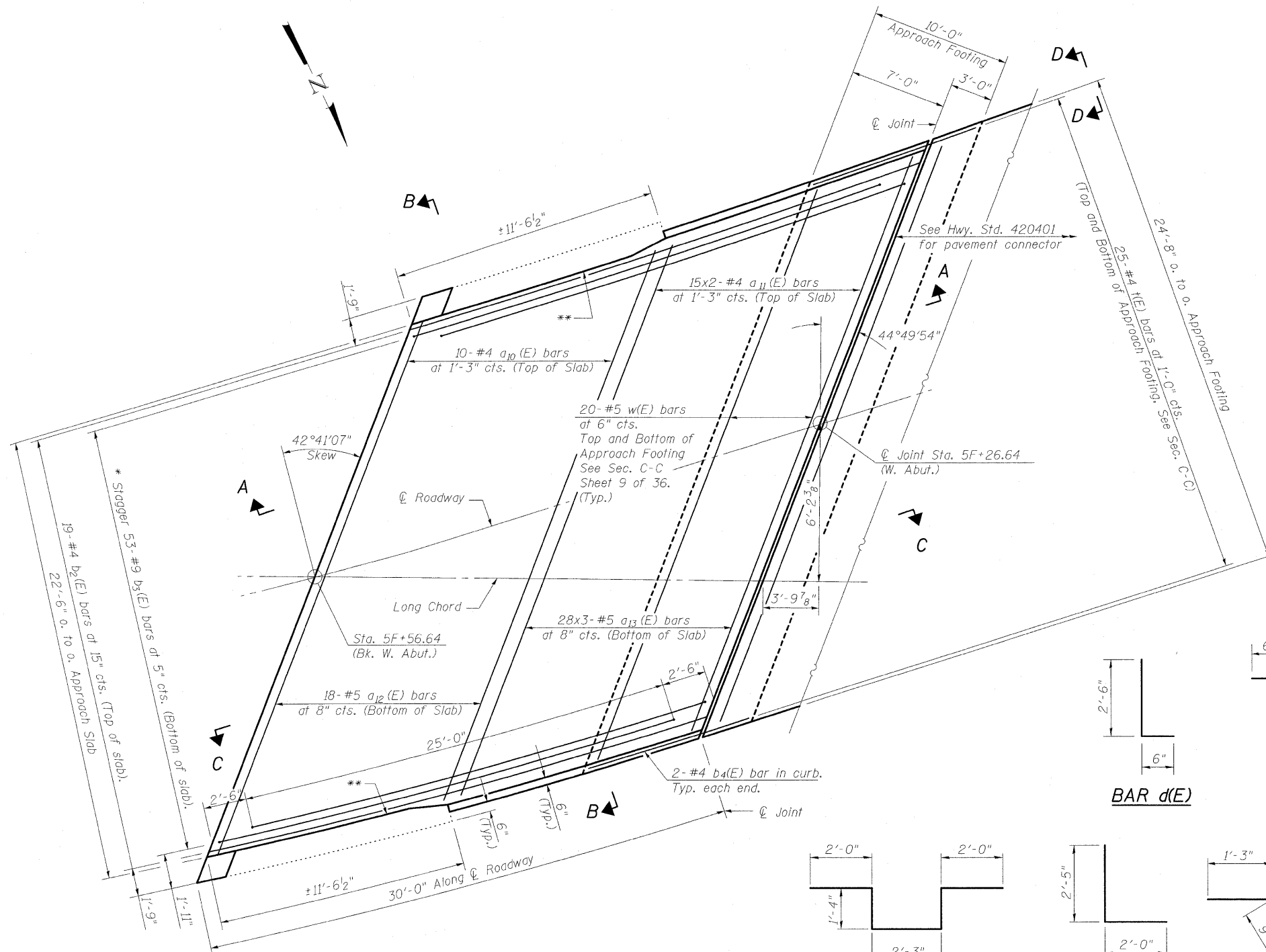
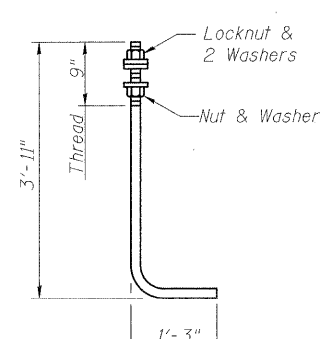

ANCHOR ROD
Diameter as specified for light poles.
(ASTM F 1554 Grade 105)

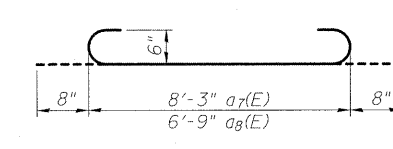

a7(E) & a8(E) BARS

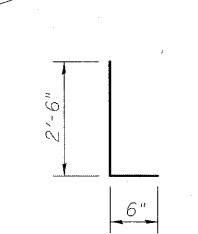

BAR d(E)

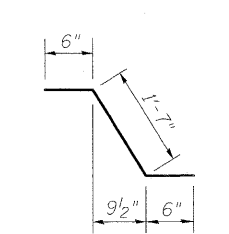

BAR d1(E)

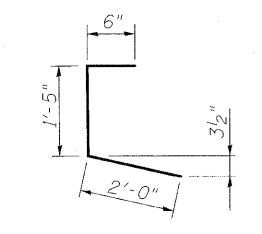

BAR d2(E)

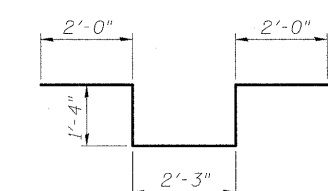

BAR d4(E)

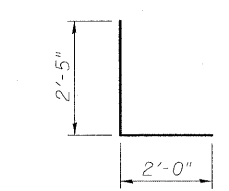

BAR d5(E)

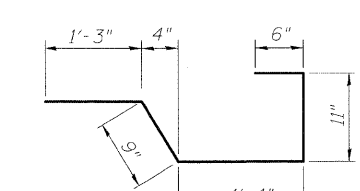

BAR x(E)

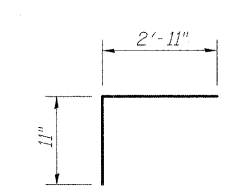

BAR x1(E)

MINIMUM BAR LAP

#4 bar = 2'-0"
#5 bar = 2'-6"

**BILL OF MATERIAL
SUPERSTRUCTURE**

Bar	No.	Size	Length	Shape
a(E)	16	#6	8'-0"	
a1(E)	9	#5	24'-2"	
a2(E)	16	#5	24'-10"	
a3(E)	16	#5	25'-10"	
a4(E)	16	#5	27'-3"	
a5(E)	16	#5	28'-8"	
a6(E)	9	#5	30'-3"	
a7(E)	9	#6	8'-1"	
a8(E)	9	#6	9'-7"	
a9(E)	32	#6	6'-2"	
a14(E)	6	#6	7'-3"	
b(E)	54	#5	2'-6"	
b1(E)	60	#5	2'-10"	
b5(E)	19	#5	7'-6"	
d(E)	184	#5	3'-0"	
d1(E)	85	#5	2'-7"	
d2(E)	85	#5	3'-11"	
d4(E)	5	#6	8'-11"	
d5(E)	3	#6	4'-5"	
e(E)	24	#4	2'-0"	
e1(E)	60	#4	2'-11"	
e2(E)	10	#8	2'-11"	
e3(E)	54	#4	2'-6"	
e4(E)	9	#8	2'-6"	
e5(E)	6	#4	7'-7"	
e6(E)	1	#8	7'-5"	
x(E)	48	#5	4'-9"	
x1(E)	240	#5	3'-10"	
Concrete Superstructure			Cu. Yd.	43.2
Reinforcement Bars, Epoxy Coated			Pound	6330

**SUPERSTRUCTURE BILL OF MATERIALS
& BRIDGE APPROACH SLAB DETAILS
STRUCTURE NO. 025-0018**

DESIGNED	B.B.
CHECKED	C.J.F.
DRAWN	W.J.S.
CHECKED	C.J.F. & B.B.

* Tilt #9 b₃(E) bars as required to maintain clearance.
** Closed Cell Joint Filler according to Article 1051.08 of the Standard Specifications. Full depth of slab, full length of parapet.
*** Skew angle measured to tangent at intersection of \varnothing of Roadway and West Approach Pavement

**BERNARDIN
LOCHMUELLER &
ASSOCIATES, INC.**
3 Oak Drive
Maryville, IL 62452-5685
Local (618) 288-4665
Fax 618-288-4666

SHEET NO. 8 36 SHEETS	F.A.I. RTE.	SECTION	COUNTY	TOTAL SHEETS	SHEET NO.
	57	(25-3HB)I-3	EFFINGHAM	1416	1389
		SN 025-0018	CONTRACT NO. 74296		
FED. ROAD DIST. NO. 7 ILLINOIS FED. AID PROJECT					

01/29/2000 3:18:20 PM _0250018_74296.dgn