

F.A.P. RTE.	SECTION	COUNTY	TOTAL SHEETS	SHEET NO.
91	D7 Beam Repair 2011-1	COLES	5	1
		ILLINOIS	CONTRACT NO. 74499	

**STATE OF ILLINOIS**  
**DEPARTMENT OF TRANSPORTATION**  
**DIVISION OF HIGHWAYS**

**PROPOSED**  
**HIGHWAY PLANS**

**FAP ROUTE 91 (IL 16)**  
**SECTION D7 BEAM REPAIR 2011-1**

**BEAM BRACING**  
**COLES COUNTY**

C-97-150-10

FOR INDEX OF SHEETS, SEE SHEET NO. 2

D-97-082-10

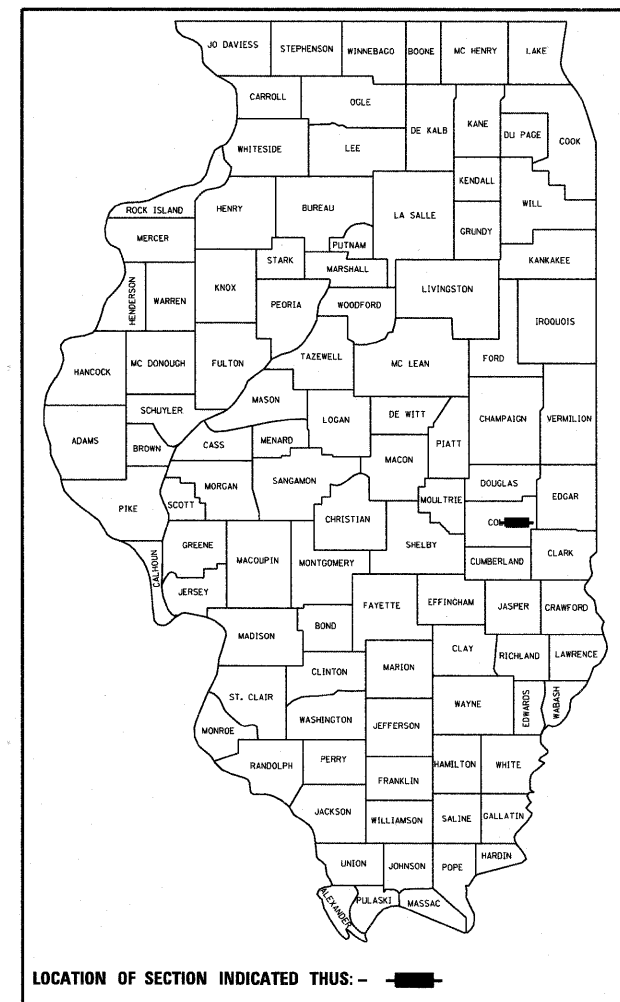

PROJECT LOCATION:  
SECTION D7 BEAM REPAIR 2011-1  
STRUCTURE 015-0019  
STATION 155+09

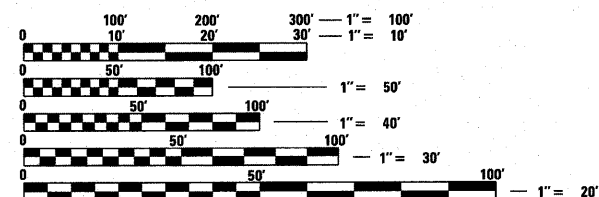
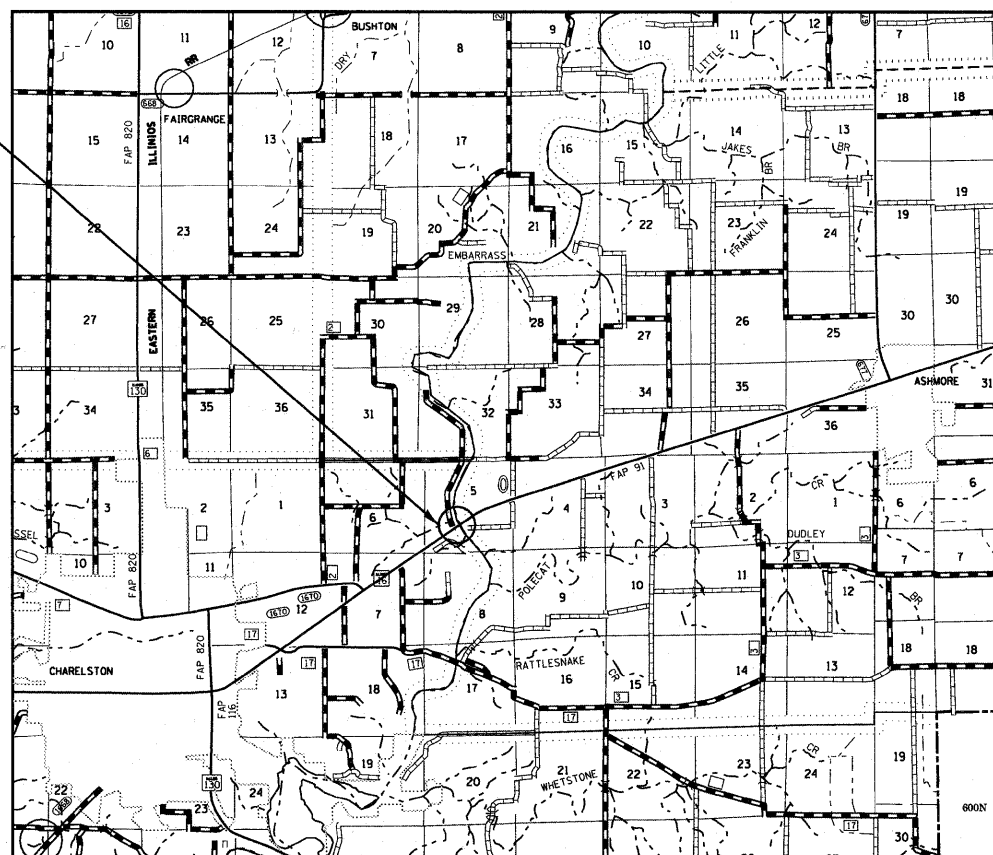

FULL SIZE PLANS HAVE BEEN PREPARED USING STANDARD ENGINEERING SCALES. REDUCED SIZED PLANS WILL NOT CONFORM TO STANDARD SCALES. IN MAKING MEASUREMENTS ON REDUCED PLANS, THE ABOVE SCALES MAY BE USED.

J.U.L.I.E.  
JOINT UTILITY LOCATION INFORMATION FOR EXCAVATION  
1-800-892-0123  
OR 811

PROJECT ENGINEER: MARK DAUGHERTY  
PROJECT MANAGER: BRIAN J. BIERMAN

CONTRACT NO. 74499

STATE OF ILLINOIS  
DEPARTMENT OF TRANSPORTATION  
DIVISION OF HIGHWAYS

SUBMITTED June 4 2010  
Roger J. Dinkell  
DEPUTY DIRECTOR OF HIGHWAYS, REGION ENGINEER

June 25 2010  
Scott E. Stitt, P.E.  
ACTING ENGINEER OF DESIGN AND ENVIRONMENT

June 25 2010  
Christine M. Reed  
DIRECTOR OF HIGHWAYS, CHIEF ENGINEER

**PRINTED BY THE AUTHORITY**  
**OF THE STATE OF ILLINOIS**