

F.A.P. RTE.	SECTION	COUNTY	TOTAL SHEETS	SHEET NO.
809	(133,134)RS-5,135RS-6	ST. CLAIR	762	97
STA. 552+00		TO STA. 567+00		
FED. ROAD DIST. NO. _		ILLINOIS	FED. AID PROJECT	

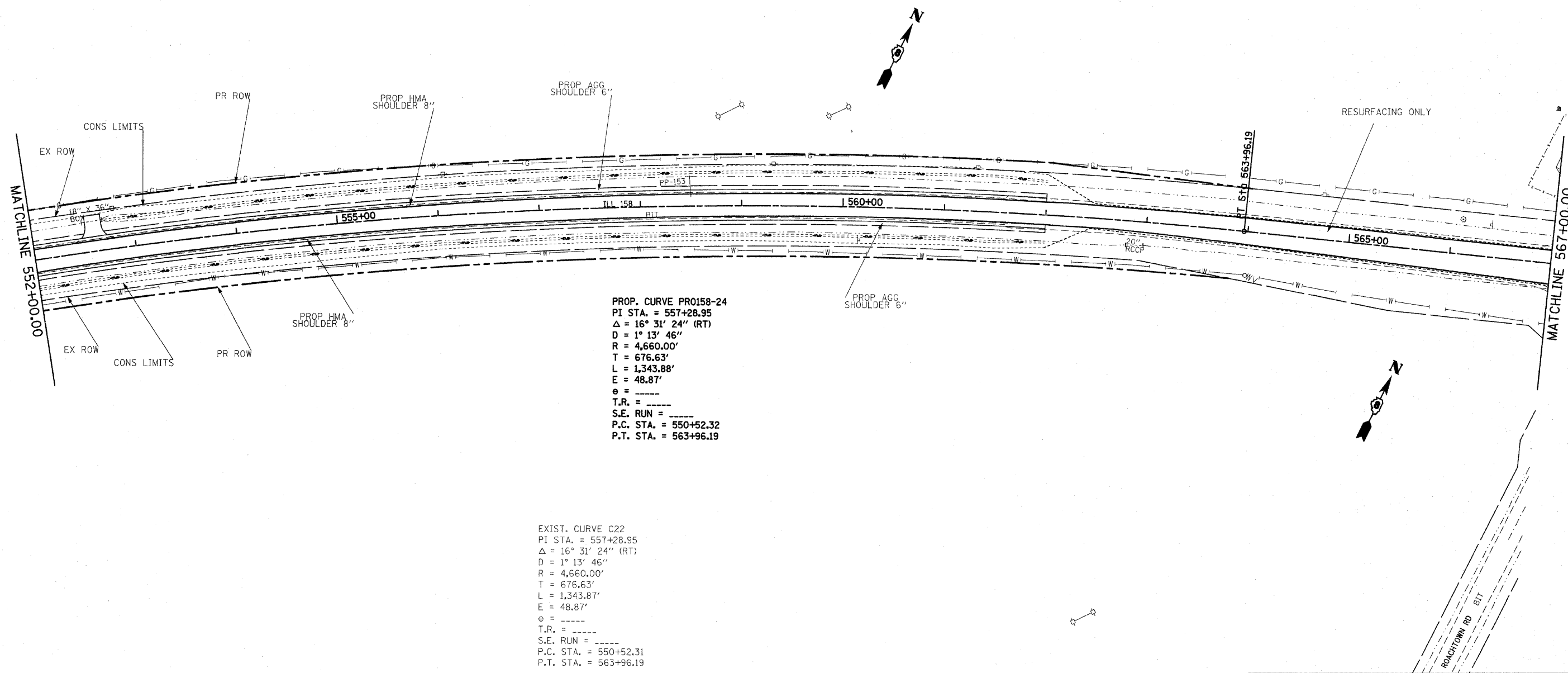

PROP. CURVE PRO158-24  
 PI STA. = 557+28.95  
 $\Delta = 16^\circ 31' 24''$  (RT)  
 $D = 1^\circ 13' 46''$   
 $R = 4,660.00'$   
 $T = 676.63'$   
 $L = 1,343.88'$   
 $E = 48.87'$   
 $e = \text{-----}$   
 $T.R. = \text{-----}$   
 $S.E. RUN = \text{-----}$   
 $P.C. STA. = 550+52.32$   
 $P.T. STA. = 563+96.19$

EXIST. CURVE C22  
 PI STA. = 557+28.95  
 $\Delta = 16^\circ 31' 24''$  (RT)  
 $D = 1^\circ 13' 46''$   
 $R = 4,660.00'$   
 $T = 676.63'$   
 $L = 1,343.87'$   
 $E = 48.87'$   
 $e = \text{-----}$   
 $T.R. = \text{-----}$   
 $S.E. RUN = \text{-----}$   
 $P.C. STA. = 550+52.31$   
 $P.T. STA. = 563+96.19$

REVISIONS	
NAME	DATE

ILLINOIS DEPARTMENT OF TRANSPORTATION  
**PLAN SHEETS**  
 FAP ROUTE 809 (IL RTE. 158)  
 SECTION (133, 134)RS-5, 135RS-6  
 ST. CLAIR COUNTY

SCALE: VERT. \_\_\_\_\_  
 HORIZ. \_\_\_\_\_  
 DATE \_\_\_\_\_ DRAWN BY \_\_\_\_\_  
 CHECKED BY \_\_\_\_\_

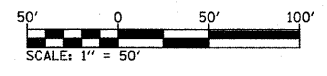

PLOT DATE = #DATE#  
 FILE NAME = #FILE#  
 PLOT SCALE = #SCALE#  
 USER NAME = #USER#