

F.A.P. RTE.	SECTION	COUNTY	TOTAL SHEETS	SHEET NO.
809	(133,134)RS-5,135RS-6	ST. CLAIR	762	103
STA. 640+00		TO STA. 655+00		
FED. ROAD DIST. NO. _____		ILLINOIS FED. AID PROJECT		

PROP. CURVE PR0158-26
 PI STA. = 648+36.63
 $\Delta = 48^\circ 40' 50''$ (LT)
 $D = 6^\circ 03' 47''$
 $R = 945.00'$
 $T = 427.48'$
 $L = 802.91'$
 $E = 92.19'$
 $e = \text{---}$
 $T.R. = \text{---}$
 $S.E. RUN = \text{---}$
 P.C. STA. = 644+09.14
 P.T. STA. = 652+12.05

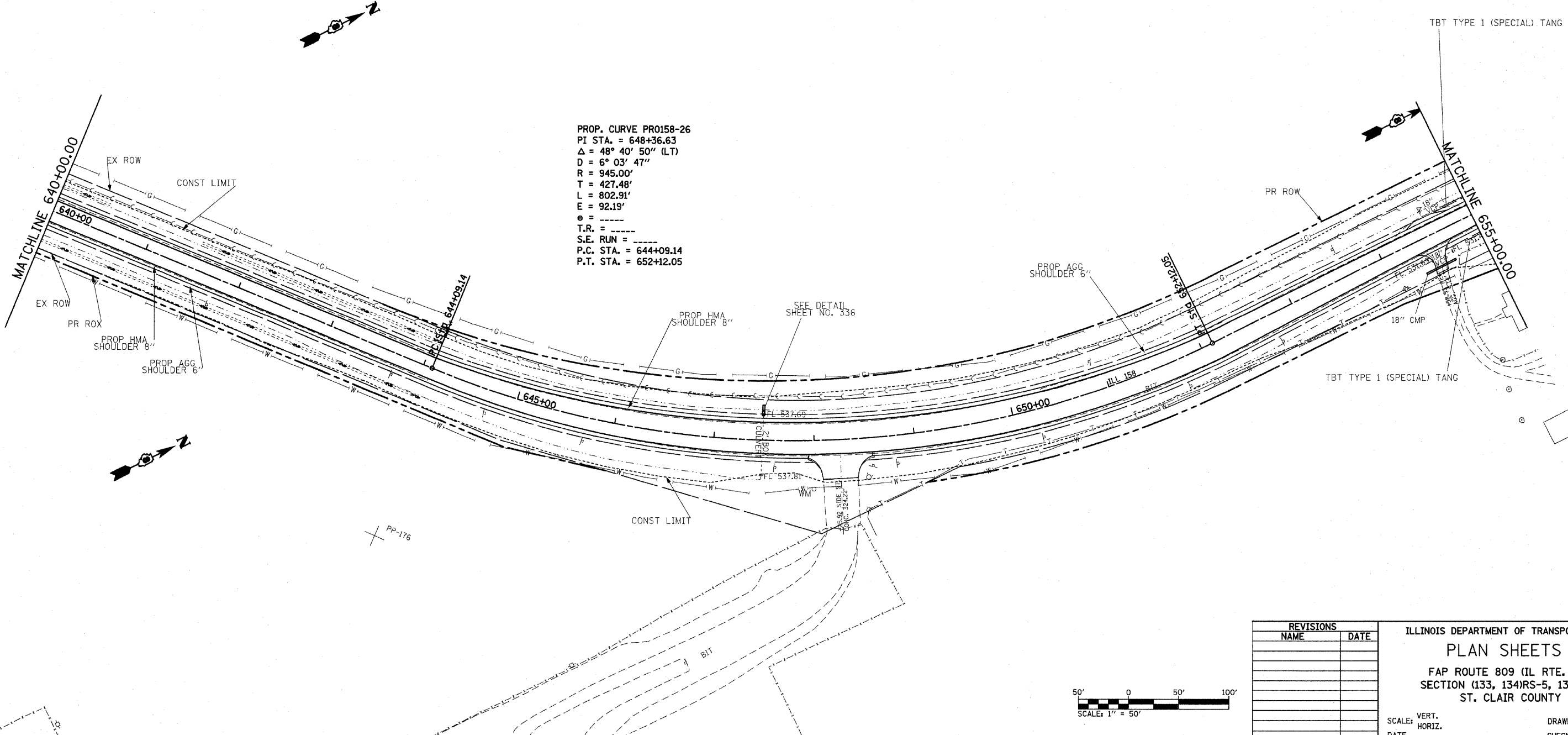

REVISIONS	
NAME	DATE

ILLINOIS DEPARTMENT OF TRANSPORTATION
PLAN SHEETS
 FAP ROUTE 809 (IL RTE. 158)
 SECTION (133, 134)RS-5, 135RS-6
 ST. CLAIR COUNTY

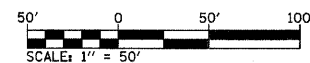

SCALE: VERT. _____
 HORIZ. _____
 DATE _____ DRAWN BY _____
 CHECKED BY _____

PLOT DATE = #DATE#
 FILE NAME = #FILE#
 PLOT SCALE = #SCALE#
 USER NAME = #USER#