

F.A.P. ROUTE	SECTION	COUNTY	TOTAL SHEETS	SHEET NO.
809	133,134 RS-4, 135 RS-5, 135 RS-6-IHBR	MONROE & ST. CLAIR	127	1
STA. _____ TO STA. _____		CONTRACT NO.: 76408 & 76A47		
R-98-008-03				

# STATE OF ILLINOIS DEPARTMENT OF TRANSPORTATION DIVISION OF HIGHWAYS

## PLAT OF HIGHWAYS PLANS FOR PROPOSED FEDERAL AID HIGHWAY

**FAP ROUTE 809 (ILLINOIS ROUTE 158)  
SECTION (133,134) RS-4, 135 RS-5 & (133,134) RS-5, 135 RS-6,  
MONROE AND ST. CLAIR COUNTY  
PROJECT NO.  
JOB NO. R-98-008-03**

### DISTRICT 8

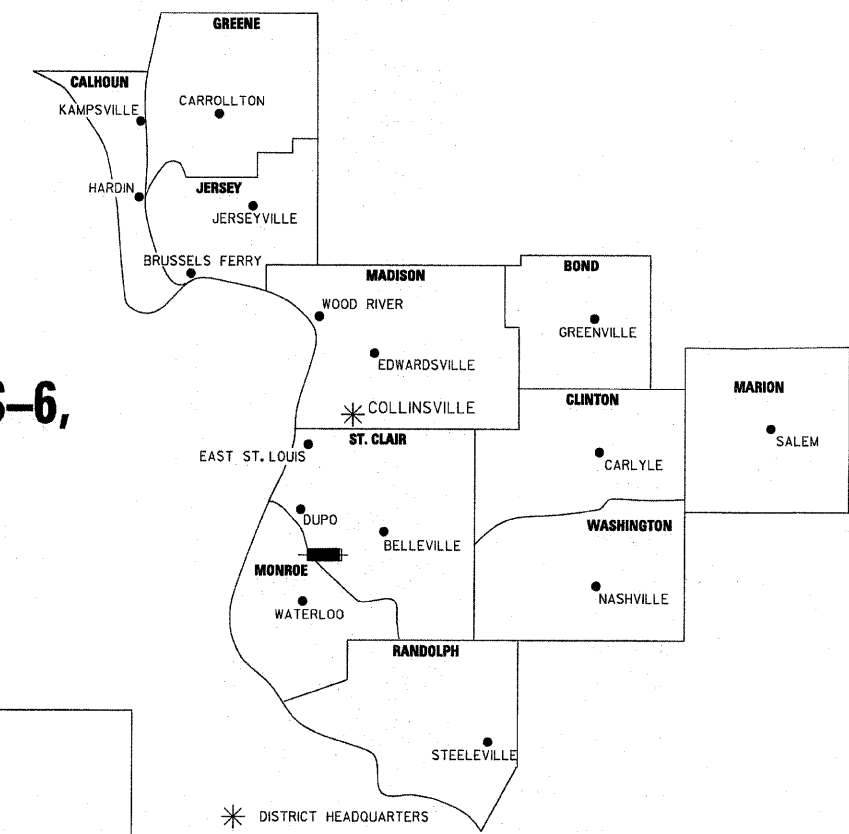

LOCATION OF SECTION INDICATED THUS:

#### PREPARED BY:

**DAVID MASON & ASSOCIATES**  
Engineering  
Architecture  
Surveying  
800 South Vandeventer Avenue  
St. Louis, MO 63110  
(314) 534-1030  
ILLINOIS LICENCE NO: 184-000485  
Expiration Date: April 30, 2011

#### LEGEND FOR EXISTING TOPOGRAPHIC SYMBOLS

- TRAFFIC SIGNAL HANDHOLE
- TRAFFIC SIGNAL GULFBOX
- TRAFFIC SIGNAL HANDHOLE
- TRAFFIC SIGNAL SIGNAL POST
- TRAFFIC SIGNAL STEEL MAST ARM
- TRAFFIC SIGNAL COMBINED MAST ARM
- TRAFFIC SIGNAL PEDESTRIAN PUSH BUTTON
- TRAFFIC SIGNAL WOODEN POLE
- TRAFFIC SIGNAL VEHICLE DETECTION PRIORITY
- TRAFFIC SIGNAL VEHICLE DETECTION MAGNET
- TRAFFIC SIGNAL JUNCTION BOX
- TRAFFIC SIGNAL CONTROLLER
- TRAFFIC SIGNAL HEAVY DUTY HANDHOLE
- RAILROAD CANTILEVER MAST ARM
- RAILROAD CROSSBUCK
- RAILROAD TRACK PATTERN
- RAILROAD ABANDON PATTERN
- RAILROAD CROSSGATE
- RAILROAD CONTROL BOX
- RAILROAD FLASHING SIGNAL
- TELEPHONE SPLICE BOX ABOVE GROUND
- UTILITY POWER POLE
- TELEPHONE POLE
- UTILITY TRAFFIC SIGNAL
- UTILITY LIGHT POLE
- FIRE HYDRANT
- UTILITY MANHOLE
- UTILITY TELEPHONE POLE
- UTILITY GUY POLE
- PIPELINE WARNING SIGN
- UTILITY HANDHOLE
- UTILITY SPLICE ABOVE GROUND
- UTILITY JUNCTION BOX
- UTILITY HEAVY DUTY HANDHOLE
- UTILITY DOUBLE HANDHOLE
- UTILITY CONTROLLER
- UTILITY WATER METER
- DRAINAGE FLOW LINE
- RIP RAP
- HEADWALL
- CULVERT END SECTION
- DRAINAGE MANHOLE
- INLET
- ROADWAY DITCH FLOW
- VEGETATION LINE
- STUMP
- SHRUB
- EVERGREEN TREE
- DECIDUOUS TREE
- WOODS/BUSH PATTERN
- TRAFFIC SIGN
- GAURDRAIL POST
- GAURDRAIL PATTERN
- FIELD LINE
- LEVEE/NOISE BARRIER
- FENCE PATTERN
- MAIL BOX
- ADVERTISING SIGN
- MARSH
- LIGHTING HANDHOLE
- LIGHTING POWER POLE
- LIGHTING JUNCTION BOX
- LIGHTING HEAVYDUTY HANDHOLE
- LIGHTING CONTROLLER
- LIGHTING PULL POINT
- HIGHWAY LIGHTING ELECTRICAL GROUND
- HIGHWAY LIGHTING SINGLE UNIT
- HIGHWAY LIGHTING DOUBLE UNIT
- EXISTING CONCRETE BARRIER

#### LEGEND FOR ABBREVIATIONS

- P.O.C. POINT OF COMMENCEMENT
- P.O.B. POINT OF BEGINNING
- A/C ACCESS CONTROL
- MAC MODIFIED ACCESS CONTROL
- PB PLAT BOOK
- DB DEED BOOK
- BK BOOK
- PG PAGE
- STA. STATION

#### CURVES

- P.C. POINT OF CURVATURE
- P.I. POINT OF INTERSECTION
- P.T. POINT OF TANGENCY
- R RADIUS OF CURVE
- L CURVE LENGTH
- CB CHORD BEARING
- C CHORD LENGTH
- Δ DELTA OF CURVE

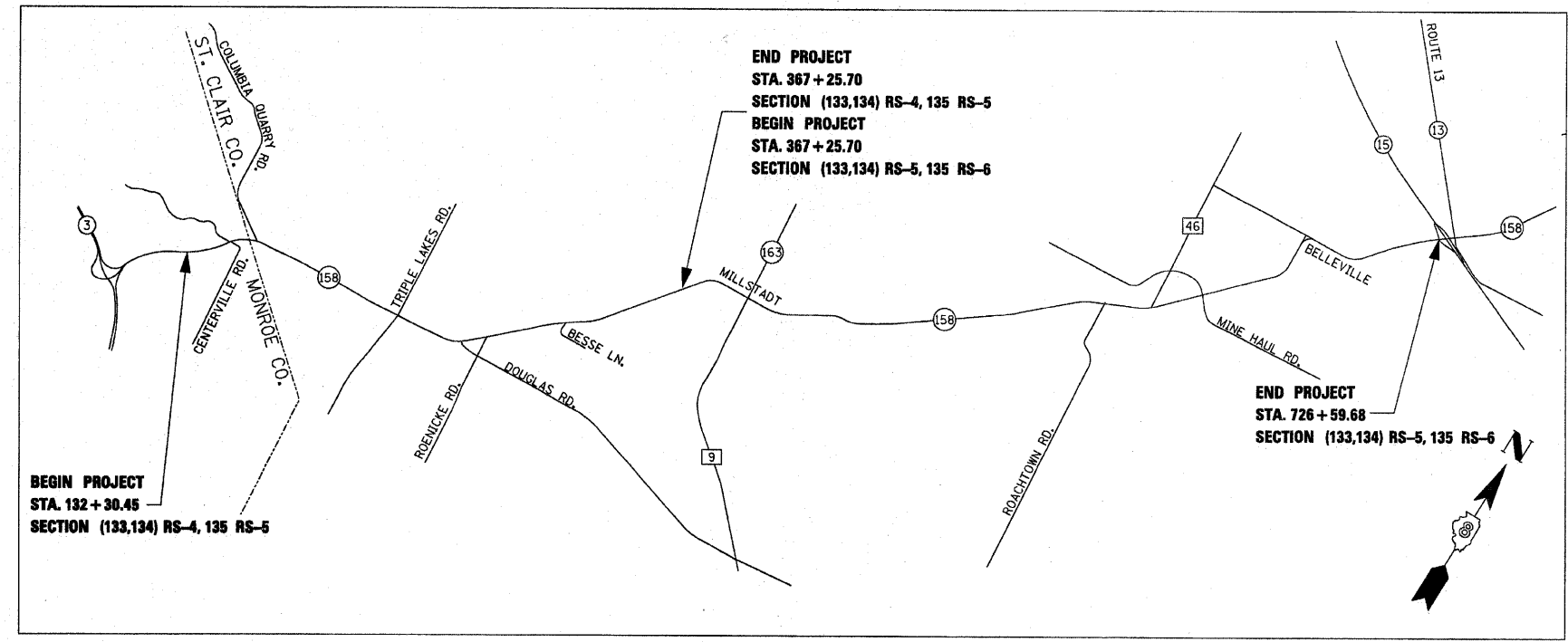

#### PROPOSED PARCEL NUMBER LEGEND

- PROPOSED FEE SIMPLE ACQUISITION
- PROPOSED PERMANENT EASEMENT
- PROPOSED TEMPORARY EASEMENT
- PROPOSED DEDICATION
- PROPOSED ACCESS CONTROL LINE
- PROPOSED MODIFIED ACCESS CONTROL LINE

**PROJECT LENGTH = 59,429.23 LIN. FT. = 11.25 MILES**

RONNIE D. LOWE, PLS NO. 035-003363  
LICENSE EXPIRATION DATE: 11/30/2010