

PARCEL NO.	OWNER	TOTAL HOLDING ACRES	FEE SIMPLE ACQUISITION						REMAINDER ACRES	EASEMENTS			PERMANENT TAX NUMBER	PROPERTY ACQUIRED BY DOC. NO.
			GROSS		PREVIOUSLY DEDICATED		NET			PE = PERMANENT ACRES	TE = TEMPORARY ACRES	EASEMENT PURPOSE		
			ACRES	SQ. FT.	ACRES	SQ. FT.	ACRES	SQ. FT.						
8308075	Kenneth H. Besse and Mary Frances Besse, husband and wife, as joint tenants Book 2583, Page 468 Title Report Number SC-5658	6.8680	0.0544	2,368				6.8136	0.0053	230	ENTRANCE CONSTRUCTION AND GRADING	12-17-200-016	A02115620	
8308076	Richard E. Bonn, divorced and not since married Book 3445, Page 1191 Title Report Number SC-5659	2.9986	0.0757	3,296				2.9229				12-17-200-026	A02146319	
8308077	Book 3091, Page 1525, Norwin Helmos Revocable Trust; Doc. No. A02045839, Book 3271, Page 1238, Norwin G. Helmos Living Revocable Trust, Dated December 30, 1993; Book 3019, Page 1522, Book 3064, Page 2372, Norwin Helmos Living Revocable Trust, dated December 30, 1993; Book 3278, Page 1428, Norwin G. Helmos, Trustee u/t/a dated 12/30/92, known as the Norwin G. Helmos Living Revocable Trust; Book 3747, Page 93, Norwin G. Helmos, Trustee Under Trust Agreement dated December 30, 1992, known as the Norwin G. Helmos Living Revocable Trust Title Report Number SC-5890, SC-5891, SC-5892, SC-5893, SC-5894, SC-5895, SC-5897, SC-5896	59.2789						59.2789	TE-1 0.0459 TE-2 0.0038 TE-3 0.0413	TE-1 1,999 TE-2 166 TE-3 1,199	TE-1 - ENTRANCE CONSTRUCTION AND GRADING TE-2 - ENTRANCE CONSTRUCTION AND GRADING TE-3 - ENTRANCE CONSTRUCTION AND GRADING	12-17-200-003 12-17-200-004 12-17-200-006 12-17-200-007 12-17-200-015 12-17-200-020 12-17-200-030 12-17-200-036	A02148842	
8308078	Ernest T. Werner, as trustee under the provisions of a trust agreement dated the 25th day of October, 1993, known as the Ernest T. Werner Declaration of Trust, as to an undivided 1/2 interest; and Doris Werner, as trustee under the provisions of a trust agreement dated the 25th day of October, 1993, known as the Doris Werner Declaration of Trust, as to an undivided 1/2 interest Title Report Number SC-5660	0.9012						0.9012	0.0043	185	DRIVEWAY CONSTRUCTION AND GRADING	12-17-0-300-028	A02119587	
8308084	David H. Albert, a married person Doc. No. A01944525 Book 4259, Page 851 Title Report Number SC-5663	56.7583	0.0900	3,921				56.6683				12-17-200-033 12-17-200-025	A02125789	

BEARINGS SHOWN HEREON ARE BASED ON SURVEY CONTROL DATA AS PROVIDED BY THE ILLINOIS DEPARTMENT OF TRANSPORTATION.

CONTRACT NO.: 76408 & 76A47
R-98-008-03

LEGEND

- SECTION CORNER
- QUARTER SECTION CORNER
- EXISTING CENTERLINE
- EXISTING RIGHT OF WAY LINE
- EXISTING EASEMENT LINE
- PROPOSED CENTERLINE
- PROPOSED RIGHT OF WAY LINE
- PROPOSED TEMPORARY EASEMENT LINE
- PROPOSED PERMANENT EASEMENT LINE
- SECTION LINE
- QUARTER SECTION LINE
- PROPERTY (DEED) LINE
- APL
- APPARENT PROPERTY LINE
- MEASURED DIMENSION
- COMPUTED DIMENSION
- RECORDED DIMENSION
- FOUND IRON PIPE OR IRON ROD AT CORNER UNLESS OTHERWISE NOTED
- SET 1/2 INCH IRON ROD AT CORNER UNLESS OTHERWISE NOTED
- PERMANENT SURVEY MONUMENT, I.D.O.T. STD. 667101 (TO BE SET BY OTHERS)
- CUT FOUND OR SET
- FOUND RIGHT OF WAY MARKER
- PROPOSED E OF CONSTRUCTION BEARING AND DISTANCE
- SAME OWNERSHIP
- EXISTING BUILDING

STAKING OF PROPOSED RIGHT OF WAY. SET 1/2 INCH METAL ROD WITH DIVISION OF HIGHWAY SURVEY MARKER TO MONUMENT THE POSITION SHOWN, IDENTIFIED BY INSCRIPTION DATA AND SURVEYORS REGISTRATION NUMBER. (PROPOSED RIGHT OF WAY CORNERS SET IN CULTIVATED AREAS SHALL BE A MINIMUM OF 20 INCHES BELOW THE GROUND SURFACES).

ALL DETAILS SHOWN NOT TO SCALE UNLESS OTHERWISE NOTED

COORDINATES SHOWN HEREON ARE BASED ON SURVEY CONTROL DATA AS PROVIDED BY THE ILLINOIS DEPARTMENT OF TRANSPORTATION.

STATION	OFFSET	NORTHING	EASTING
325+38.90	50.00' RT	649003.5739	2311643.5136
327+80.02	50.00' RT	649131.7711	2311846.4808
PT 330+78.31	0	649327.6345	2312076.1008
330+78.31	40.00' LT	649362.2115	2312055.9904
330+78.31	50.00' RT	649284.4132	2312101.2388
331+10.53	50.00' RT	649300.6099	2312129.0867
332+00.00	45.00' RT	649349.9152	2312203.9150
334+25.00	45.00' RT	649463.0365	2312398.4107
334+75.00	60.00' RT	649475.2081	2312449.1734
335+25.00	60.00' RT	649500.3462	2312492.3947
PC 335+44.96	0	649562.2483	2312479.4855
335+44.96	40.00' LT	649596.8253	2312459.3751
335+75.00	40.00' RT	649543.1213	2312525.8425

STATE OF MISSOURI)
) SS
CITY OF ST. LOUIS)

I, RONNIE D. LOWE, AN ILLINOIS PROFESSIONAL LAND SURVEYOR, CERTIFY THAT I HAVE SURVEYED THE PLAT OF HIGHWAY SHOWN HEREON AND THAT THIS PROFESSIONAL SERVICE CONFORMS TO THE CURRENT ILLINOIS MINIMUM STANDARDS FOR A BOUNDARY SURVEY FOR THE PROPOSED PARCEL(S) TO BE ACQUIRED BY THE STATE OF ILLINOIS, DEPARTMENT OF TRANSPORTATION, SHOWN HEREON.

DATED _____

RONNIE D. LOWE, PLS NO. 035-003363
LICENSE EXPIRATION DATE: 11/30/2010

DAVID MASON & ASSOCIATES Engineering Architecture Surveying
800 South Vandeventer Avenue
St. Louis, MO 63110
(314) 534-1030
ILLINOIS LICENCE NO: 184-000485
Expiration Date: April 30, 2011

ILLINOIS DEPARTMENT OF TRANSPORTATION
PLAT OF HIGHWAYS
FAP ROUTE 809 (IL 158)
SECTION (133,134) RS-4, 135 RS-5
MONROE AND ST. CLAIR COUNTY
JOB NO. R-98-008-03

STATION 325+00 TO STATION 340+00
SCALE: 1" = 50'
SHEET 22 OF 127

ILLINOIS DEPARTMENT OF TRANSPORTATION
DIVISION OF HIGHWAYS/DISTRICT 8
1102 EASTPORT PLAZA DRIVE
COLLINSVILLE, ILLINOIS 62234-6198
SHEET 1 IS A COVER SHEET

SW 1/4 NE 1/4 SEC 17-1S-9W
SEE SHEET TH12 FOR TOTAL HOLDING

SE 1/4 NE 1/4 SEC 17-1S-9W
SEE SHEET TH12 FOR TOTAL HOLDING

SE 1/4 NE 1/4 SEC 17-1S-9W
SEE SHEET TH13 FOR TOTAL HOLDING

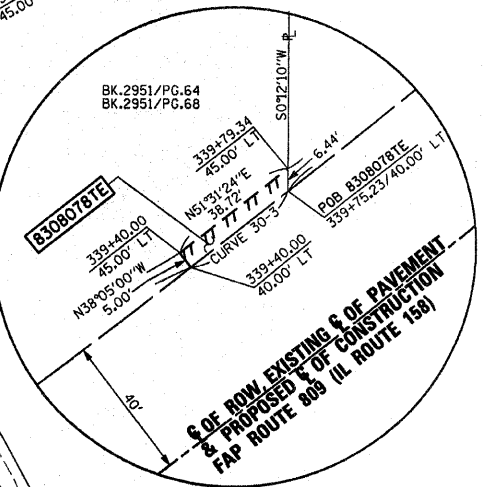

DETAIL A

Curve	R	L	C	CB
CURVE - 30-1	R = 2,824.90'	L = 125.99'	C = 125.98'	CB = S52°29'24" W
CURVE - 30-2	R = 11,499.20'	L = 199.65'	C = 199.64'	CB = S57°25'42" W
CURVE - 30-3	R = 2,824.90'	L = 34.73'	C = 34.73'	CB = S51°33'52" W
CURVE - 30-4	R = 11,409.20'	L = 45.90'	C = 45.90'	CB = N57°14'07" E

PROP. CURVE C10
PI STA. = 323+36.11
Δ = 0° 25' 57" (RT)
D = 0° 30' 00"
R = 11,459.20'
T = 744.29'
L = 1,486.48'
E = 24.14'
P.C. STA. = 315+91.83
P.T. STA. = 330+78.31

PROP. CURVE C11
PI STA. = 340+46.66
Δ = 19° 51' 56" (RT)
D = 0° 00' 00"
R = 2,864.90'
T = 501.69'
L = 993.31'
E = 43.60'
P.C. STA. = 335+44.96
P.T. STA. = 345+38.28

COMPLETION DATE OF FIELD WORK PERFORMED
LAND SURVEY: OCTOBER 06, 2006
RIGHT OF WAY STAKING: JUNE 02, 2009

INC.	DATE	DESCRIPTION	BY

8601266
DATE-TIME
CON-SPEC
REF
REF
REF