

BEARINGS SHOWN HEREON ARE BASED ON SURVEY CONTROL DATA AS PROVIDED BY THE ILLINOIS DEPARTMENT OF TRANSPORTATION.

FAP ROUTE	SECTION	COUNTY	TOTAL SHEETS	SHEET NO.
809	133,134 RS-4, 135 RS-5	MONROE / ST. CLAIR	762	139
STA. 339+00		TO STA. 352+00		
CONTRACT NO.: 76408 & 76447				
R-98-008-03				

LEGEND

- EXISTING CENTERLINE
  - EXISTING RIGHT OF WAY LINE
  - EXISTING EASEMENT LINE
  - PROPOSED CENTERLINE
  - PROPOSED RIGHT OF WAY LINE
  - PROPOSED TEMPORARY EASEMENT LINE
  - PROPOSED PERMANENT EASEMENT LINE
  - SECTION LINE
  - QUARTER SECTION LINE
  - QUARTER QUARTER SECTION LINE
  - PROPERTY (DEED) LINE
  - APPARENT PROPERTY LINE
  - MEASURED DIMENSION
  - COMPUTED DIMENSION
  - RECORDED DIMENSION
  - FOUND IRON PIPE OR IRON ROD AT CORNER UNLESS OTHERWISE NOTED
  - SET 3/8 INCH IRON ROD AT CORNER UNLESS OTHERWISE NOTED
  - PERMANENT SURVEY MONUMENT, I.D.O.T. STD. 667101 (TO BE SET BY OTHERS)
  - CUT CROSS FOUND OR SET
  - FOUND RIGHT OF WAY MARKER
  - PROPOSED CENTERLINE BEARING AND DISTANCE
  - SAME OWNERSHIP
  - EXISTING BUILDING
  - STAKING OF PROPOSED RIGHT OF WAY. SET 3/8 INCH METAL ROD WITH DIVISION OF HIGHWAY SURVEY MARKER TO MONUMENT THE POSITION SHOWN, IDENTIFIED BY INSCRIPTION DATA AND SURVEYORS REGISTRATION NUMBER. (PROPOSED RIGHT OF WAY CORNERS SET IN CULTIVATED AREAS SHALL BE A MINIMUM OF 20 INCHES BELOW THE GROUND SURFACES).
- ALL DETAILS SHOWN NOT TO SCALE UNLESS OTHERWISE NOTED

STATE OF MISSOURI )  
 ) SS  
 CITY OF ST. LOUIS )

I, RONNIE D. LOWE, AN ILLINOIS PROFESSIONAL LAND SURVEYOR, CERTIFY THAT I HAVE SURVEYED THE PLAT OF HIGHWAY SHOWN HEREON AND THAT THIS PROFESSIONAL SERVICE CONFORMS TO THE CURRENT ILLINOIS MINIMUM STANDARDS FOR A BOUNDARY SURVEY FOR THE PROPOSED PARCEL(S) TO BE ACQUIRED BY THE STATE OF ILLINOIS, DEPARTMENT OF TRANSPORTATION, SHOWN HEREON.

DATED \_\_\_\_\_  
 RONNIE D. LOWE, PLS NO. 035-003363  
 LICENSE EXPIRATION DATE: 11/30/2010

**DAVID MASON & ASSOCIATES** Engineering Architecture Surveying  
 800 South Vandeventer Avenue  
 St. Louis, MO 63110  
 (314) 534-1030  
 ILLINOIS LICENCE NO: 184-000485  
 Expiration Date: April 30, 2011

ILLINOIS DEPARTMENT OF TRANSPORTATION  
**PLAT OF HIGHWAYS**  
 FAP ROUTE 809 (IL 158)  
 SECTION (133,134) RS-4, 135 RS-5  
 MONROE AND ST. CLAIR COUNTY  
 JOB NO. R-98-008-03

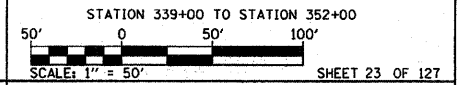

COMPLETION DATE OF FIELD WORK PERFORMED  
 LAND SURVEY: OCTOBER 06, 2006  
 RIGHT OF WAY STAKING: JUNE 02, 2009

ILLINOIS DEPARTMENT OF TRANSPORTATION  
 DIVISION OF HIGHWAYS/DISTRICT 8  
 1102 EASTPORT PLAZA DRIVE  
 COLLINGSVILLE, ILLINOIS 62234-6198  
 SHEET 1 IS A COVER SHEET

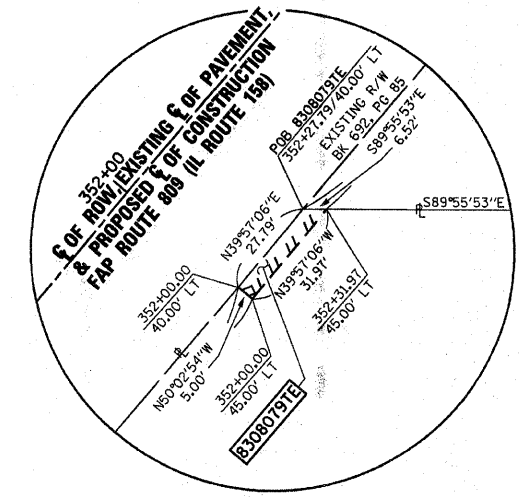

DETAIL B

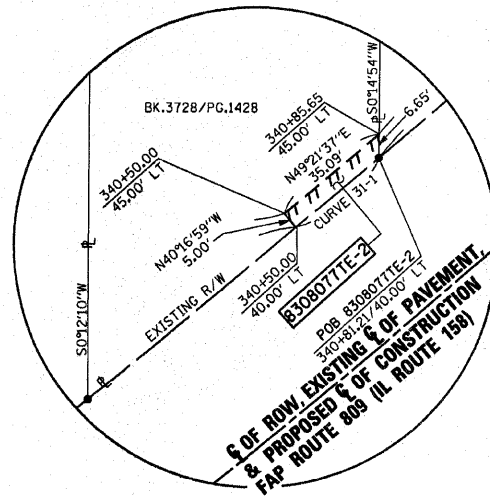

DETAIL A

DOC. NO. A02084950  
 NW 1/4 NW 1/4  
 SEC 16-1S-9W  
 SEE SHEET TH13  
 FOR TOTAL HOLDING

COORDINATES SHOWN HEREON ARE BASED ON SURVEY CONTROL DATA AS PROVIDED BY THE ILLINOIS DEPARTMENT OF TRANSPORTATION.

STATION	OFFSET	NORTHING	EASTING
341+21.70	40.00' RT	649870.4095	2312972.2015
341+57.88	0	649924.5124	2312972.4360
341+95.63	40.00' LT	649979.2621	2312972.6734
345+38.28	40.00' LT	650227.9670	2313200.8225
PT 345+38.28	0	650199.0706	2313235.3189
345+38.28	40.00' RT	650173.3850	2313265.9823

CURVE TABLE					
Curve	R	L	C	CB	
CURVE - 31-1	R = 2,824.90'	L = 30.77'	C = 30.77'	CB = S49°24'17\"W	

PARCEL NO.	OWNER	TOTAL HOLDING ACRES	FEE SIMPLE ACQUISITION				REMAINDER ACRES	EASEMENTS		PERMANENT TAX NUMBER	PROPERTY ACQUIRED BY DOC. NO.	
			GROSS ACRES	PREVIOUSLY DEDICATED ACRES	NET ACRES	SO. FT.		PE = PERMANENT ACRES	TE = TEMPORARY ACRES			EASEMENT PURPOSE
8308077	SEE SHEET 22											
8308079	William H. Albert Self Declaration of Trust dated December 28, 2007 Doc. No. A02084950 Title Report Number SC-5661	21.4026					21.4026	0.0034	149	ENTRANCE CONSTRUCTION AND GRADING	12-16-100-011	A02137602

PROP. CURVE C11  
 PI STA. = 340+46.66  
 $\Delta = 19^\circ 51' 56''$  (RT)  
 $D = 02^\circ 00' 00''$   
 $R = 2,864.90'$   
 $T = 501.69'$   
 $L = 993.31'$   
 $E = 43.60'$   
 P.C. STA. = 335+44.96  
 P.T. STA. = 345+38.28

South Line NW 1/4 NW 1/4 Sec 16, T1S, R9W

NO.	DATE	DESCRIPTION	BY

DATE: TIME:  
 DATE: TIME:  
 DATE: TIME:  
 DATE: TIME: