

BEARINGS SHOWN HEREON ARE BASED ON SURVEY CONTROL DATA AS PROVIDED BY THE ILLINOIS DEPARTMENT OF TRANSPORTATION.

| FAP ROUTE | SECTION | COUNTY | TOTAL SHEETS | SHEET NO. |
|-----------------------------|------------------------|------------------|--------------|-----------|
| 809 | 133,134 RS-5, 135 RS-6 | MONROE/ST. CLAIR | 762 | 146 |
| STA. 394+50 | | TO STA. 399+50 | | |
| CONTRACT NO.: 76408 & 76447 | | R-98-008-03 | | |



- LEGEND**
- EXISTING CENTERLINE
 - EXISTING RIGHT OF WAY LINE
 - EXISTING EASEMENT LINE
 - PROPOSED CENTERLINE
 - PROPOSED RIGHT OF WAY LINE
 - PROPOSED TEMPORARY EASEMENT LINE
 - PROPOSED PERMANENT EASEMENT LINE
 - SECTION LINE
 - QUARTER SECTION LINE
 - PROPERTY (DEED) LINE
 - APPARENT PROPERTY LINE
 - 121.45 MEASURED DIMENSION
 - 123.45 (COMP) COMPUTED DIMENSION
 - (123.45) RECORDED DIMENSION
 - FOUND IRON PIPE OR IRON ROD
 - SET 1/2 INCH IRON ROD
 - PERMANENT SURVEY MONUMENT, I.D.O.T. STD. 2135
 - (TO BE SET BY OTHERS) CUT CROSS FOUND OR SET
 - FOUND RIGHT OF WAY MARKER
 - N89°21'38"W 120.00' PROPOSED C. OF CONSTRUCTION BEARING AND DISTANCE
 - SAME OWNERSHIP
 - EXISTING BUILDING

STAKING OF PROPOSED RIGHT OF WAY. SET 1/2 INCH METAL ROD WITH DIVISION OF HIGHWAY SURVEY MARKER TO MONUMENT THE POSITION SHOWN, IDENTIFIED BY INSCRIPTION DATA AND SURVEYORS REGISTRATION NUMBER. (PROPOSED RIGHT OF WAY CORNERS SET IN CULTIVATED AREAS SHALL BE A MINIMUM OF 20 INCHES BELOW THE GROUND SURFACES).

ALL DETAILS SHOWN NOT TO SCALE UNLESS OTHERWISE NOTED

STATE OF MISSOURI)
) SS
CITY OF ST. LOUIS)

I, RONNIE D. LOWE AN ILLINOIS PROFESSIONAL LAND SURVEYOR, CERTIFY THAT THIS PROFESSIONAL SERVICE CONFORMS TO THE CURRENT ILLINOIS MINIMUM STANDARDS FOR A BOUNDARY SURVEY FOR THE PROPOSED PARCEL(S) TO BE ACQUIRED BY THE STATE OF ILLINOIS, DEPARTMENT OF TRANSPORTATION, SHOWN HEREON.

DATED _____
RONNIE D. LOWE, PLS NO. 035-003363
LICENCE EXPIRATION DATE: 11/30/2010

DAVID MASON & ASSOCIATES Engineering Architecture Surveying
800 South Vandeventer Avenue
St. Louis, MO 63110
(314) 534-1030
ILLINOIS LICENCE NO: 184-000485
Expiration Date: April 30, 2011

ILLINOIS DEPARTMENT OF TRANSPORTATION
PLAT OF HIGHWAYS
FAP ROUTE 809 (IL 158)
SECTION (133,134) RS-5, 135 RS-6
MONROE AND ST. CLAIR COUNTY
JOB NO. R-98-008-03
STATION 394+50 TO STATION 399+50
SCALE: 1" = 20'
SHEET 30 OF 127
ILLINOIS DEPARTMENT OF TRANSPORTATION
DIVISION OF HIGHWAYS/DISTRICT 8
1102 EASTPORT PLAZA DRIVE
COLLINGSVILLE, ILLINOIS 62234-6198
SHEET 1 IS A COVER SHEET

| NO. | DATE | DESCRIPTION | BY |
|-----|------------|--------------|-----|
| 3 | MM/DD/YYYY | CHANGE XXXXX | XXX |
| 2 | MM/DD/YYYY | CHANGE XXXXX | XXX |
| 1 | MM/DD/YYYY | CHANGE XXXXX | XXX |

*DATE-TIME
*DATE-SPEC
*REF.
*REF.
*REF.

South Line NE 1/4 Sec 9, T1S, R9W
North Line SE 1/4 Sec 9, T1S, R9W

HENCKLER'S ADDITION TO CENTERVILLE
PLAT BK.R/PG.163
BLOCK 3

RANDLEMAN'S 3RD ADDITION
PLAT BK.DSN/PG.104
BLOCK 2

HENCKLER'S ADDITION TO CENTERVILLE
PLAT BK.R/PG.163
BLOCK 6

RANDLEMAN'S 3RD ADDITION
PLAT BK.DSN/PG.104
BLOCK 3

EXISTING R/W BK 692, PG 64
EXISTING R/W BK 692, PG 40
EXISTING R/W BK 692, PG 40
EXISTING R/W BK 692, PG 40

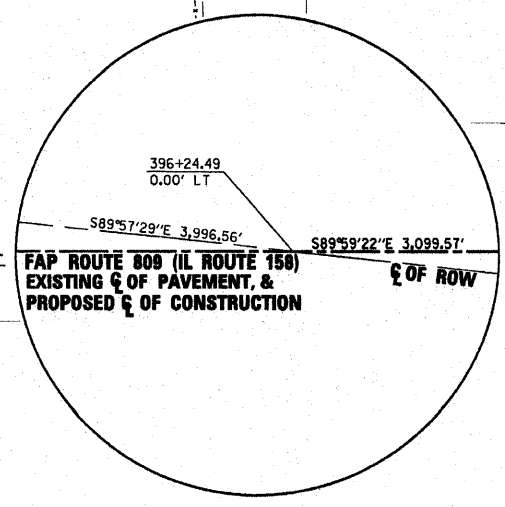

DETAIL A

COORDINATES SHOWN HEREON ARE BASED ON SURVEY CONTROL DATA AS PROVIDED BY THE ILLINOIS DEPARTMENT OF TRANSPORTATION.

| STATION | COORDINATE TABLE | | |
|-----------|------------------|-------------|--------------|
| | OFFSET | NORTHING | EASTING |
| 394+25.25 | 24.89' RT | 653528.0243 | 2316649.0817 |
| 394+25.79 | 25.11' LT | 653578.0249 | 2316649.6233 |
| 394+75.25 | 24.92' RT | 653527.9887 | 2316699.0827 |
| 394+75.79 | 25.08' LT | 653577.9884 | 2316699.6233 |
| 397+98.59 | 24.90' LT | 653577.7523 | 2317022.4248 |
| 397+98.69 | 25.10' RT | 653527.7523 | 2317022.5197 |
| 398+38.59 | 24.88' LT | 653577.7231 | 2317062.4249 |
| 398+38.69 | 25.12' RT | 653527.7230 | 2317062.5198 |

NOTE: ALL FOUND MONUMENTATION ON THIS SHEET SHOWN PERPENDICULAR TO EXISTING RIGHT-OF-WAY

COMPLETION DATE OF FIELD WORK PERFORMED
LAND SURVEY: OCTOBER 06, 2006
RIGHT OF WAY STAKING: JUNE 02, 2009