

BEARINGS SHOWN HEREON ARE BASED ON SURVEY CONTROL DATA AS PROVIDED BY THE ILLINOIS DEPARTMENT OF TRANSPORTATION.

SECTION	COUNTY	TOTAL SHEETS	SHEET NO.
133,134 RS-5, 135 RS-6	MONROE/ST. CLAIR	762	130
CONTRACT NO.: 76408 & 76447		R-98-008-03	

COORDINATES SHOWN HEREON ARE BASED ON SURVEY CONTROL DATA AS PROVIDED BY THE ILLINOIS DEPARTMENT OF TRANSPORTATION.

STATION	OFFSET	NORTH	EAST
649+08.02	49.99' RT	665194.3702	2338583.9790
PT 652+12.12	0	665509.0585	2338585.0650
652+12.16	50.00' RT	665509.0996	2338635.0650
652+37.56	60.00' LT	665534.5048	2338525.0649
653+23.72	50.00' RT	665620.6612	2338635.0645
654+00.00	50.00' RT	665696.9436	2338635.0641
655+00.00	60.00' RT	665796.9437	2338645.0635
656+00.00	60.00' LT	665896.9431	2338525.0630
PC 656+98.45	0	665995.3971	2338585.0625
656+98.45	60.00' RT	665995.3974	2338645.0625
657+00.00	80.00' LT	665997.0732	2338505.0639
657+35.13	60.00' RT	666029.7507	2338645.7256
658+50.00	52.73' LT	666154.6775	2338545.0617

LEGEND

- EXISTING CENTERLINE
- EXISTING RIGHT OF WAY LINE
- EXISTING EASEMENT LINE
- PROPOSED CENTERLINE
- PROPOSED RIGHT OF WAY LINE
- PROPOSED TEMPORARY EASEMENT LINE
- PROPOSED PERMANENT EASEMENT LINE
- SECTION LINE
- QUARTER SECTION LINE
- QUARTER QUARTER SECTION LINE
- PROPERTY (DEED) LINE
- APPARENT PROPERTY LINE
- MEASURED DIMENSION
- RECORDED DIMENSION
- FOUND IRON PIPE OR IRON ROD AT CORNER UNLESS OTHERWISE NOTED
- SET 1/2 INCH IRON ROD AT CORNER UNLESS OTHERWISE NOTED
- PERMANENT SURVEY MONUMENT, I.D.O.T. STD. 667101 (TO BE SET BY OTHERS)
- CUT CROSS FOUND OR SET
- FOUND RIGHT OF WAY MARKER
- N89°21'38"W 120.00' PROPOSED C/OF CONSTRUCTION BEARING AND DISTANCE
- SAME OWNERSHIP
- EXISTING BUILDING

STAKING OF PROPOSED RIGHT OF WAY. SET 1/2 INCH METAL ROD WITH DIVISION OF HIGHWAY SURVEY MARKER TO MONUMENT THE POSITION SHOWN, IDENTIFIED BY INSCRIPTION DATA AND SURVEYORS REGISTRATION NUMBER. (PROPOSED RIGHT OF WAY CORNERS SET IN CULTIVATED AREAS SHALL BE A MINIMUM OF 20 INCHES BELOW THE GROUND SURFACES).

ALL DETAILS SHOWN NOT TO SCALE UNLESS OTHERWISE NOTED

STATE OF MISSOURI)
) SS
CITY OF ST. LOUIS)

I, RONNIE D. LOWE, AN ILLINOIS PROFESSIONAL LAND SURVEYOR, CERTIFY THAT I HAVE SURVEYED THE PLAT OF HIGHWAY SHOWN HEREON AND THAT THIS PROFESSIONAL SERVICE CONFORMS TO THE CURRENT ILLINOIS MINIMUM STANDARDS FOR A BOUNDARY SURVEY FOR THE PROPOSED PARCEL(S) TO BE ACQUIRED BY THE STATE OF ILLINOIS, DEPARTMENT OF TRANSPORTATION, SHOWN HEREON.

DATED _____
RONNIE D. LOWE, PLS NO. 035-003363
LICENSE EXPIRATION DATE: 11/30/2010

DAVID MASON & ASSOCIATES Engineering Architecture Surveying
800 South Vandeventer Avenue
St. Louis, MO 63110
(314) 534-1030
ILLINOIS LICENSE NO: 184-000485
Expiration Date: April 30, 2011

ILLINOIS DEPARTMENT OF HIGHWAYS
PLAT OF HIGHWAYS
FAP ROUTE 809 (IL 158)
SECTION (133,134) RS-5, 135 RS-6
MONROE AND ST. CLAIR COUNTY
JOB NO. R-98-008-03
STATION 648+00 TO STATION 658+00

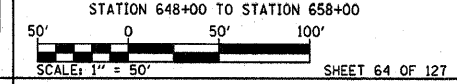

ILLINOIS DEPARTMENT OF TRANSPORTATION
DIVISION OF HIGHWAYS/DISTRICT 8
1102 EASTPORT PLAZA DRIVE
COLLINGSVILLE, ILLINOIS 62234-6198
SHEET 1 IS A COVER SHEET

COMPLETION DATE OF FIELD WORK PERFORMED
LAND SURVEY: OCTOBER 06, 2006
RIGHT OF WAY STAKING: JUNE 02, 2009

NO.	DATE	DESCRIPTION	BY

LOT 13
PLAT BK."A"/PG. 204
BK.2759/PG.630 & 635
NE 1/4
SEC 31-1N-8W
SEE SHEET TH24 FOR TOTAL HOLDING

NW 1/4
SEC 32-1N-8W
SEE SHEET TH25 FOR TOTAL HOLDING

PART OF LOT 14
PLAT BK."A"/PG. 204
BK.2759/PG.630 & 635
NE 1/4
SEC 31-1N-8W
SEE SHEET TH24 FOR TOTAL HOLDING

NW 1/4
SEC 32-1N-8W
SEE SHEET TH25 FOR TOTAL HOLDING

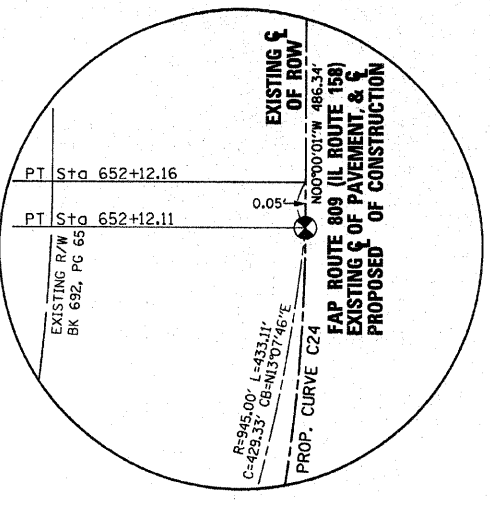

DETAIL A



DETAIL B

CURVE TABLE			
STATION	R	L	CB
CURVE-67-1	R=890.00'	L=34.36'	CB=S01°06'21"W
PROP. CURVE C24	R=945.00'	L=433.11'	CB=N13°07'46"E
PROP. CURVE C27	R=945.00'	L=433.11'	CB=N13°07'46"E

PARCEL NO.	OWNER	TOTAL HOLDING ACRES	FEE SIMPLE ACQUISITION			REMAINDER ACRES	EASEMENTS		PERMANENT TAX NUMBER	PROPERTY ACQUIRED BY
			GROSS ACRES	PREVIOUSLY USED & DEDICATED ACRES	NET ACRES		PE = PERMANENT ACRES	TE = TEMPORARY ACRES		
8308212	SEE SHEET 62									
8308213	Doris Mae Jones Book 2418 Page 2023, Book 2327 Page 778, Book 2937 Page 863 Title Report Number SC-5906	19.0208	0.0951	4,143		18.9257			08-32-0-100-016	
8308214	Roy Melvin Jones & Doris Mae Jones, as joint tenants Book 2937 Page 863 & Book 2919 Page 1658 Title Report Number SC-5955, SC-5956	16.6399	0.1577	5,869		16.4822			08-32-0-100-015 08-32-0-100-012	