

COORDINATES SHOWN HEREON ARE BASED ON SURVEY CONTROL DATA AS PROVIDED BY THE ILLINOIS DEPARTMENT OF TRANSPORTATION.

COORDINATE TABLE			
STATION	OFFSET	NORTH	EAST
671+39.46	82.33' LT	667026.2260	2339479.3916
671+51.62	61.39' LT	667005.9399	2339493.4563
PC 671+89.57 BK	0	666945.4012	2339533.9174
PC 673+72.12 AH	0	666945.4012	2339533.9174
674+19.37	60.64' LT	667006.0974	2339581.0986
674+64.85	60.67' LT	667006.1791	2339626.5769
675+08.36	60.69' LT	667006.2572	2339670.0791
675+53.85	60.72' LT	667006.3390	2339715.5750
675+97.25	60.74' LT	667006.4170	2339758.9770
676+42.75	60.77' LT	667006.4987	2339804.4778
676+86.23	60.80' LT	667006.5768	2339847.9577
677+31.77	60.82' LT	667006.6587	2339893.4909
677+75.19	60.85' LT	667006.7367	2339936.9116

PARCEL NO.	OWNER	TOTAL HOLDING ACRES	GROSS			FEE SIMPLE ACQUISITION			REMAINDER		EASEMENTS		PERMANENT TAX NUMBER	PROPERTY ACQUIRED BY
			ACRES	SO. FT.	ACRES	SO. FT.	ACRES	SO. FT.	ACRES	SO. FT.	ACRES	SO. FT.		
8308234	Steven P. Boul, single & Rhonda L. Trlpp, single, as joint tenants Doc. No. A01982725, A01992530 Title Report Number SC-5040	0.3184	0.0475	2,071					0.2709	TE=0.0185	TE=806	GRADING	08-29-0-305-009	
8308235	Sandra J. Ward Document No. A0201008 Title Report Number SC-5039	0.1734	0.0209	910					0.1525				08-29-0-305-010	
8308236	Roseann Nasser, divorced and not since remarried Document No. A02082078 Title Report Number SC-5038	0.1659	0.0200	807					0.1459				08-29-0-305-011	A02154146
8308237	SonTon, a Limited Liability Company Book 4186 Page 2205 Title Report Number SC-5037	0.1736	0.0209	910					0.1527				08-29-0-305-012	
8308238	Patricia C. Vincent Book 4301 Page 1362 Title Report Number SC-5036	0.1656	0.0199	868					0.1457				08-29-0-305-013	
8308239	Lucille A. Ritean Document No. A02037306 Title Report Number SC-5035	0.1737	0.0209	910					0.1528				08-29-0-305-014	
8308240	SonTon, a Limited Liability Company Book 4186 Page 2205 Title Report Number SC-5034	0.1660	0.0200	870					0.1460				08-29-0-305-015	
8308241	SonTon, a Limited Liability Company Book 4186 Page 2205 Title Report Number SC-5033	0.1740	0.0209	911					0.1531				08-29-0-305-016	
8308242	Karen A. Lanter Doc. No. A02013735 Title Report Number SC-5032	0.1659	0.0199	868					0.1460				08-29-0-305-017	

BEARINGS SHOWN HEREON ARE BASED ON SURVEY CONTROL DATA AS PROVIDED BY THE ILLINOIS DEPARTMENT OF TRANSPORTATION.

SECTION	COUNTY	TOTAL SHEETS	SHEET NO.
133,134 RS-5, 135 RS-6	MONROE / ST. CLAIR	762	188
STA. 671+00 TO STA. 677+75		76408 & 76417	

LEGEND

- EXISTING CENTERLINE
- EXISTING RIGHT OF WAY LINE
- EXISTING EASEMENT LINE
- PROPOSED CENTERLINE
- PROPOSED RIGHT OF WAY LINE
- PROPOSED TEMPORARY EASEMENT LINE
- PROPOSED PERMANENT EASEMENT LINE
- SECTION LINE
- QUARTER SECTION LINE
- PROPERTY (DEED) LINE
- APPARENT PROPERTY LINE
- 121.45 MEASURED DIMENSION
- 123.45 (COMP) COMPUTED DIMENSION
- (123.45) RECORDED DIMENSION
- FOUND IRON PIPE OR IRON ROD
- SET 1/2 INCH IRON ROD
- PERMANENT SURVEY MONUMENT, I.D.O.T. STD. 2135 (TO BE SET BY OTHERS)
- CUT CROSS FOUND OR SET
- FOUND RIGHT OF WAY MARKER
- N89°21'38"W 120.00' PROPOSED C/O OF CONSTRUCTION BEARING AND DISTANCE
- SAME OWNERSHIP
- EXISTING BUILDING

STAKING OF PROPOSED RIGHT OF WAY. SET 1/2 INCH METAL ROD WITH DIVISION OF HIGHWAY SURVEY MARKER TO MONUMENT THE POSITION SHOWN, IDENTIFIED BY INSCRIPTION DATA AND SURVEYORS REGISTRATION NUMBER. (PROPOSED RIGHT OF WAY CORNERS SET IN CULTIVATED AREAS SHALL BE A MINIMUM OF 20 INCHES BELOW THE GROUND SURFACES).

ALL DETAILS SHOWN NOT TO SCALE UNLESS OTHERWISE NOTED

STATE OF MISSOURI))
CITY OF ST. LOUIS))

I, RONNIE D. LOWE AN ILLINOIS PROFESSIONAL LAND SURVEYOR, CERTIFY THAT THIS PROFESSIONAL SERVICE CONFORMS TO THE CURRENT ILLINOIS MINIMUM STANDARDS FOR A BOUNDARY SURVEY FOR THE PROPOSED PARCEL(S) TO BE ACQUIRED BY THE STATE OF ILLINOIS, DEPARTMENT OF TRANSPORTATION, SHOWN HEREON.

DATED _____
RONNIE D. LOWE, PLS NO. 035-003363
LICENSE EXPIRATION DATE: 11/30/2010

DAVID MASON & ASSOCIATES Engineering Architecture Surveying
800 South Vandeventer Avenue
St. Louis, MO 63110
(314) 634-1030
ILLINOIS LICENCE NO: 184-000488
Expiration Date: April 30, 2011

ILLINOIS DEPARTMENT OF TRANSPORTATION
PLAT OF HIGHWAYS
FAP ROUTE 809 (IL 158)
SECTION (133,134) RS-5, 135 RS-6
MONROE AND ST. CLAIR COUNTY
JOB NO. R-98-008-03

STATION 671+00 TO STATION 677+75
SCALE: 1" = 20'
SHEET 72 OF 127

ILLINOIS DEPARTMENT OF TRANSPORTATION
DIVISION OF HIGHWAYS/DISTRICT 8
1102 EASTPORT PLAZA DRIVE
COLLINSVILLE, ILLINOIS 62234-6198
SHEET 1 IS A COVER SHEET

FIRST ADDITION TO FAIRLAWN TERRACE

PLAT BK.58/PG.27

FAIRLAWN TERRACE
1ST ADDITION

VILLAS OF FAIRLAWN
PLAT 2

SEE SHEET 66

AARON (50' W) DR.

UNIT 12

UNIT 11

UNIT 10

UNIT 9

UNIT 8

UNIT 7

UNIT 6

UNIT 5

UNIT 4

VILLAS OF FAIRLAWN
PLAT ONE

PLAT BK.106/PG.52
SEPTEMBER 12, 2005

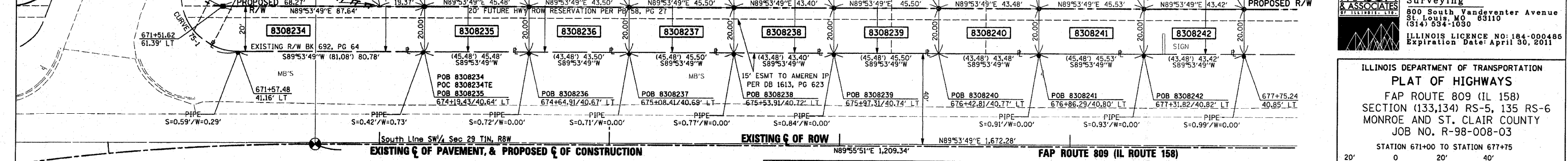

CURVE TABLE			
Curve	R	L	CB
CURVE-75-1	R=25.00'	L=(48.33')	CB=N34°44'03"W
CURVE-75-2	R=15.00'	L=28.99'	CB=S34°44'03"E