

F.A.P. RTE.	SECTION	COUNTY	TOTAL SHEETS	SHEET NO.
809	(133,134)RS-5,135RS-6	ST. CLAIR	762	246
STA. 388+00		TO STA. 403+00		
FED. ROAD DIST. NO. - ILLINOIS		FED. AID PROJECT		

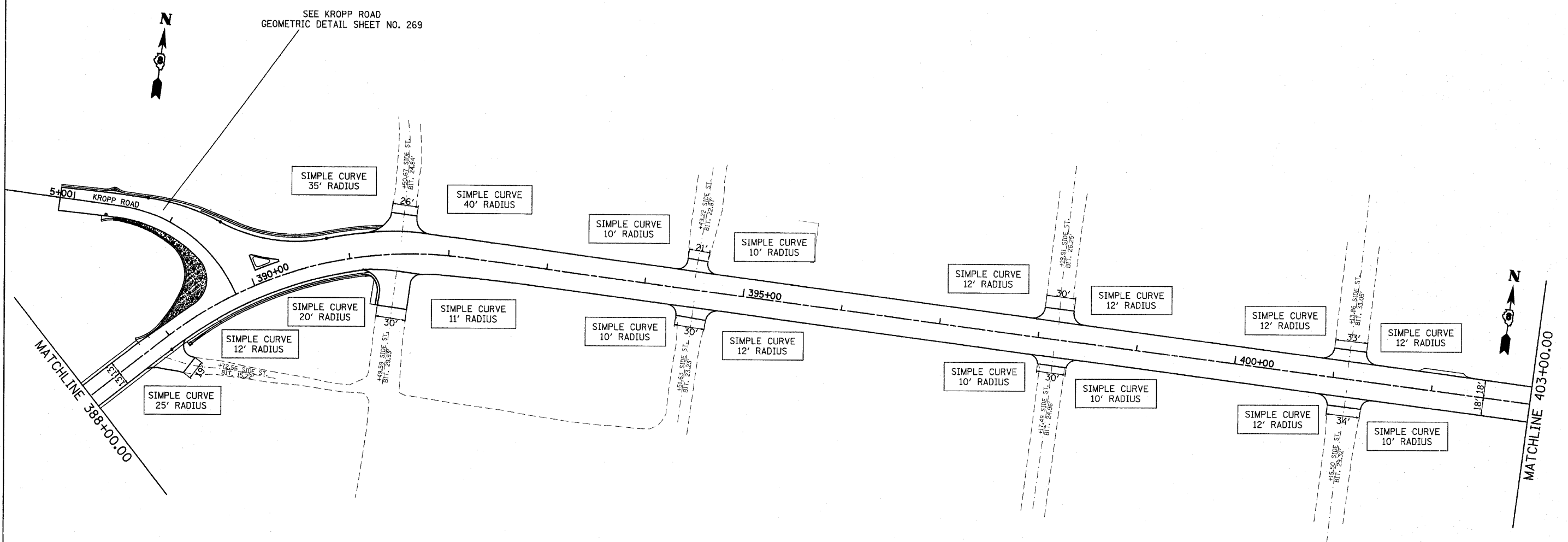

PROP. CURVE KP01-1
 PI STA. = 3+85.22
 $\Delta = 56^\circ 10' 51''$ (LT)
 $D = 38^\circ 11' 50''$
 $R = 150.00'$
 $T = 80.06'$
 $L = 147.08'$
 $E = 20.03'$
 $e = \text{---}$
 $T.R. = \text{---}$
 $S.E. \text{ RUN} = \text{---}$
 P.C. STA. = 3+05.16
 P.T. STA. = 4+52.24

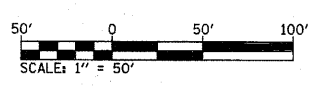

PLOT DATE = #DATE#
 FILE NAME = #FILE#
 PLOT SCALE = #SCALE#
 USER NAME = #USER#

REVISIONS	
NAME	DATE

ILLINOIS DEPARTMENT OF TRANSPORTATION
 GEOMETRIC DETAIL SHEETS
 FAP ROUTE 809 (IL RTE. 158)
 SECTION (133, 134)RS-5, 135RS-6
 ST. CLAIR COUNTY

SCALE: VERT. _____
 HORIZ. _____
 DATE _____

DRAWN BY _____
 CHECKED BY _____