

\D:\CONNS-98-MOTIFL.DGN, \D:\CONNS-98-ROBBERI.DGN, \D:\CONNS-98-SHT-TYPICAL.DGN, \D:\CONNS-98-LEADER.DGN, \D:\CONNS-98-DARLING ROAD.DGN, \D:\CONNS-98-MOTIFL.DGN
 6-23-2002, 14:33:43
 BONDHUJO, \IFS-004\AM VALL\LD-TRANS.97\2282\28868-001\CIVIL\0A\99 ALL CONTRACTS\CONNS\SHEETS CONTRACT 85\BONDUN-98-SHT-TYPICAL2.DGN

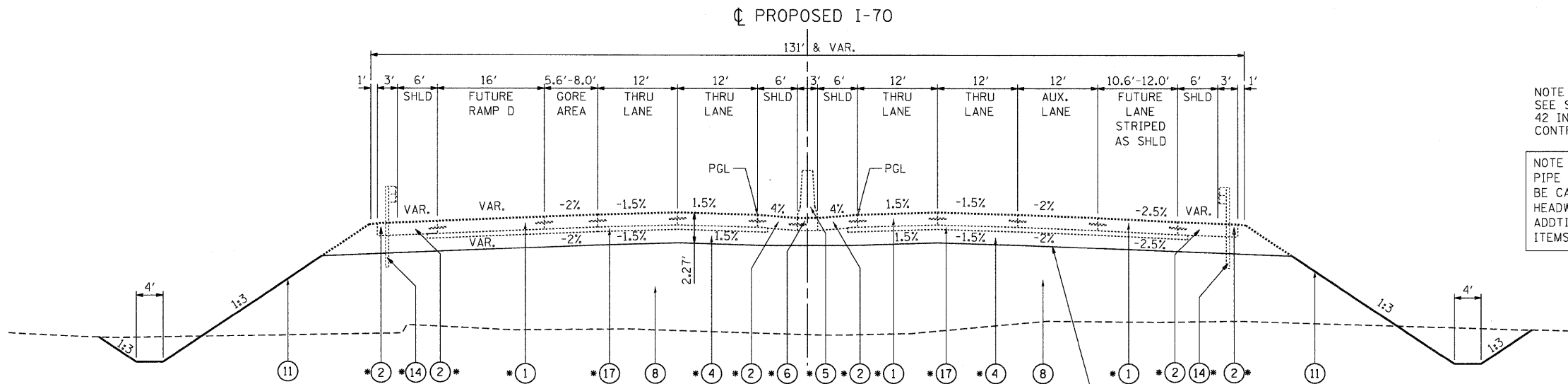

NOTE 1:
SEE SHEET 109 FOR ADDITIONAL CONCRETE BARRIER, DOUBLE FACE 42 INCH HEIGHT DETAILS. THIS DETAIL WILL BE INCLUDED IN FUTURE CONTRACT 76C43 AND IS PROVIDED FOR INFORMATION ONLY.

NOTE 2:
PIPE UNDERDRAINS USED TO OUTLET THE SAND DRAINAGE BLANKET SHALL BE CAPPED AT THE UPSTREAM END AND SHALL HAVE A CONCRETE HEADWALL FOR PIPE DRAINS AT THE EMBANKMENT SIDESLOPE. THE ADDITIONAL COST OF THE CAP SHALL BE INCLUDED IN THE UNDERDRAIN ITEMS, THE HEADWALLS SHALL BE PAID FOR SEPARATELY.

PROPOSED I-70 TYPICAL SECTION
 STA. 147+35.00 TO STA. 149+66.77
 SUPERELEVATION TRANSITION
 STA. 147+65.00 5.4% TO STA. 150+84.60 N.C.

- PROPOSED LEGEND** * = BY OTHERS
- * (1) PORTLAND CEMENT CONCRETE PAVEMENT 11 1/4" (JOINTED)
 - * (2) PORTLAND CEMENT CONCRETE SHOULDERS 11 1/4"
 - (3) M.S.E RETAINING WALL
 - (4) AGGREGATE SUBGRADE 12"
 - * (5) CONCRETE BARRIER, DOUBLE FACE, 42 INCH HEIGHT
 - * (6) CONCRETE BARRIER BASE
 - (7) AGGREGATE SURFACE COURSE, TYPE A, 12"
 - (8) EMBANKMENT
 - (9) HOT-MIX ASPHALT SHOULDERS, 6 1/2"
 - (10) SEEDING, CLASS 4A/MULCH, METHOD 2
 - (11) SEEDING, CLASS 7/FERTILIZER NUTRIENTS/MULCH, METHOD 2
 - (12) AGGREGATE SHOULDERS, TYPE A 6"
 - * (13) BARRIER WALL, MODOT, TYPE D AND MOMENT SLAB
 - (14) STEEL PLATE BEAM GUARD RAIL, TYPE A, 6 FOOT POSTS
 - (15) CHAIN LINK FENCE, 6'
 - (16) HOT-MIX ASPHALT PAVEMENT (FULL-DEPTH), 6 1/2"
 - * (17) STABILIZED SUBBASE - HOT-MIX ASPHALT, 4"
 - (18) SAND DRAINAGE BLANKET
 - (19) STEEL PLATE BEAM GUARD RAIL, TYPE B (SPECIAL)
 - * (20) CURB - STD. 610001

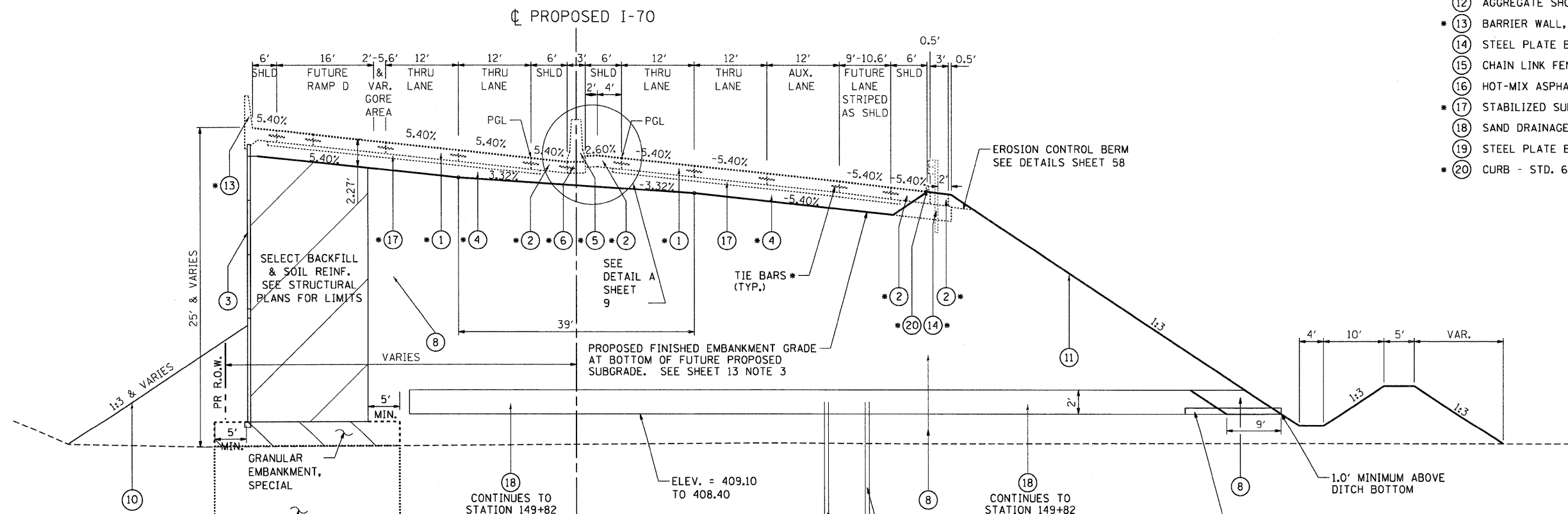

PROPOSED I-70 TYPICAL SECTION
 STA. 144+85.29 TO STA. 147+35.00

CONTRACTOR DESIGNED GROUND IMPROVEMENT, SEE SHEET 224.

SEE SHEET 44 FOR WICK DRAIN LAYOUT AND CONFIGURATION

FILE NAME = #FILEL#		DESIGNED - JB	REVISED -	STATE OF ILLINOIS DEPARTMENT OF TRANSPORTATION		PROPOSED I-70 TYPICAL SECTIONS 2			F.A.P. RTE.	SECTION	COUNTY	TOTAL SHEETS	SHEET NO.
USER NAME = #USER#		DRAWN - JB	REVISED -						998	82-2-1HV2	ST. CLAIR	285	10
PLOT SCALE = #SCALE#		CHECKED - ACL	REVISED -	I-70 CONNECTION		SCALE: N.T.S. SHEET NO. OF SHEETS STA. TO STA.			CONTRACT NO. 76C44				
PLOT DATE = #DATE#		DATE - 06/04/10	REVISED -						FED. ROAD DIST. NO. ILLINOIS FED. AID PROJECT				

