

\\\\DBCONN-05-MOTIFL.DGN, \\DBCONN-05-LEGEND.DGN, \\DBCONN-05-SHT-REMOVAL-123000.DGN, \\DBCONN-05-RDREPR.DGN, \\DBCONN-05-LEGEND.DGN, \\DBCONN-05-SHT-REMOVAL-123000.DGN, \\VFS-0044.VAM.VAULT.D -TRANS.07.2202.28869-001.CIVIL.CAD\\99 ALL CONTRACTS\\CONN SHEETS CONTRACT 85ADBCONN-05-SHT-REMOVAL-123000.DGN

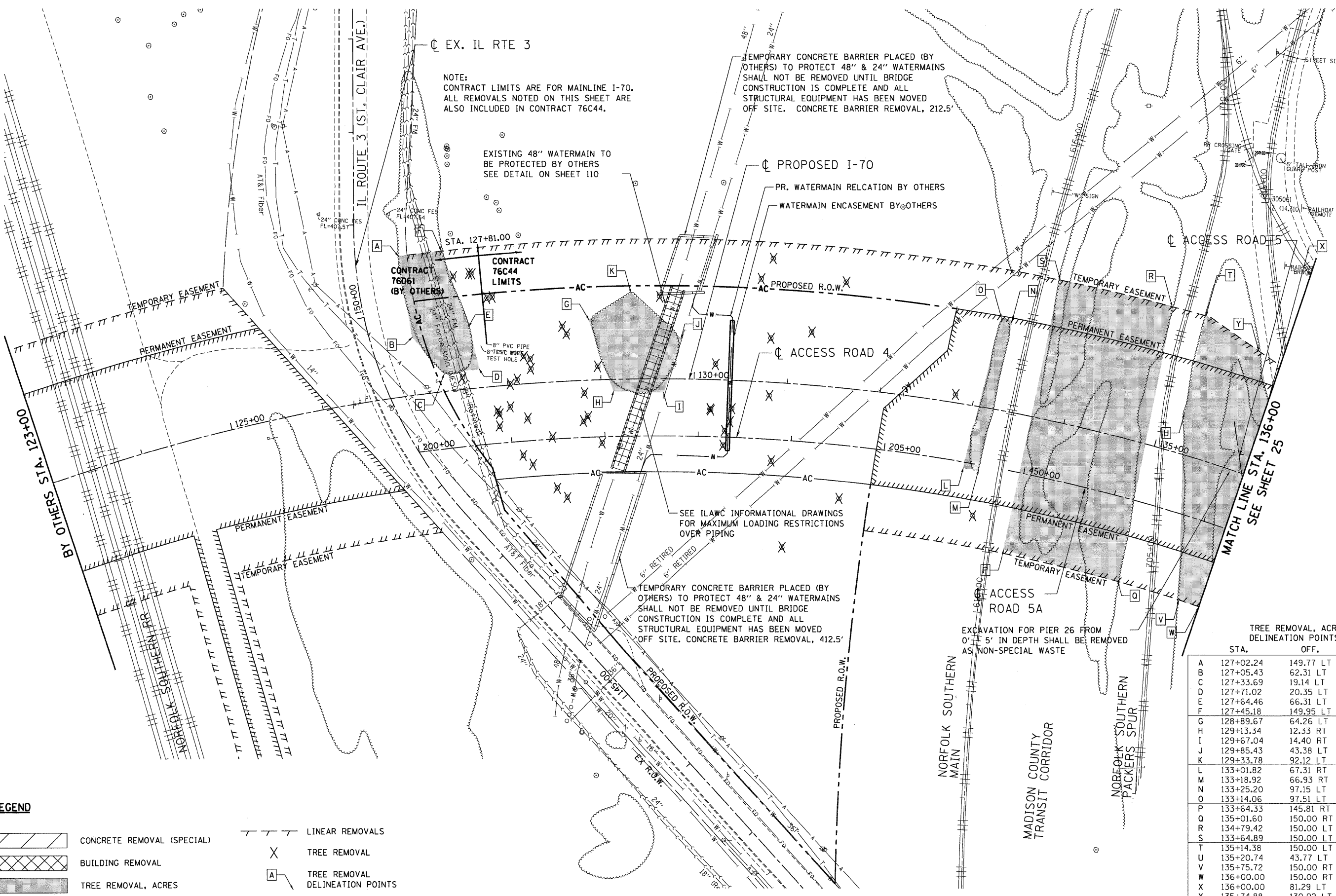

NOTE:
CONTRACT LIMITS ARE FOR MAINLINE I-70.
ALL REMOVALS NOTED ON THIS SHEET ARE ALSO INCLUDED IN CONTRACT 76C44.

TEMPORARY CONCRETE BARRIER PLACED (BY OTHERS) TO PROTECT 48" & 24" WATERMANS SHALL NOT BE REMOVED UNTIL BRIDGE CONSTRUCTION IS COMPLETE AND ALL STRUCTURAL EQUIPMENT HAS BEEN MOVED OFF SITE. CONCRETE BARRIER REMOVAL, 212.5'

EXISTING 48" WATERMAIN TO BE PROTECTED BY OTHERS SEE DETAIL ON SHEET 110

CONTRACT 76D61 (BY OTHERS)
CONTRACT 76C44 LIMITS

PROPOSED I-70
PR. WATERMAIN RELICATION BY OTHERS
WATERMAIN ENCASEMENT BY OTHERS

PROPOSED R.O.W.

ACCESS ROAD 4

SEE ILAWC INFORMATIONAL DRAWINGS FOR MAXIMUM LOADING RESTRICTIONS OVER PIPING

TEMPORARY CONCRETE BARRIER PLACED (BY OTHERS) TO PROTECT 48" & 24" WATERMANS SHALL NOT BE REMOVED UNTIL BRIDGE CONSTRUCTION IS COMPLETE AND ALL STRUCTURAL EQUIPMENT HAS BEEN MOVED OFF SITE. CONCRETE BARRIER REMOVAL, 412.5'

EXCAVATION FOR PIER 26 FROM 0' TO 5' IN DEPTH SHALL BE REMOVED AS NON-SPECIAL WASTE

MATCH LINE STA. 136+00
SEE SHEET 25

LEGEND

- CONCRETE REMOVAL (SPECIAL)
- BUILDING REMOVAL
- TREE REMOVAL, ACRES
- LINEAR REMOVALS
- TREE REMOVAL
- TREE REMOVAL DELINEATION POINTS

TREE REMOVAL, ACRES DELINEATION POINTS		AREA (ACRE)
STA.	OFF.	
A	127+02.24	149.77 LT
B	127+05.43	62.31 LT
C	127+33.69	19.14 LT
D	127+71.02	20.35 LT
E	127+64.46	66.31 LT
F	127+45.18	149.95 LT
G	128+89.67	64.26 LT
H	129+13.34	12.33 RT
I	129+67.04	14.40 RT
J	129+85.43	43.38 LT
K	129+33.78	92.12 LT
L	133+01.82	67.31 RT
M	133+18.92	66.93 RT
N	133+25.20	97.15 LT
O	133+14.06	97.51 LT
P	133+64.33	145.81 RT
Q	135+01.60	150.00 RT
R	134+79.42	150.00 LT
S	133+64.89	150.00 LT
T	135+14.38	150.00 LT
U	135+20.74	43.77 LT
V	135+75.72	150.00 RT
W	136+00.00	150.00 RT
X	136+00.00	81.29 LT
Y	135+74.88	130.92 LT

TENG logo and company information: TENG & ASSOCIATES, INC. ENGINEERS/ARCHITECTS/PLANNERS CHICAGO, ILLINOIS

FILE NAME =	USER NAME = #USER#	DESIGNED - JB	REVISED -
#FILEL#		DRAWN - JB	REVISED -
PLOT SCALE = #SCALE#		CHECKED - ACL	REVISED -
PLOT DATE = #DATE#		DATE - 06/04/10	REVISED -

STATE OF ILLINOIS
DEPARTMENT OF TRANSPORTATION
I-70 CONNECTION

PROPOSED I-70
EXISTING PLAN & REMOVALS
STA. 123 + 00 TO STA. 136 + 00
SCALE: 1"=50'
SHEET NO. OF SHEETS STA. TO STA.

F.A.P. RTE.	SECTION	COUNTY	TOTAL SHEETS	SHEET NO.
998	82-2-1HVB	ST. CLAIR	285	24
FED. ROAD DIST. NO.		ILLINOIS FED. AID PROJECT		
		CONTRACT NO. 76C44		