

MATCH LINE "A"  
SEE SHEET 27

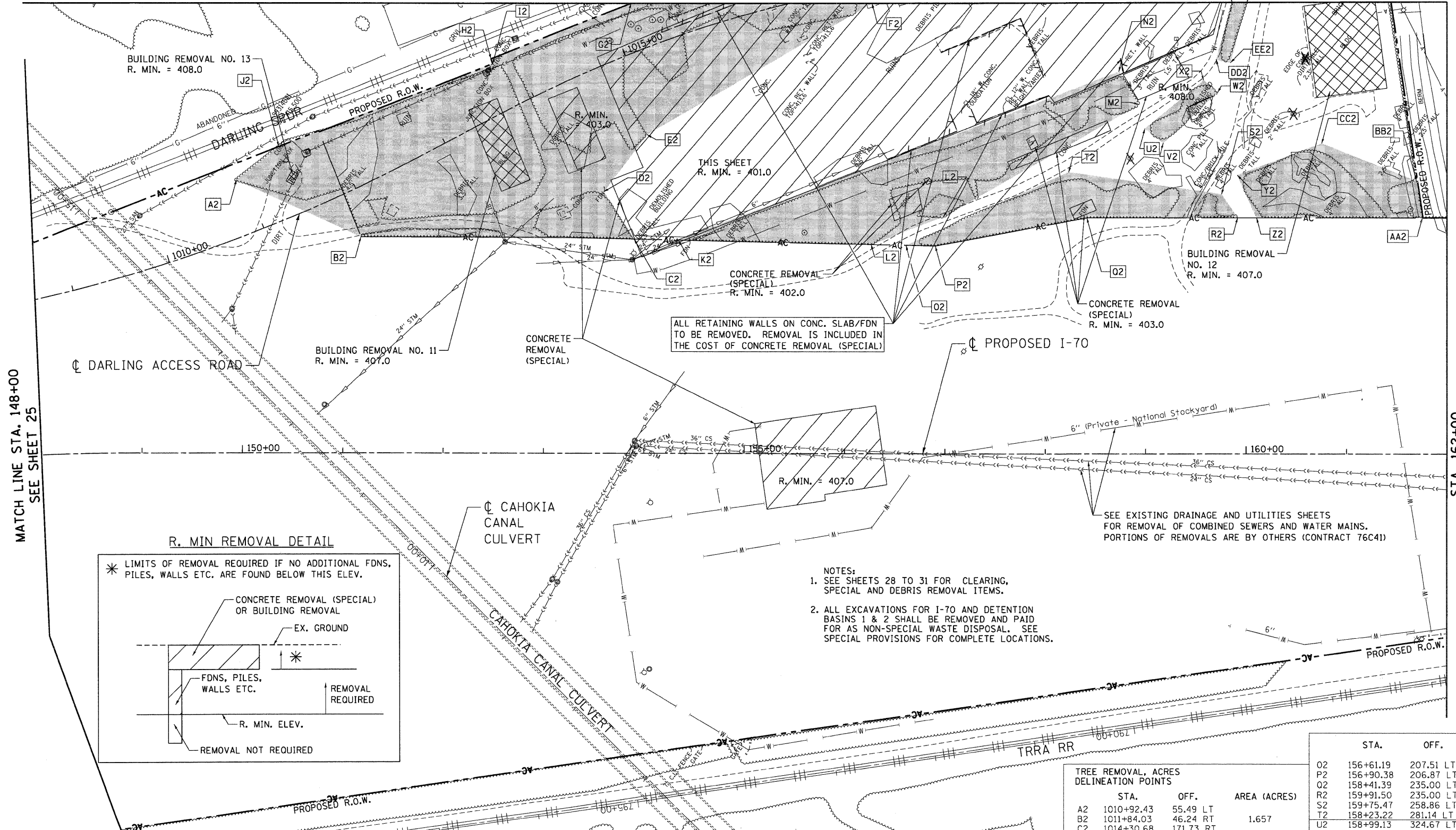
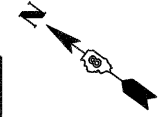

ALL RETAINING WALLS ON CONC. SLAB/FDN TO BE REMOVED. REMOVAL IS INCLUDED IN THE COST OF CONCRETE REMOVAL (SPECIAL)

SEE EXISTING DRAINAGE AND UTILITIES SHEETS FOR REMOVAL OF COMBINED SEWERS AND WATER MAINS. PORTIONS OF REMOVALS ARE BY OTHERS (CONTRACT 76C41)

R. MIN REMOVAL DETAIL

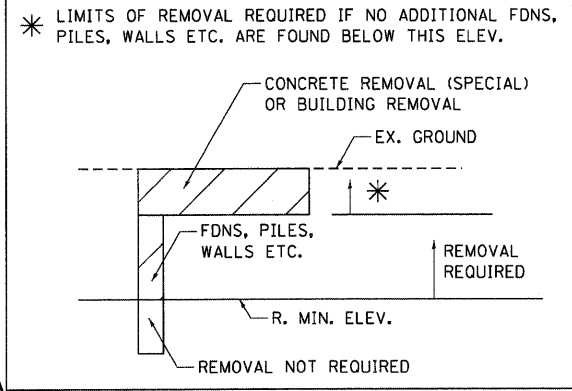

- NOTES:
- SEE SHEETS 28 TO 31 FOR CLEARING, SPECIAL AND DEBRIS REMOVAL ITEMS.
  - ALL EXCAVATIONS FOR I-70 AND DETENTION BASINS 1 & 2 SHALL BE REMOVED AND PAID FOR AS NON-SPECIAL WASTE DISPOSAL. SEE SPECIAL PROVISIONS FOR COMPLETE LOCATIONS.

LEGEND

- CONCRETE REMOVAL (SPECIAL)
- BUILDING REMOVAL
- TREE REMOVAL, ACRES
- LINEAR REMOVALS
- TREE REMOVAL
- TREE REMOVAL DELINEATION POINTS

R. MIN. = X. ANY FOUNDATIONS, PILES OR WALLS ASSOCIATED WITH THIS REMOVAL ITEM WITHIN PROPOSED RIGHT OF WAY SHALL BE REMOVED TO THIS MINIMUM DEPTH AS SPECIFIED. SEE DETAIL ON THIS SHEET.

TREE REMOVAL, ACRES DELINEATION POINTS		
STA.	OFF.	AREA (ACRES)
A2	1010+92.43	55.49 LT
B2	1011+84.03	46.24 RT
C2	1014+30.68	171.73 RT
D2	1014+22.59	115.76 RT
E2	1014+90.46	80.39 RT
F2	1017+52.16	17.85 RT
G2	1015+23.51	46.57 LT
H2	1013+78.99	52.70 LT
I2	1013+78.51	47.72 LT
J2	1011+46.54	70.21 LT
K2	154+34.30	212.60 LT
L2	156+26.51	208.27 LT
M2	158+93.08	348.72 LT
N2	158+73.14	381.50 LT
		1.657

STA.	OFF.	AREA (ACRES)
O2	156+61.19	207.51 LT
P2	156+90.38	206.87 LT
Q2	158+41.39	235.00 LT
R2	159+91.50	235.00 LT
S2	159+75.47	258.86 LT
T2	158+23.22	281.14 LT
U2	158+99.13	324.67 LT
V2	159+18.04	311.01 LT
W2	159+71.49	360.75 LT
X2	159+57.59	372.66 LT
Y2	159+91.16	277.93 LT
Z2	160+10.35	235.00 LT
AA2	161+75.50	235.00 LT
BB2	161+69.64	272.04 LT
CC2	160+75.27	310.00 LT
DD2	159+70.14	393.44 LT
EE2	159+84.31	390.10 LT
FF2	160+00.82	449.68 LT
GG2	159+86.09	449.66 LT
		0.223
		0.351
		0.228
		0.02

FILE NAME = #FILEL#  
 TENG & ASSOCIATES, INC.  
 ENGINEERS/ARCHITECTS/PLANNERS  
 CHICAGO, ILLINOIS

USER NAME = #USER#  
 PLOT SCALE = #SCALE#  
 PLOT DATE = #DATE#

DESIGNED - JB  
 DRAWN - JB  
 CHECKED - ACL  
 DATE - 06/04/10

REVISED -  
 REVISED -  
 REVISED -  
 REVISED -

STATE OF ILLINOIS  
 DEPARTMENT OF TRANSPORTATION  
 I-70 CONNECTION

PROPOSED I-70  
 EXISTING PLAN & REMOVALS  
 STA. 148 + 00 TO STA. 162 + 00  
 SCALE: 1"=50'  
 SHEET NO. OF SHEETS STA. TO STA.

F.A.P. RTE.	SECTION	COUNTY	TOTAL SHEETS	SHEET NO.
998	82-2-1HVB	ST. CLAIR	285	26

CONTRACT NO. 76C44  
 FED. ROAD DIST. NO. ILLINOIS FED. AID PROJECT