

MATCH LINE "A"
SEE SHEET 49

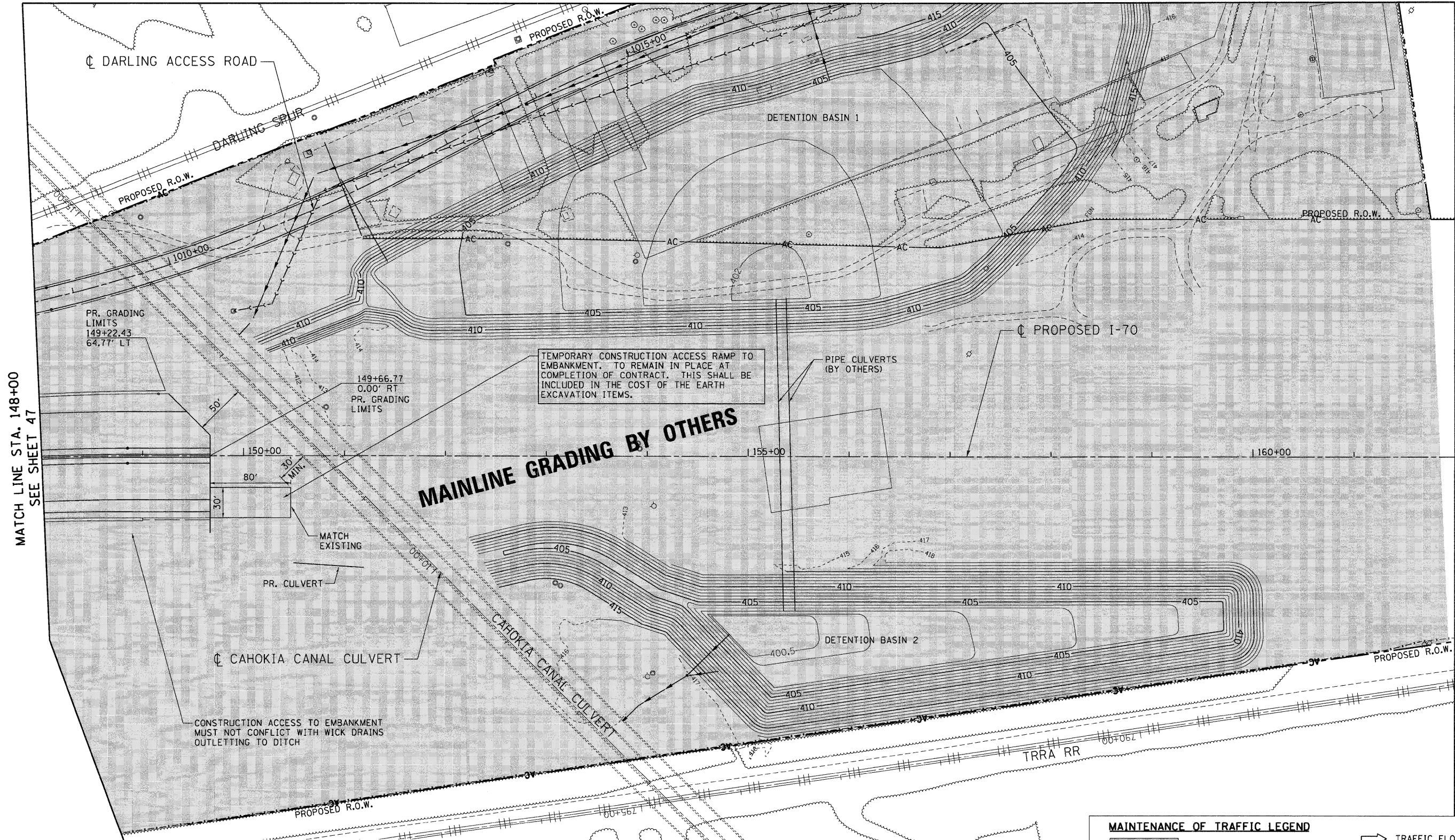
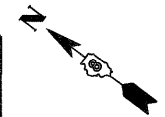

MATCH LINE STA. 148+00
SEE SHEET 47

STA. 162+00 (BY OTHERS)

TEMPORARY CONSTRUCTION ACCESS RAMP TO EMBANKMENT. TO REMAIN IN PLACE AT COMPLETION OF CONTRACT. THIS SHALL BE INCLUDED IN THE COST OF THE EARTH EXCAVATION ITEMS.

PIPE CULVERTS (BY OTHERS)

MAINLINE GRADING BY OTHERS

MATCH EXISTING

CONSTRUCTION ACCESS TO EMBANKMENT MUST NOT CONFLICT WITH WICK DRAINS OUTLETTING TO DITCH

MAINTENANCE OF TRAFFIC LEGEND

- WORK AREA / CONSTRUCTION LIMITS
- EXISTING SIGN
- PROPOSED SIGN
- TRAFFIC CONTROL SIGN
- TRAFFIC FLOW
- BARRICADE, TYPE III
- BARRICADES, TYPE II W/ FLASHING LIGHTS
- TYPE II BARRICADES OR DRUMS W/ STEADY BURNING LIGHT
- FLAGGER WITH TRAFFIC CONTROL SIGN

\BDC\NN-99-MOTIF.LDN, \BDC\NN-95-LEGN.LDN, \BDC\NN-95-MOTIF.LDN, \BDC\NN-95-PLN1-14800.LDN, \BDC\NN-95-MOTIF.LDN, \BDC\NN-95-STAGN.LDN
 6-23-2010, 14:20:13 BONDHLD \VFS-2044\AMVAULT.D - TRANS_07-2202-28965-001\CL\VAL\CAD\91 ALL CONTRACTS\CONNSHEETS CONTRACT 05\BDC\NN-95-SHT-STAGE1-14800.LDN

FILE NAME: #FILEL#
TENG TENG & ASSOCIATES, INC.
 ENGINEERS/ARCHITECTS/PLANNERS
 CHICAGO, ILLINOIS

USER NAME = #USER#
 PLOT SCALE = #SCALE#
 PLOT DATE = #DATE#

DESIGNED - JB
 DRAWN - JB
 CHECKED - ACL
 DATE - 06/04/10

REVISED -
 REVISED -
 REVISED -
 REVISED -

STATE OF ILLINOIS
DEPARTMENT OF TRANSPORTATION
 I-70 CONNECTION

PROPOSED I-70
SUGGESTED STAGING, MAINTENANCE OF TRAFFIC
STA. 148 + 00 TO STA. 162 + 00
 SCALE: 1"=50' SHEET NO. OF SHEETS STA. TO STA.

F.A.P. RTE.	SECTION	COUNTY	TOTAL SHEETS	SHEET NO.
998	82-2-1HVB	ST. CLAIR	285	48
FED. ROAD DIST. NO. ILLINOIS FED. AID PROJECT			CONTRACT NO. 76C44	