

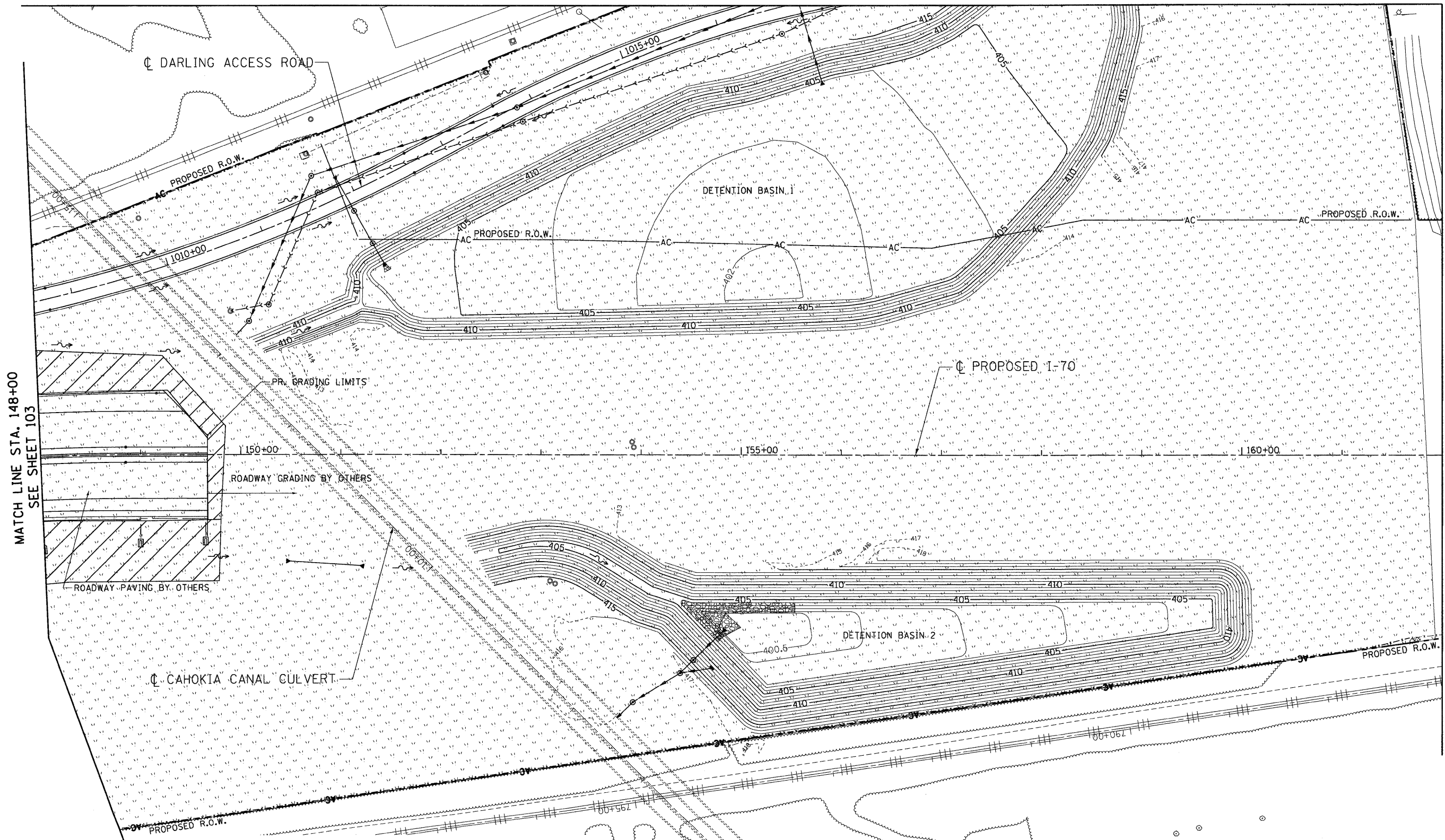

MATCH LINE "A"
SEE SHEET 105

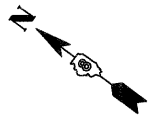
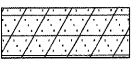

MATCH LINE STA. 148+00
SEE SHEET 103

STA. 162+00
BY OTHERS

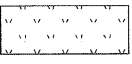
-  SEEDING, CLASS 4A
(LOW PROFILE NATIVE GRASS)
MULCH, METHOD 2
-  EROSION CONTROL BLANKET
(MULCH NOT REQUIRED)
-  SEEDING, CLASS 7
(TEMPORARY TURF COVER MIXTURE)
NITROGEN, PHOSPHOROUS, AND POTASSIUM
FERTILIZER NUTRIENTS (90 LBS/ACRE EACH)
MULCH, METHOD 2

NOTE:
CLASS 7 SEEDING MAY BE
OMITTED IN AREAS WHERE
SUBSEQUENT CONTRACTS
BEGIN CONSTRUCTION

FILE NAME =
#FILE#

TENG TENG & ASSOCIATES, INC.
ENGINEERS/ARCHITECTS/PLANNERS
CHICAGO, ILLINOIS

USER NAME = #USER#

PLOT SCALE = #SCALE#

PLOT DATE = #DATE#

| | |
|-----------------|-----------|
| DESIGNED - JB | REVISED - |
| DRAWN - JB | REVISED - |
| CHECKED - ACL | REVISED - |
| DATE - 06/04/10 | REVISED - |

STATE OF ILLINOIS
DEPARTMENT OF TRANSPORTATION
I-70 CONNECTION

PROPOSED I-70
LANDSCAPING PLANS
STA. 148 + 00 TO STA. 162 + 00

SCALE: 1"=50'
SHEET NO. OF SHEETS STA. TO STA.

| F.A.P. RTE. | SECTION | COUNTY | TOTAL SHEETS | SHEET NO. |
|-----------------------------------------------|-----------|-----------|--------------------|-----------|
| 998 | 82-2-1HVB | ST. CLAIR | 285 | 104 |
| FED. ROAD DIST. NO. ILLINOIS FED. AID PROJECT | | | CONTRACT NO. 76C44 | |

\D:\CONTRACTS\05-06\BORDERLINE\05-06\CONTRACT\05-06\LEGEND.DWG, \D:\CONTRACTS\05-06\MOTIF.DWG, \D:\CONTRACTS\05-06\LEGEND.DWG, \D:\CONTRACTS\05-06\TRANS.07\2202\20868-201\CIVIL\CAD\99, ALL CONTRACTS\CONNS\SHEETS CONTRACT 05-06\CONNS-05-SHT-LANDSCAP-14800.DWG, \D:\CONTRACTS\05-06\BORDERLINE\05-06\CONTRACT\05-06\LEGEND.DWG, \D:\CONTRACTS\05-06\MOTIF.DWG, \D:\CONTRACTS\05-06\LEGEND.DWG, \D:\CONTRACTS\05-06\TRANS.07\2202\20868-201\CIVIL\CAD\99, ALL CONTRACTS\CONNS\SHEETS CONTRACT 05-06\CONNS-05-SHT-LANDSCAP-14800.DWG