

INSIDE ELEVATION OF SOUTH BARRIER CURB (WB I-70)
Looking South

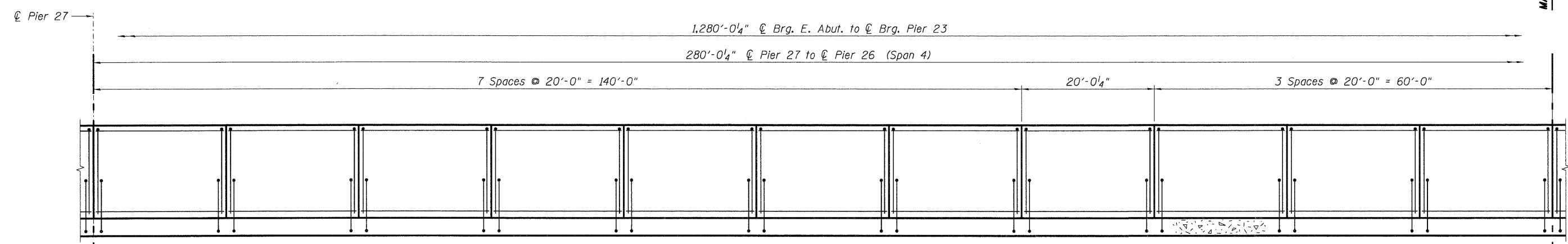

INSIDE ELEVATION OF SOUTH BARRIER CURB (WB I-70)
Looking South

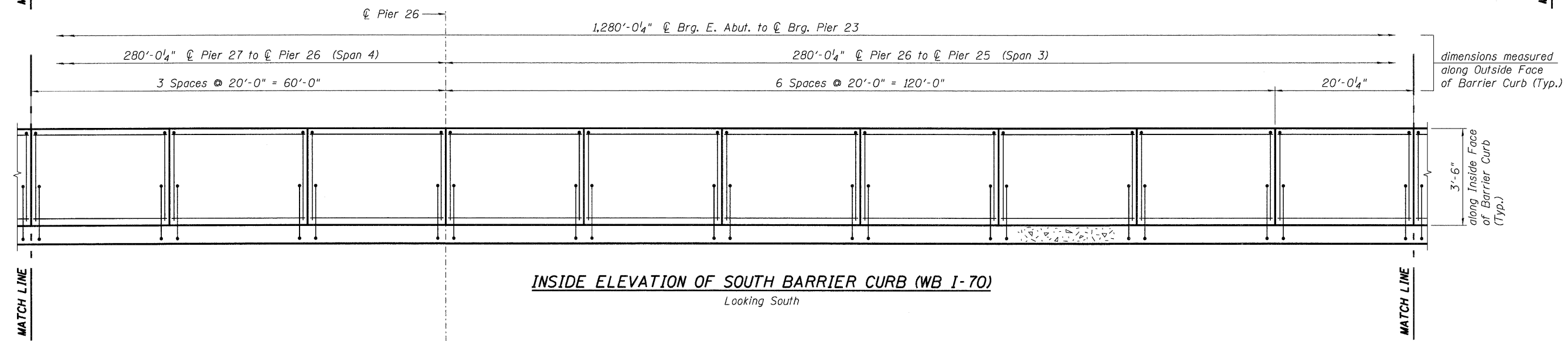

INSIDE ELEVATION OF SOUTH BARRIER CURB (WB I-70)
Looking South

NOTE:
See Sht. S-39 for Notes.

\0820318-CONN-05-001-SUDDN... \0820318-CONN-99-001-90JDN... \0820318-CONN-05-001-SUDDN... \0820318-CONN-05-104-SHT-SUDDN...
 BONDHUJO \175-2044\AM VALLT.D-TRANS... \175-2044\AM VALLT.D-TRANS... \175-2044\AM VALLT.D-TRANS... \175-2044\AM VALLT.D-TRANS...

FILE NAME =	USER NAME = #USER#	DESIGNED - JLR	REVISED -	STATE OF ILLINOIS DEPARTMENT OF TRANSPORTATION I-70 CONNECTION OVER NS, TRRA, MCT AND INDUSTRIAL DR.	PARAPET ELEVATIONS WB I-70 3 OF 4			F.A.P. RTE.	SECTION	COUNTY	TOTAL SHEETS	SHEET NO.
#FILE#		DRAWN - FD	REVISED -		998	82-2-IHVB	ST. CLAIR	285	150			
PLOT SCALE = #SCALE#		CHECKED - TCU	REVISED -		SN 082-0318 (EB) & 0319 (WB)	CONTRACT NO. 76C44						
PLOT DATE = #DATE#		DATE - 06/04/10	REVISED -		SCALE:	SHEET NO. S-40 OF S-111	STA. 134+22.00 TO STA.	FED. ROAD DIST. NO.	ILLINOIS FED. AID PROJECT			

