

.\\06220318-CONN-05-001-FF.DGN, .\\06220318-CONN-99-001-BO.DGN, .\\06220318-CONN-05-ALIGNMENT2.DGN
 6-03-2010, 10:46:13
 BONDHILLD \\FS-004\AMV\VAULT\TRANS.07\2202\28868-021\STRUCT\CAD\01 DESIGN\06220318-CONN-05-001-FF.DGN

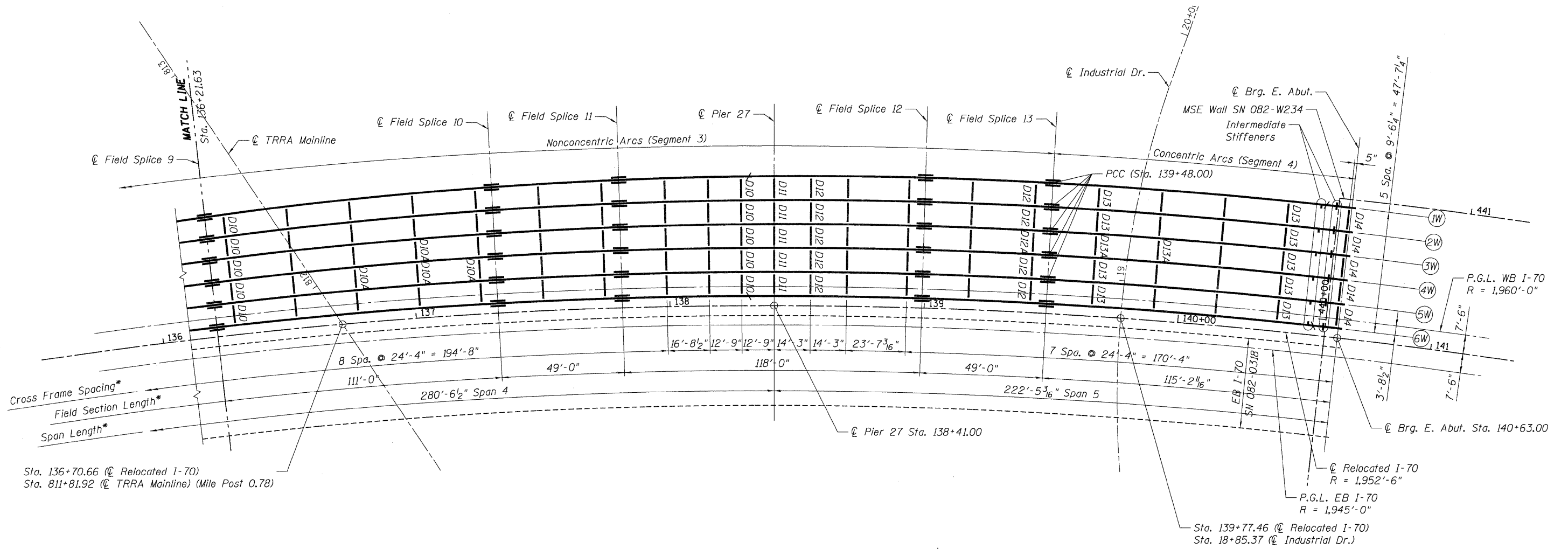

FRAMING PLAN
WB I-70 SN 082-0319

* Dimensions measured along centerline Girder 6W

NOTE:
Work this sheet with Sheets S-51 and S-52.

FILE NAME =	USER NAME = *USER#	DESIGNED - CCE	REVISED -	STATE OF ILLINOIS DEPARTMENT OF TRANSPORTATION I-70 CONNECTION OVER NS, TRRA, MCT AND INDUSTRIAL DR.	FRAMING PLAN WB I-70 3 OF 3		F.A.P. RTE.	SECTION	COUNTY	TOTAL SHEETS	SHEET NO.	
*FILEL#		DRAWN - CCE	REVISED -		SCALE:	SHEET NO. S-53 OF S-111	STA. 134+22.00 TO STA.	998	82-2-1HVB	ST. CLAIR	285	163
	PLOT SCALE = *SCALE#	CHECKED - TCU	REVISED -					SN 082-0318 (EB) & 0319 (WB)		CONTRACT NO. 76C44		
	PLOT DATE = *DATE#	DATE - 06/04/10	REVISED -					FED. ROAD DIST. NO.		[ILLINOIS] FED. AID PROJECT		

