

STATE OF ILLINOIS
DEPARTMENT OF TRANSPORTATION

Bench Mark: Chiseled "□" on S.E. wingwall of S.N. 073-0016. Elevation 448.11.

Existing Structure: S.N. 073-0016. Built in 1927 as S.B.I. Route 154, Section 108-B at station 232+00 as a single span reinforced concrete slab bridge on timber pile supported closed abutments. The structure was rehabilitated in 1986 under F.A.P. 841, Section (108-108X)RS-1 with a concrete wearing surface and railing replacement. 28'-0" bk. to bk. abutments, 42'-2" out to out deck. Traffic to be maintained utilizing stage construction.

No salvage

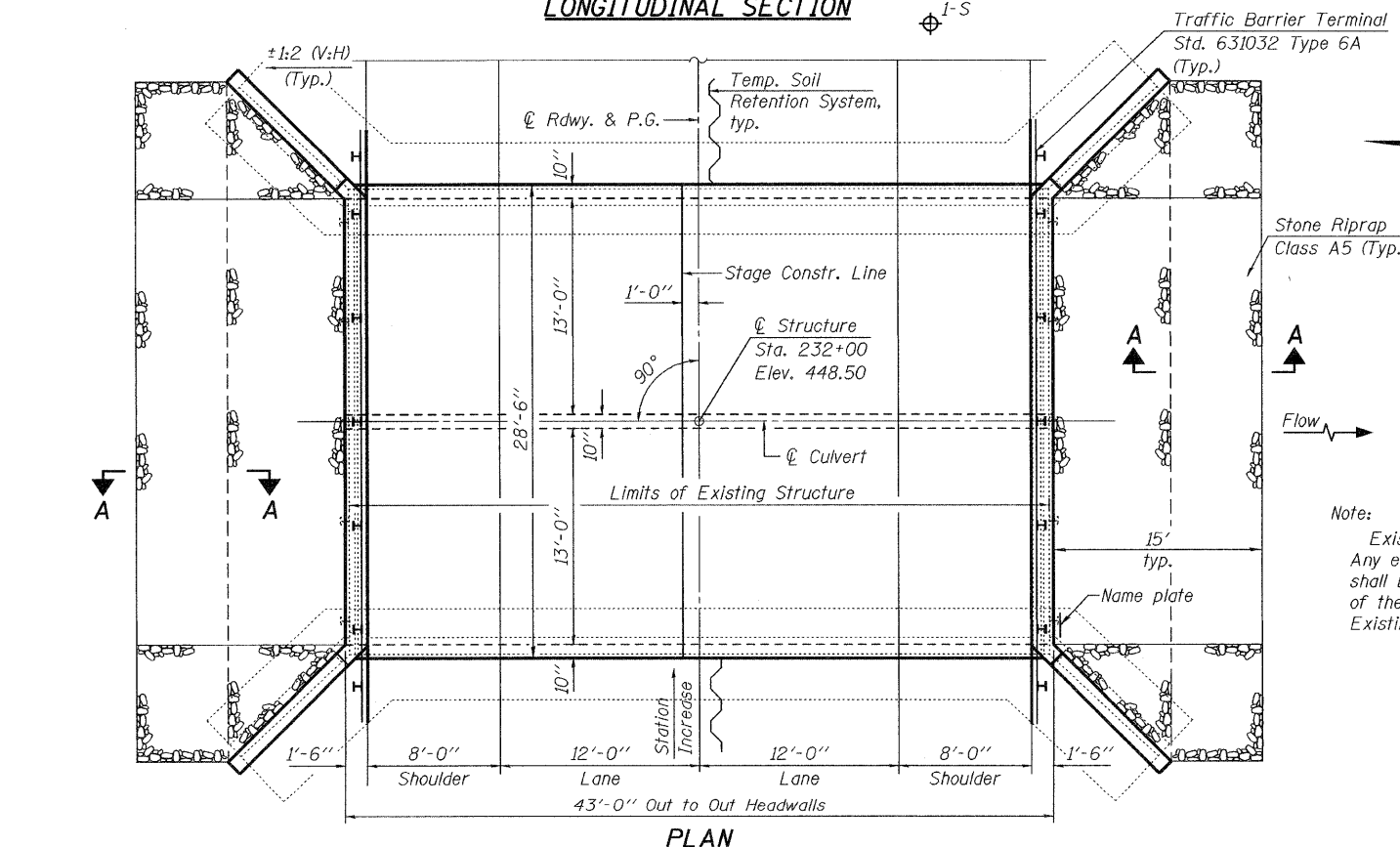
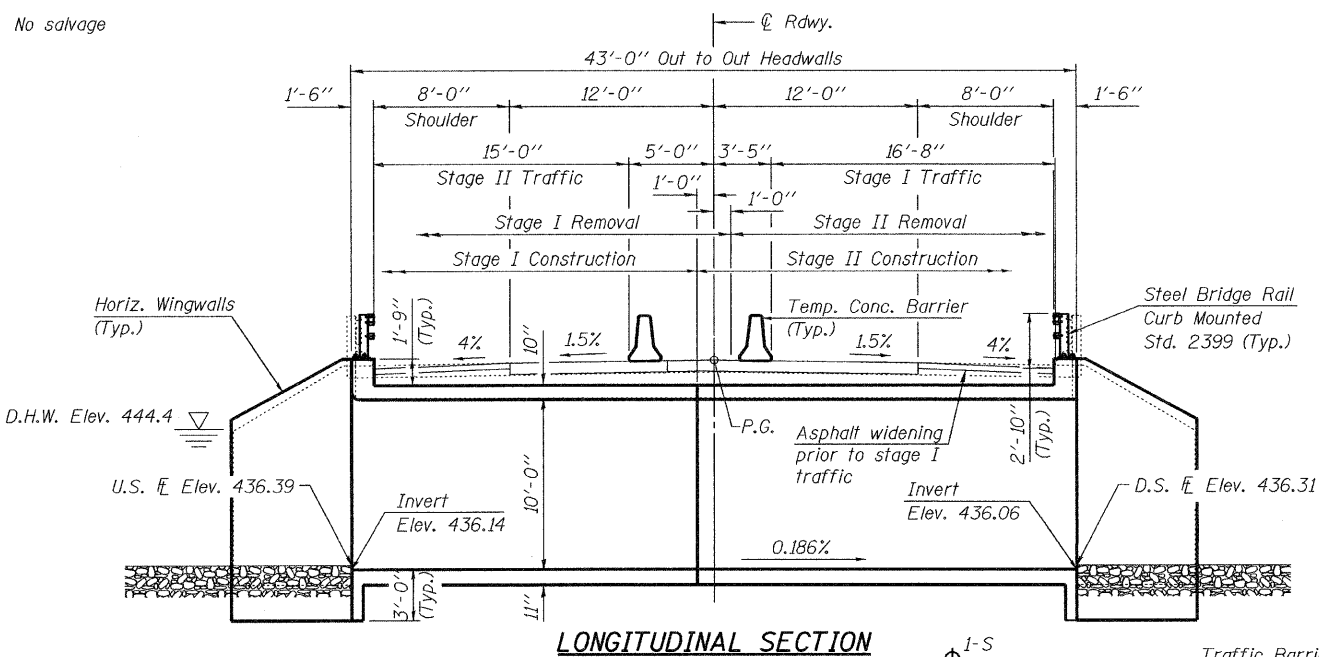

- INDEX OF SHEETS**
- 1 General Plan & Elevation
 - 2 Stage Construction Details & Temporary Soil Retention System
 - 3 Temporary Concrete Barrier for Stage Construction
 - 4 Steel Railing, Type 2399
 - 5-7 Culvert Details
 - 8 Bar Splicer Assembly Details
 - 9 Soil Boring Logs

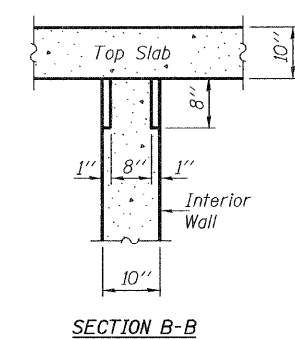
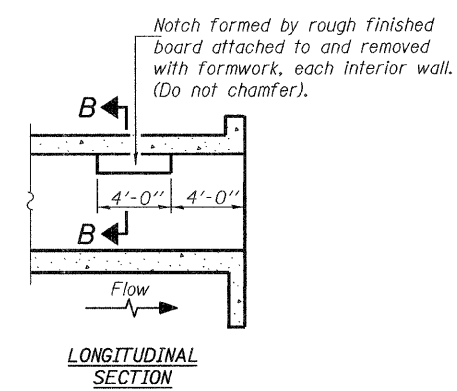

**PHOEBE NESTING
SITE DETAILS
(Downstream End Only)**

Note:
Existing footings shall be completely removed. Any existing piles within the limits of the culvert shall be cut a minimum 1'-0" below the bottom of the culvert. Cost included with Removal of Existing Structures.

DESIGN SCOUR ELEVATION TABLE

Design Scour Elevation (ft.)	U.S. Invert	D.S. Invert
	433.14	433.06

WATERWAY INFORMATION

Drainage Area = 3.34 mi² Exist. Low Grade Elev. 448.48 @ Sta. 232+50
Prop. Low Grade Elev. 448.71 @ Sta. 232+50

Flood	Freq. Yr.	Q C.F.S.	Opening Sq. Ft. Exist.	Opening Sq. Ft. Prop.	Nat. H.W.E.	Head - Ft. Exist.	Head - Ft. Prop.	Headwater El. Exist.	Headwater El. Prop.
Design	50	1690	150.2	204.4	444.0	1.2	0.3	445.2	444.3
Base	100	1980	173.6	227.8	444.4	3.0	1.3	447.4	445.7
Overtopping (E)		1920	184.0	238.2	445.3	3.4	1.7	448.7	447.0
Overtopping (P)		2500	181.4	253.8	445.2	3.4	2.7	448.6	448.6

GENERAL NOTES

Reinforcement bars shall conform to the requirements of ASTM A 706 Gr 60. See Special Provisions.
Reinforcement bars designated (E) shall be epoxy coated.
Layout of slope protection system may be varied in the field to suit ground conditions as directed by the Engineer.
Excavation behind existing abutment walls shall be performed to balance front and back soil pressure before removing the existing superstructure. The Contractor shall sawcut the upper portion of the existing abutment at the stage removal line before Stage I removal to ensure the remaining portion will not be prematurely damaged.
Precast alternate is not allowed.

TOTAL BILL OF MATERIAL

ITEM	UNIT	TOTAL
Stone Riprap, Class A5	Sq. Yd.	134
Filter Fabric	Sq. Yd.	134
Removal of Existing Structures	Each	1
Reinforcement Bars, Epoxy Coated	Pound	35150
Bar Splicers	Each	174
Steel Railing, Type 2399	Foot	57
Temporary Soil Retention System	Sq. Ft.	288
Name Plates	Each	1
Concrete Box Culverts	Cu. Yd.	163.1

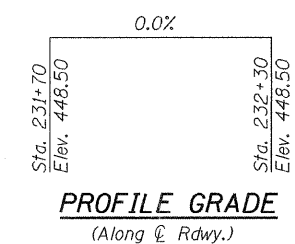

LOADING HS20-44
Allow 50#/sq. ft. for future wearing surface.

DESIGN SPECIFICATIONS
2002 AASHTO

DESIGN STRESSES
FIELD UNITS

f'c = 3,500 psi
fy = 60,000 psi (Reinforcement)

STATION 232+00
BUILT 20 BY
STATE OF ILLINOIS
F.A.P. RTE. 841 SEC. 108B-1
LOADING HS20-44
STRUCTURE NO. 073-2007

NAME PLATE
See Std. 515001

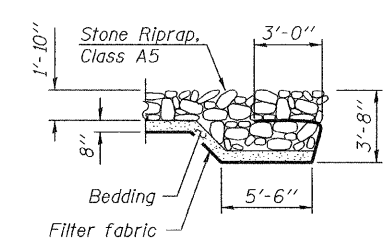

SECTION A-A

GENERAL PLAN & ELEVATION
IL RTE. 154 OVER PANTHER CREEK
F.A.P. 841 - SEC. 108B-1
PERRY COUNTY
STATION 232+00
STRUCTURE NO. 073-2007

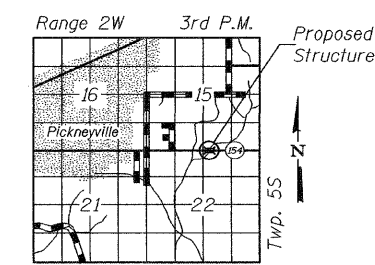

LOCATION SKETCH

DESIGNED *Jay D. Edwards*
CHECKED *Michael D. Rebe*
DRAWN *h.t. duong*
CHECKED *JDE/MDR*

EXAMINED *Thomas J. Demagalibi*
PASSED *Ralph E. Anderson*



EXPIRES 11-30-2010

SHEET NO. 1	F.A.P. RTE.	SECTION	COUNTY	TOTAL SHEETS	SHEET NO.
9 SHEETS	841	108B-1	PERRY	27	19
FED. ROAD DIST. NO. _			ILLINOIS FED. AID PROJECT		