

F.A.U. ROUTE	SECTION	COUNTY	TOTAL SHEETS	SHEET NUMBER
N/A	09-0002-00-SW	ST. CLAIR	8	4
STA. 10+17.29		TO	STA. 14+28.03	
FEDERAL AID PROJECT			CONTRACT 97449	

ALL EXCAVATION AND TRENCH BACKFILL NECESSARY TO COMPLETE STORM SEWER CONSTRUCTION SHALL BE INCLUDED IN THE COST OF THAT ITEM. TRENCH BACKFILL SHALL CONSIST OF EITHER CA-6 OR CA-7 AND SHALL EXTEND TO THE SURFACE OF THE ROAD.

- LEGEND**
- TREE
 - SHRUB
 - ◇ SAPLING
 - MAILBOX
 - STORM INLET
 - CULVERT
 - TELEPHONE PEDESTAL
 - CABLE TV PEDESTAL
 - ELECTRIC PEDESTAL
 - GAS VALVE
 - SIGN
 - STREET SIGN
 - ROADWAY/TRAFFIC SIGN
 - POWER POLE
 - GUY WIRE
 - WATER METER
 - WATER VALVE
 - WARNING POST
 - FENCE
 - SWALE FLOWLINE
 - EDGE OF PAVEMENT
 - OVERHEAD ELECTRIC
 - UNDERGROUND ELECTRIC
 - UNDERGROUND FIBER OPTIC
 - UNDERGROUND TELEPHONE
 - UNDERGROUND GAS MAIN
 - WATER MAIN
 - SANITARY SEWER

NOTE: ALL EXCAVATION AND EMBANKMENT NECESSARY TO COMPLETE THE IMPROVEMENTS AS SHOWN IN THE DRAWINGS AND AS DIRECTED BY THE ENGINEER SHALL BE INCLUDED IN THE COST OF THE CONTRACT.

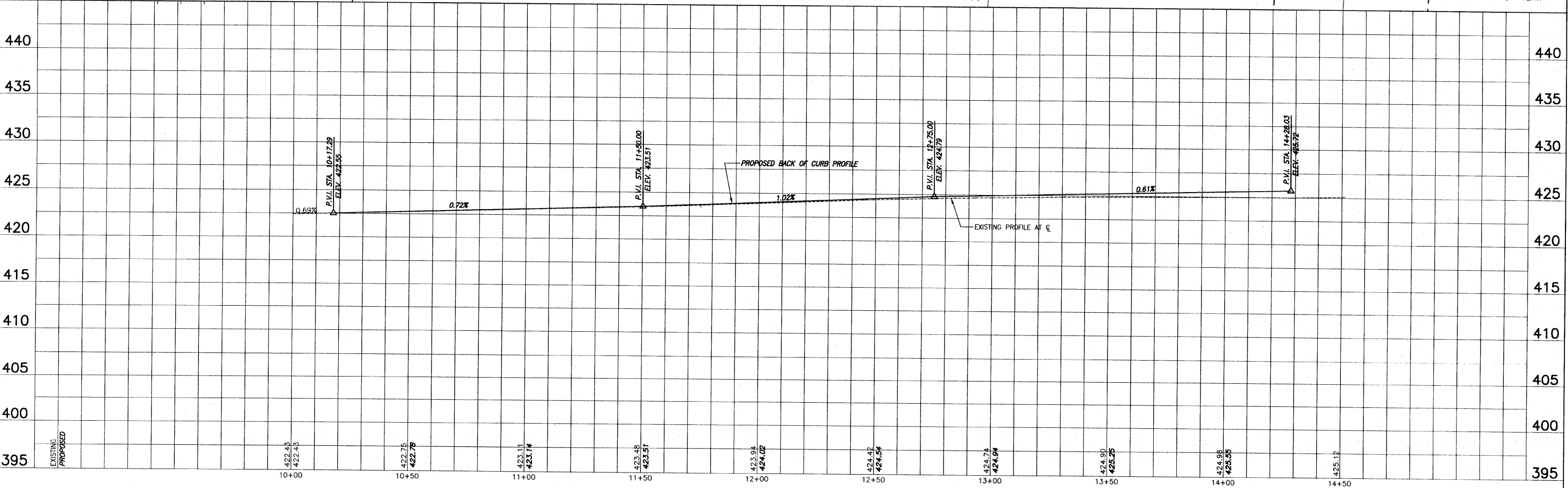

ROADWAY PLAN AND PROFILE SRTS / HANFT STREET IMPROVEMENTS
SECTION 09-0002-00-SW ST. CLAIR COUNTY, ILLINOIS