

FOR INDEX OF SHEETS, SEE SHEET NO. 2

**PLAN SHEET ARRANGEMENT**

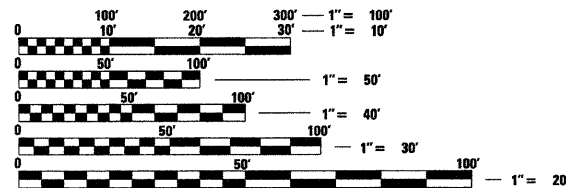
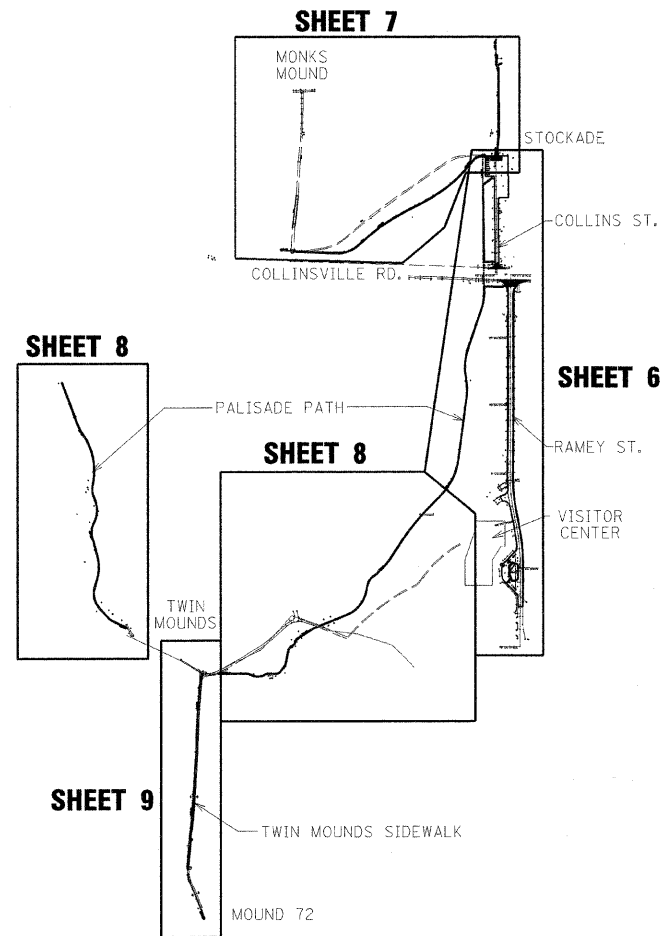

FULL SIZE PLANS HAVE BEEN PREPARED USING STANDARD ENGINEERING SCALES. REDUCED SIZED PLANS WILL NOT CONFORM TO STANDARD SCALES. IN MAKING MEASUREMENTS ON REDUCED PLANS, THE ABOVE SCALES MAY BE USED.

J.U.L.I.E.  
JOINT UTILITY LOCATION INFORMATION FOR EXCAVATION  
1-800-892-0123  
OR 811

**PROJECT ENGINEER  
PROJECT MANAGER**

**CONTRACT NO. 46060**

**STATE OF ILLINOIS  
DEPARTMENT OF TRANSPORTATION  
DIVISION OF HIGHWAYS**

**PROPOSED  
HIGHWAY PLANS**

**IDOT / IHPA STATEWIDE  
CAHOKIA MOUNDS ST HIST SITE  
PARKING AND SIDEWALK IMPROVEMENTS  
ST. CLAIR COUNTY  
C-30-046-09**

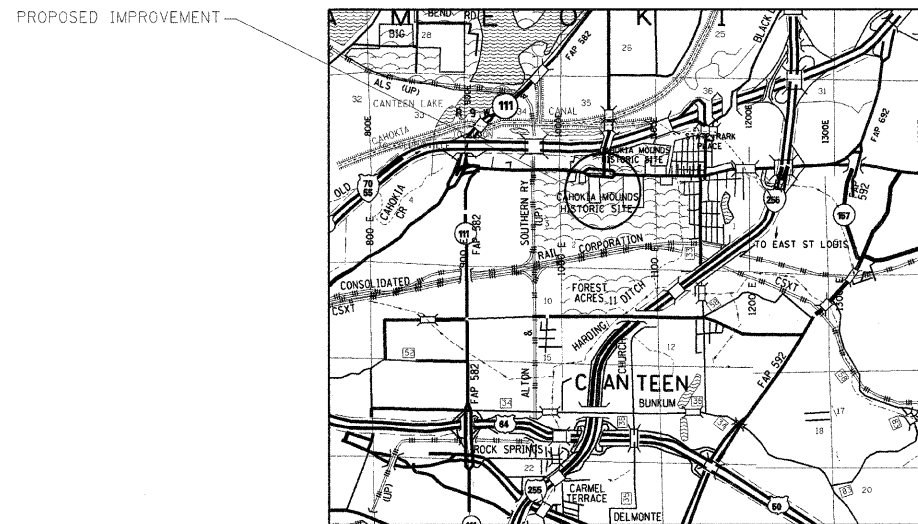

ROBERT H. DALL  
062,021,112  
PROFESSIONAL  
ENGINEER  
OF  
ILLINOIS  
5/8/09

|                     |          |                    |              |           |
|---------------------|----------|--------------------|--------------|-----------|
| F.A. RTE.           | SECTION  | COUNTY             | TOTAL SHEETS | SHEET NO. |
|                     |          | ST. CLAIR          | 12           | 1         |
| FED. ROAD DIST. NO. | ILLINOIS | CONTRACT NO. 46060 |              |           |

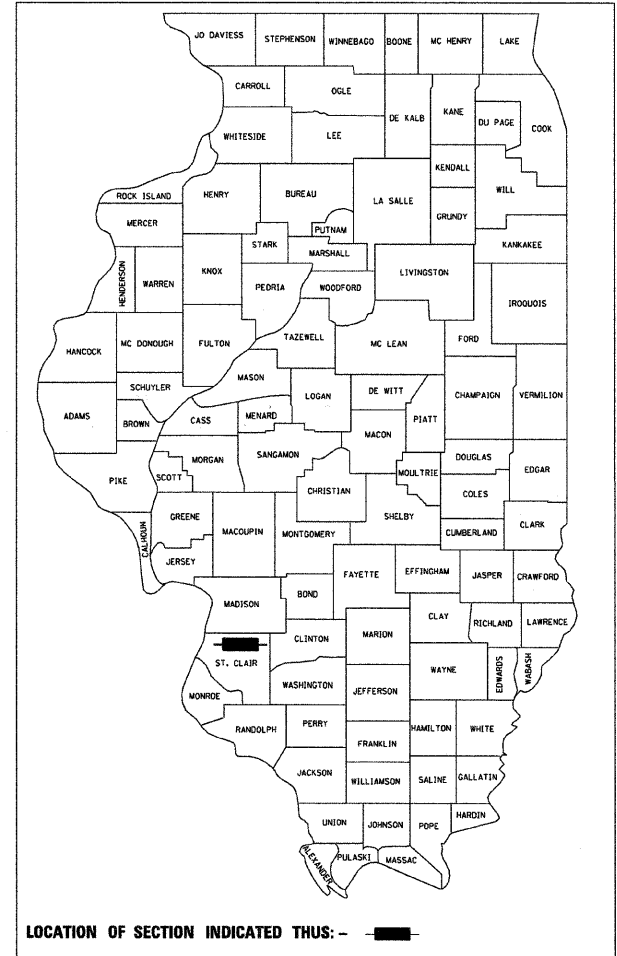

STATE OF ILLINOIS  
DEPARTMENT OF TRANSPORTATION  
DIVISION OF HIGHWAYS

SUBMITTED June 26, 2009  
Eric E. Harris  
DEPUTY DIRECTOR OF HIGHWAYS, REGION ENGINEER

June 26, 2009  
Charles J. Invernizzi  
ENGINEER OF DESIGN AND ENVIRONMENT

June 26, 2009  
Christine M. Reed  
DIRECTOR OF HIGHWAYS, CHIEF ENGINEER

**PRINTED BY THE AUTHORITY  
OF THE STATE OF ILLINOIS**

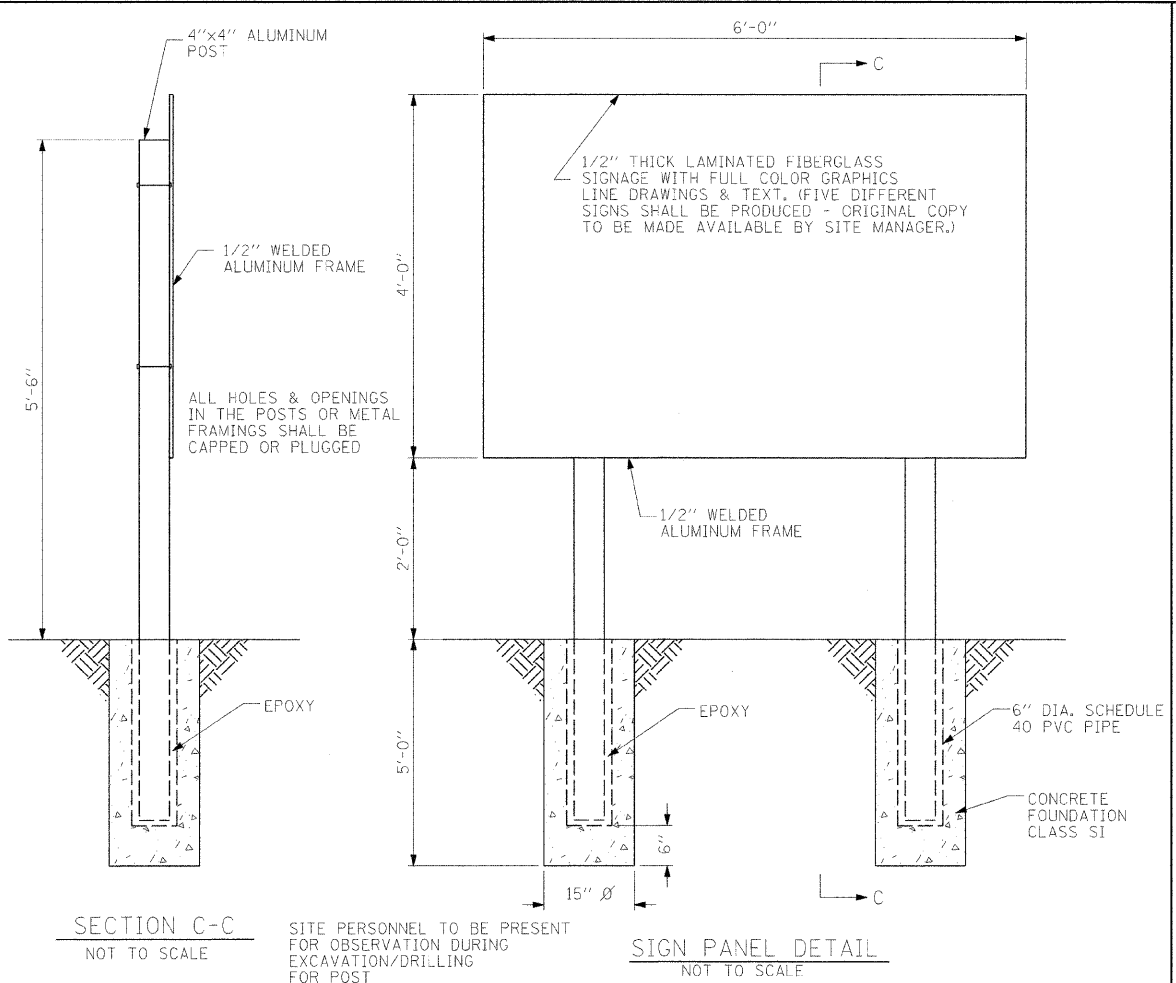

### LIST OF STANDARDS

|           |   |
|-----------|---|
| 280001-04 | TEMPORARY EROSION CONTROL SYSTEM                              |
| 424001-05 | CURB RAMPS FOR SIDEWALKS                                      |
| 420701-02 | PAVEMENT FABRIC   |
| 542301-02 | PRECAST REINFORCED CONCRETE FLARED END SECTION                |
| 602301-02 | INLET TYPE A  |
| 602306-02 | INLET TYPE B  |
| 602401-02 | MANHOLE TYPE A  |
| 602601-02 | PRECAST REINFORCED CONCRETE FLAT SLAB TOP                     |
| 604006-04 | FRAME AND GRATE TYPE 3  |
| 606001-04 | CONCRETE CURB TYPE B AND COMBINATION CONCRETE CURB AND GUTTER |
| 701001-02 | OFF-ROAD OPERATIONS, 2L, 2W, MORE THAN 15' AWAY               |
| 701006-03 | OFF-ROAD OPERATIONS, 2L, 2W, 15' TO 24" FROM PAVEMENT EDGE    |
| 701011-02 | OFF-ROAD, MOVING OPERATIONS, 2L, 2W, DAY ONLY                 |
| 701301-03 | LANE CLOSURE, 2L, 2W, SHORT TIME OPERATIONS                   |
| 701311-03 | LANE CLOSURE, 2L, 2W, MOVING OPERATIONS DAY ONLY              |
| 701501-05 | URBAN LANE CLOSURE, 2L, 2W, UNDIVIDED                         |
| 701901-01 | TRAFFIC CONTROL DEVICES                                       |
| 780001-02 | TYPICAL PAVEMENT MARKINGS                                     |

### MIXES AND APPLICATION RATE TABLES

| MIXTURES USE(S): | BITUMINOUS BINDER  | BITUMINOUS SURFACE |
|------------------|--------------------|--------------------|
| AC/PG            | PG 64-22           | PG 64-22           |
| RAP% (MAX)       | 15%                | 10%                |
| DESIGN AIR VOIDS | 4.0% @ N DESIGN 70 | 4.0% @ N DESIGN 70 |
| MIX COMP         | IL 19.0            | IL 9.5             |
| FRICITION AGG.   | MIX B              | MIX D              |

| PRIME APPLICATION RATES |                |
|-------------------------|----------------|
| BIT MATLS PR CT         | AGG PRIME COAT |
| 0.375 GAL/ SQ YD        | 5 LB/ SQ YD    |

### INDEX OF SHEETS

| SHEET NO. | SHEET TITLE  |
|-----------|--|
| 1         | COVER SHEET  |
| 2         | INDEX OF SHEETS, LIST OF STANDARDS, DETAILS, AND GENERAL NOTES |
| 3         | SUMMARY/SCHEDULE OF QUANTITIES                                 |
| 4         | SCHEDULE OF QUANTITIES   |
| 5         | TYPICAL SECTIONS   |
| 6         | RAMEY AND COLLINS ST PLAN VIEW AND PALASADE AGGREGATE PATH     |
| 7         | MONKS MOUND & WALL SIDEWALK                                    |
| 8         | PALASADE AGGREGATE PATH  |
| 9         | TWIN MOUNDS SIDEWALK   |
| 10        | SIDEWALK PROFILES  |
| 11        | HANDICAP PARKING SPACE AND CONCRETE SLAB DETAILS               |
| 12        | FLAGPOLE DETAILS   |

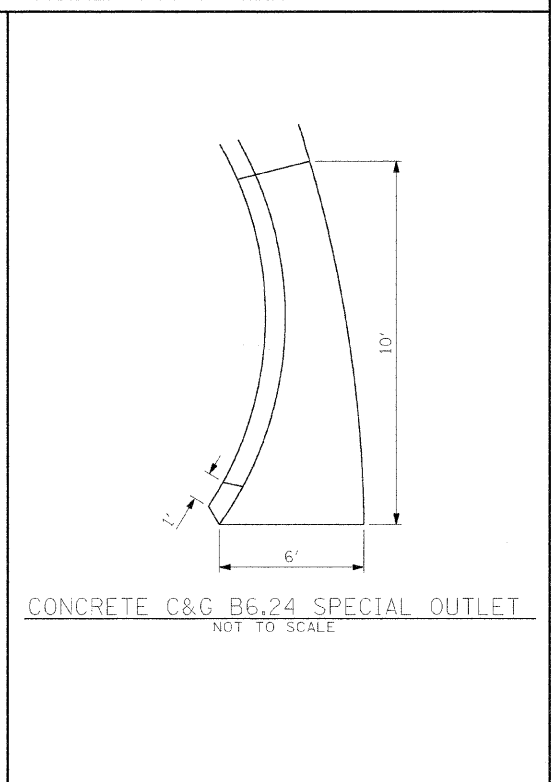
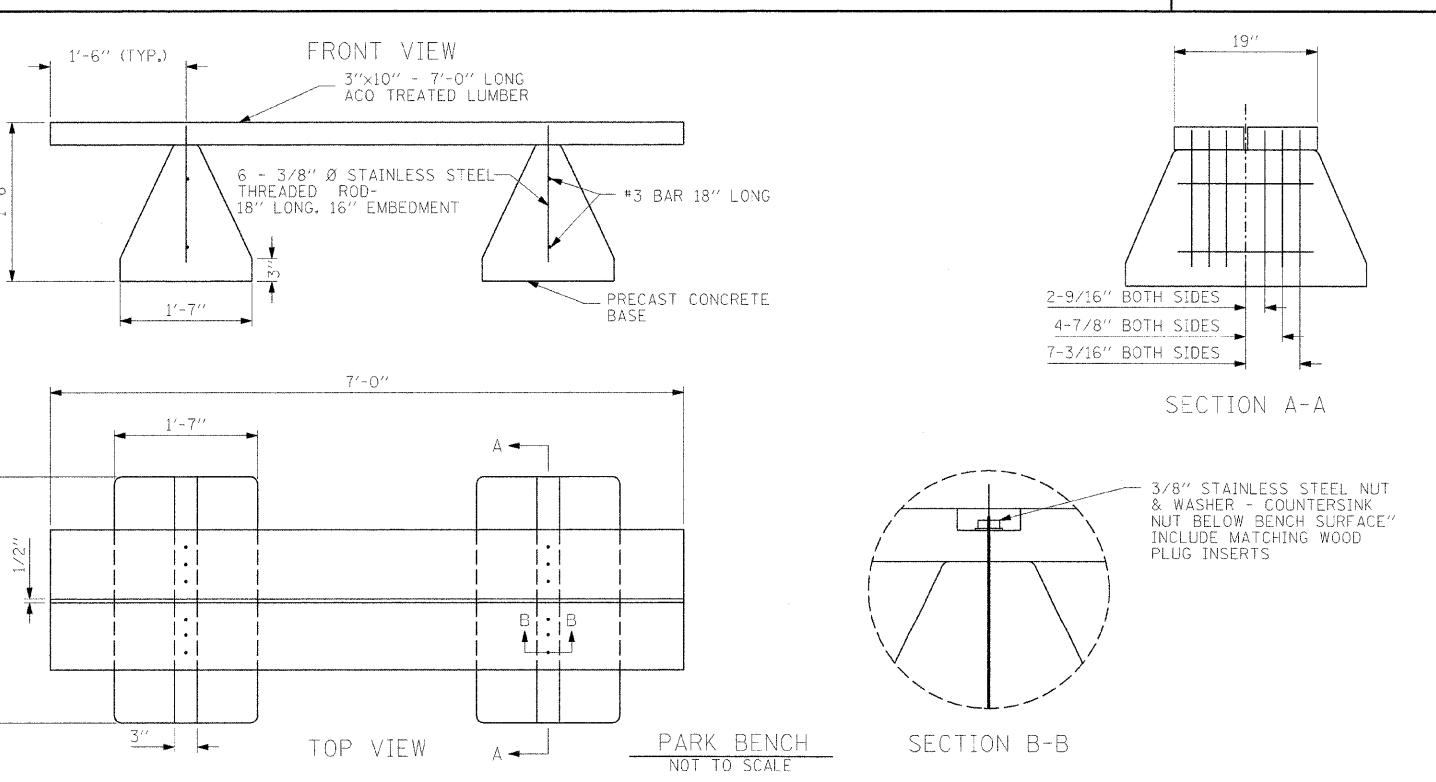
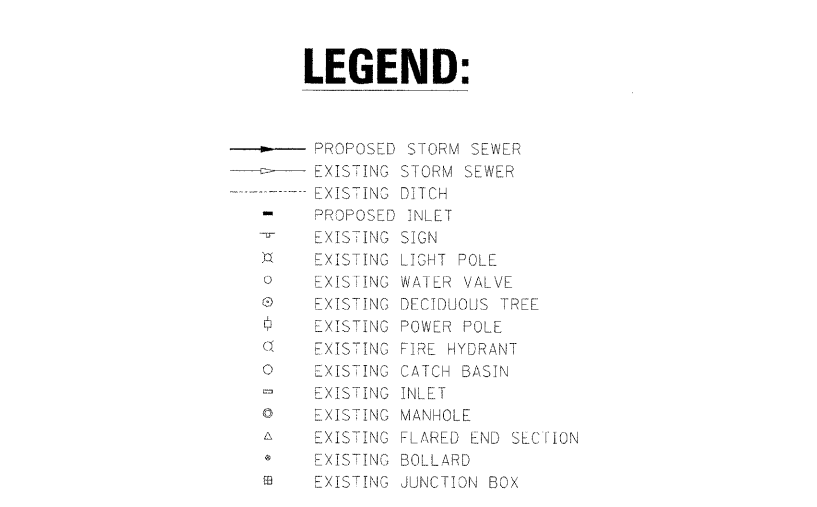

- ### GENERAL NOTES
- ALL ELEVATIONS ARE REFERENCED TO ELEVATIONS ESTABLISHED BY VASCONCELLES ENGINEERING CORP.
  - WHERE SECTION OR SUBSECTION MONUMENTS ARE ENCOUNTERED, THE ENGINEER SHALL BE NOTIFIED BEFORE SUCH MONUMENTS ARE REMOVED. THE CONTRACTOR SHALL PROTECT AND CAREFULLY PRESERVE ALL PROPERTY MARKERS AND MONUMENTS UNTIL THE OWNER AND AUTHORIZED SURVEYOR OR AGENT HAS WITNESSED OR OTHERWISE REFERENCED THEIR LOCATION. IF THE ENGINEER DECIDES TO HAVE THE CONTRACTOR RESET THE MONUMENT, THIS WORK WILL BE PAID FOR IN ACCORDANCE WITH ARTICLE 109.04.
  - THE CONTRACTOR SHALL CONTACT J.U.L.I.E. PRIOR TO ANY EXCAVATION TO HAVE ALL PUBLIC AND PRIVATE UTILITIES LOCATED.
  - THE CONTRACTOR SHALL BE RESPONSIBLE FOR PROTECTING UTILITY PROPERTY FROM CONSTRUCTION OPERATIONS AS OUTLINED IN ARTICLE 107.26 OF THE STANDARD SPECIFICATIONS. THE J.U.L.I.E. NUMBER IS (800) 892-0123. A MINIMUM OF 48 HOURS ADVANCE NOTICE IS REQUIRED. SEE SPECIAL PROVISIONS FOR STATUS OF UTILITIES, WITH UTILITY COMPANIES LISTED.
  - ANY REFERENCE TO THE STANDARDS THROUGHOUT THE PLANS SHALL BE INTERPRETED TO BE THE LATEST STANDARDS OF THE DEPARTMENT AS INCLUDED IN THE PLANS.
  - ALL DETAILS IN THE PLANS SHALL GOVERN CONSTRUCTION OF THIS PROJECT, AND IN CASE OF CONFLICT WITH ANY STANDARD DRAWINGS INCLUDED, THE SAID DETAILS SHALL TAKE PRECEDENCE AND GOVERN.

|                    |                    |                   |           |   |   |                          |      |           |           |          |              |           |
|--------------------|--------------------|-------------------|-----------|---|---|--------------------------|------|-----------|-----------|----------|--------------|-----------|
| FILE NAME = #FILE# | USER NAME = #USER# | DESIGNED - T.T.P. | REVISED - | <b>STATE OF ILLINOIS<br/>DEPARTMENT OF TRANSPORTATION</b> | <b>INDEX OF SHEETS<br/>CAHOKIA MOUNDS STATE HISTORIC SITE</b> |                          |      | F.A. RTE. | SECTION   | COUNTY   | TOTAL SHEETS | SHEET NO. |
|                    |                    | DRAWN - S.D.K.    | REVISED - |   | SCALE:  | SHEET NO. 2 OF 12 SHEETS | STA. | TO STA.   | ST. CLAIR | ILLINOIS | 12           | 2         |
|                    |                    | CHECKED - T.T.P.  | REVISED - |   | CONTRACT NO. 46060  |                          |      |           |           |          |              |           |
|                    |                    | DATE - 5/8/09     | REVISED - |   | FED. ROAD DIST. NO. [ILLINOIS] FED. AID PROJECT               |                          |      |           |           |          |              |           |

| SIDEWALK                          |                      |                               |                             |
|-----------------------------------|----------------------|-------------------------------|-----------------------------|
| LOCATION                          | SIDEWALK REM (SQ FT) | PC CONC SIDEWALK 4 SP (SQ FT) | DETECTABLE WARNINGS (SQ FT) |
| VISITOR CENTER (FLAGPOLE)         | 268                  | 268                           |                             |
| 15+24.86, 84.08L LT               | 100                  | 100                           | 20                          |
| MONK STA 80+61.87 TO STA 91+17.01 |                      | 5276                          |                             |
| WALL STA 100+00 TO STA 104+74.97  |                      | 2375                          |                             |
| SOUTH STA 202+50 TO STA 211+75.50 |                      | 4628                          |                             |
| TOTAL =                           | 288                  | 12,646                        | 20                          |

| EROSION CONTROL          |                             |                          |
|--------------------------|-----------------------------|--------------------------|
| LOCATION                 | INLET & PIPE PROTECT (EACH) | TEMP DITCH CHECKS (EACH) |
| STA. 14+50, 14.62' LT    | 1                           |                          |
| STA. 14+95.52, 57.09' LT | 1                           |                          |
| STA. 15+35.76, 22.50' LT | 1                           |                          |
| STA. 42+43, 17.53' RT    |                             | 1                        |
| TOTAL =                  | 3                           | 1                        |

| REMOVAL SCHEDULE                                     |                                |                             |
|--|--------------------------------|-----------------------------|
| LOCATION   | FIELD ENTRANCE REMOVAL (L SUM) | PIPE CULVERT REMOVAL (FOOT) |
| COLLINS STREET STA. 42+93.07, 16.27' RT              | 1                              |                             |
| STA. 42+20.00  |                                | 10                          |
| STA. 42+88.06, 16.03' RT TO STA. 42+98.08, 16.52' RT |                                | 10                          |
| TOTAL =  | 1                              | 20                          |

| PAVEMENT MARKING SCHEDULE            |                                 |                            |                            |                             |                              |
|--------------------------------------|---------------------------------|----------------------------|----------------------------|-----------------------------|------------------------------|
| LOCATION                             | PT PVT MK LTRS & SYMB (SQ. FT.) | PAINT PVT MK LINE 4 (FOOT) | PAINT PVT MK LINE 6 (FOOT) | PAINT PVT MK LINE 24 (FOOT) | REM REIN PARKING BLKS (EACH) |
| RAMEY STREET                         |                                 |                            |                            |                             |                              |
| 13+30.00 TO 28+93.56 C               |                                 | 391                        |                            |                             |                              |
| 13+30.00, 12' RT TO 28+93.56, 12' RT |                                 | 1564                       |                            |                             |                              |
| 14+18.00, 28' LT                     | 6.5                             |                            |                            |                             |                              |
| 14+44.00, 56' LT                     | 25.9                            |                            |                            |                             |                              |
| 15+43.00, 54' LT                     | 25.9                            |                            |                            |                             |                              |
| 15+94.00, 27' LT                     | 6.5                             |                            |                            |                             |                              |
| 18+86.15, 12' LT TO 28+93.56, 12' LT |                                 | 1007                       |                            |                             |                              |
| 28+44.00, TO 28+66.00 (ISLAND)       |                                 | 80                         |                            |                             |                              |
| 28+45.00, 28' RT TO 28+54, 20' RT    |                                 |                            |                            | 12                          |                              |
| 28+56.00, 0' RT TO 28+56.00, 12' RT  |                                 |                            |                            | 12                          |                              |
| COLLINS STREET                       |                                 |                            |                            |                             |                              |
| 40+28.00, TO 43+62.00 C              |                                 | 84                         |                            |                             |                              |
| 40+28.00 TO 43+62.00, 12' RT         |                                 | 334                        |                            |                             |                              |
| 40+28.00 TO 44+63.00, 12' LT         |                                 | 435                        |                            |                             |                              |
| 40+36.00, 0' LT TO 40+36.00, 19' LT  |                                 |                            |                            | 19                          |                              |
| PARKING LOT STRIPING                 | 4.6                             |                            | 270                        |                             |                              |
| MONKS MOUND PARKING LOT              |                                 |                            |                            |                             | 50                           |
| TOTAL =                              | 69.4                            | 3895                       | 270                        | 43                          | 50                           |

NOTE: LETTERS AND SYMBOLS  
SMALL DIRECTIONAL ARROW = 6.5 SQ FT  
HANDICAP SYMBOL = 4.6 SQ FT

| MISCELLANEOUS             |                              |                              |                     |                     |                       |                                 |                   |
|---------------------------|------------------------------|------------------------------|---------------------|---------------------|-----------------------|---------------------------------|-------------------|
| LOCATION                  | VALVE BOX FRAMES ADJ. (EACH) | PIPE BOL REM. + REPL. (EACH) | PARK BENCHES (EACH) | STEEL EDGING (FOOT) | CONCRETE SLAB (SQ YD) | BRICK SGN AND FOUND REM (L SUM) | FLAG-POLES (EACH) |
| RAMEY STREET              |                              |                              |                     |                     |                       |                                 |                   |
| VISITOR CENTER            |                              |                              |                     |                     |                       | 1                               | 3                 |
| STA. 14+92.18, 34.13' LT  |                              |                              |                     |                     |                       |                                 |                   |
| STA. 22+74.30, 15.00' LT  |                              | 1                            |                     |                     |                       |                                 |                   |
| STA. 22+76.62, 13.50' LT  |                              | 1                            |                     |                     |                       |                                 |                   |
| STA. 22+83.03, 13.50' LT  |                              | 1                            |                     |                     |                       |                                 |                   |
| STA. 28+09.17, 12.00' LT  | 1                            |                              |                     |                     |                       |                                 |                   |
| STA. 28+36.60, 28.00' LT  | 1                            |                              |                     |                     |                       |                                 |                   |
| STA. 28+38.29, 28.00' LT  | 1                            |                              |                     |                     |                       |                                 |                   |
| STA. 28+41.62, 28.00' LT  | 1                            |                              |                     |                     |                       |                                 |                   |
| STA. 28+48.49, 18.00' LT  | 1                            |                              |                     |                     |                       |                                 |                   |
| STA. 80+50.77, 116.36' LT |                              |                              |                     | 10                  |                       |                                 |                   |
| STA. 80+54.29, 190.00' LT |                              |                              | 1                   |                     | 7.8                   |                                 |                   |
| STA. 80+62.62, 116.22' LT |                              |                              |                     | 10                  |                       |                                 |                   |
| STA. 80+75.29, 440.00' LT |                              |                              | 1                   |                     | 7.8                   |                                 |                   |
| STA. 84+02.33, 2.40' LT   |                              |                              | 1                   |                     | 7.8                   |                                 |                   |
| STA. 202+50.84, 9.21' LT  |                              |                              | 1                   |                     |                       |                                 |                   |
| TOTAL =                   | 5                            | 3                            | 4                   | 20                  | 23.4                  | 1                               | 3                 |

\*REMOVAL ONLY

| SIGNING SCHEDULE             |              |           |                     |                         |                                  |                            |
|------------------------------|--------------|-----------|---------------------|-------------------------|----------------------------------|----------------------------|
| LOCATION                     | MESSAGE      | MUTCD NO. | SIGN REMOVAL (EACH) | SIGN PANELS T-1 (SQ FT) | SIGN PANEL T-3 SPECIAL (SQ. FT.) | MINOR SIGN COMPLETE (EACH) |
| COLLINS STREET 45+50, 50' LT | FINE SIGN    | R 7-I 101 |                     | 0.5                     |                                  |                            |
| STA. 80+47.48, 6.34' LT      |              |           | 1                   |                         |                                  | 1                          |
| STA. 80+54.25, 181.88' LT    |              |           |                     |                         |                                  | 1                          |
| STA. 80+67.21, 4.92' LT      |              |           | 1                   |                         |                                  | 1                          |
| STA. 80+77, 437' LT          |              |           |                     |                         |                                  | 1                          |
| STA. 83+99.65, 2.5' LT       |              |           |                     |                         |                                  | 1                          |
| STA. 91+06, 5.25' LT         |              |           | 1                   |                         |                                  | 1                          |
| STA. 91+13, 6' LT            |              |           | 1                   |                         |                                  | 1                          |
| STA. 101+13, 4' LT           |              |           | 1                   |                         |                                  | 1                          |
| STA. 202+60.80, 13.60' RT    | INTERPRETIVE |           |                     |                         | 24                               |                            |
| STA. 300+50, 2.5' LT         |              |           |                     |                         |                                  | 1                          |
| STA. 305+00, 2.5' RT         |              |           |                     |                         |                                  | 1                          |
| STA. 315+55, 2.5' LT         |              |           |                     |                         |                                  | 1                          |
| STA. 320+25, 2.5' LT         |              |           |                     |                         |                                  | 1                          |
| STA. 324+38, 2.5' LT         |              |           |                     |                         |                                  | 1                          |
| STA. 404+50, 2.5' RT         |              |           |                     |                         |                                  | 1                          |
| STA. 411+00, 2.5' RT         |              |           |                     |                         |                                  | 1                          |
| TOTAL=                       |              |           | 5                   | 0.5                     | 24                               | 15                         |

NOTE: ALL POST UNLESS OTHERWISE NOTED SHALL MEET THE REQUIREMENTS OF SECTION 728 OF THE STANDARD SPECIFICATIONS. EACH POST SHALL ALSO INCLUDE A 2 1/4" x 2 1/4" x 4' BASE DRIVEN INTO THE GROUND EXCEPT THE LAST 3".

ALL POST SHALL BE OFFSET FROM EDGE OF THE PAVEMENT BY 6'. SEE STANDARD DRAWINGS FOR POST IN PAVEMENT.

| SUMMARY OF QUANTITIES |   |        | 100% STATE |  |
|-----------------------|---|--------|------------|--|
| CODE #                | PAY ITEM  | UNITS  | TOTAL      |  |
| 20200600              | EXCAVATING AND GRADING EXISTING SHOULDERS             | UNIT   | 24.1       |  |
| 20800150              | TRENCH BACKFILL                                       | CU YD  | 46         |  |
| * 21101600            | TOPSOIL FURNISH AND PLACE, VARIABLE DEPTH             | SO YD  | 2716       |  |
| 21400100              | GRADING AND SHAPING DITCHES                           | FOOT   | 131        |  |
| * 25000100            | SEEDING, CLASS 1                                      | ACRE   | 0.71       |  |
| * 25000400            | NITROGEN FERTILIZER NUTRIENT                          | POUND  | 65         |  |
| * 25000500            | PHOSPHORUS FERTILIZER NUTRIENT                        | POUND  | 65         |  |
| * 25000600            | POTASSIUM FERTILIZER NUTRIENT                         | POUND  | 65         |  |
| * 25000700            | AGRICULTURAL GROUND LIMESTONE                         | TON    | 1.42       |  |
| 28000300              | TEMPORARY DITCH CHECK                                 | EACH   | 1          |  |
| 28000500              | INLET AND PIPE PROTECTION                             | EACH   | 3          |  |
| 28000720              | MULCH, METHOD 2                                       | ACRE   | 0.71       |  |
| 35102200              | AGGREGATE BASE COURSE TYPE B, 10"                     | SO YD  | 85         |  |
| 40200800              | AGGREGATE SURFACE COURSE, TYPE B                      | TON    | 294        |  |
| 40600100              | BITUMINOUS MATERIALS (PRIME COAT)                     | GALLON | 2,859      |  |
| 40600300              | AGGREGATE (PRIME COAT)                                | TON    | 20         |  |
| 40600982              | HOT-MIX ASPHALT SURFACE REMOVAL - BUTT JOINT          | SO YD  | 525        |  |
| 40600990              | TEMPORARY RAMP  | SO YD  | 337        |  |
| 40603085              | HOT-MIX ASPHALT BINDER COURSE, IL-19.0, N70           | TON    | 7          |  |
| 40603315              | HOT-MIX ASPHALT SURFACE COURSE, MIX "C", N70          | TON    | 716        |  |
| 42000300              | PORTLAND CEMENT CONCRETE PAVEMENT, 8"                 | SO YD  | 5.3        |  |
| 42001200              | PAVEMENT FABRIC                                       | SO YD  | 5.3        |  |
| 42400420              | PORTLAND CEMENT CONCRETE SIDEWALK 4 INCH, SPECIAL     | SO FT  | 12,646     |  |
| 42400800              | DETECTABLE WARNINGS                                   | SO FT  | 20         |  |
| 44000100              | PAVEMENT REMOVAL                                      | SO YD  | 5.3        |  |
| 44000155              | HOT-MIX ASPHALT SURFACE REMOVAL, 1 1/2"               | SO YD  | 5,196      |  |
| 44000400              | GUTTER REMOVAL  | FOOT   | 249        |  |
| 44000600              | SIDEWALK REMOVAL                                      | SO FT  | 288        |  |
| 44212899              | PAVEMENT PATCHING (FULL DEPTH)                        | SO YD  | 177        |  |
| 48101200              | AGGREGATE SHOULDERS, TYPE B                           | TON    | 89         |  |
| 48203013              | HOT-MIX ASPHALT SHOULDERS, 4"                         | SO YD  | 829        |  |
| 50105220              | PIPE CULVERTS REMOVAL                                 | FOOT   | 20         |  |
| 54200433              | PIPE CULVERTS, TYPE 1 RCCP, 18"                       | FOOT   | 4          |  |
| 54213663              | PRECAST REINFORCED CONCRETE FLARED END SECTIONS 18"   | EACH   | 1          |  |
| 550A0050              | STORM SEWER, CLASS A, TYPE 1 12"                      | FOOT   | 84         |  |
| 60218500              | MANHOLES, TYPE A, 4'-DIAMETER, TYPE 3 FRAME AND GRATE | EACH   | 1          |  |
| 60235700              | INLETS, TYPE A, TYPE 3 FRAME AND GRATE                | EACH   | 1          |  |
| 60240220              | INLETS, TYPE B, TYPE 3 FRAME AND GRATE                | EACH   | 1          |  |
| 60300405              | VALVE BOX FRAMES TO BE ADJUSTED                       | EACH   | 5          |  |
| 60605000              | COMBINATION CONCRETE CURB AND GUTTER, TYPE B-6.24     | FOOT   | 271        |  |
| 67100100              | MOBILIZATION  | L SUM  | 1          |  |
| 70102620              | TRAFFIC CONTROL AND PROTECTION, STANDARD 701501       | L SUM  | 1          |  |
| * 72000100            | SIGN PANEL - TYPE 1                                   | SO FT  | 0.5        |  |
| * 72000305            | SIGN PANEL - TYPE 3 (SPECIAL)                         | SO FT  | 24         |  |
| * 78001100            | PAINT PAVEMENT MARKING - LETTERS AND SYMBOLS          | SO FT  | 69.4       |  |
| * 78001110            | PAINT PAVEMENT MARKING - LINE 4"                      | FOOT   | 3,895      |  |
| * 78001130            | PAINT PAVEMENT MARKING - LINE 6"                      | FOOT   | 270        |  |
| * 78001180            | PAINT PAVEMENT MARKING - LINE 24"                     | FOOT   | 43         |  |
| * K1005582            | STEEL EDGING  | FOOT   | 20         |  |
| XX004357              | FIELD ENTRANCE REMOVAL                                | L SUM  | 1          |  |
| XX004603              | CONCRETE SLAB   | SO YD  | 23.4       |  |
| XX005644              | MINOR SIGN COMPLETE                                   | EACH   | 15         |  |
| XX006091              | PIPE BOLLARD REMOVAL AND REPLACEMENT                  | EACH   | 3          |  |
| XX006582              | BRICK SIGN AND CONCRETE FOUNDATION REMOVAL            | L SUM  | 1          |  |
| X0300019              | REMOVE AND REINSTALL PARKING BLOCKS                   | EACH   | 50         |  |
| X0321158              | PARK BENCHES  | EACH   | 4          |  |
| X0323407              | FLAGPOLES   | EACH   | 3          |  |
| X0325372              | SURFACE REMOVAL VARIABLE DEPTH (HAND METHOD)          | SO YD  | 765        |  |
| X0974300              | SIGN REMOVAL  | EACH   | 5          |  |
| X4020500              | AGGREGATE SURFACE COURSE, TYPE B 6"                   | SO YD  | 104        |  |

\*Specialty Items

|             |                      |                   |           |
|-------------|----------------------|-------------------|-----------|
| FILE NAME = | USER NAME = #USER#   | DESIGNED - T.T.P. | REVISED - |
| #FILE#      |                      | DRAWN - S.D.K.    | REVISED - |
|             | PLOT SCALE = #SCALE# | CHECKED - R.H.D.  | REVISED - |
|             | PLOT DATE = #DATE#   | DATE - 5/8/09     | REVISED - |

STATE OF ILLINOIS  
DEPARTMENT OF TRANSPORTATION

SUMMARY /SCHEDULE OF QUANTITIES  
CAHOKIA MOUNDS STATE HISTORIC SITE

|                    |                          |              |   |           |
|--------------------|--------------------------|--------------|---|-----------|
| F.A. RTE.          | SECTION                  | COUNTY       | TOTAL SHEETS                                  | SHEET NO. |
|                    |                          | ST. CLAIR    | 12  | 3         |
| CONTRACT NO. 46060 |                          |              |   |           |
| SCALE:             | SHEET NO. 3 OF 12 SHEETS | STA. TO STA. | FED. ROAD DIST. NO. ILLINOIS FED. AID PROJECT |           |

RESURFACING/SHOULDER SCHEDULE

| LOCATION                                     | EXC & GR EX SHOULDER | AGG BASE CSE B 10 | AGGREGATE SURFACE CSE B | BIT MATLS PR CT | AGG PR CT | HMA SURFACE REMOVAL BUTT JOINT | TEMPORARY RAMP | HMA BC "C" 1L-19.0, N70 | HMA SC "C" 1L-9.5 N70 | PCC PVT 8 | PAVEMENT FABRIC | HMA SURFACE REMOVAL 1 1/2" | PAVEMENT REM | PVT PATCHING (FD) | AGGREGATE SHLDS B | HMA SHOULDERS 4" | SURF REM VAR DP (HM) | AGGREGATE SURFACE CSE B 6" |
|--|----------------------|-------------------|-------------------------|-----------------|-----------|--------------------------------|----------------|-------------------------|-----------------------|-----------|-----------------|----------------------------|--------------|-------------------|-------------------|------------------|----------------------|----------------------------|
| (UNIT)                                       | (SQ YD)              | (TON)             | (GALLONS)               | (TON)           | (SQ YD)   | (SQ YD)                        | (TON)          | (TON)                   | (SQ YD)               | (SQ YD)   | (SQ YD)         | (SQ YD)                    | (SQ YD)      | (SQ YD)           | (TON)             | (SQ YD)          | (SQ YD)              | (SQ YD)                    |
| VISITOR CENTER CIRCLE DRIVE                  |                      | 85                |                         |                 |           |                                |                | 7                       | 7                     |           |                 |                            |              |                   |                   |                  |                      |                            |
| RAMEY STREET                                 |                      |                   |                         |                 |           | 67                             |                |                         |                       |           |                 | 5196                       |              |                   |                   |                  |                      |                            |
| 13+30 TO 13+55                               |                      |                   |                         | 1948            | 13        |                                |                |                         |                       |           |                 |                            |              |                   |                   |                  |                      |                            |
| 13+30 TO 28+67.43                            |                      |                   |                         |                 |           |                                |                |                         |                       |           |                 |                            |              |                   |                   |                  |                      |                            |
| 13+30 TO 18+88 - RT                          | 5.6                  |                   |                         |                 |           |                                |                |                         |                       | 5.3       | 5.3             |                            | 5.3          |                   |                   |                  | 186                  |                            |
| 15+23.98, 80.57' LT                          |                      |                   |                         |                 |           |                                |                |                         |                       |           |                 |                            |              |                   |                   |                  |                      |                            |
| 18+88 TO 28+13.5 - RT AND LT                 | 18.5                 |                   |                         |                 |           |                                |                |                         |                       |           |                 |                            |              |                   |                   |                  |                      |                            |
| 28+10.50, 15' LT TO 28+44.29, 24.24' LT      |                      |                   | 1.3                     |                 |           |                                |                |                         |                       |           |                 |                            |              |                   |                   |                  |                      |                            |
| 28+13.5 TO 28+67.43 RT                       |                      |                   |                         |                 |           |                                |                |                         |                       |           |                 |                            |              |                   |                   |                  |                      |                            |
| 28+37.43 TO 28+67.43                         |                      |                   |                         |                 |           | 245                            | 245            |                         |                       |           |                 |                            |              |                   |                   |                  |                      |                            |
| COLLINS STREET                               |                      |                   |                         |                 |           |                                |                |                         |                       |           |                 |                            |              | 177               |                   |                  |                      |                            |
| 40+28 TO 40+40                               |                      |                   |                         |                 |           | 92                             | 92             |                         |                       |           |                 |                            |              |                   |                   |                  |                      |                            |
| 40+28 TO 43+62                               |                      |                   |                         | 251             | 2         |                                |                |                         |                       |           |                 |                            |              |                   |                   |                  |                      |                            |
| 43+62 TO 45+58.17                            |                      |                   |                         | 660             | 5         |                                |                |                         |                       |           |                 |                            |              |                   |                   |                  |                      |                            |
| 45+18 TO 45+58.17                            |                      |                   |                         |                 |           | 121                            |                |                         |                       |           |                 |                            |              |                   |                   |                  |                      |                            |
| SIDEWALKS                                    |                      |                   |                         |                 |           |                                |                |                         |                       |           |                 |                            |              |                   |                   |                  |                      |                            |
| 80+47.48, 6.34' LT                           |                      |                   | 0.15                    |                 |           |                                |                |                         |                       |           |                 |                            |              |                   |                   |                  |                      |                            |
| 80+67.21, 4.92' LT                           |                      |                   | 0.15                    |                 |           |                                |                |                         |                       |           |                 |                            |              |                   |                   |                  |                      |                            |
| 80+56.33, 111.29' LT TO 80+67.16, 258.81' LT |                      |                   | 12.8                    |                 |           |                                |                |                         |                       |           |                 |                            |              |                   |                   |                  |                      |                            |
| 80+61.87 TO 91+17.01                         |                      |                   |                         |                 |           |                                |                |                         |                       |           |                 |                            |              |                   |                   |                  |                      |                            |
| 80+77, 445' LT                               |                      |                   | 2                       |                 |           |                                |                |                         |                       |           |                 |                            |              |                   |                   |                  |                      |                            |
| 80+54.29, 186' LT                            |                      |                   | 2                       |                 |           |                                |                |                         |                       |           |                 |                            |              |                   |                   |                  |                      |                            |
| 84+07, 2.4' LT                               |                      |                   | 2                       |                 |           |                                |                |                         |                       |           |                 |                            |              |                   |                   |                  |                      |                            |
| 91+06, 5.25' LT                              |                      |                   | 0.15                    |                 |           |                                |                |                         |                       |           |                 |                            |              |                   |                   |                  |                      |                            |
| 91+13, 6' LT                                 |                      |                   | 0.15                    |                 |           |                                |                |                         |                       |           |                 |                            |              |                   |                   |                  |                      |                            |
| 101+13, 4' LT                                |                      |                   | 0.15                    |                 |           |                                |                |                         |                       |           |                 |                            |              |                   |                   |                  |                      |                            |
| 104+34.96 TO 104+75                          |                      |                   | 0.2                     |                 |           |                                |                |                         |                       |           |                 |                            |              |                   |                   |                  |                      |                            |
| 202+50 TO 211+75.50                          |                      |                   |                         |                 |           |                                |                |                         |                       |           |                 |                            |              |                   |                   |                  |                      |                            |
| 202+60.80, 13.60' RT                         |                      |                   | 0.15                    |                 |           |                                |                |                         |                       |           |                 |                            |              |                   |                   |                  |                      |                            |
| PALISADE PATH                                |                      |                   |                         |                 |           |                                |                |                         |                       |           |                 |                            |              |                   |                   |                  |                      |                            |
| 300+00 TO 313+35.68                          |                      |                   | 82.4                    |                 |           |                                |                |                         |                       |           |                 |                            |              |                   |                   |                  |                      |                            |
| 300+50, 2.5' LT                              |                      |                   | 0.15                    |                 |           |                                |                |                         |                       |           |                 |                            |              |                   |                   |                  |                      |                            |
| 305+00, 2.5' RT                              |                      |                   | 0.15                    |                 |           |                                |                |                         |                       |           |                 |                            |              |                   |                   |                  |                      |                            |
| 313+42.41 TO 324+87.84                       |                      |                   | 71.5                    |                 |           |                                |                |                         |                       |           |                 |                            |              |                   |                   |                  |                      |                            |
| 315+55, 2.5' LT                              |                      |                   | 0.15                    |                 |           |                                |                |                         |                       |           |                 |                            |              |                   |                   |                  |                      |                            |
| 320+25, 2.5' LT                              |                      |                   | 0.15                    |                 |           |                                |                |                         |                       |           |                 |                            |              |                   |                   |                  |                      |                            |
| 324+38, 2.5' LT                              |                      |                   | 0.15                    |                 |           |                                |                |                         |                       |           |                 |                            |              |                   |                   |                  |                      |                            |
| 324+87.84 TO 327+87.84, 101.63' RT           |                      |                   | 6.55                    |                 |           |                                |                |                         |                       |           |                 |                            |              |                   |                   |                  |                      |                            |
| 326+00 TO 331+00.79                          |                      |                   | 30.9                    |                 |           |                                |                |                         |                       |           |                 |                            |              |                   |                   |                  |                      |                            |
| 400+00 TO 412+73.52                          |                      |                   | 78.6                    |                 |           |                                |                |                         |                       |           |                 |                            |              |                   |                   |                  |                      |                            |
| 404+50, 2.5' RT                              |                      |                   | 0.15                    |                 |           |                                |                |                         |                       |           |                 |                            |              |                   |                   |                  |                      |                            |
| 411+00, 2.5' RT                              |                      |                   | 0.15                    |                 |           |                                |                |                         |                       |           |                 |                            |              |                   |                   |                  |                      |                            |
| AGGREGATE ENTRANCE                           |                      |                   |                         |                 |           |                                |                |                         |                       |           |                 |                            |              |                   |                   |                  |                      |                            |
| 19+05.31, 14.85' LT                          |                      |                   |                         |                 |           |                                |                |                         |                       |           |                 |                            |              |                   |                   |                  |                      | 104                        |
| TOTAL =                                      | 24.1                 | 85                | 294                     | 2859            | 20        | 525                            | 377            | 7                       | 716                   | 5.3       | 5.3             | 5196                       | 5.3          | 177               | 89                | 829              | 765                  | 104                        |

| MOBILIZATION   |                 |
|----------------|-----------------|
| LOCATION       | QUANTITY (LSUM) |
| ENTIRE PROJECT | 1 LSUM          |
| TOTAL =        | 1 LSUM          |

| TRAFFIC CONTROL |                              |
|-----------------|------------------------------|
| LOCATION        | TRAF CONT&PROT 701501 (LSUM) |
| ENTIRE SECTION  | 1 LSUM                       |
| TOTAL =         | 1 LSUM                       |

| CURB & GUTTER                                       |            |                   |
|---|------------|-------------------|
| LOCATION  | GUTTER REM | COMB CC&G TB 6.24 |
|   | (FOOT)     | (FOOT)            |
| RAMEY STREET  |            |                   |
| VISITOR CENTER (ADA SIDEWALK)                       | 10         | 10                |
| STA. 14+44.00, 31' LT TO STA. 15+40.00, 33' LT      | 239        | 201               |
| STA. 28+13.65, 15.48' LT TO STA. 28+60.00, 45.74 LT |            | 60                |
| TOTAL =   | 249        | 271               |

DRAINAGE SCHEDULE

| LOCATION                                   | P CUL CL A 1 18" | PRC FLAR END SEC 18" | STORM SEW CL A 1 12" | INLETS TA T3F&G | INLETS TB T3F&G | MANHOLE TA T3F&G | TRENCH BACKFILL | GRADING & SHAP DITCH |
|--|------------------|----------------------|----------------------|-----------------|-----------------|------------------|-----------------|----------------------|
| (FOOT)                                     | (EACH)           | (EACH)               | (EACH)               | (EACH)          | (EACH)          | (EACH)           | (CU YD)         | (FOOT)               |
| RAMEY STREET                               |                  |                      |                      |                 |                 |                  |                 |                      |
| 14+55.59, 40.66' LT                        |                  |                      |                      | 1               |                 |                  |                 |                      |
| 14+55.59, 40.66' LT TO 14+95.50, 50.22' LT |                  |                      | 39                   |                 |                 |                  | 14              |                      |
| 14+95.50, 50.22' LT                        |                  |                      |                      |                 | 1               |                  |                 |                      |
| 14+95.50, 50.22' LT TO 15+32.26, 23.23 LT  |                  |                      | 45                   |                 |                 |                  | 32              |                      |
| 15+32.26, 23.23' LT                        |                  |                      |                      |                 |                 | 1                |                 |                      |
| 19+24, 18.00' LT                           | 4                | 1                    |                      |                 |                 |                  |                 |                      |
| COLLINS STREET                             |                  |                      |                      |                 |                 |                  |                 | 131                  |
| 41+81.32, 14.3' RT TO 43+11.90, 16.0' RT   |                  |                      |                      |                 |                 |                  |                 |                      |
| TOTAL =                                    | 4                | 1                    | 84                   | 1               | 1               | 1                | 46              | 131                  |

SEEDING SCHEDULE

| LOCATION (STATION TO STATION) | TOPSOIL F & P VAR DP | SEEDING CL 1 | NITROGEN FERT NUTR | PHOSPHORUS FERT NUTR | POTASSIUM FERT NUTR | AGR GROUND LIMESTONE | MULCH METHOD 2 |
|-------------------------------|----------------------|--------------|--------------------|----------------------|---------------------|----------------------|----------------|
| (SQ YD)                       | (ACRE)               | (LBS.)       | (LBS.)             | (LBS.)               | (LBS.)              | (TON)                | (ACRE)         |
| VISITOR CENTER (ISLAND)       | 291                  | 0.06         | 5                  | 5                    | 5                   | 0.12                 | 0.06           |
| 13+30.00 TO 28+66.89          | 683                  | 0.14         | 13                 | 13                   | 13                  | 0.28                 | 0.14           |
| 40+28.00 TO 45+58.17          | 236                  | 0.05         | 5                  | 5                    | 5                   | 0.10                 | 0.05           |
| 80+61.87 TO 91+17.01          | 522                  | 0.25         | 23                 | 23                   | 23                  | 0.50                 | 0.25           |
| 100+00.00 TO 104+74.97        | 469                  | 0.10         | 9                  | 9                    | 9                   | 0.20                 | 0.10           |
| 202+50.00 TO 211+75.50        | 515                  | 0.11         | 10                 | 10                   | 10                  | 0.22                 | 0.11           |
| TOTAL =                       | 2716                 | 0.71         | 65                 | 65                   | 65                  | 1.42                 | 0.71           |

PAVEMENT PATCHING SCHEDULE - COLLINS STREET

| PATCH   | STATION | LT OR RT | W  | L   | SQ. YD |
|---------|---------|----------|----|-----|--------|
| A       | 40+86   | RT       | 8' | 4'  | 4      |
| B       | 41+45   | RT       | 2' | 23' | 5      |
| C       | 41+77   | RT       | 7' | 74' | 58     |
| D       | 42+33   | LT       | 4' | 40' | 18     |
| E       | 42+73   | LT       | 6' | 55' | 36     |
| F       | 43+47   | LT       | 6' | 84' | 56     |
| TOTAL = |         |          |    |     | 177    |

|                      |                    |                   |           |   |  |                          |      |                    |           |          |                  |           |   |
|----------------------|--------------------|-------------------|-----------|---|--|--------------------------|------|--------------------|-----------|----------|------------------|-----------|---|
| FILE NAME =          | USER NAME = #USER# | DESIGNED - T.T.P. | REVISED - | <b>STATE OF ILLINOIS<br/>DEPARTMENT OF TRANSPORTATION</b> | <b>SCHEDULE OF QUANTITIES<br/>CAHOKIA MOUNDS STATE HISTORIC SITE</b> |                          |      | F.A. RTE.          | SECTION   | COUNTY   | TOTAL SHEETS     | SHEET NO. |   |
| #FILE#               |                    | DRAWN - S.D.K.    | REVISED - |   | SCALE:   | SHEET NO. 4 OF 12 SHEETS | STA. | TO STA.            | ST. CLAIR | ILLINOIS | FED. AID PROJECT | 12        | 4 |
| PLOT SCALE = #SCALE# |                    | CHECKED - R.H.D.  | REVISED - |   |  |                          |      | CONTRACT NO. 46060 |           |          |                  |           |   |
| PLOT DATE = #DATE#   |                    | DATE - 5/8/09     | REVISED - |   |  |                          |      |                    |           |          |                  |           |   |

\*TRANSITION TAPER FROM 1' WIDTH TO FULL WIDTH STA. 13+30 - STA. 13+70 RIGHT ONLY  
 \*\*SHOULDER BEGINS AT STA. 18+88 LEFT ONLY  
 \*\*\*PAVEMENT CROSS SLOPES ARE 2% OR AS DIRECTED BY THE RESIDENT ENGINEER

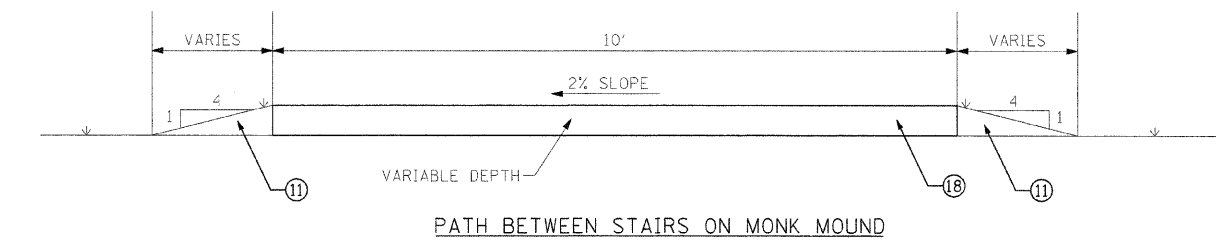
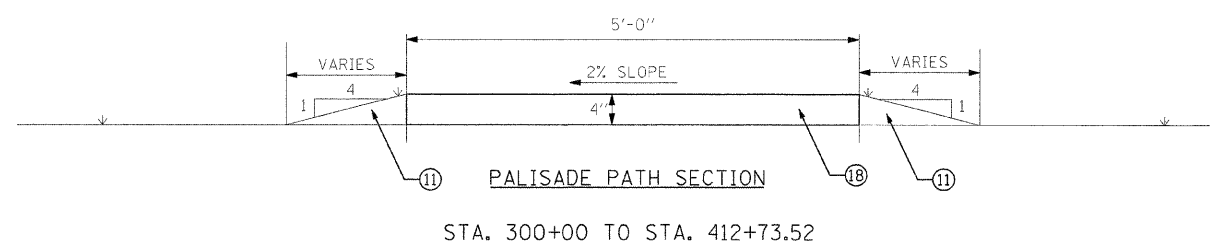
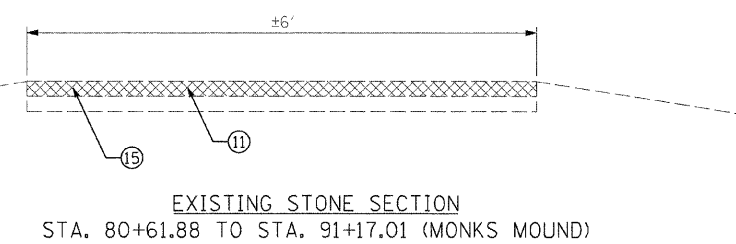
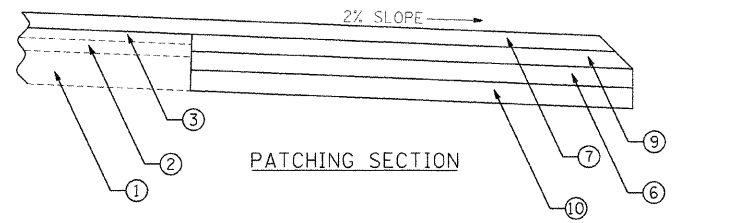
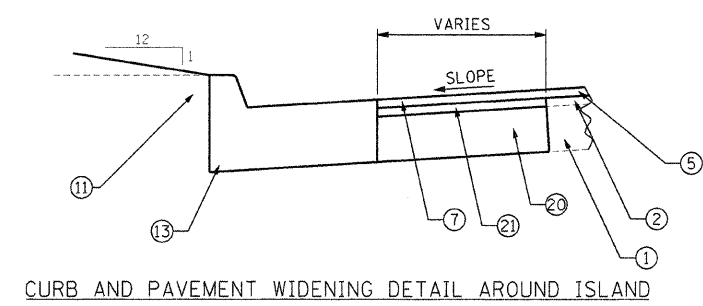
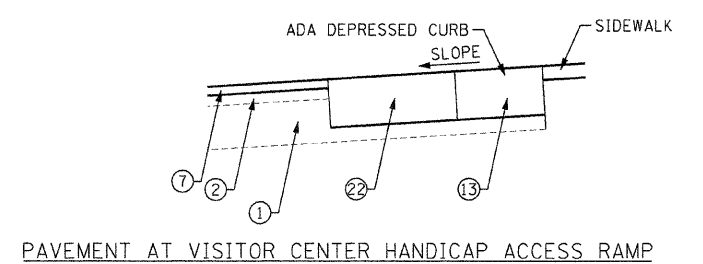
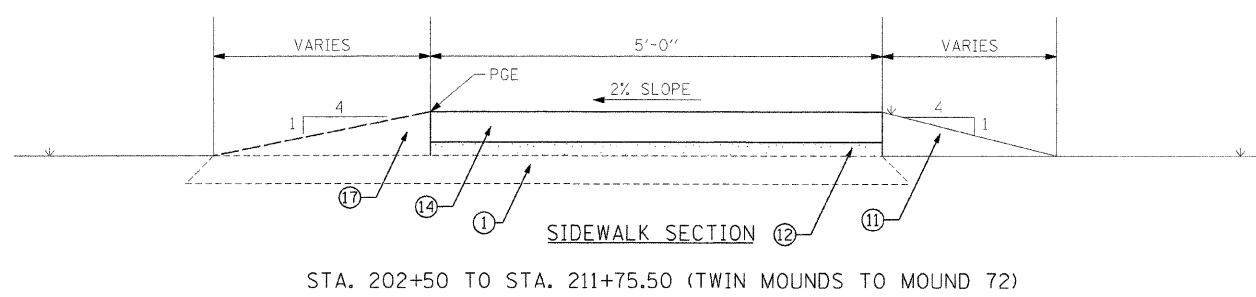
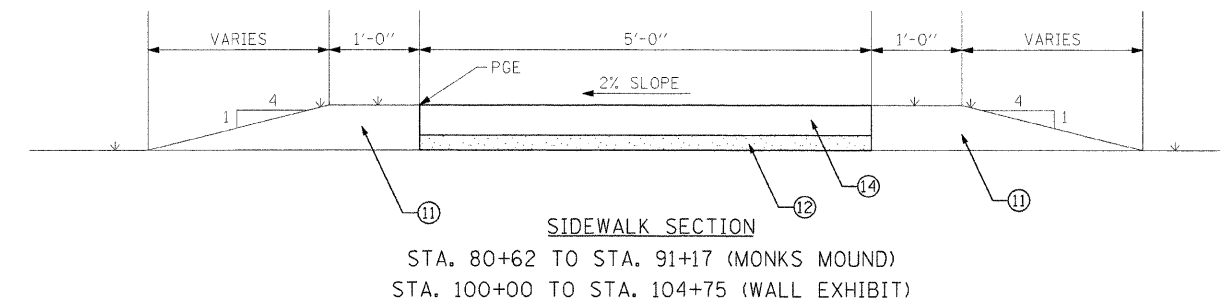
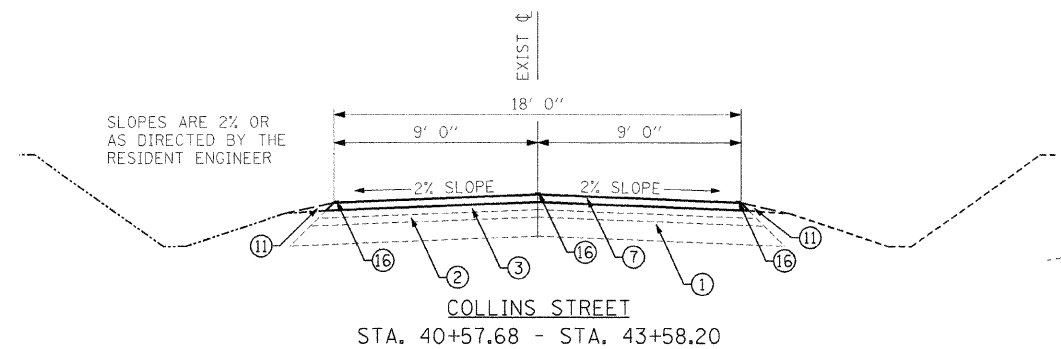
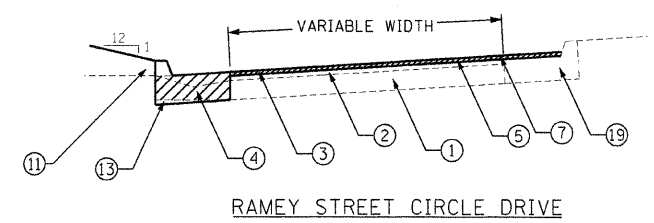
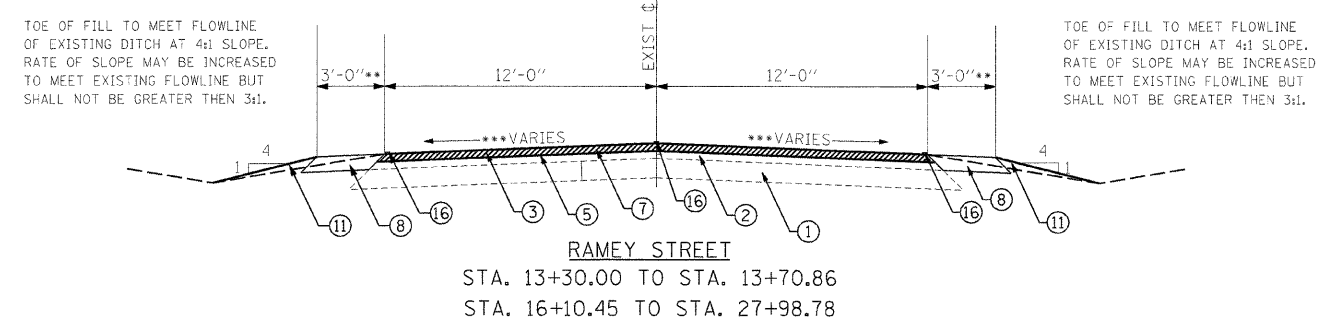

- ① EXISTING AGGREGATE BASE COURSE
- ② EXISTING HOT-MIX ASPHALT BINDER COURSE
- ③ EXISTING HOT-MIX ASPHALT SURFACE COURSE, 1 1/2"
- ④ EXISTING CONCRETE GUTTER
- ⑤ PROPOSED HOT-MIX ASPHALT SURFACE REMOVAL, 1-1/2"
- ⑥ PROPOSED AGGREGATE BASE COURSE 4"
- ⑦ PROPOSED HOT-MIX ASPHALT SURFACE COURSE, MIX "C", N70, RAMEY STREET & AROUND ISLAND = 1 1/2" COLLINS STREET = 2"
- ⑧ PROPOSED HOT-MIX ASPHALT SHOULDERS, 4" & EXCAVATE AND GRADE EXISTING SHOULDERS
- ⑨ PROPOSED HOT MIX BINDER COURSE, IL-19.0, N70, 3"
- ⑩ PROPOSED SUB-BASE GRANULAR MATERIAL, 5"
- ⑪ PROPOSED TOPSOIL FURNISH AND PLACE, VARIABLE DEPTH.
- ⑫ PROPOSED 3" MINIMUM AGGREGATE BASE COURSE, TYPE B
- ⑬ PROPOSED COMBINATION CONCRETE CURB AND GUTTER, TYPE B-6.24 (SPECIAL)
- ⑭ PROPOSED PORTLAND CEMENT CONCRETE SIDEWALK 4 INCH (SPECIAL). NO SLIP-FORMING WILL BE ALLOWED
- ⑮ SURFACE REMOVAL VARIABLE DEPTH, (HAND METHOD)
- ⑯ PAINT PAVEMENT MARKING-LINE 4"
- ⑰ PROPOSED AGGREGATE SHOULDERS, TYPE B
- ⑱ PROPOSED AGGREGATE SURFACE COURSE, TYPE B
- ⑲ EXISTING CONCRETE CURB & GUTTER
- ⑳ PROPOSED AGGREGATE BASE COURSE, TYPE B, 10"
- ㉑ PROPOSED HOT MIX BINDER COURSE, IL-19.0, N70, 1 1/2"
- ㉒ PORTLAND CEMENT CONCRETE PAVEMENT, 8"

|                     |                    |                   |           |
|---------------------|--------------------|-------------------|-----------|
| FILE NAME = #FILEL# | USER NAME = #USER# | DESIGNED - T.T.P. | REVISED - |
|                     |                    | DRAWN - S.D.K.    | REVISED - |
|                     |                    | CHECKED - R.H.D.  | REVISED - |
|                     |                    | DATE - 5/8/09     | REVISED - |

**STATE OF ILLINOIS  
 DEPARTMENT OF TRANSPORTATION**

**TYPICAL SECTIONS  
 CAHOKIA MOUNDS STATE HISTORIC SITE**

SCALE: SHEET NO. 5 OF 12 SHEETS STA. TO STA.

|   |         |           |              |           |
|---|---------|-----------|--------------|-----------|
| F.A. RTE.                                     | SECTION | COUNTY    | TOTAL SHEETS | SHEET NO. |
|   |         | ST. CLAIR | 12           | 5         |
| CONTRACT NO. 46060                            |         |           |              |           |
| FED. ROAD DIST. NO. ILLINOIS FED. AID PROJECT |         |           |              |           |

JOB NO. 250-061-G VASCONCELLES ENGINEERING CORP. DESIGN FIRM REGISTRATION NUMBER 184-002107

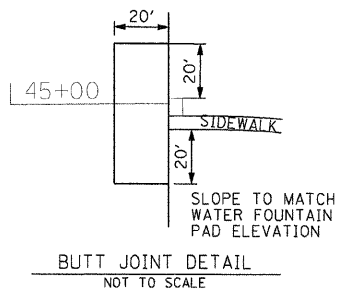
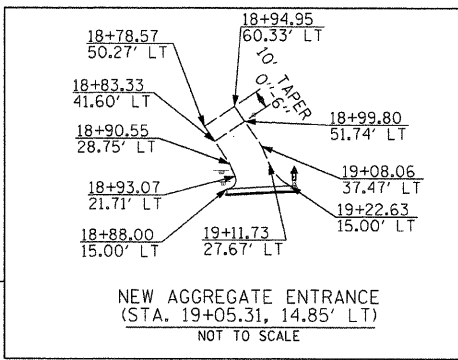
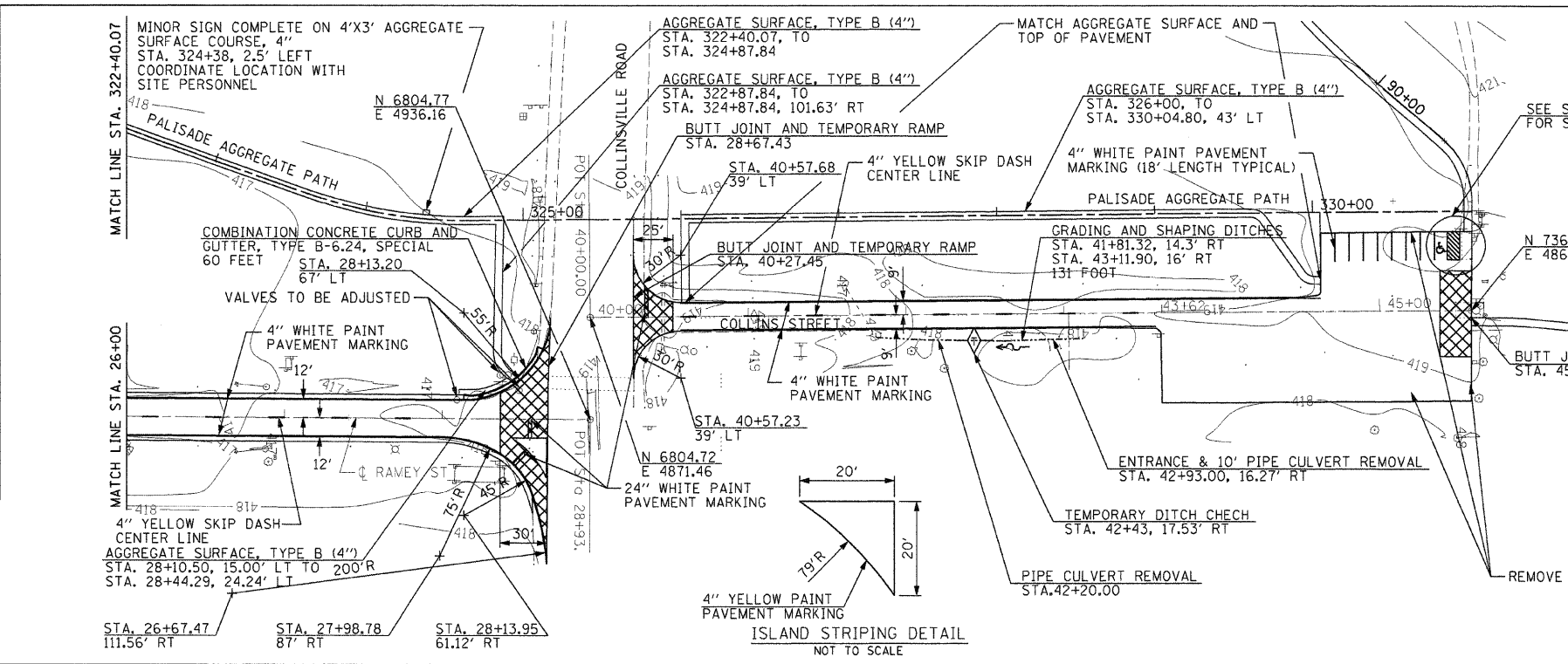
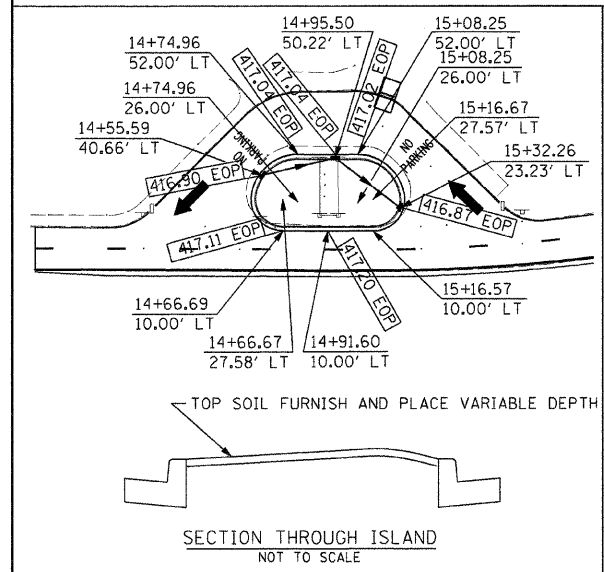
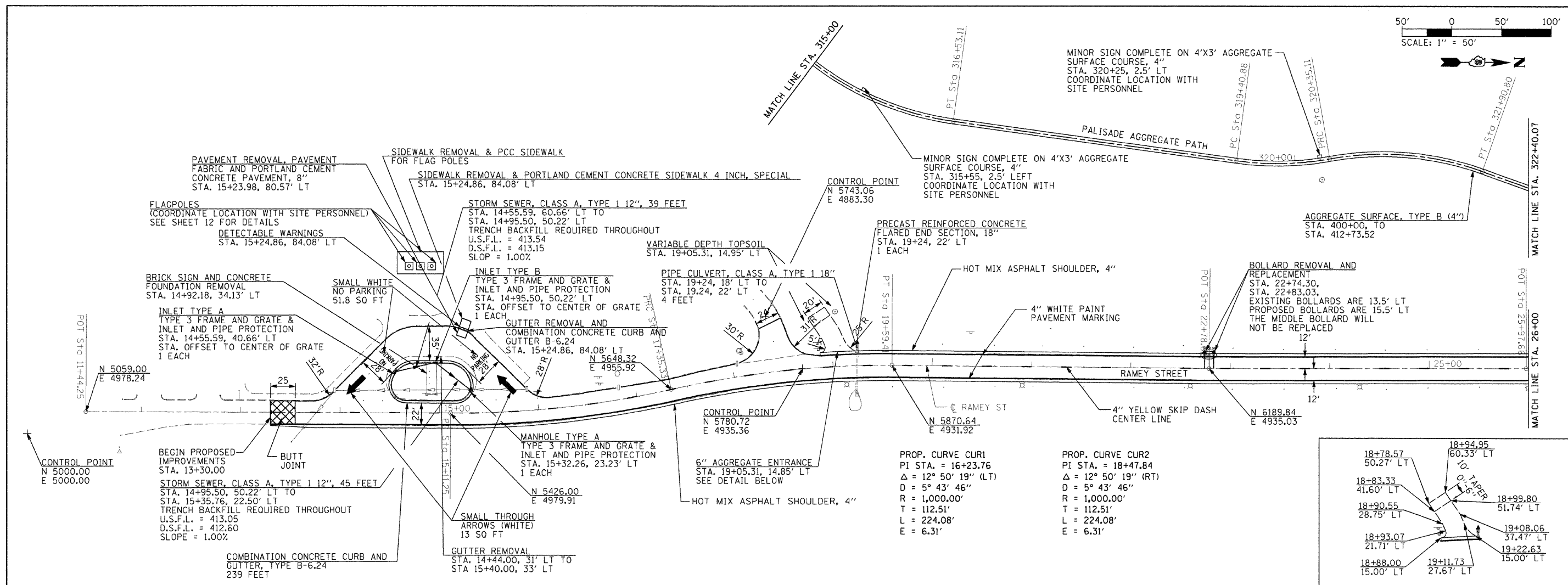
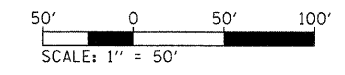

|                     |                    |                   |           |   |   |                 |                          |                    |                  |           |   |
|---------------------|--------------------|-------------------|-----------|---|---|-----------------|--------------------------|--------------------|------------------|-----------|---|
| FILE NAME = #FJLEL# | USER NAME = #USER# | DESIGNED - T.T.P. | REVISED - | <b>STATE OF ILLINOIS</b><br><b>DEPARTMENT OF TRANSPORTATION</b> | <b>RAMEY AND COLLINS ST PLAN VIEW AND PALASIDES AGGREGATE PATH</b><br><b>CAHOKIA MOUNDS STATE HISTORIC SITE</b> | F.A. RTE.       | SECTION                  | COUNTY             | TOTAL SHEETS     | SHEET NO. |   |
|                     |                    | DRAWN - S.D.K.    | REVISED - |   |   | SCALE: 1" = 50' | SHEET NO. 6 OF 12 SHEETS | ST. CLAIR          | ILLINOIS         | 12        | 6 |
|                     |                    | CHECKED - R.H.D.  | REVISED - |   |   | DATE - 5/8/09   | STA. TO STA.             | CONTRACT NO. 46060 | FED. AID PROJECT |           |   |
|                     |                    | DATE -            | REVISED - |   |   |                 |                          |                    |                  |           |   |



PROP. CURVE SW1  
PI STA. = 83+18.99  
Δ = 43° 02' 55" (LT)  
D = 38° 11' 50"  
R = 150.00'  
T = 59.16'  
L = 112.70'  
E = 11.24'  
N = 6,905.5464  
E = 4,169.2671

PROP. CURVE SW4  
PI STA. = 89+15.17  
Δ = 16° 03' 40" (LT)  
D = 9° 32' 57"  
R = 600.00'  
T = 84.65'  
L = 168.19'  
E = 5.94'  
N = 7,238.5286  
E = 4,668.0504

PROP. CURVE SW6  
PI STA. = 100+30.57  
Δ = 5° 17' 01" (RT)  
D = 22° 55' 06"  
R = 250.00'  
T = 11.53'  
L = 23.05'  
E = 0.27'  
N = 7,393.4065  
E = 4,871.4654

PROP. CURVE SW2  
PI STA. = 85+64.22  
Δ = 14° 58' 04" (RT)  
D = 5° 43' 46"  
R = 1,000.00'  
T = 131.37'  
L = 261.24'  
E = 8.59'  
N = 7,068.4291  
E = 4,360.0468

PROP. CURVE SW5  
PI STA. = 90+78.20  
Δ = 49° 34' 28" (RT)  
D = 114° 35' 30"  
R = 50.00'  
T = 23.09'  
L = 43.26'  
E = 5.07'  
N = 7,363.1421  
E = 4,774.8838

PROP. CURVE SW3  
PI STA. = 87+62.35  
Δ = 7° 48' 35" (LT)  
D = 5° 43' 46"  
R = 1,000.00'  
T = 68.26'  
L = 136.30'  
E = 2.33'  
N = 7,154.4389  
E = 4,540.1910

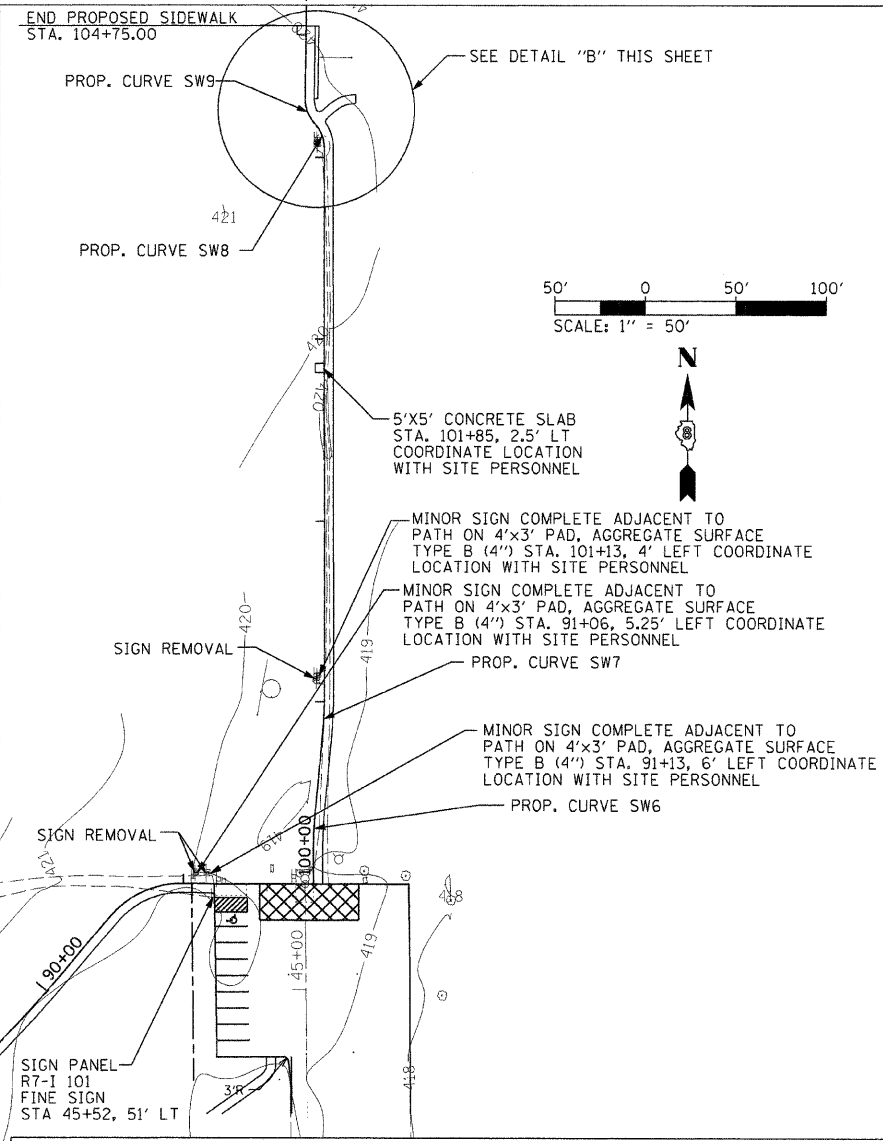
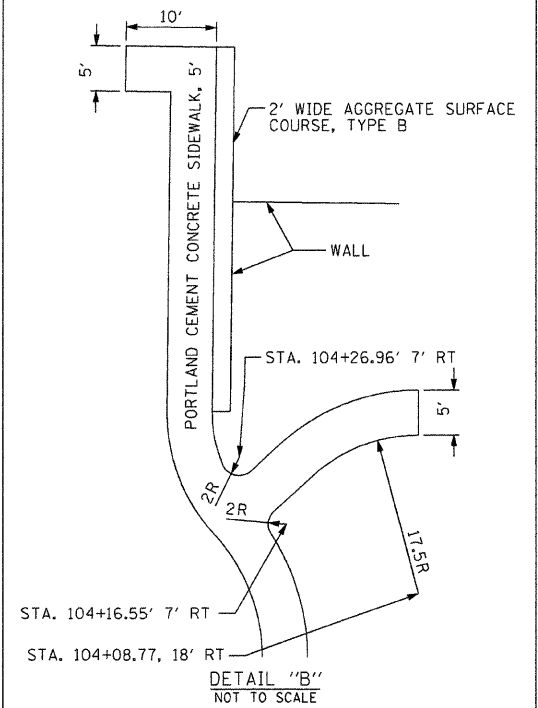
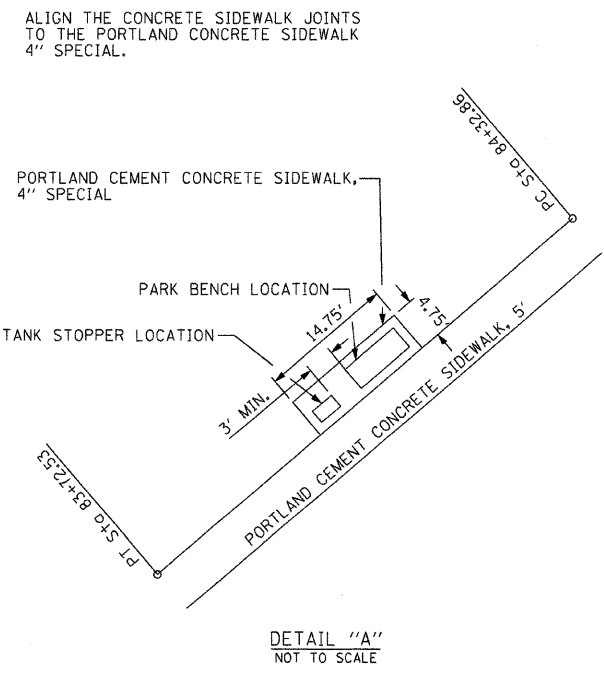

PROP. CURVE SW7  
PI STA. = 100+93.06  
Δ = 5° 30' 46" (LT)  
D = 22° 55' 06"  
R = 250.00'  
T = 12.04'  
L = 24.05'  
E = 0.29'  
N = 7,455.6332  
E = 4,877.4159

PROP. CURVE SW8  
PI STA. = 104+12.84  
Δ = 42° 29' 51" (LT)  
D = 286° 28' 44"  
R = 20.00'  
T = 7.78'  
L = 14.83'  
E = 1.46'  
N = 7,775.4239  
E = 4,877.1346

PROP. CURVE SW9  
PI STA. = 104+27.81  
Δ = 43° 10' 41" (RT)  
D = 286° 28' 44"  
R = 20.00'  
T = 7.91'  
L = 15.07'  
E = 1.51'  
N = 7,786.9840  
E = 4,866.5240

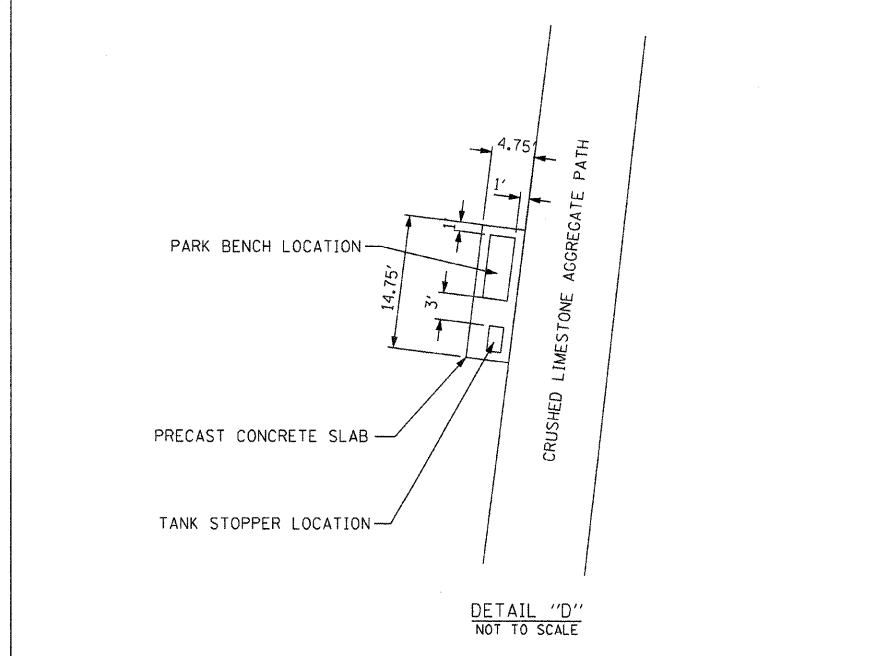
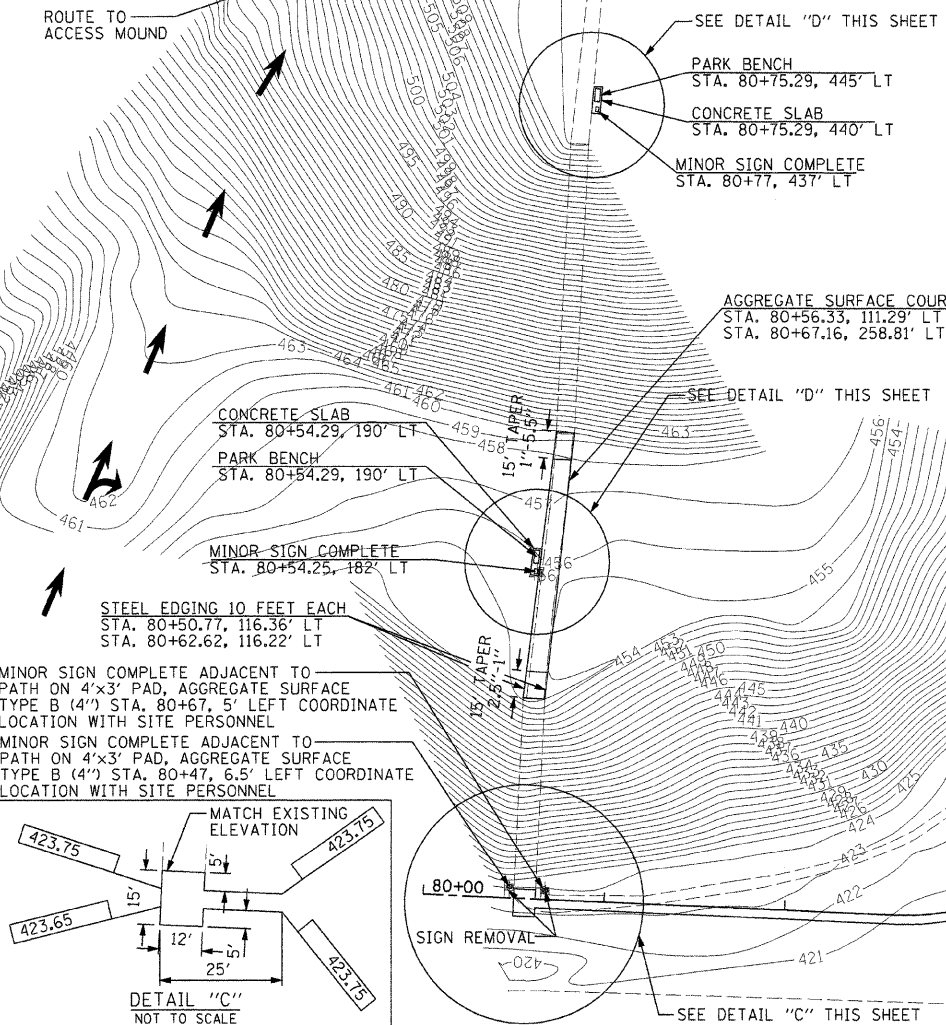

|                       |                     |                   |           |   |   |                 |                          |              |                     |                           |  |
|-----------------------|---------------------|-------------------|-----------|---|---|-----------------|--------------------------|--------------|---------------------|---------------------------|--|
| FILE NAME = *FILE#*   | USER NAME = *USER#* | DESIGNED - T.T.P. | REVISED - | <b>STATE OF ILLINOIS</b><br><b>DEPARTMENT OF TRANSPORTATION</b> | <b>MONKS MOUND AND WALL SIDEWALK</b><br><b>CAHOKIA MOUNDS STATE HISTORIC SITE</b> | F.A. RTE.       | SECTION                  | COUNTY       | TOTAL SHEETS        | SHEET NO.                 |  |
|                       |                     | DRAWN - S.D.K.    | REVISED - |   |   |                 |                          |              |                     |                           |  |
|                       |                     | CHECKED - R.H.D.  | REVISED - |   |   |                 |                          |              |                     |                           |  |
|                       |                     | DATE - 5/8/09     | REVISED - |   |   |                 |                          |              |                     |                           |  |
| PLOT SCALE = *SCALE#* |                     |                   |           |   |   | SCALE: 1" = 50' | SHEET NO. 7 OF 12 SHEETS | STA. TO STA. | FED. ROAD DIST. NO. | ILLINOIS FED. AID PROJECT |  |
| PLOT DATE = *DATE#*   |                     |                   |           |   |   |                 |                          |              | ST. CLAIR           | CONTRACT NO. 46060        |  |

|  |  |   |  |  |  |   |  |
|--|--|---|--|--|--|---|--|
| PROP. CURVE AT18<br>PI STA. = 400+91.08<br>Δ = 22° 39' 03" (RT)<br>D = 57° 17' 45"<br>R = 100.00'<br>T = 20.03'<br>L = 39.53'<br>E = 1.99'<br>N = 5,185.5983<br>E = 3,045.7930 | PROP. CURVE AT19<br>PI STA. = 402+21.43<br>Δ = 58° 16' 31" (RT)<br>D = 57° 17' 45"<br>R = 100.00'<br>T = 55.75'<br>L = 101.71'<br>E = 14.49'<br>N = 5,282.1861<br>E = 2,957.4838 | PROP. CURVE AT20<br>PI STA. = 403+66.17<br>Δ = 30° 50' 20" (LT)<br>D = 28° 38' 52"<br>R = 200.00'<br>T = 55.16'<br>L = 107.65'<br>E = 7.47'<br>N = 5,430.8364<br>E = 2,999.6559 | PROP. CURVE AT21<br>PI STA. = 405+45.84<br>Δ = 42° 09' 00" (RT)<br>D = 57° 17' 45"<br>R = 100.00'<br>T = 38.54'<br>L = 73.57'<br>E = 7.17'<br>N = 5,606.9727<br>E = 2,952.4593 | PROP. CURVE AT22<br>PI STA. = 406+42.91<br>Δ = 52° 47' 19" (LT)<br>D = 45° 50' 12"<br>R = 125.00'<br>T = 62.04'<br>L = 115.17'<br>E = 14.55'<br>N = 5,696.4630<br>E = 2,998.3519 | PROP. CURVE AT23<br>PI STA. = 407+30.52<br>Δ = 38° 02' 50" (RT)<br>D = 57° 17' 45"<br>R = 100.00'<br>T = 34.48'<br>L = 66.40'<br>E = 5.78'<br>N = 5,783.4912<br>E = 2,956.6268 | PROP. CURVE AT24<br>PI STA. = 408+92.57<br>Δ = 46° 53' 49" (LT)<br>D = 19° 05' 55"<br>R = 300.00'<br>T = 130.12'<br>L = 245.55'<br>E = 27.00'<br>N = 5,944.2072<br>E = 2,992.1824 | PROP. CURVE AT25<br>PI STA. = 410+45.15<br>Δ = 14° 07' 14" (RT)<br>D = 19° 05' 55"<br>R = 300.00'<br>T = 37.16'<br>L = 73.94'<br>E = 2.29'<br>N = 6,082.1948<br>E = 2,897.6215 |
|--|--|---|--|--|--|---|--|

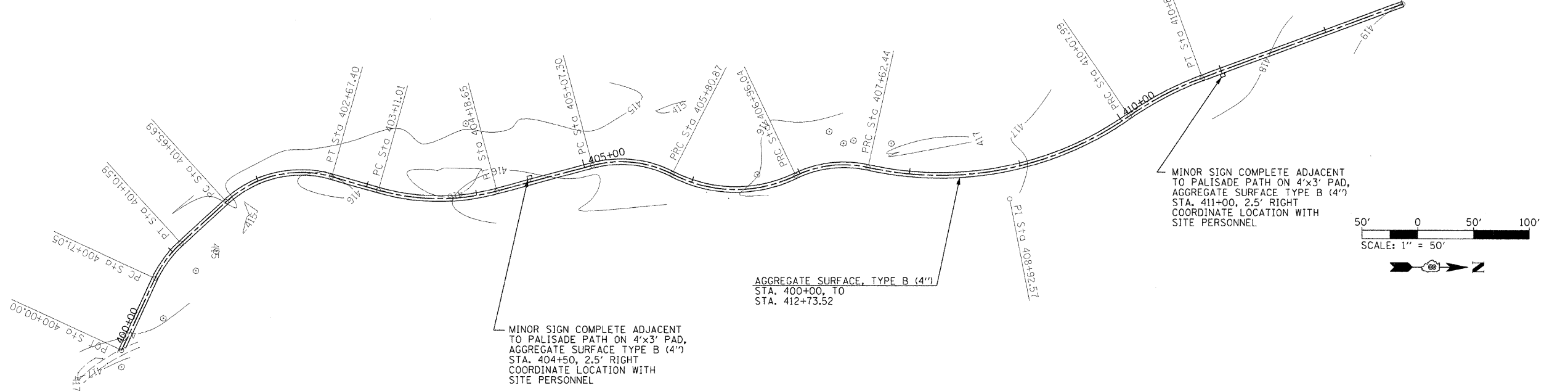

COORDINATE LOCATION OF PATHWAY, SEATING, SIGNAGE AND CONCRETE PADS WITH SITE PERSONELL

|   |  |   |  |  |   |   |  |
|---|--|---|--|--|---|---|--|
| PROP. CURVE AT6<br>PI STA. = 304+23.28<br>Δ = 59° 28' 15" (RT)<br>D = 190° 59' 09"<br>R = 30.00'<br>T = 17.14'<br>L = 31.14'<br>E = 4.55'<br>N = 5,058.2991<br>E = 3,888.5800 | PROP. CURVE AT7<br>PI STA. = 304+46.17<br>Δ = 61° 17' 33" (LT)<br>D = 381° 58' 19"<br>R = 15.00'<br>T = 8.89'<br>L = 16.05'<br>E = 2.44'<br>N = 5,066.5226<br>E = 3,913.2702 | PROP. CURVE AT8<br>PI STA. = 304+68.67<br>Δ = 47° 20' 24" (RT)<br>D = 163° 42' 08"<br>R = 35.00'<br>T = 15.34'<br>L = 28.92'<br>E = 3.21'<br>N = 5,090.3626<br>E = 3,917.5967 | PROP. CURVE AT9<br>PI STA. = 305+67.33<br>Δ = 10° 13' 47" (RT)<br>D = 57° 17' 45"<br>R = 100.00'<br>T = 8.95'<br>L = 17.85'<br>E = 0.40'<br>N = 5,144.1339<br>E = 4,002.4123 | PROP. CURVE AT10<br>PI STA. = 308+31.34<br>Δ = 61° 53' 12" (LT)<br>D = 38° 11' 50"<br>R = 150.00'<br>T = 89.93'<br>L = 162.02'<br>E = 24.89'<br>N = 5,243.6652<br>E = 4,246.9882 | PROP. CURVE AT11<br>PI STA. = 309+39.21<br>Δ = 48° 11' 33" (RT)<br>D = 71° 37' 11"<br>R = 80.00'<br>T = 35.78'<br>L = 67.29'<br>E = 7.64'<br>N = 5,368.6906<br>E = 4,260.0608 | PROP. CURVE AT12<br>PI STA. = 310+24.32<br>Δ = 20° 15' 43" (LT)<br>D = 19° 05' 55"<br>R = 300.00'<br>T = 53.61'<br>L = 106.09'<br>E = 4.75'<br>N = 5,421.0253<br>E = 4,332.5226 | PROP. CURVE AT13<br>PI STA. = 312+84.68<br>Δ = 11° 15' 50" (RT)<br>D = 5° 43' 46"<br>R = 1,000.00'<br>T = 98.61'<br>L = 196.59'<br>E = 4.85'<br>N = 5,638.0526<br>E = 4,478.3581 |
|---|--|---|--|--|---|---|--|

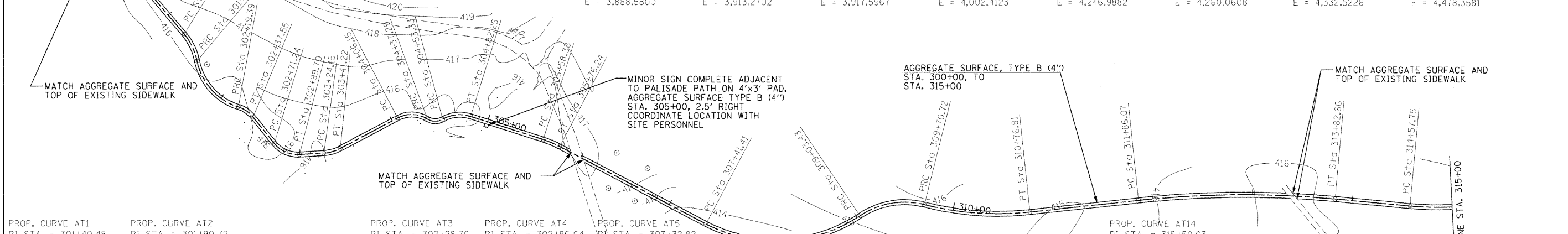

|  |  |  |   |  |   |
|--|--|--|---|--|---|
| PROP. CURVE AT1<br>PI STA. = 301+40.45<br>Δ = 28° 35' 31" (RT)<br>D = 95° 29' 35"<br>R = 60.00'<br>T = 15.29'<br>L = 29.94'<br>E = 1.92'<br>N = 4,931.6143<br>E = 3,699.6841 | PROP. CURVE AT2<br>PI STA. = 301+90.72<br>Δ = 61° 23' 50" (LT)<br>D = 95° 29' 35"<br>R = 60.00'<br>T = 35.62'<br>L = 64.30'<br>E = 9.78'<br>N = 4,907.2874<br>E = 3,744.4089 | PROP. CURVE AT3<br>PI STA. = 302+28.76<br>Δ = 34° 41' 00" (RT)<br>D = 190° 59' 09"<br>R = 30.00'<br>T = 9.37'<br>L = 18.16'<br>E = 1.43'<br>N = 4,931.6954<br>E = 3,782.2040 | PROP. CURVE AT4<br>PI STA. = 302+86.64<br>Δ = 54° 21' 37" (LT)<br>D = 190° 59' 09"<br>R = 30.00'<br>T = 15.40'<br>L = 28.46'<br>E = 3.72'<br>N = 4,930.6130<br>E = 3,840.6524 | PROP. CURVE AT5<br>PI STA. = 303+32.82<br>Δ = 24° 26' 49" (LT)<br>D = 143° 14' 22"<br>R = 40.00'<br>T = 8.67'<br>L = 17.02'<br>E = 0.93'<br>N = 4,969.5874<br>E = 3,869.5492 | PROP. CURVE AT14<br>PI STA. = 315+59.03<br>Δ = 37° 18' 39" (LT)<br>D = 19° 05' 55"<br>R = 300.00'<br>T = 101.28'<br>L = 195.36'<br>E = 16.64'<br>N = 5,831.9442<br>E = 4,673.3607 |
|--|--|--|---|--|---|

|                     |                    |                   |           |   |   |                          |      |           |                     |                           |              |           |
|---------------------|--------------------|-------------------|-----------|---|---|--------------------------|------|-----------|---------------------|---------------------------|--------------|-----------|
| FILE NAME = #JFILE# | USER NAME = #USER# | DESIGNED - T.T.P. | REVISED - | <b>STATE OF ILLINOIS<br/>DEPARTMENT OF TRANSPORTATION</b> | <b>PALISADE AGGREGATE PATH<br/>CAHOKIA MOUNDS STATE HISTORIC SITE</b> |                          |      | F.A. RTE. | SECTION             | COUNTY                    | TOTAL SHEETS | SHEET NO. |
|                     |                    | DRAWN - S.D.K.    | REVISED - |   | SCALE:  | SHEET NO. 8 OF 12 SHEETS | STA. | TO STA.   | FED. ROAD DIST. NO. | ILLINOIS FED. AID PROJECT | 12           | 8         |
|                     |                    | CHECKED - R.H.D.  | REVISED - |   | CONTRACT NO. 46060  |                          |      |           |                     |                           |              |           |
|                     |                    | DATE - 5/8/09     | REVISED - |   |   |                          |      |           |                     |                           |              |           |



PROP. CURVE SW10  
 PI STA. = 202+25.76  
 $\Delta = 27^\circ 29' 26''$  (RT)  
 D = 28' 38" 52"  
 R = 200.00'  
 T = 48.92'  
 L = 95.96'  
 E = 5.90'  
 N = 3,985.9839  
 E = 3,405.2566

PROP. CURVE SW14  
 PI STA. = 205+10.96  
 $\Delta = 1^\circ 05' 54''$  (LT)  
 D = 5' 43' 46"  
 R = 1,000.00'  
 T = 9.59'  
 L = 19.17'  
 E = 0.05'  
 N = 4,271.8918  
 E = 3,431.2521

PROP. CURVE SW13  
 PI STA. = 211+38.74  
 $\Delta = 9^\circ 52' 43''$  (RT)  
 D = 38' 11" 50"  
 R = 150.00'  
 T = 12.96'  
 L = 25.86'  
 E = 0.56'  
 N = 4,898.4511  
 E = 3,469.7099

PROP. CURVE SW11  
 PI STA. = 206+67.73  
 $\Delta = 1^\circ 11' 51''$  (LT)  
 D = 5' 43' 46"  
 R = 1,000.00'  
 T = 10.45'  
 L = 20.90'  
 E = 0.05'  
 N = 4,428.2651  
 E = 3,442.4524

PROP. CURVE SW12  
 PI STA. = 210+15.73  
 $\Delta = 1^\circ 36' 09''$  (RT)  
 D = 11' 27' 33"  
 R = 500.00'  
 T = 6.99'  
 L = 13.99'  
 E = 0.05'  
 N = 4,775.8193  
 E = 3,460.0545

COORDINATE LOCATION OF PATHWAY, SEATING, SIGNAGE AND CONCRETE PADS WITH SITE PERSONELL

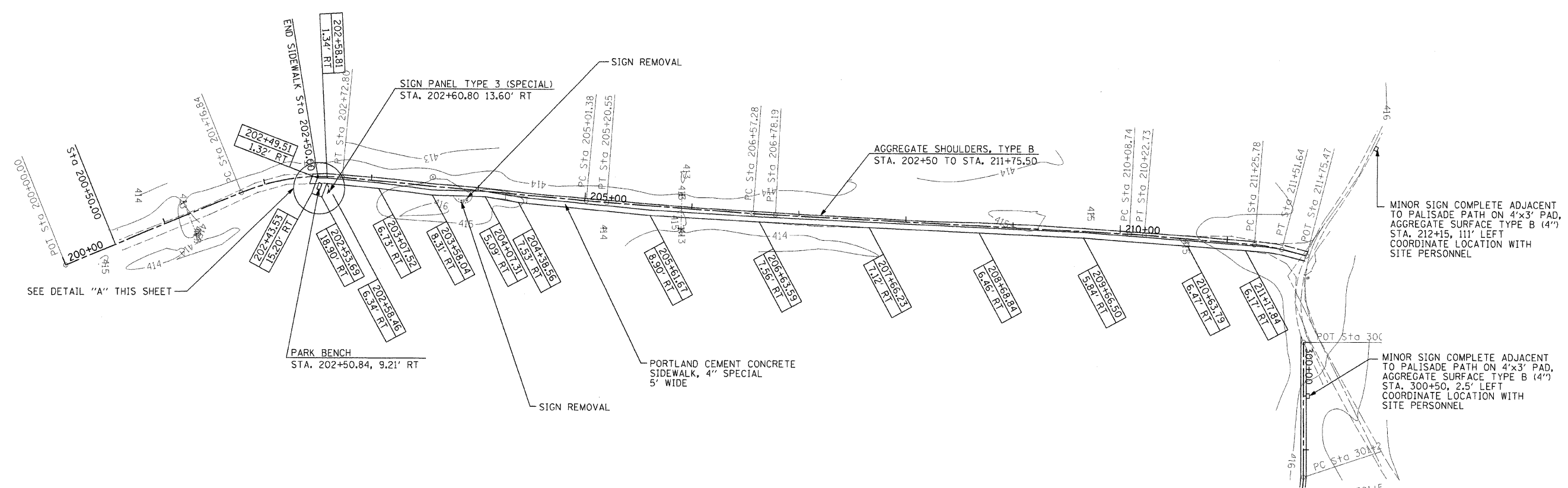
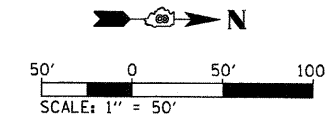
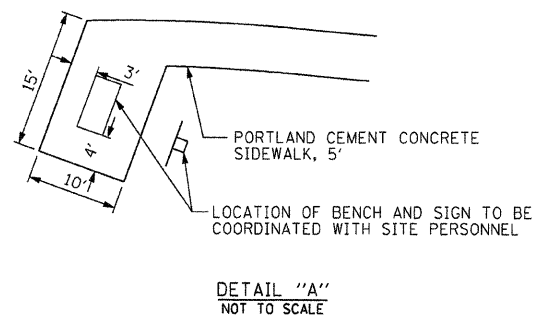

|                     |                      |                   |           |   |  |                          |           |         |           |              |           |
|---------------------|----------------------|-------------------|-----------|---|--|--------------------------|-----------|---------|-----------|--------------|-----------|
| FILE NAME = #FILEL# | USER NAME = #USER#   | DESIGNED - T.T.P. | REVISED - | <b>STATE OF ILLINOIS<br/>DEPARTMENT OF TRANSPORTATION</b> | <b>TWIN MOUNDS SIDEWALK<br/>CAHOKIA MOUNDS STATE HISTORIC SITE</b> |                          | F.A. RTE. | SECTION | COUNTY    | TOTAL SHEETS | SHEET NO. |
|                     | PLOT SCALE = #SCALE# | DRAWN - S.D.K.    | REVISED - |   | SCALE:   | SHEET NO. 8 OF 12 SHEETS | STA.      | TO STA. | ST. CLAIR | 12           | 9         |
|                     | PLOT DATE = #DATE#   | CHECKED - R.H.D.  | REVISED - |   | CONTRACT NO. 46060   |                          |           |         |           |              |           |
|                     |                      | DATE - 5/8/09     | REVISED - |   | FED. ROAD DIST. NO. [ILLINOIS] FED. AID PROJECT                    |                          |           |         |           |              |           |

JOB NO. 250-061-G VASCONCELLES ENGINEERING CORP. DESIGN FIRM REGISTRATION NUMBER 184-002107

PROFILE SUBMITTED BY DATE  
 GRADES CHECKED PLOTTED  
 NOTE BOOK NO. STRUCTURE NOTATION DRG NO.

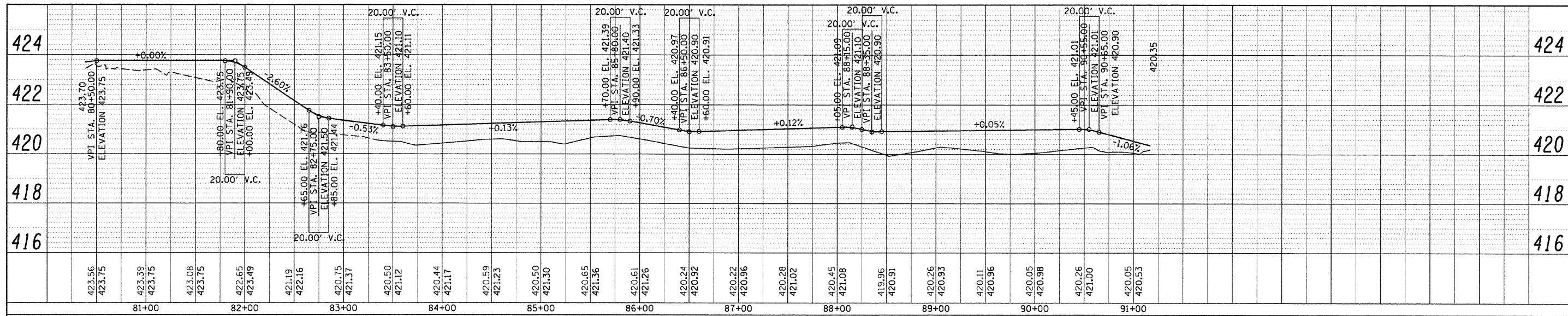

MONK SIDEWALK

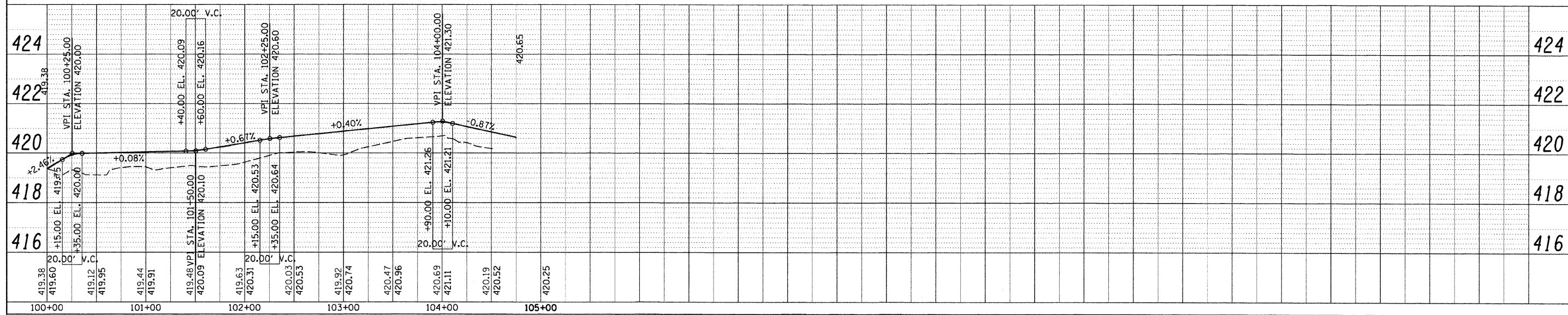

WALL SIDEWALK

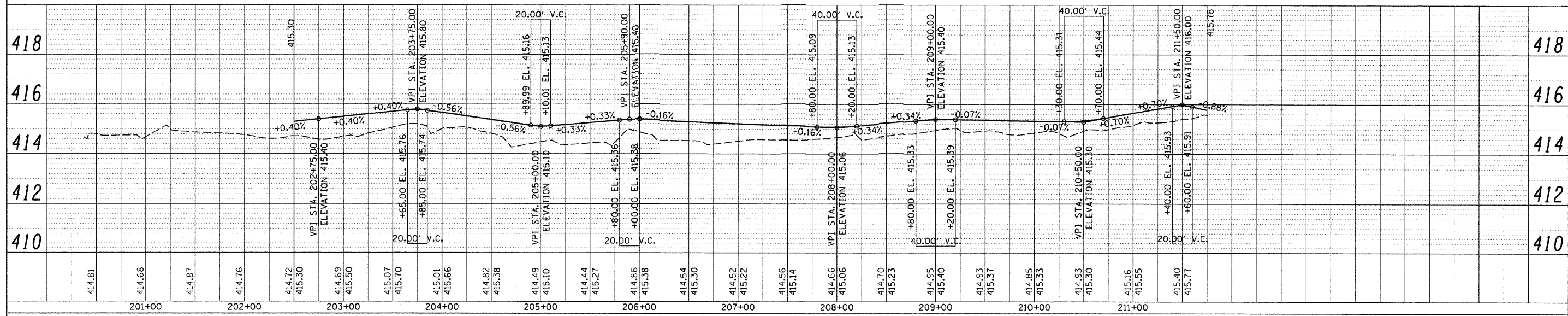

TWIN MOUNDS SIDEWALK

|             |                    |                   |           |   |   |                           |      |           |                    |          |                  |           |    |
|-------------|--------------------|-------------------|-----------|---|---|---------------------------|------|-----------|--------------------|----------|------------------|-----------|----|
| FILE NAME = | USER NAME = #USER# | DESIGNED - S.D.K. | REVISED - | <b>STATE OF ILLINOIS</b><br><b>DEPARTMENT OF TRANSPORTATION</b> | <b>SIDEWALK PROFILES</b><br><b>CAHOKIA MOUNDS STATE HISTORIC SITE</b> |                           |      | F.A. RTE. | SECTION            | COUNTY   | TOTAL SHEETS     | SHEET NO. |    |
| #FILE#      |                    | CHECKED - T.T.P.  | REVISED - |   | SCALE:  | SHEET NO. 10 OF 12 SHEETS | STA. | TO STA.   | ST. CLAIR          | ILLINOIS | FED. AID PROJECT | 12        | 10 |
|             |                    | DRAWN - S.D.K.    | REVISED - |   |   |                           |      |           | CONTRACT NO. 46060 |          |                  |           |    |
|             |                    | CHECKED - 5/8/09  | REVISED - |   |   |                           |      |           |                    |          |                  |           |    |

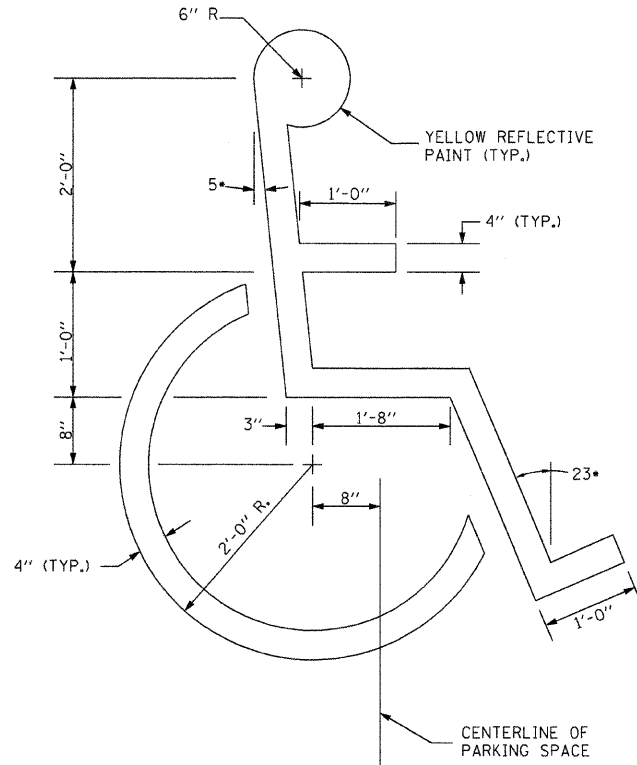
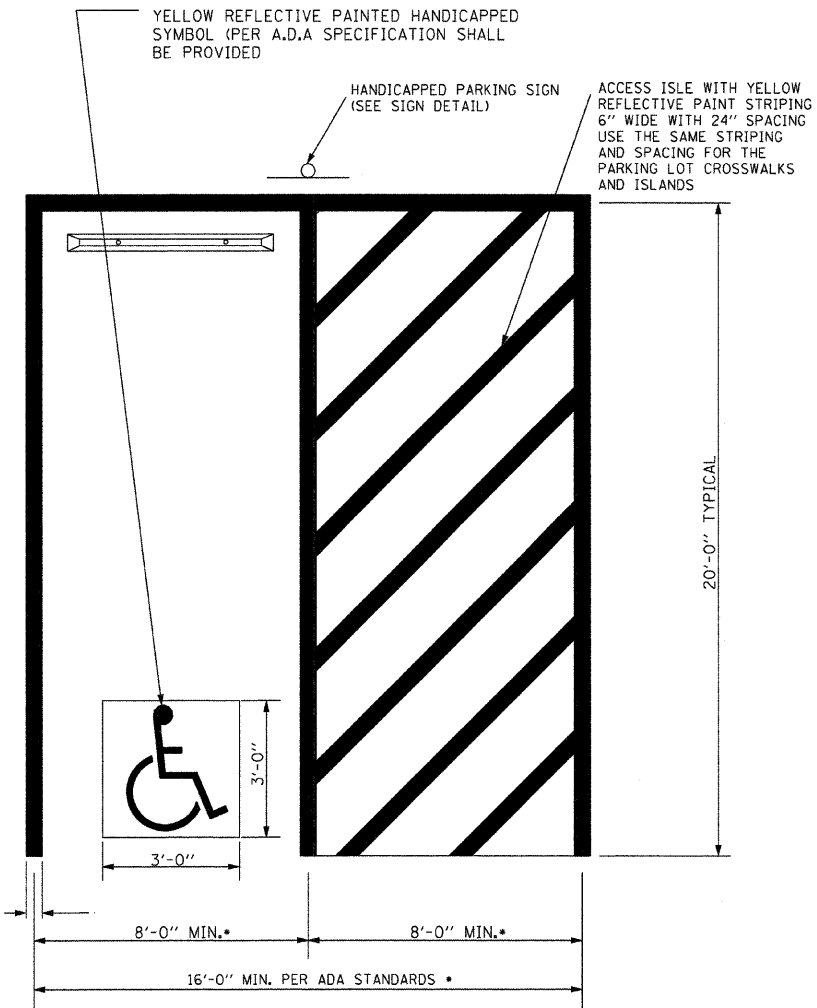

HANDICAPPED SYMBOL LAYOUT DETAIL  
NOT TO SCALE

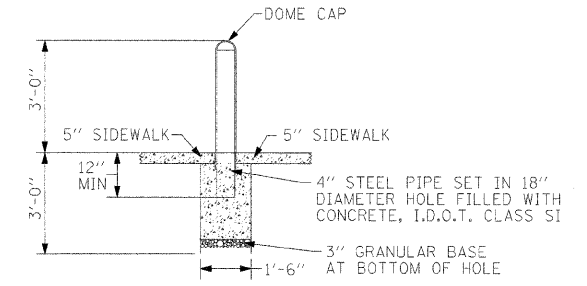

BOLLARD DETAIL  
NOT TO SCALE

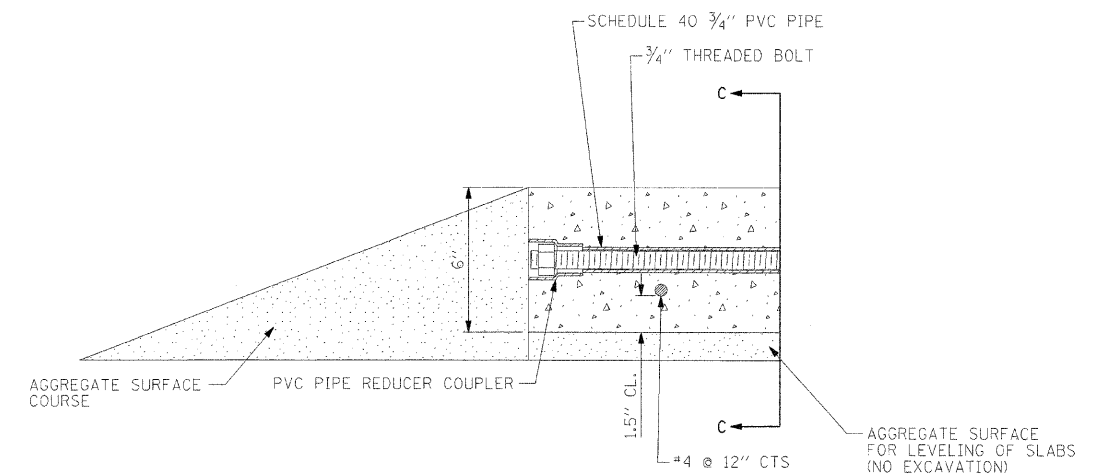

SECTION C-C

• SEE PLANS TO VERIFY DIMENSIONS

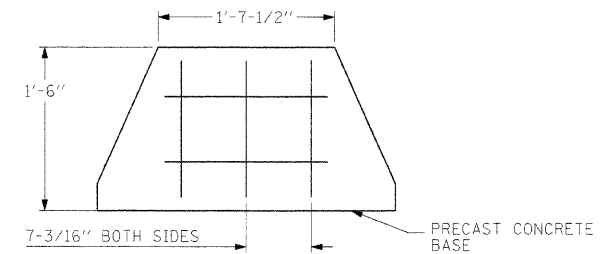
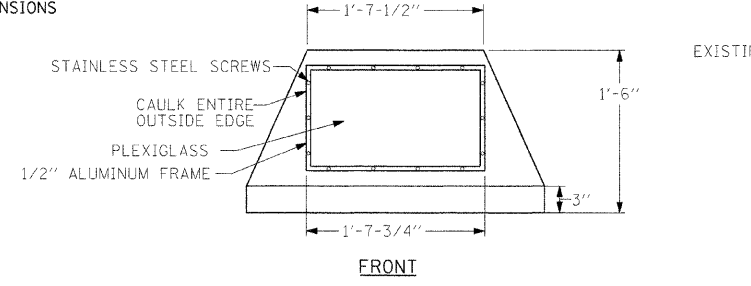
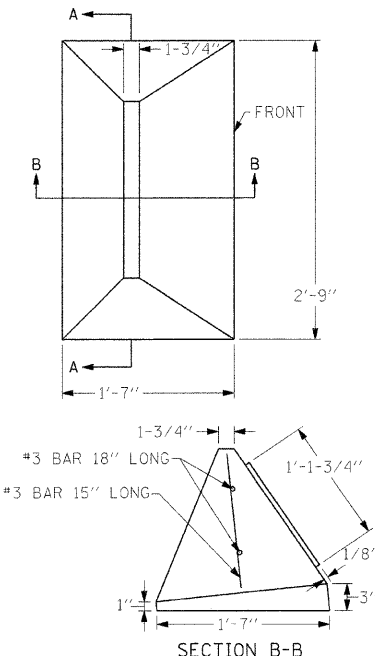

MINOR SIGN COMPLETE  
NOT TO SCALE

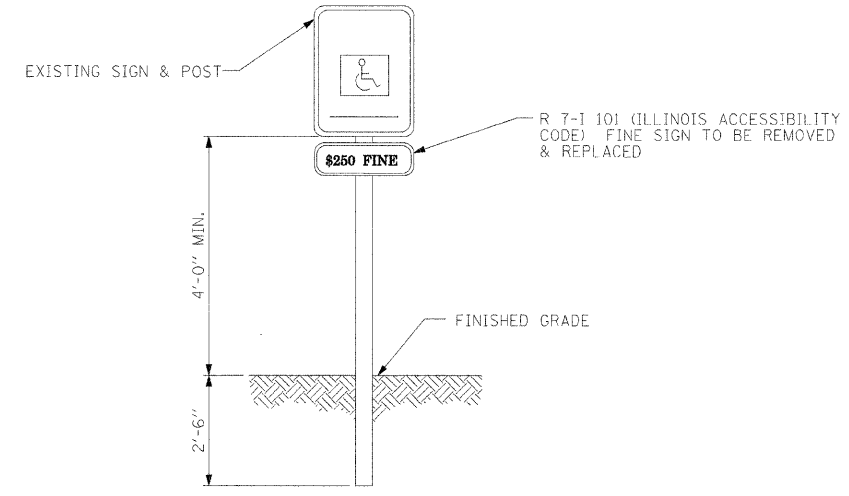

HANDICAPPED PARKING SIGNS  
NOT TO SCALE

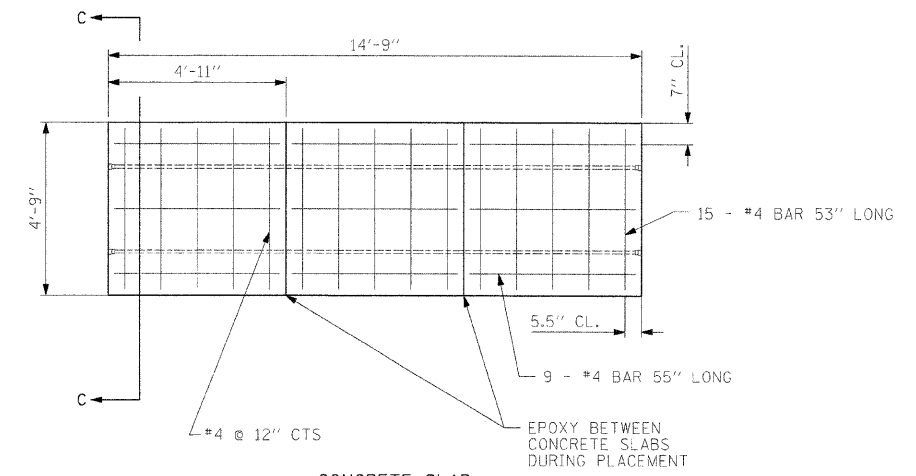

CONCRETE SLAB  
NOT TO SCALE

|                     |                    |                   |           |
|---------------------|--------------------|-------------------|-----------|
| FILE NAME = #FILEL# | USER NAME = #USER# | DESIGNED - T.T.P. | REVISED - |
|                     |                    | DRAWN - S.D.K.    | REVISED - |
|                     |                    | CHECKED - R.H.D.  | REVISED - |
|                     |                    | DATE - 5/8/09     | REVISED - |

STATE OF ILLINOIS  
DEPARTMENT OF TRANSPORTATION

HANDICAP PARKING SPACE AND CONCRETE SLAB DETAILS  
CAHOKIA MOUNDS STATE HISTORIC SITE

SCALE: SHEET NO. 11 OF 12 SHEETS STA. TO STA.

|                     |         |                           |              |           |
|---------------------|---------|---------------------------|--------------|-----------|
| F.A. RTE.           | SECTION | COUNTY                    | TOTAL SHEETS | SHEET NO. |
|                     |         | ST. CLAIR                 | 12           | 11        |
| CONTRACT NO. 46060  |         |                           |              |           |
| FED. ROAD DIST. NO. |         | ILLINOIS FED. AID PROJECT |              |           |

JOB NO. 250-061-G VASCONCELLES ENGINEERING CORP. DESIGN FIRM REGISTRATION NUMBER 184-002107

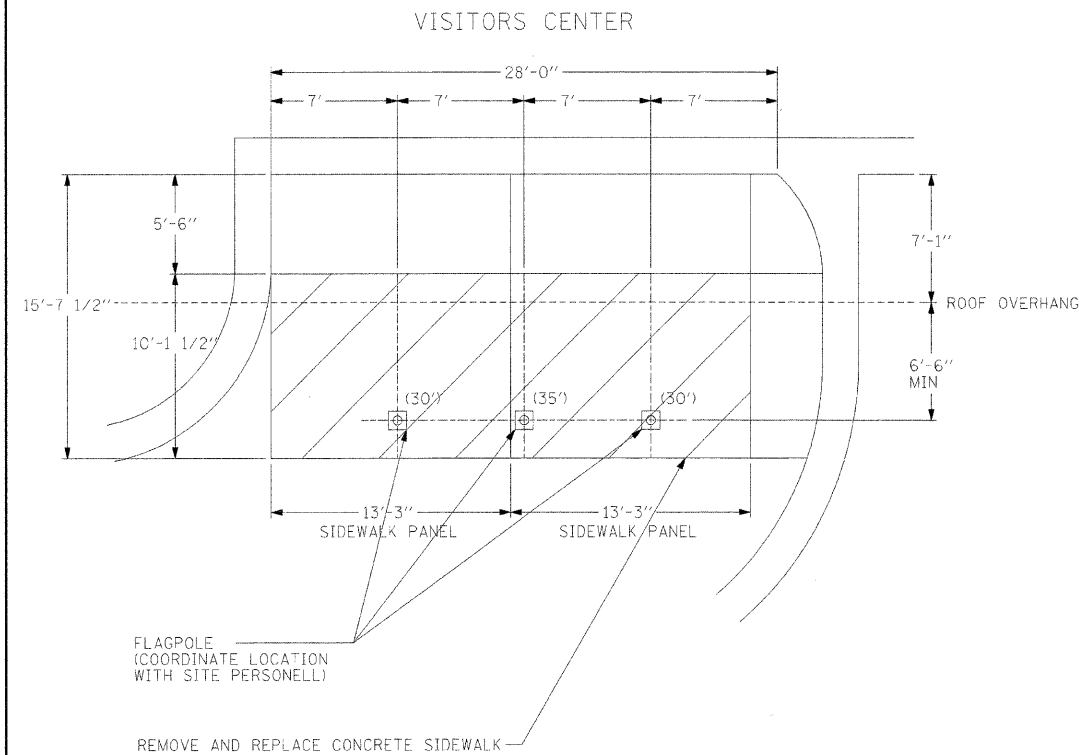

FLAGPOLE  
(COORDINATE LOCATION  
WITH SITE PERSONELL)

REMOVE AND REPLACE CONCRETE SIDEWALK

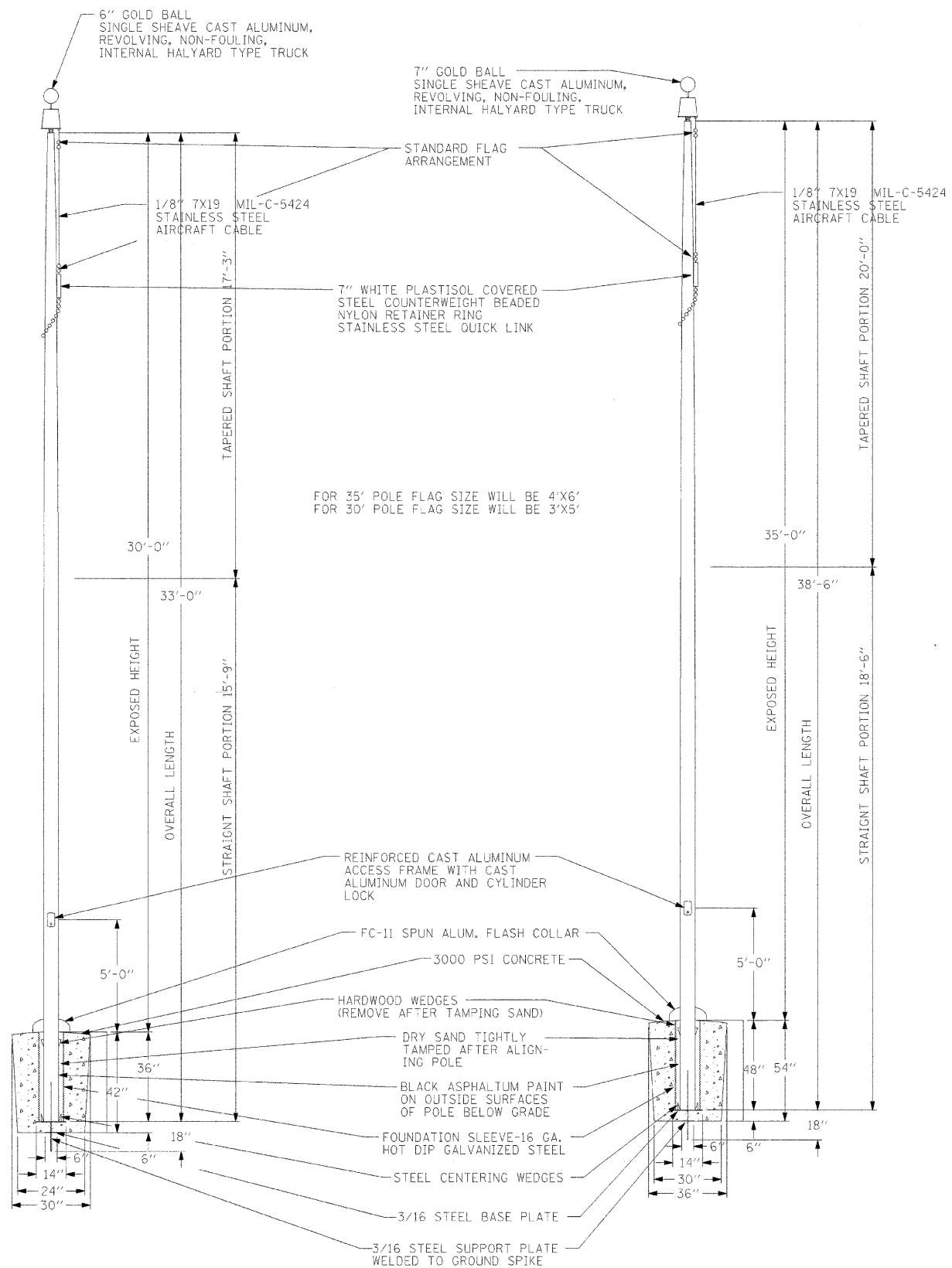

FOR 35' POLE FLAG SIZE WILL BE 4'X6'  
FOR 30' POLE FLAG SIZE WILL BE 3'X5'

REVOLVING NON-FOULING INTERNAL HALYARD TRUCK, CAST ALUMINUM BODY, SEALED BEARINGS AND 2-1/2" DIAMETER PLATED STEEL SHEAVE

STAINLESS STEEL, DIRECT DRIVE WINCH WITH REMOVABLE CRANK HANDLE

ALL SHAFTS WITH AN OVERALL LENGTH OF MORE THAN 38'-6" ARE SHIPPED IN TWO SECTIONS. SHAFTS WITH AN OVERALL LENGTH OF MORE THAN 49'-6" ARE SHIPPED IN THREE SECTIONS.

EACH SECTION MATCH MARKED FOR FIELD ASSEMBLY. EXPOSED PORTION OF JAM SLEEVE MUST BE WELL LUBRICATED PRIOR TO ASSEMBLY.

1-1/2" MAX. SHOP GAP ALLOWED FOR FIELD FITTING (RAM FOR TIGHT JOINT).

1-35' FLAGPOLE  
2-30' FLAGPOLE

EXP/HT. 30' OVERALL HT. 33' SHIP IN 1 SEC.  
BUTT. DIA. 6" TOP DIA. 3 1/2" WALL THICKNESS .188  
FINISH : 150 GRIT HIGH POLISH

EXP/HT. 35' OVERALL HT. 38'-6" SHIP IN 1 SEC.  
BUTT. DIA. 7" TOP DIA. 3 1/2" WALL THICKNESS .188  
FINISH : 150 GRIT HIGH POLISH

|             |                    |                   |           |
|-------------|--------------------|-------------------|-----------|
| FILE NAME = | USER NAME = #USER# | DESIGNED - T.T.P. | REVISED - |
| #FILEL#     |                    | DRAWN - S.D.K.    | REVISED - |
|             |                    | CHECKED - R.H.D.  | REVISED - |
|             |                    | DATE - 5/8/09     | REVISED - |

**STATE OF ILLINOIS**  
**DEPARTMENT OF TRANSPORTATION**

**FLAGPOLE DETAILS**  
**CAHOKIA MOUNDS STATE HISTORIC SITE**

|   |         |           |              |           |
|---|---------|-----------|--------------|-----------|
| F.A. RTE.                                     | SECTION | COUNTY    | TOTAL SHEETS | SHEET NO. |
|   |         | ST. CLAIR | 12           | 12        |
| CONTRACT NO. 46060                            |         |           |              |           |
| FED. ROAD DIST. NO. ILLINOIS FED. AID PROJECT |         |           |              |           |

JOB NO. 250-061-G VASCONCELLES ENGINEERING CORP. DESIGN FIRM REGISTRATION NUMBER 184-002107