

V.E.C. CONTROL POINT #1
N = 777409.11
E = 2315140.99

V.E.C. CONTROL POINT #2
N = 777645.73
E = 2315223.49

V.E.C. CONTROL POINT #3
N = 778081.82
E = 2315618.58

STATION 10+00
N = 776462.17
E = 2315057.92

P.C. STATION 18+09.28
N = 777241.18
E = 2315277.19

P.T. STATION 18+86.26
N = 777315.81
E = 2315268.91

P.C. STATION 19+32.47
N = 777356.47
E = 2315246.93

P.T. STATION 19+81.82
N = 777403.81
E = 2315234.10

STATION 23+86.93
N = 777808.92
E = 2315234.10

STATION 13+00, 53.68' LT
N = 776765.22
E = 2315088.50

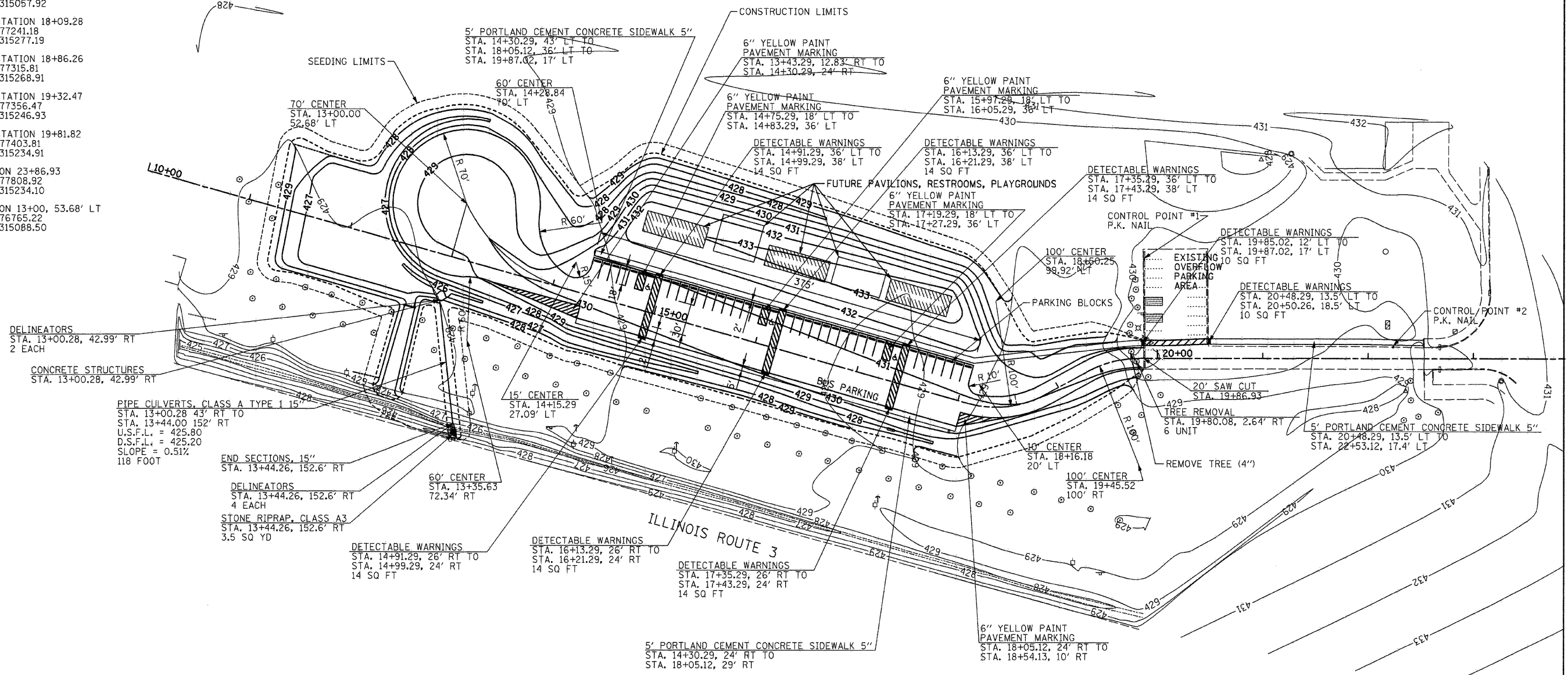

DELINEATORS
STA. 13+00.28, 42.99' RT
2 EACH

CONCRETE STRUCTURES
STA. 13+00.28, 42.99' RT

PIPE CULVERTS, CLASS A TYPE 1 15"
STA. 13+00.28 43' RT TO
STA. 13+44.00 152' RT
U.S.F.L. = 425.80
D.S.F.L. = 425.20
SLOPE = 0.51%
116 FOOT

END SECTIONS, 15"
STA. 13+44.26, 152.6' RT

DELINEATORS
STA. 13+44.26, 152.6' RT
4 EACH

STONE RIPRAP, CLASS A3
STA. 13+44.26, 152.6' RT
3.5 SQ YD

DETECTABLE WARNINGS
STA. 14+91.29, 26' RT TO
STA. 14+99.29, 24' RT
14 SQ FT

DETECTABLE WARNINGS
STA. 16+13.29, 26' RT TO
STA. 16+21.29, 24' RT
14 SQ FT

DETECTABLE WARNINGS
STA. 17+35.29, 26' RT TO
STA. 17+43.29, 24' RT
14 SQ FT

5' PORTLAND CEMENT CONCRETE SIDEWALK 5"
STA. 14+30.29, 24' RT TO
STA. 18+05.12, 29' RT

6" YELLOW PAINT PAVEMENT MARKING
STA. 18+05.12, 24' RT TO
STA. 18+54.13, 10' RT

CONTAINER GROWN, 3 GALLON ACER SACCHARIUM (SUGAR MAPLE) TREES TO BE PLANTED IN COORDINATION WITH SITE PERSONNEL

FILE NAME =	USER NAME = #USER#	DESIGNED - R.H.D.	REVISED -	STATE OF ILLINOIS DEPARTMENT OF TRANSPORTATION		PROPOSED LAYOUT LEWIS AND CLARK STATE HISTORIC SITE			F.A. RTE.	SECTION	COUNTY	TOTAL SHEETS	SHEET NO.
#FILEL#		DRAWN - S.D.K.	REVISED -			SCALE: 1"=50'	SHEET NO. 4 OF 13 SHEETS	STA. TO STA.	FED. ROAD DIST. NO.	ILLINOIS FED. AID PROJECT	MADISON	13	4
PLOT SCALE = #SCALE#		CHECKED - R.H.D.	REVISED -				CONTRACT NO. 460						
PLOT DATE = #DATE#		DATE - 4/8/09	REVISED -										