

F.A.I. RTE.	SECTION	COUNTY	TOTAL SHEETS	SHEET NO.
94	2005-036 I	COOK	45	10
STA. 135+99.6 (SB I-57) TO STA. 2031+23.0 (NB FORD)		STA. 1364+78.8 (SB RYAN)		TO STA. 2364+99.1 (NB RYAN)
FED. ROAD DIST. NO.	ILLINOIS	FED. AID PROJECT		

60A07

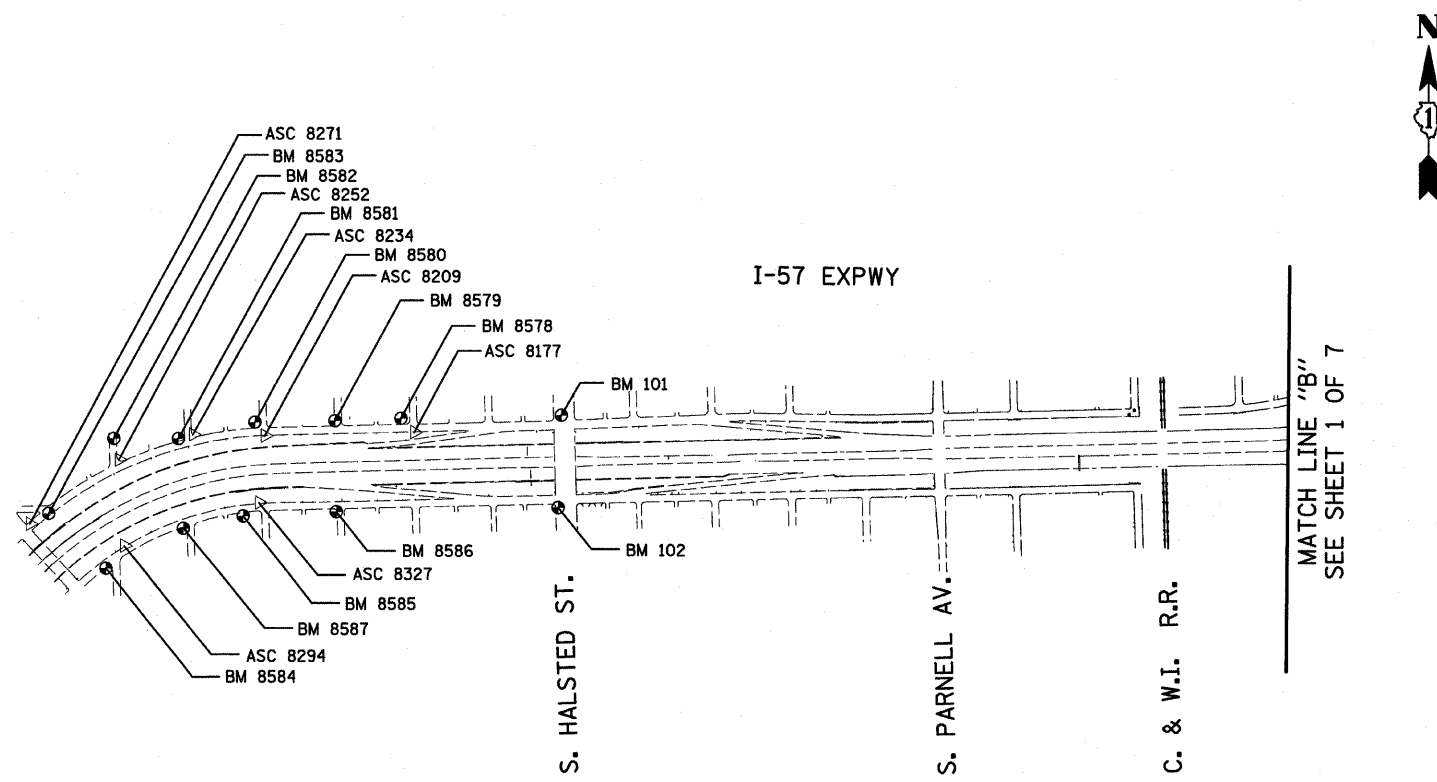

American Surveying Consultants, P.C.  
 SURVEYORS-ENGINEERS-GEODETISTS-MAPPING SCIENTISTS  
 1637 Piquette Rd., Chicago, IL 60601 606 N. Northway, Elmhurst, IL 60120  
 773-585-1234 773-585-1234

REVISIONS	
NAME	DATE

ILLINOIS DEPARTMENT OF TRANSPORTATION  
 F.A.I. 94 (DAN RYAN EXPRESSWAY)  
 SURVEY TIES FOR CONTROL POINTS  
 SHEET 2 OF 7

SCALE: 1"=400'  
 DATE: FEBRUARY 13, 2009  
 DRAWN BY: GSP  
 CHECKED BY: MMW

P:\02373\road\639\1391\6063ad.dwg 3/19/2009 11:45:31 AM