

F.A.I. RTE.	SECTION	COUNTY	TOTAL SHEETS	SHEET NO.
94	2005-036 I	COOK	45	16
STA. 135+95.6 (SB I-57) TO STA. 1364+78.8 (SB RYAN)				
STA. 2031+23.0 (NB FORD) TO STA. 2364+99.1 (NB RYAN)				
FED. ROAD DIST. NO. ILLINOIS FED. AID PROJECT				

60A07

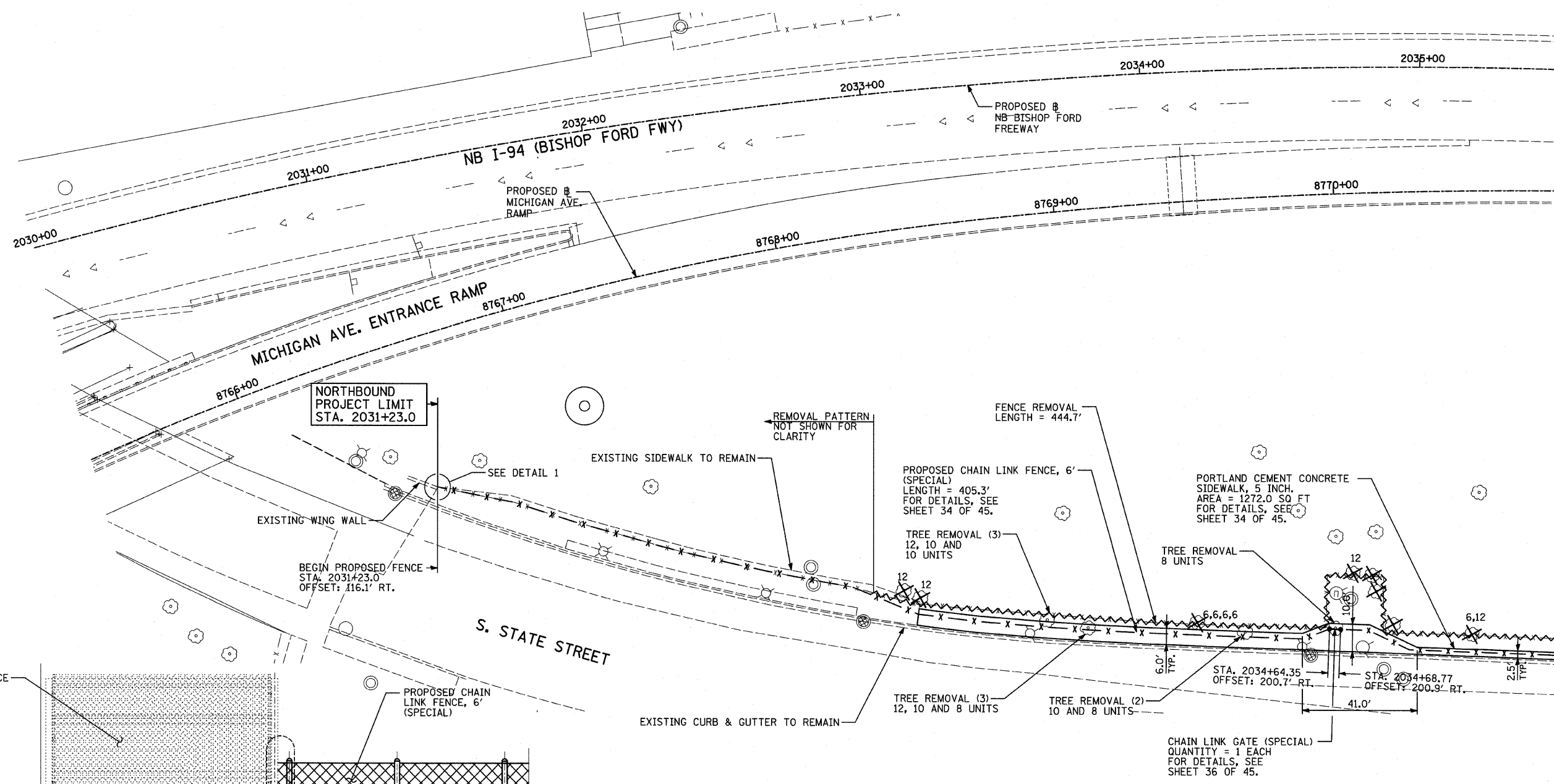

MATCHLINE NB FORD STA. 2035+50.00

NORTHBOUND PROJECT LIMIT STA. 2031+23.0

BEGIN PROPOSED FENCE STA. 2031+23.0 OFFSET: 116.1' RT.

REMOVAL PATTERN NOT SHOWN FOR CLARITY

FENCE REMOVAL LENGTH = 444.7'

PROPOSED CHAIN LINK FENCE, 6' (SPECIAL) LENGTH = 405.3' FOR DETAILS, SEE SHEET 34 OF 45.

PORTLAND CEMENT CONCRETE SIDEWALK, 5 INCH. AREA = 1272.0 SQ FT FOR DETAILS, SEE SHEET 34 OF 45.

TREE REMOVAL (3) 12, 10 AND 8 UNITS

TREE REMOVAL (2) 10 AND 8 UNITS

CHAIN LINK GATE (SPECIAL) QUANTITY = 1 EACH FOR DETAILS, SEE SHEET 36 OF 45.

EXISTING FENCE

EXISTING PARAPET

TOP OF EXISTING SIDEWALK

SEE GENERAL NOTE 6 ON SHEET 2 OF 45.

PROPOSED CHAIN LINK FENCE, 6' (SPECIAL)

S. STATE STREET

EXISTING CURB & GUTTER TO REMAIN

**LEGEND:**

- FENCE REMOVAL
- TREE REMOVAL (UNITS) (NO UNIT SHOWN = <6 OR CALLED OUT)
- INLET FILTER

**NOTES:**

1. THE CONTRACTOR SHALL USE THE EXCAVATED MATERIALS FROM THE SIDEWALK CONSTRUCTION TO BACKFILL THE AREA BEHIND THE SIDEWALK. A QUANTITY OF "SEEDING, CLASS 2A" HAS BEEN PROVIDED TO RESEED THE BACKFILLED AREAS.
2. FOR FENCE MOUNTED ON CONCRETE PAD DETAILS, SEE SHEET 34 OF 45.

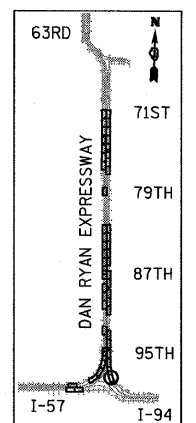

LOCATION MAP

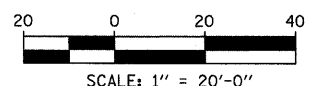

REVISIONS	
NAME	DATE

ILLINOIS DEPARTMENT OF TRANSPORTATION  
**F.A.I. 94 (DAN RYAN EXPRESSWAY)  
 PROPOSED PLAN  
 ALONG STATE STREET FROM  
 98TH TO 95TH ST.  
 NB FORD STA. 2030+00 TO STA. 2035+50**

SCALE: 1"=20'  
 DATE: FEBRUARY 13, 2009  
 DRAWN BY: MAF, AMB  
 CHECKED BY: TGB, MI

**TYLIN** INTERNATIONAL

**DETAIL 1**  
(LOOKING SOUTH)

3/19/2009 11:45:50 AM