

F.A.I. RTE.	SECTION	COUNTY	TOTAL SHEETS	SHEET NO.
94	2005-036 I	COOK	45	19
STA. 135+99.6 (SB I-57) TO STA. 1364+78.8 (SB RYAN)		TO STA. 2364+99.1 (NB RYAN)		
FED. ROAD DIST. NO.		ILLINOIS	FED. AID PROJECT	

60A07

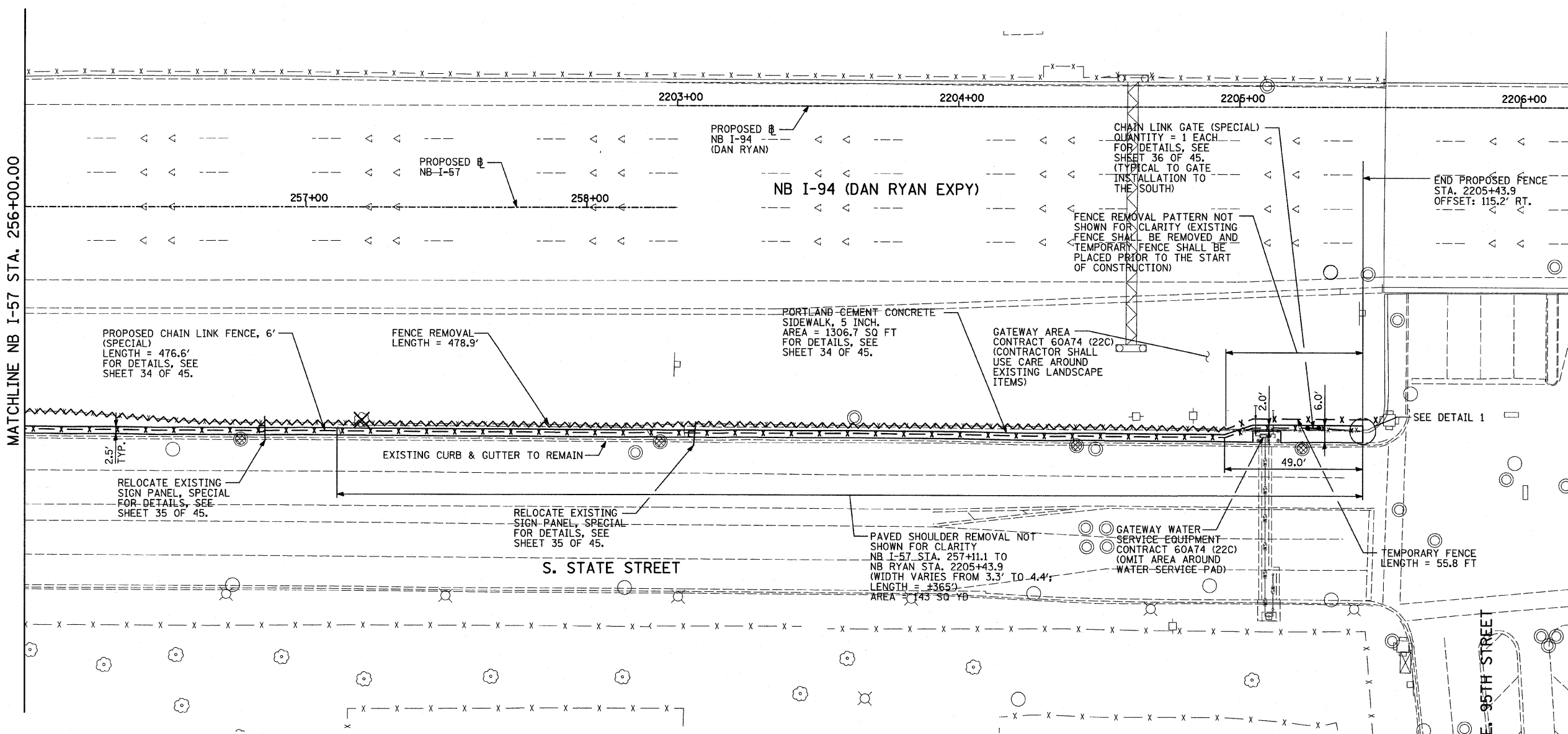

MATCHLINE NB I-57 STA. 256+00.00

PROPOSED CHAIN LINK FENCE, 6' (SPECIAL) LENGTH = 476.6' FOR DETAILS, SEE SHEET 34 OF 45.

FENCE REMOVAL LENGTH = 478.9'

PORTLAND CEMENT CONCRETE SIDEWALK, 5 INCH. AREA = 1306.7 SQ FT FOR DETAILS, SEE SHEET 34 OF 45.

GATEWAY AREA CONTRACT 60A74 (22C) (CONTRACTOR SHALL USE CARE AROUND EXISTING LANDSCAPE ITEMS)

RELOCATE EXISTING SIGN PANEL, SPECIAL FOR DETAILS, SEE SHEET 35 OF 45.

RELOCATE EXISTING SIGN PANEL, SPECIAL FOR DETAILS, SEE SHEET 35 OF 45.

PAVED SHOULDER REMOVAL NOT SHOWN FOR CLARITY NB I-57 STA. 257+11.1 TO NB RYAN STA. 2205+43.9 (WIDTH VARIES FROM 3.3' TO 4.4'; LENGTH = 365'; AREA = 143 SQ FT)

GATEWAY WATER SERVICE EQUIPMENT CONTRACT 60A74 (22C) (OMIT AREA AROUND WATER SERVICE PAD)

TEMPORARY FENCE LENGTH = 55.8 FT

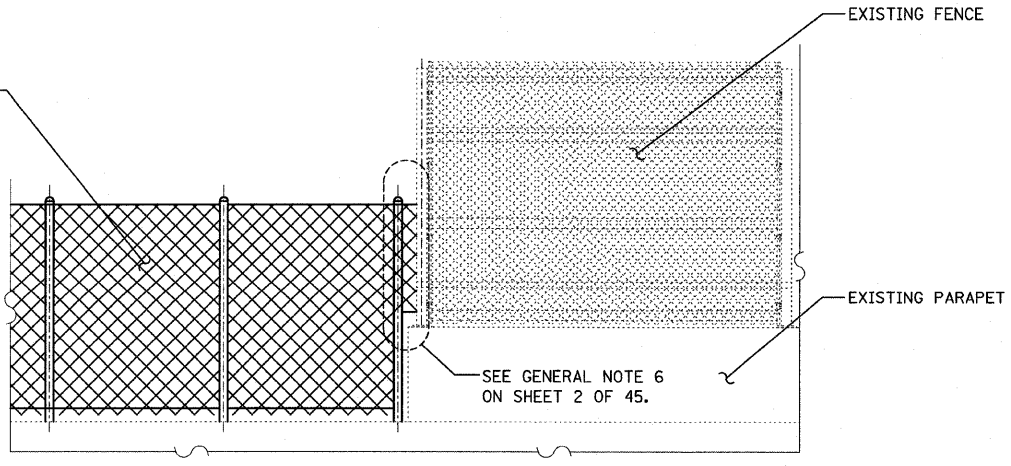

**DETAIL 1**  
(LOOKING WEST)

- LEGEND:**
- FENCE REMOVAL
  - TREE REMOVAL (UNITS) (NO UNIT SHOWN = 6 OR CALLED OUT)
  - INLET FILTER

- NOTES:**
- THE CONTRACTOR SHALL USE THE EXCAVATED MATERIALS FROM THE SIDEWALK CONSTRUCTION TO BACKFILL THE AREA BEHIND THE SIDEWALK. A QUANTITY OF "SEEDING, CLASS 2A" HAS BEEN PROVIDED TO RESEED THE BACKFILLED AREAS.
  - FOR FENCE MOUNTED ON CONCRETE PAD DETAILS, SEE SHEET 34 OF 45.

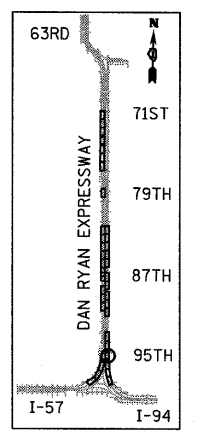

LOCATION MAP

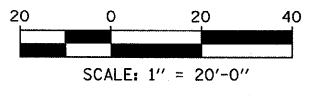

REVISIONS	
NAME	DATE

ILLINOIS DEPARTMENT OF TRANSPORTATION  
**F.A.I. 94 (DAN RYAN EXPRESSWAY) PROPOSED PLAN**  
**ALONG STATE STREET FROM 98TH ST. TO 95TH ST. NB I-57 STA. 256+00 TO NB RYAN STA. 2206+00**

SCALE: 1"=20'  
DATE: FEBRUARY 13, 2009

DRAWN BY: MAF, AMB  
CHECKED BY: TGB, MI

**TYLIN** INTERNATIONAL

3/19/2009 11:45:54 AM