

F.A.I. RTE.	SECTION	COUNTY	TOTAL SHEETS	SHEET NO.
94	2005-036 I	COOK	45	24
STA. 135+99.6 (SB I-57) TO STA. 1364+78.8 (SB RYAN)				
STA. 2031+23.0 (NB FORD) TO STA. 2364+99.1 (NB RYAN)				
FED. ROAD DIST. NO. ILLINOIS		FED. AID PROJECT		

60A07

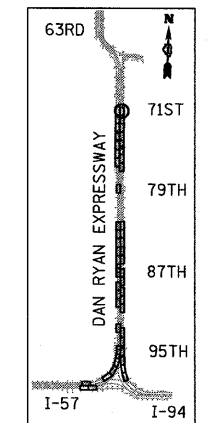
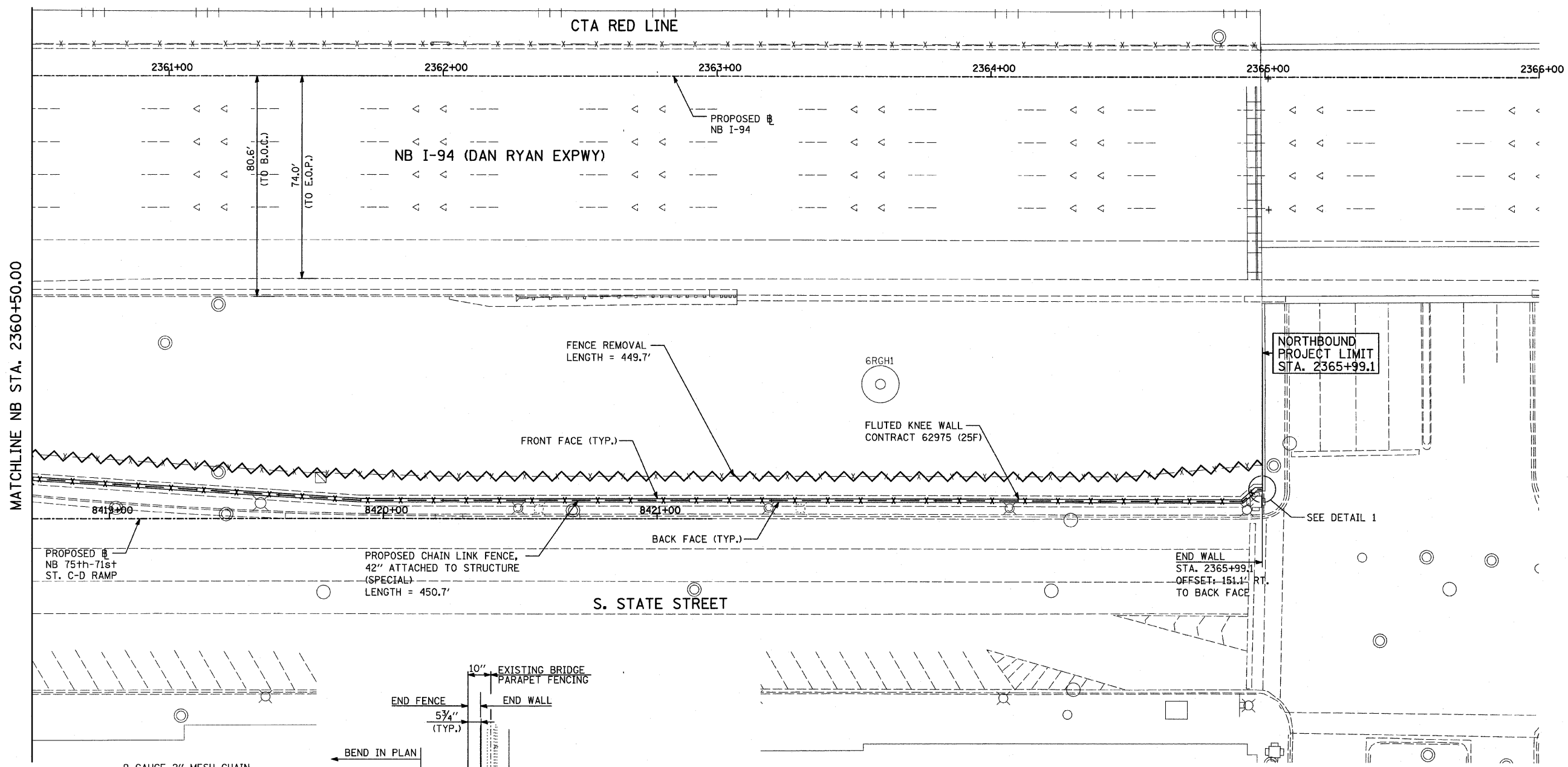

LOCATION MAP

MATCHLINE NB STA. 2360+50.00

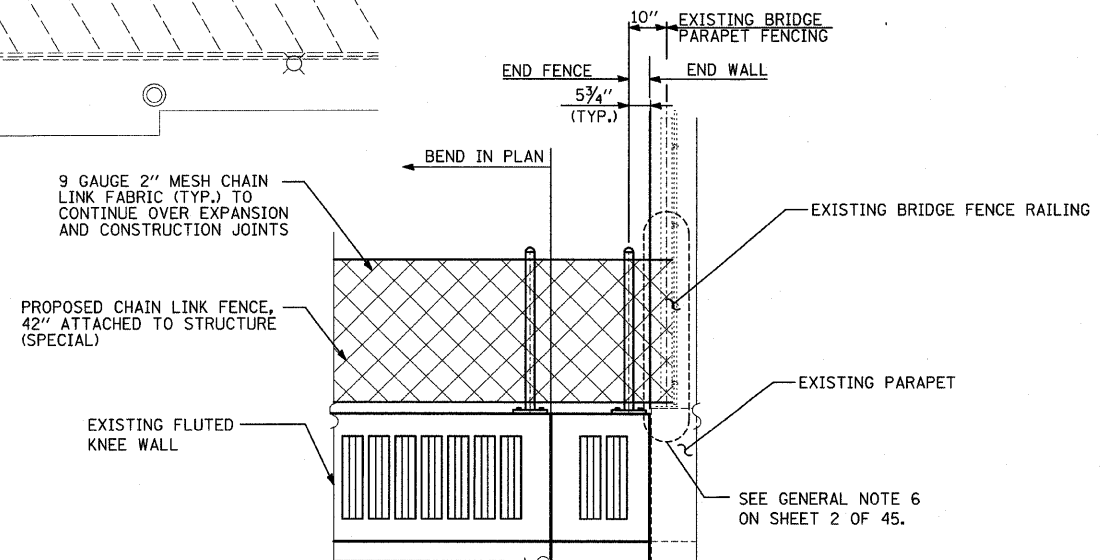

DETAIL 1
(LOOKING WEST)

LEGEND:

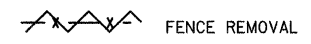

NOTES:

- FOR CHAIN LINK FENCE, 42" ATTACHED TO STRUCTURE (SPECIAL), SEE SHEET 33 OF 45.

REVISIONS	
NAME	DATE

ILLINOIS DEPARTMENT OF TRANSPORTATION
F.A.I. 94 (DAN RYAN EXPRESSWAY)
PROPOSED PLAN
NB I-94 (DAN RYAN EXPRESSWAY)
STA. 2360+50.00 TO STA. 2366+00.00
CONTRACT 25F LOCATION

SCALE: 1"=20'
DATE: FEBRUARY 13, 2009

DRAWN BY: AMB, MAF
CHECKED BY: TGB, MI

TYLIN INTERNATIONAL

PA02-37-3 road-639 pp25f 6/05 3a.dgn 11:46:01 AM 3/19/2009