

F.A.I. RTE.	SECTION	COUNTY	TOTAL SHEETS	SHEET NO.
55	99 (1&2) I-11	WILL	176	33
STA.	TO STA.			
FED. ROAD DIST. NO.	ILLINOIS	FED. AID PROJECT		

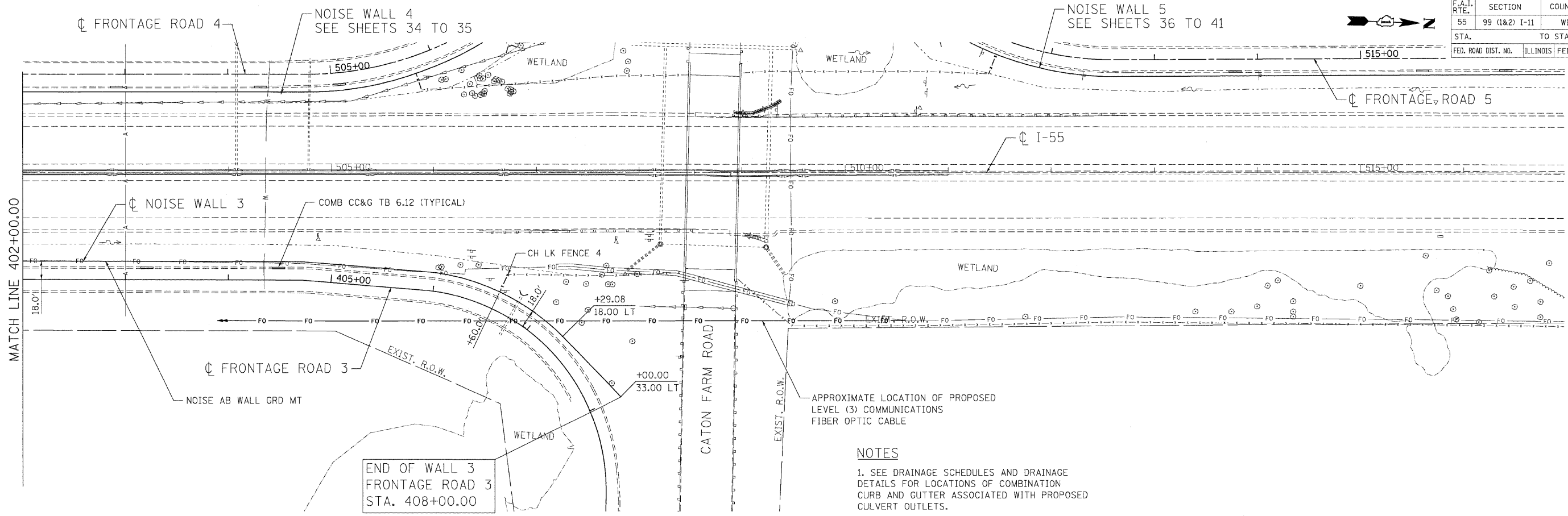

- NOTES**
- SEE DRAINAGE SCHEDULES AND DRAINAGE DETAILS FOR LOCATIONS OF COMBINATION CURB AND GUTTER ASSOCIATED WITH PROPOSED CULVERT OUTLETS.

END OF WALL 3
FRONTAGE ROAD 3
STA. 408+00.00

PLAN	DATE
BY	
REVIEWED	
DATE	
NO. OF PAGES	
NO. OF PAGES CHECKED	
NO. OF PAGES NOT CHECKED	
NO. OF PAGES PAID	

PROFILE	DATE
BY	
REVIEWED	
DATE	
NO. OF PAGES	
NO. OF PAGES CHECKED	
NO. OF PAGES NOT CHECKED	
NO. OF PAGES PAID	

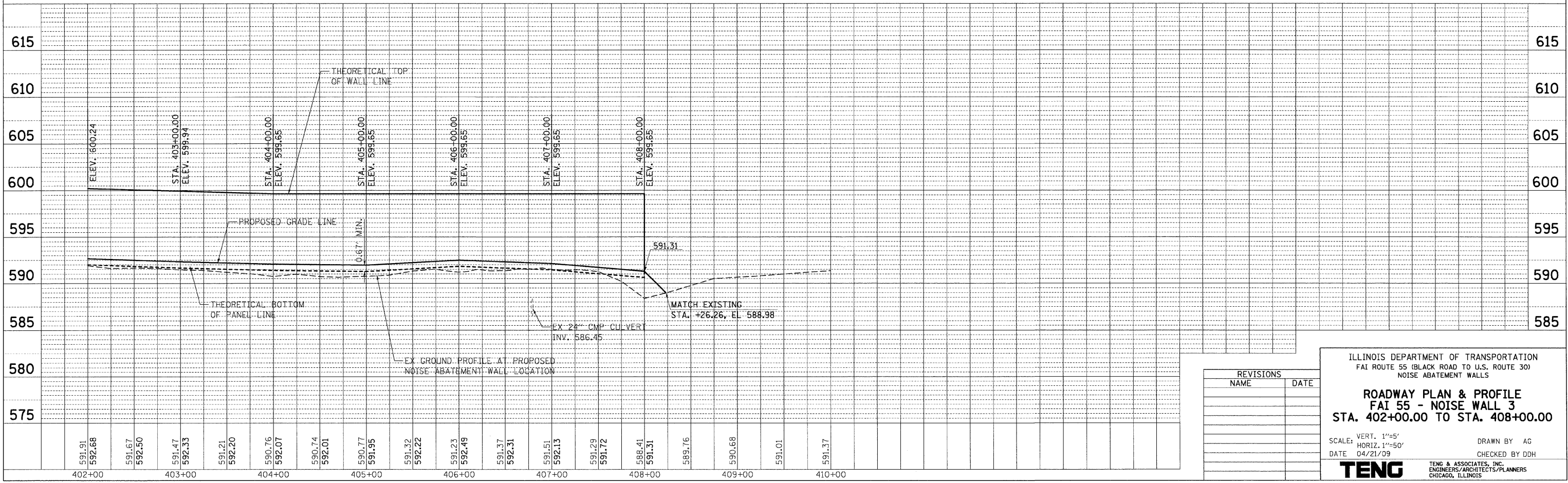

REVISIONS	
NAME	DATE

ILLINOIS DEPARTMENT OF TRANSPORTATION
FAI ROUTE 55 (BLACK ROAD TO U.S. ROUTE 30)
NOISE ABATEMENT WALLS

ROADWAY PLAN & PROFILE
FAI 55 - NOISE WALL 3
STA. 402+00.00 TO STA. 408+00.00

SCALE: VERT. 1"=5'
HORIZ. 1"=50'
DATE 04/21/09

DRAWN BY AG
CHECKED BY DDH

TENG TENG & ASSOCIATES, INC.
ENGINEERS/ARCHITECTS/PLANNERS
CHICAGO, ILLINOIS

PLOT DATE = #DATE#
FILE NAME = #FILE#
PLOT SCALE = #SCALE#
USER NAME = #USER#

4-21-2009 11:21:14
HAMREND
S:\DOCUMENT\222859\PROJECT\UDN\VP12121011.SHT