



Geotechnical, Environmental & Civil Engineering
 805 Amherst Court, Suite 204
 Naperville, Illinois 60565
 (630) 365-2878

| F.A. RTE. | SECTION | COUNTY | TOTAL SHEETS | SHEET NO. |
|--------------------------|---------------|---|--------------|-----------|
| 55 | 99 (1&2) I-11 | WILL | 176 | 51 |
| STA. _____ TO STA. _____ | | FED. ROAD DIST. NO. _____ ILLINOIS FED. AID PROJECT _____ | | |

| | | |
|-----------|------------|-------|
| PLAN | REVIEWED | DATE |
| NO. _____ | BY _____ | _____ |
| NO. _____ | DATE _____ | _____ |

| | | |
|-----------|------------|-------|
| PROFILE | REVIEWED | DATE |
| NO. _____ | BY _____ | _____ |
| NO. _____ | DATE _____ | _____ |

PLOT DATE = 02/06/09
 FILE NAME = 020609_174802
 PLOT SCALE = 1"=50'
 USER NAME = ddh

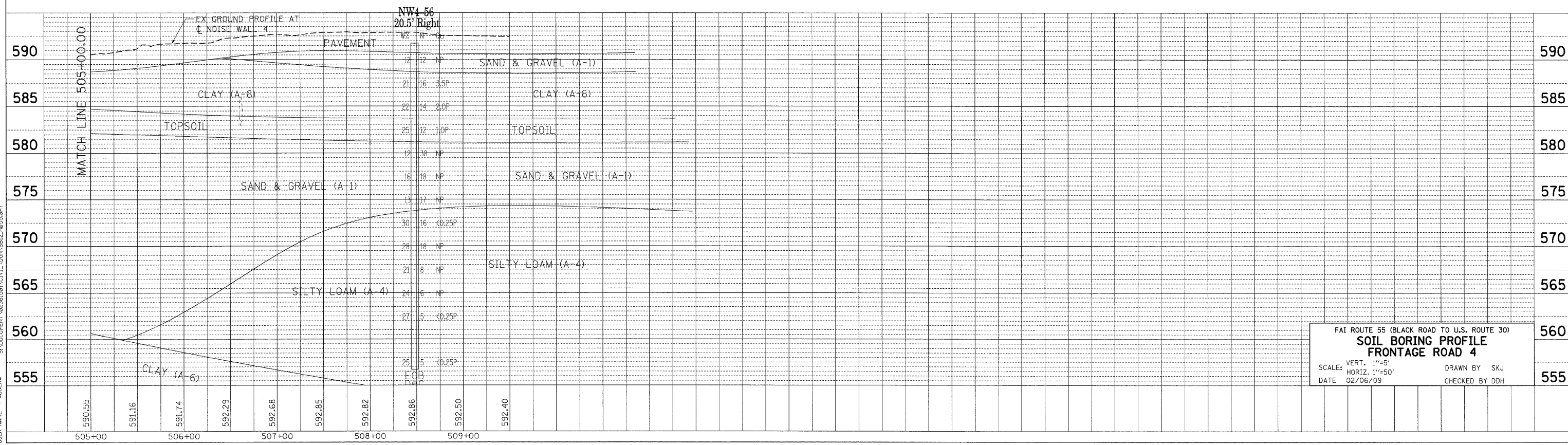
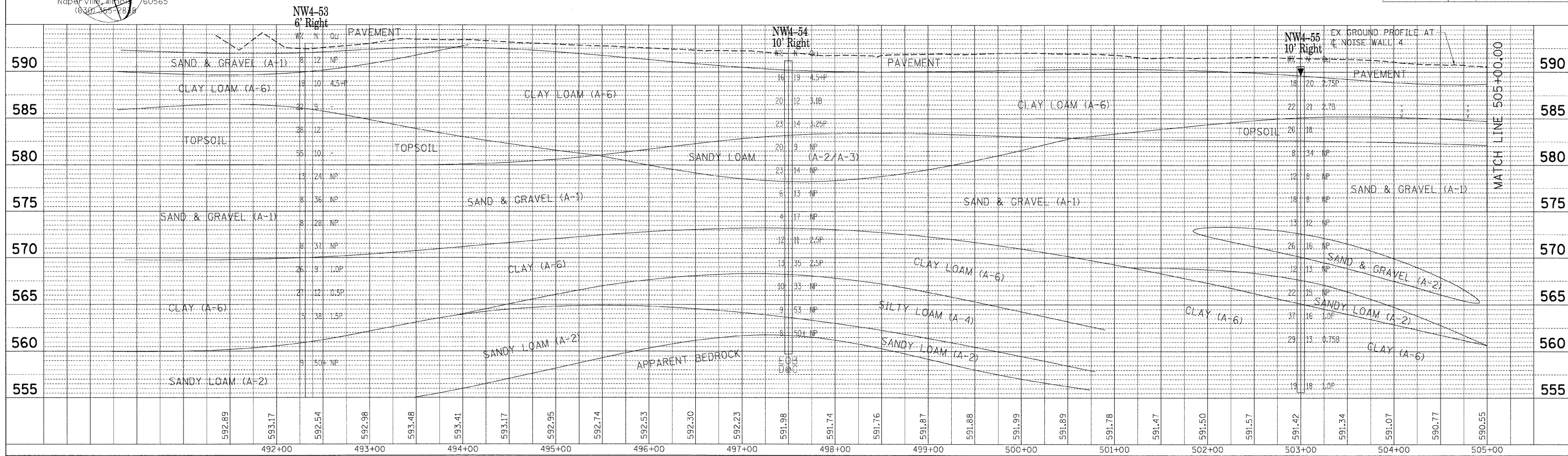

FAI ROUTE 55 (BLACK ROAD TO U.S. ROUTE 30)
SOIL BORING PROFILE FRONTAGE ROAD 4
 SCALE: VERT. 1"=5'
 HORIZ. 1"=50'
 DATE 02/06/09
 DRAWN BY SKJ
 CHECKED BY DDH