

F.A.I. RTE.	SECTION	COUNTY	TOTAL SHEETS	SHEET NO.
55	99 (1&2) I-12	WILL	147	18
STA.	637+00	TO STA.	667+00	
FED. ROAD DIST. NO.	ILLINOIS FED. AID PROJECT		ALIGN-03 OF 10	

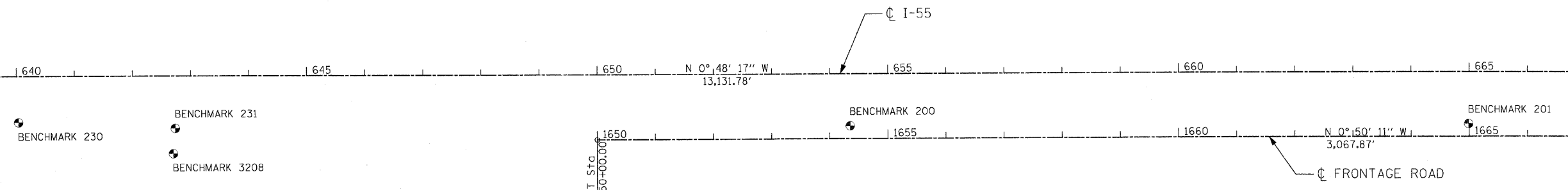

MATCHLINE STA. 637+00
SEE ALIGN-02

MATCHLINE STA. 667+00
SEE ALIGN-04



BENCHMARK DESCRIPTIONS

BENCHMARK 200	SET REBAR +/- 2' NW OF EXISTING FENCE LINE
BENCHMARK 201	SET REBAR +/- 2' NW OF EXISTING FENCE LINE
BENCHMARK 230	SET REBAR +/- 10' NW OF EXISTING FENCE LINE
BENCHMARK 231	FOUND CHISELED SQUARE IN EXISTING FES. ON SOUTH END OF FES. IN I-55 R.O.W..
BENCHMARK 3208	SQUARE CUT ON S END OF A HEADWALL OF A 30" CMP UNDER E FRONTAGE RD AND ABOUT 1/4 MILE N OF RENWICK RD., ELEV. 607.15'.

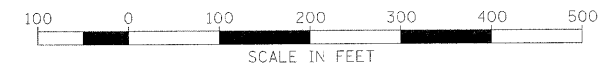

REVISIONS	
NAME	DATE

ILLINOIS DEPARTMENT OF TRANSPORTATION
 FAI ROUTE 55
 US 30 (PLAINFIELD ROAD) TO WEBER ROAD

ALIGNMENTS, TIES AND
 BENCHMARKS

SCALE: 1"=100'
 DATE: 2-06-09

DRAWN BY: MMS
 CHECKED BY: DM

FINAL