

F.A.I. RTE.	SECTION	COUNTY	TOTAL SHEETS	SHEET NO.
55	99 (1&2) I-12	WILL	147	21
STA. 727+00		TO STA. 757+00		
FED. ROAD DIST. NO. 1		ILLINOIS FED. AID PROJECT		
ALIGN-06 OF 10				

MATCHLINE STA. 727+00
SEE ALIGN-05

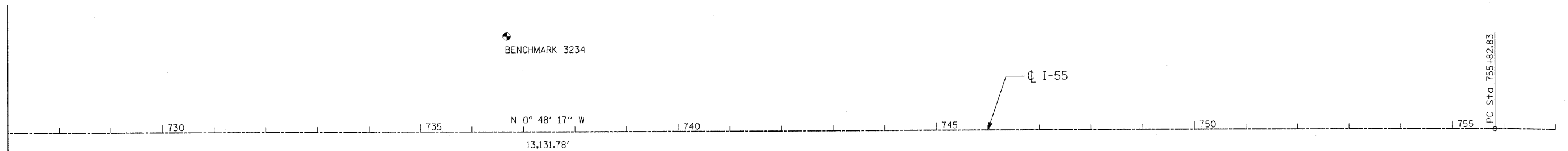

BENCHMARK DESCRIPTIONS

- BENCHMARK 207 SET REBAR +/- 2' NW OF EXISTING FENCE LINE
- BENCHMARK 208 SET REBAR +/- 2' NW OF EXISTING FENCE LINE
- BENCHMARK 3228 SQUARE CUT ON TOP OF 36" CONC FLARE END SECTION ABOUT ON E ROW OF E FRONTAGE RD., ELEV. 618.29'.
- BENCHMARK 3234 "X" CUT ON TOP OF NE BOLT OF A 4'X4' SIGN BASE OF A LARGE SIGN AT THE SW CORNER OF THE W FRONTAGE RD. OF I-55 AND 143RD ST. N 1805400.67 E 1030496.13, ELEV. 624.51'.

PROP. CURVE FRD2-2
 PI STA. = 1737+00.72
 $\Delta = 70^\circ 06' 31''$ (RT)
 $D = 63^\circ 39' 43''$
 $R = 90.00'$
 $T = 63.15'$
 $L = 110.13'$
 $E = 19.94'$
 $e =$ -----
 $T.R. =$ -----
 $S.E. RUN =$ -----
 $P.C. STA = 1736+37.57$
 $P.T. STA = 1737+47.70$



REVISIONS	
NAME	DATE

ILLINOIS DEPARTMENT OF TRANSPORTATION
 FAI ROUTE 55
 US 30 (PLAINFIELD ROAD) TO WEBER ROAD

ALIGNMENT, TIES AND
 BENCHMARKS

SCALE: 1"=100'
 DATE: 2-06-09

DRAWN BY: MMS
 CHECKED BY: DM

FINAL