

F.A.I. RTE.	SECTION	COUNTY	TOTAL SHEETS	SHEET NO.
55	99 (1&2) 1-12	WILL	147	31
STA. 689+00.00		TO STA. 697+00.00		
FED. ROAD DIST. NO.		ILLINOIS	FED. AID PROJECT	
PNP 6 OF 12				

PLAN VIEW FOR NOISE WALL 9B
FROM STA. 689+00 TO STA. 697+00
SEE PNP SHEET 5 OF 12

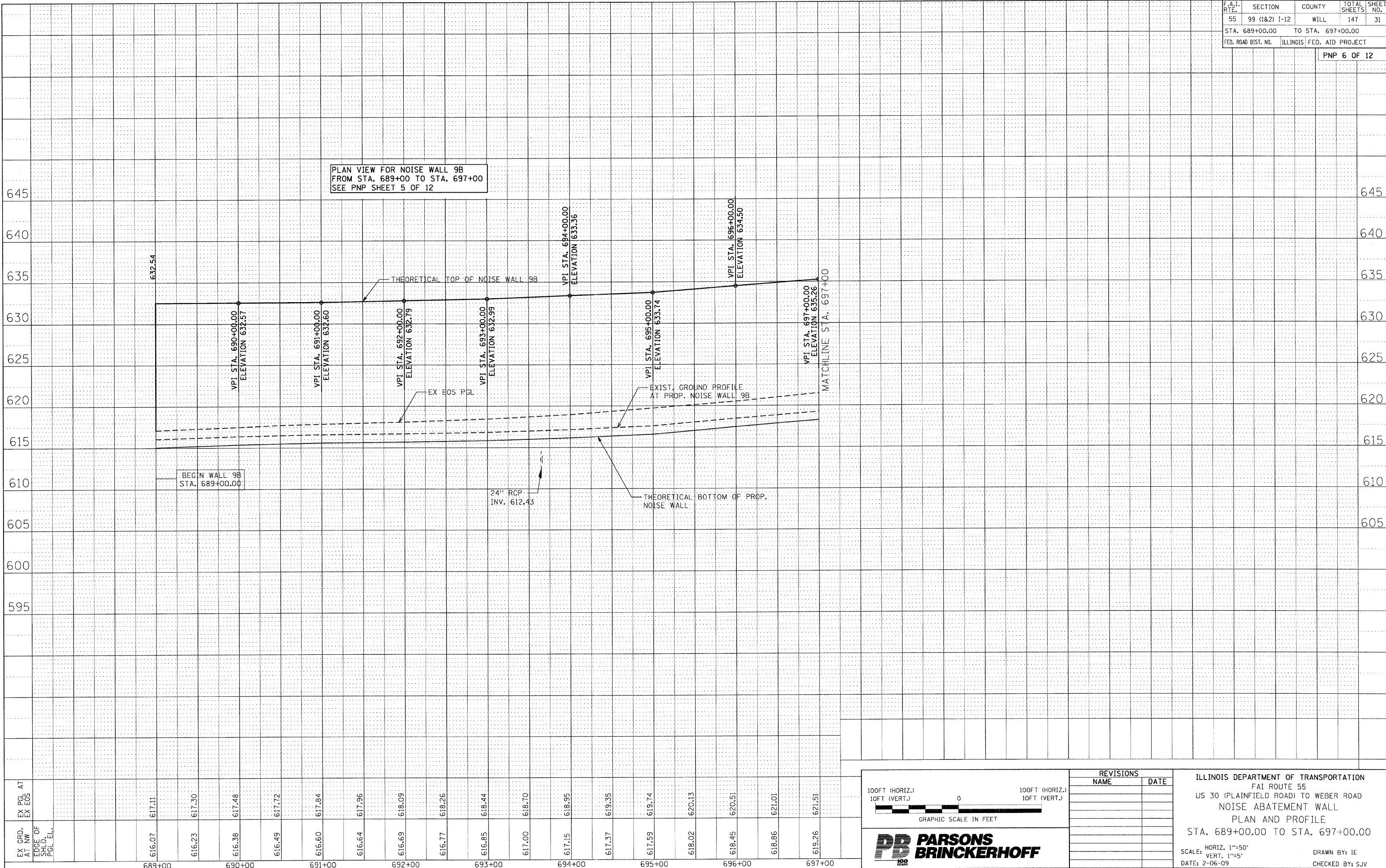

EX GRD. AT NW EX EOS	616.07	617.11	616.23	617.30	616.38	617.48	616.49	617.72	616.60	617.84	616.64	617.96	616.69	618.09	616.77	618.26	616.85	618.44	617.00	618.70	617.15	618.95	617.37	619.35	617.59	619.74	618.02	620.13	618.45	620.51	618.86	621.01	619.26	621.51
EDGE OF SHLD. PGL EL.	689+00		690+00		691+00		692+00		693+00		694+00		695+00		696+00		697+00																	

100FT (HORIZ.)
10FT (VERT.)

0

100FT (HORIZ.)
10FT (VERT.)

GRAPHIC SCALE IN FEET

REVISIONS	
NAME	DATE

ILLINOIS DEPARTMENT OF TRANSPORTATION
FAI ROUTE 55
US 30 (PLAINFIELD ROAD) TO WEBER ROAD
NOISE ABATEMENT WALL
PLAN AND PROFILE
STA. 689+00.00 TO STA. 697+00.00

SCALE: HORIZ. 1"=50'
DATE: 2-06-09

DRAWN BY: IE
CHECKED BY: SJV