

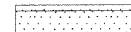

F.A.I. RTE.	SECTION	COUNTY	TOTAL SHEETS	SHEET NO.
55	99 (1&2) I-12	WILL	147	68
STA. 610+25.64 TO STA. 637+00.00				
FED. ROAD DIST. NO.		ILLINOIS	FED. AID PROJECT	

NOTES

- FOR PROPOSED TREE LOCATIONS CONTACT STEVE LIPKIE OF IDOT'S ROADSIDE DEVELOPMENT UNIT (847-705-4173).
- PRUNING FOR SAFETY AND EQUIPMENT CLEARANCE SHALL TAKE PLACE PRIOR TO NOISE WALL INSTALLATION.

LEGEND

-  SEEDING CLASS 4
-  SEEDING CLASS 2A

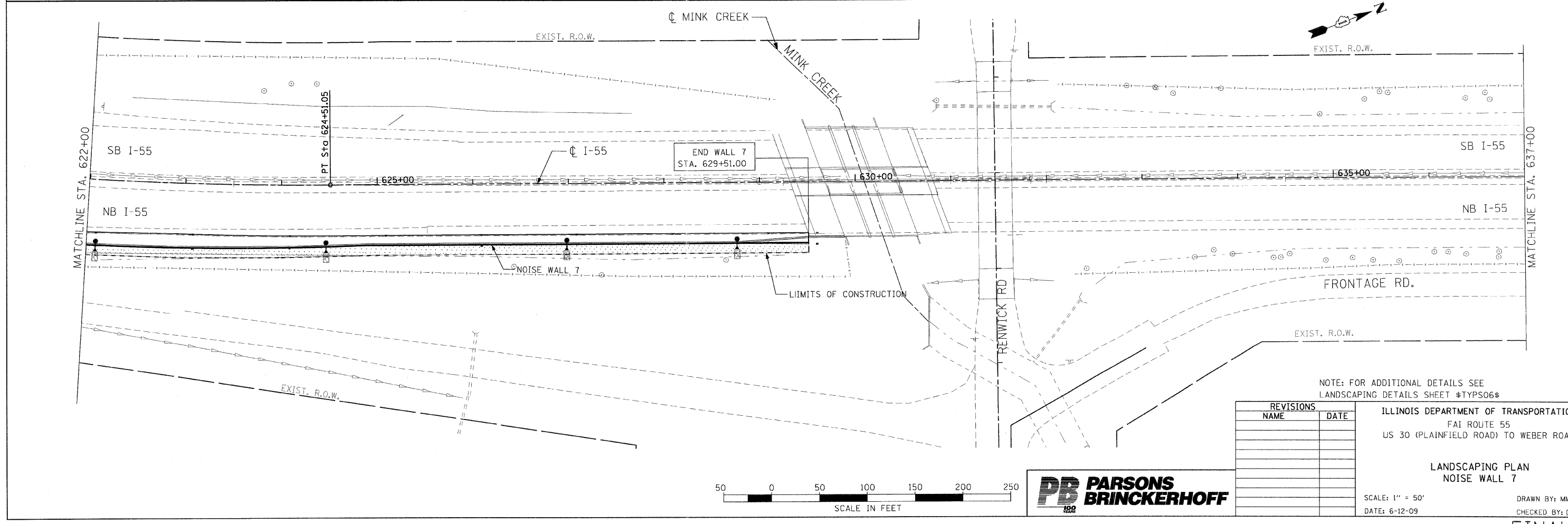
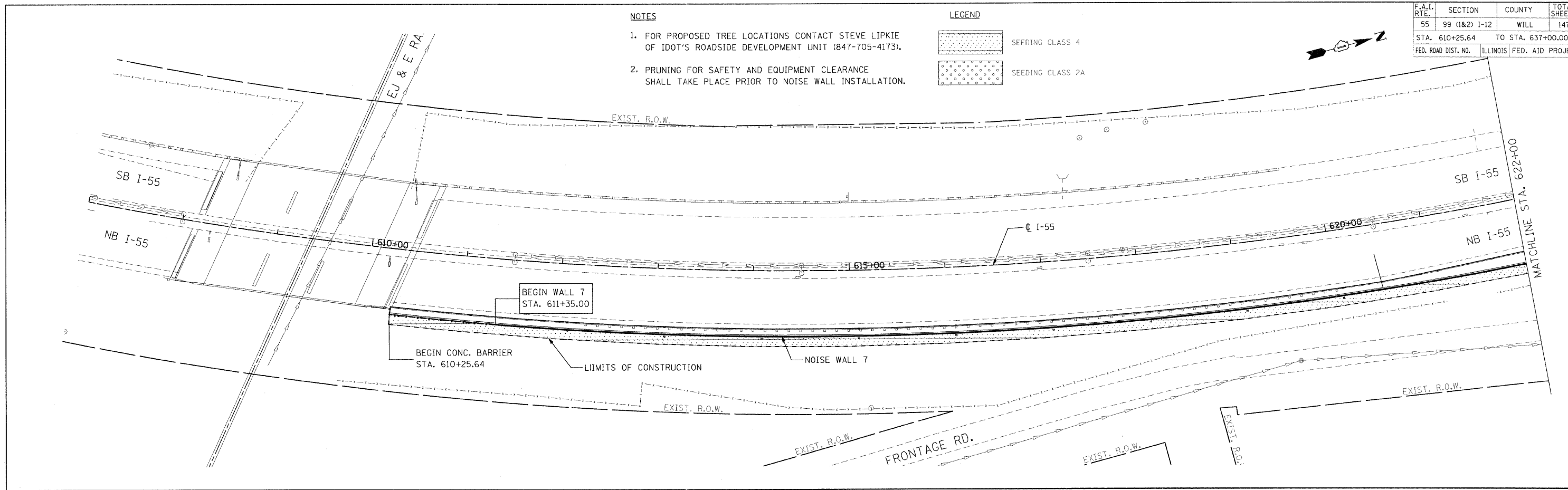

NOTE: FOR ADDITIONAL DETAILS SEE LANDSCAPING DETAILS SHEET \$TYP506\$

REVISIONS	
NAME	DATE

ILLINOIS DEPARTMENT OF TRANSPORTATION
FAI ROUTE 55
US 30 (PLAINFIELD ROAD) TO WEBER ROAD

LANDSCAPING PLAN
NOISE WALL 7

SCALE: 1" = 50'
DATE: 6-12-09

DRAWN BY: MMS
CHECKED BY: DM

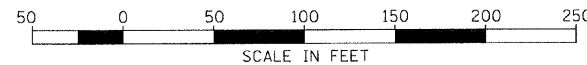

FINAL