

F.A.I. RTE.	SECTION	COUNTY	TOTAL SHEETS	SHEET NO.
55	99 (1&2) I-12	WILL	147	73
STA. 757+00	TO STA. 787+00			
FED. ROAD DIST. NO.	ILLINOIS	FED. AID PROJECT		

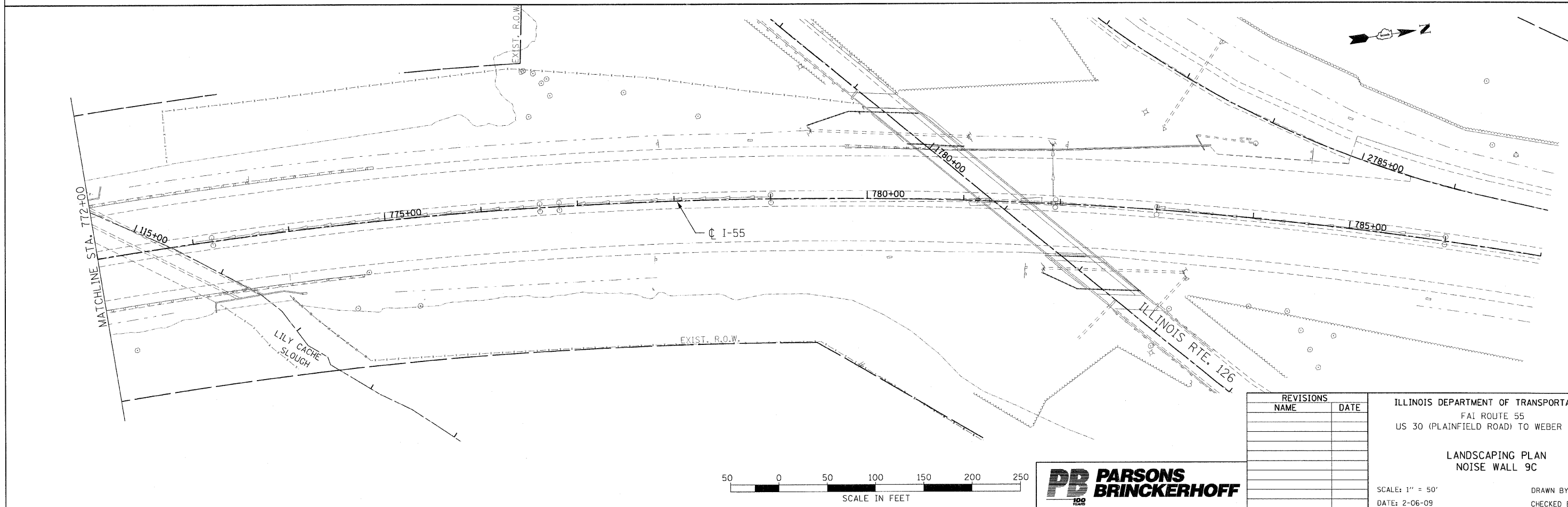
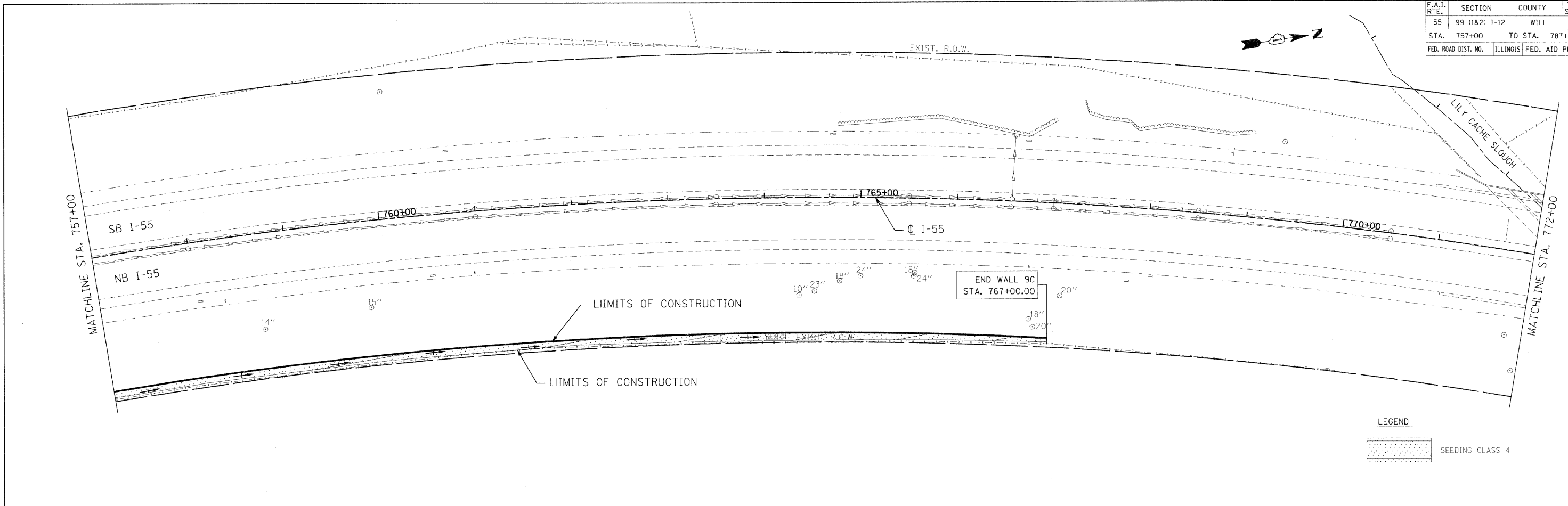

REVISIONS	
NAME	DATE

ILLINOIS DEPARTMENT OF TRANSPORTATION
 FAI ROUTE 55
 US 30 (PLAINFIELD ROAD) TO WEBER ROAD

LANDSCAPING PLAN
 NOISE WALL 9C

SCALE: 1" = 50'
 DATE: 2-06-09

DRAWN BY: MMS
 CHECKED BY: DM