

PROJECT NO.	SECTION	COUNTY	TOTAL SHEETS	SHEET NO.
352 (Emb.) R-4	LAKE	41	24	
STA.	TO STA.			
FED. ROAD DIST. NO. 7	ILLINOIS	FED. AID PROJECT		

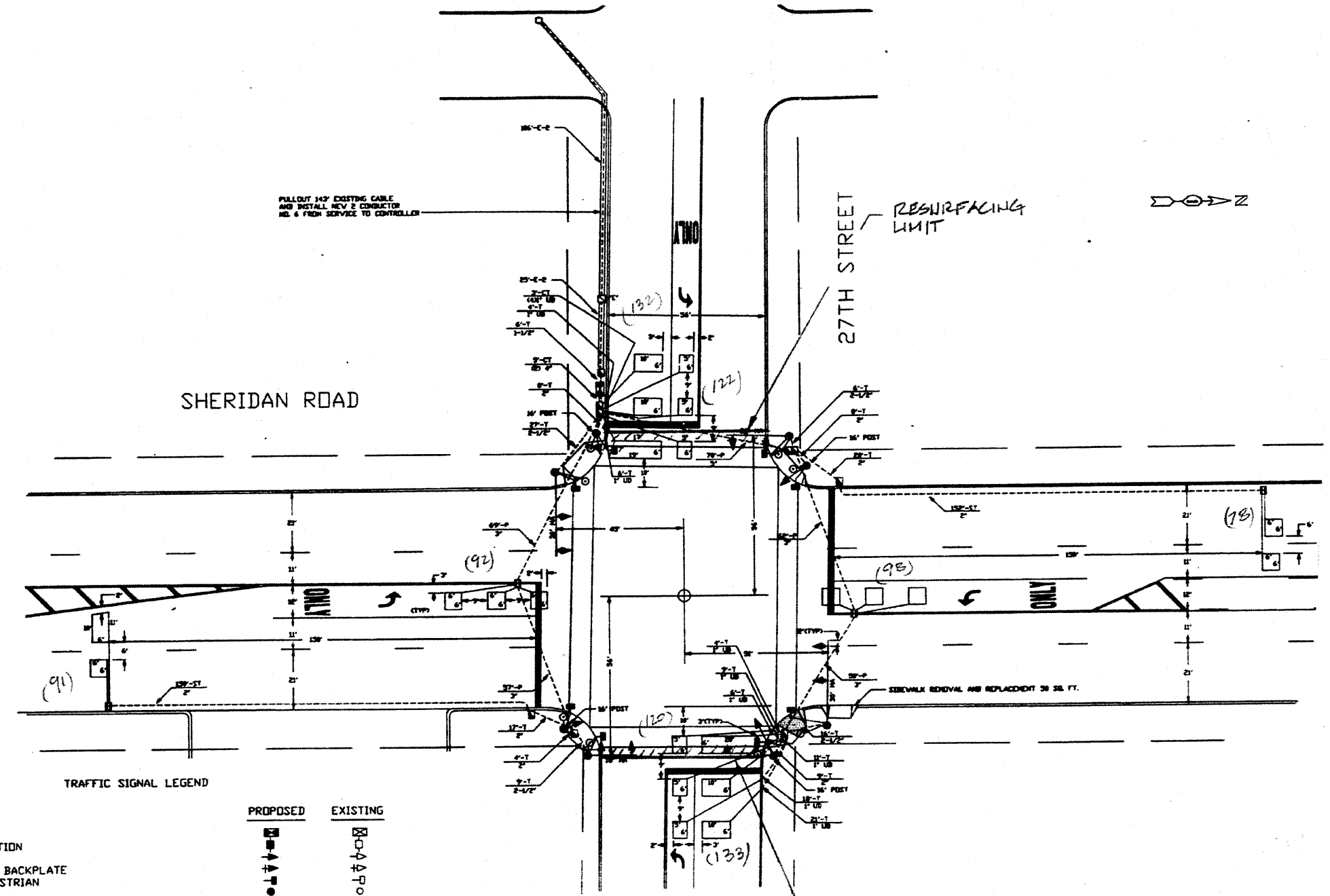

- TRAFFIC SIGNAL LEGEND**
- CONTROLLER
 - SERVICE INSTALLATION
 - SIGNAL HEAD
 - SIGNAL HEAD WITH BACKPLATE
 - SIGNAL HEAD, PEDESTRIAN
 - SIGNAL POST
 - MAST ARM ASSEMBLY AND POLE, STEEL
 - HANDHOLE
 - HEAVY DUTY HANDHOLE
 - DOUBLE HANDHOLE
 - G.S. CONDUIT IN TRENCH OR PUSHED
 - PEDESTRIAN PUSHBUTTON DETECTOR
 - DETECTOR LOOP
 - CONCRETE JUNCTION BOX
 - CAST IRON JUNCTION BOX
 - COMMON TRENCH
 - SPECIAL TRENCH
 - MAST ARM ASSEMBLY AND POLE, ALUMINUM
 - EMERGENCY VEHICLE SYSTEM DETECTOR
 - SIGNAL HEAD OPTICALLY PROGRAMMED
 - CONDUIT SPLICE
 - WOOD POLE
 - RACEWAY FOR MAGNETIC DETECTOR, TYPE I OR TYPE II
 - VEHICLE DETECTOR, NON COMPENSATED MAGNETIC TYPE
 - RAILROAD CONTROL CABINET
 - SIDEWALK RAMPS

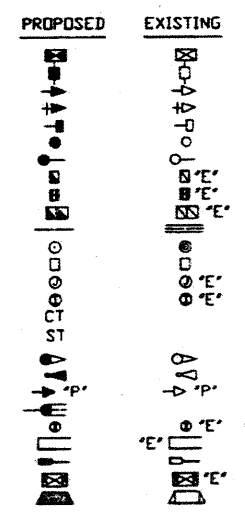

REPLACE ALL DETECTOR LOOPS AS SHOWN

(WITHIN THE RESURFACING LIMITS)

CODE NO.	QUANTITY	UNIT	ITEM
86500600	866	Foot	Detector Loop Replacement

NOTE:
THIS PLAN IS FOR THE PURPOSE OF REPLACING THE DETECTOR LOOPS ONLY. ALL OTHER INFORMATION SHOWN IS NOT RELATED AND WILL BE DISREGARDED.

ILLINOIS DEPARTMENT OF TRANSPORTATION
DETECTOR LOOP REPLACEMENT
SHERIDAN ROAD @ 27TH STREET

SCALE NONE
DATE JAN. 2007

DRAWN BY JHE
DESIGNED BY JHE
CHECKED BY DAD.

REVISIONS	
NAME	DATE