

F.A.I. RTE.	SECTION	COUNTY	TOTAL SHEETS	SHEET NO.
94	1516.1 I-7	COOK	58	25
STA. 2212+06.20		TO STA. 2243+03.23		
FED. ROAD DIST. NO.	ILLINOIS	FED. AID PROJECT		

62971



**LEGEND:**

- EROSION CONTROL BLANKET, SEEDING, CLASS 2A, NITROGEN, PHOSPHORUS, AND POTASSIUM FERTILIZER NUTRIENTS, TOPSOIL FURNISH AND PLACE, 4"
- EROSION CONTROL BLANKET, SEEDING, CLASS 2A, NITROGEN, PHOSPHORUS, AND POTASSIUM FERTILIZER NUTRIENTS, TOPSOIL FURNISH AND PLACE, 12"
- EROSION CONTROL BLANKET, SEEDING, CLASS 2A, NITROGEN, PHOSPHORUS, AND POTASSIUM FERTILIZER NUTRIENTS, TOPSOIL FURNISH AND PLACE, 6"
- INLET FILTER, TO BE INSTALLED IN OFF PROJECT DRAINAGE STRUCTURES ACCEPTING STORMWATER RUNOFF

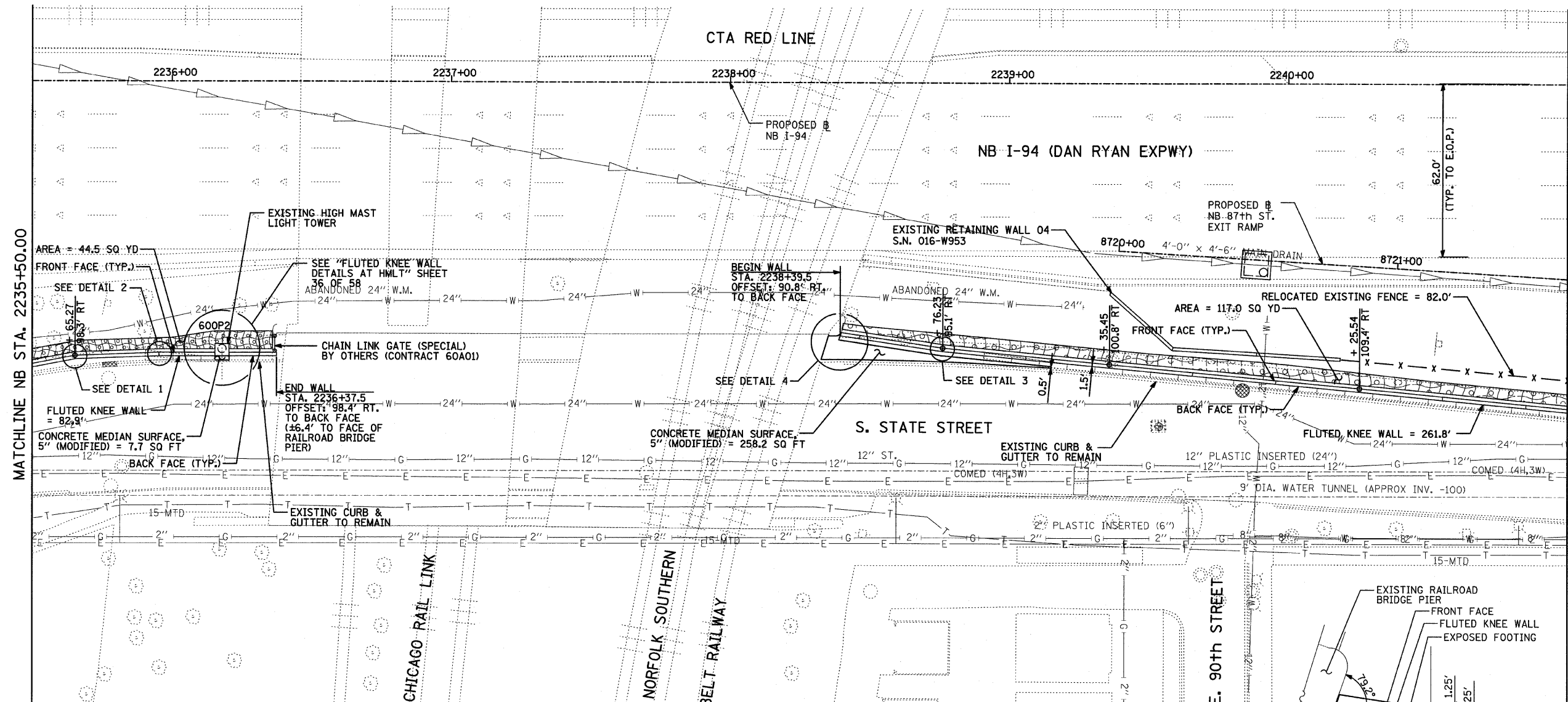

MATCHLINE NB STA. 2235+50.00

MATCHLINE NB STA. 2241+00.00

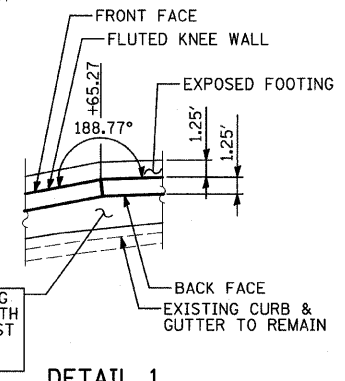

**DETAIL 1**

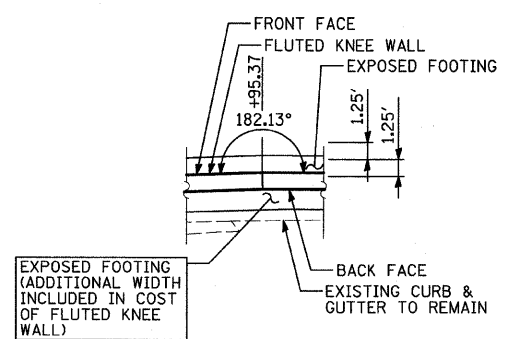

**DETAIL 2**

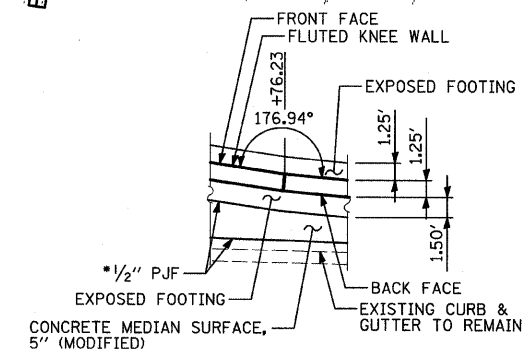

**DETAIL 3**

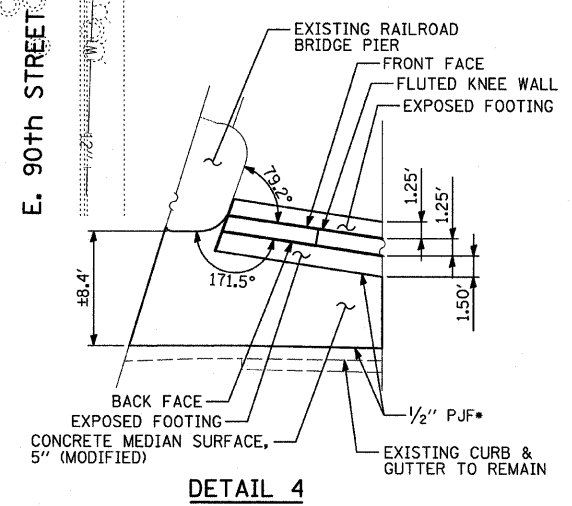

**DETAIL 4**

EXPOSED FOOTING (ADDITIONAL WIDTH INCLUDED IN COST OF FLUTED KNEE WALL)

EXPOSED FOOTING (ADDITIONAL WIDTH INCLUDED IN COST OF FLUTED KNEE WALL)

1/2" P.J.F.  
EXPOSED FOOTING  
CONCRETE MEDIAN SURFACE, 5" (MODIFIED)

EXPOSED FOOTING  
CONCRETE MEDIAN SURFACE, 5" (MODIFIED)

**TYLIN INTERNATIONAL**

COST INCLUDED WITH "CONCRETE MEDIAN SURFACE, 5" (MODIFIED)"

**NOTES:**

1. STATION AND OFFSET CALLOUTS ALONG THE LENGTH OF EITHER FLUTED KNEE WALL OR FLUTED KNEE WALL, SPECIAL ARE TAKEN FROM THE FRONT FACE SIDE AT PROPOSED EXPANSION JOINT LOCATIONS.
2. THE CONTRACTOR SHALL PROTECT AND USE CAUTION DURING CONSTRUCTION OPERATIONS AROUND ALL EXISTING PUBLIC OR PRIVATE UTILITY FACILITIES.

REVISIONS	
NAME	DATE

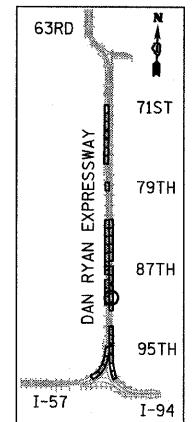
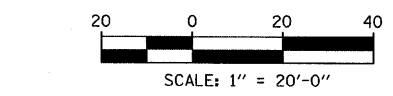

**LOCATION MAP**

ILLINOIS DEPARTMENT OF TRANSPORTATION  
**F.A.I. 94 (DAN RYAN EXPRESSWAY)**  
**PROPOSED PLAN**  
**NB I-94 (DAN RYAN EXPRESSWAY)**  
**STA. 2235+50.00 TO 2241+00.00**  
 SCALE: 1"=20' DRAWN BY: AMB, MAF  
 DATE: OCTOBER 17, 2008 CHECKED BY: TGB, MT