

PROFILE	SURVEYED	BY	DATE
NOTE BOOK	GRADES CHECKED		
NO.	P.M. NO. (IF ANY)		
	NO. OF STAKES		
	NOTATION		

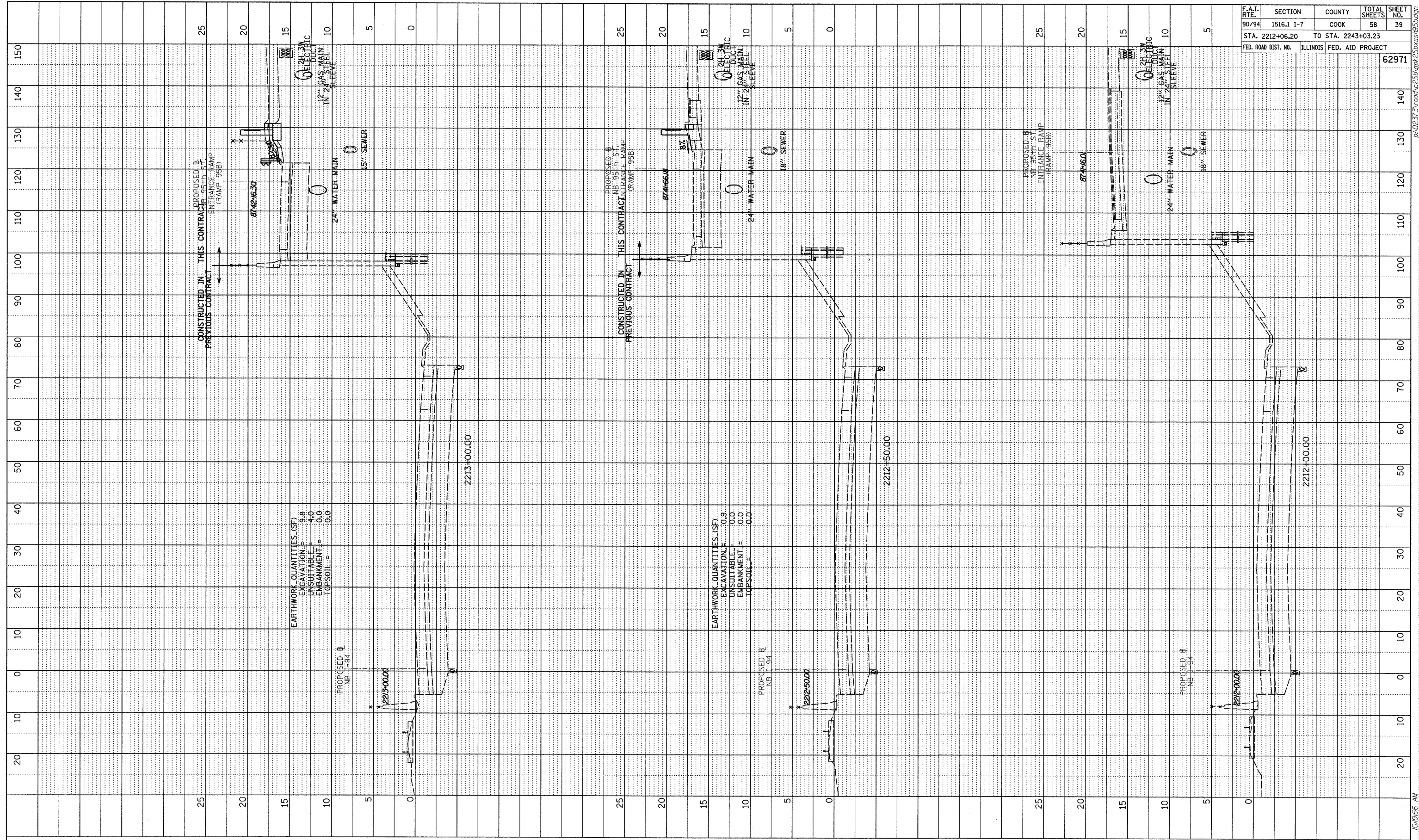

F.A.I. RTE.	SECTION	COUNTY	TOTAL SHEETS	SHEET NO.
90/94	1516.1 I-7	COOK	58	39
STA. 2212+06.20	TO STA. 2243+03.23			
FED. ROAD DIST. NO.	ILLINOIS	FED. AID PROJECT		
				62971

TYLIN INTERNATIONAL

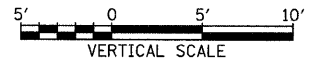

NB I-94 (DAN RYAN EXPRESSWAY)
STA. 2212+00 TO STA. 2213+00

10/17/2008 10:55:56 AM p:\02273\road\225\p4\25\ssst95b.dgn