

PROFILE SURVEYED BY DATE  
 GRADES CHECKED  
 NOTE BOOK NO. DATE  
 E.M. NOTED  
 STRUCTURE INDICATING CPWD  
 NO.

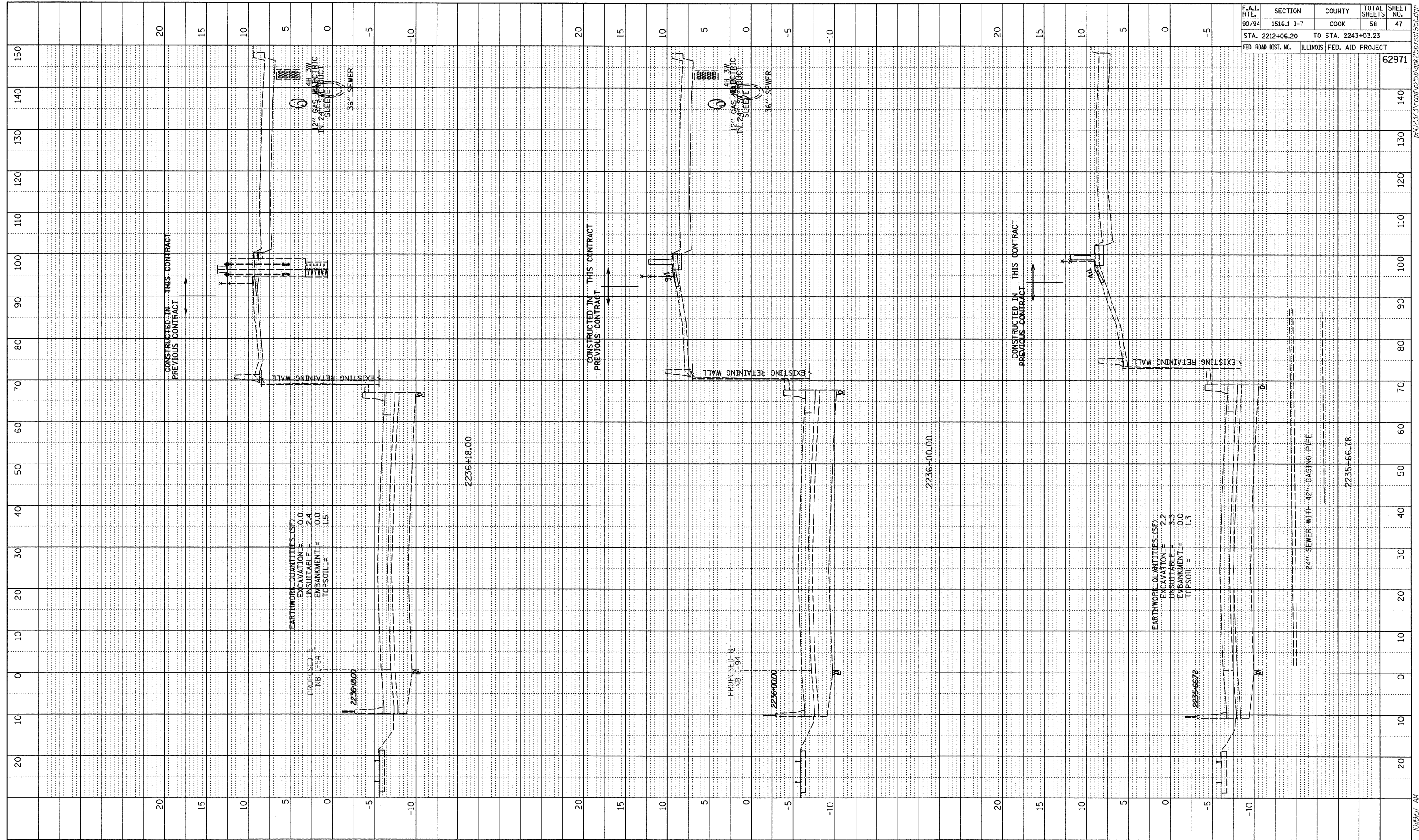

F.A.I. RTE.	SECTION	COUNTY	TOTAL SHEETS	SHEET NO.
90/94	1516.1 I-7	COOK	58	47
STA. 2212+06.20		TO STA. 2243+03.23		
FED. ROAD DIST. NO.	ILLINOIS	FED. AID PROJECT		62971

TYLIN INTERNATIONAL

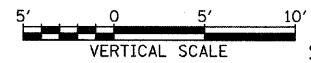
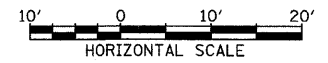

NB I-94 (DAN RYAN EXPRESSWAY)  
 STA. 2235+66.78 TO STA. 2236+18

10/17/2008 10:49:57 AM P:\023731\road\225d\pk250\ss195.dgn