

PROFILE	SURVEYED	BY	DATE
NOTE BOOK	GRADES CHECKED		
NO.	PLANS NOTED		
	DISCREPANCY NOTATIONS		

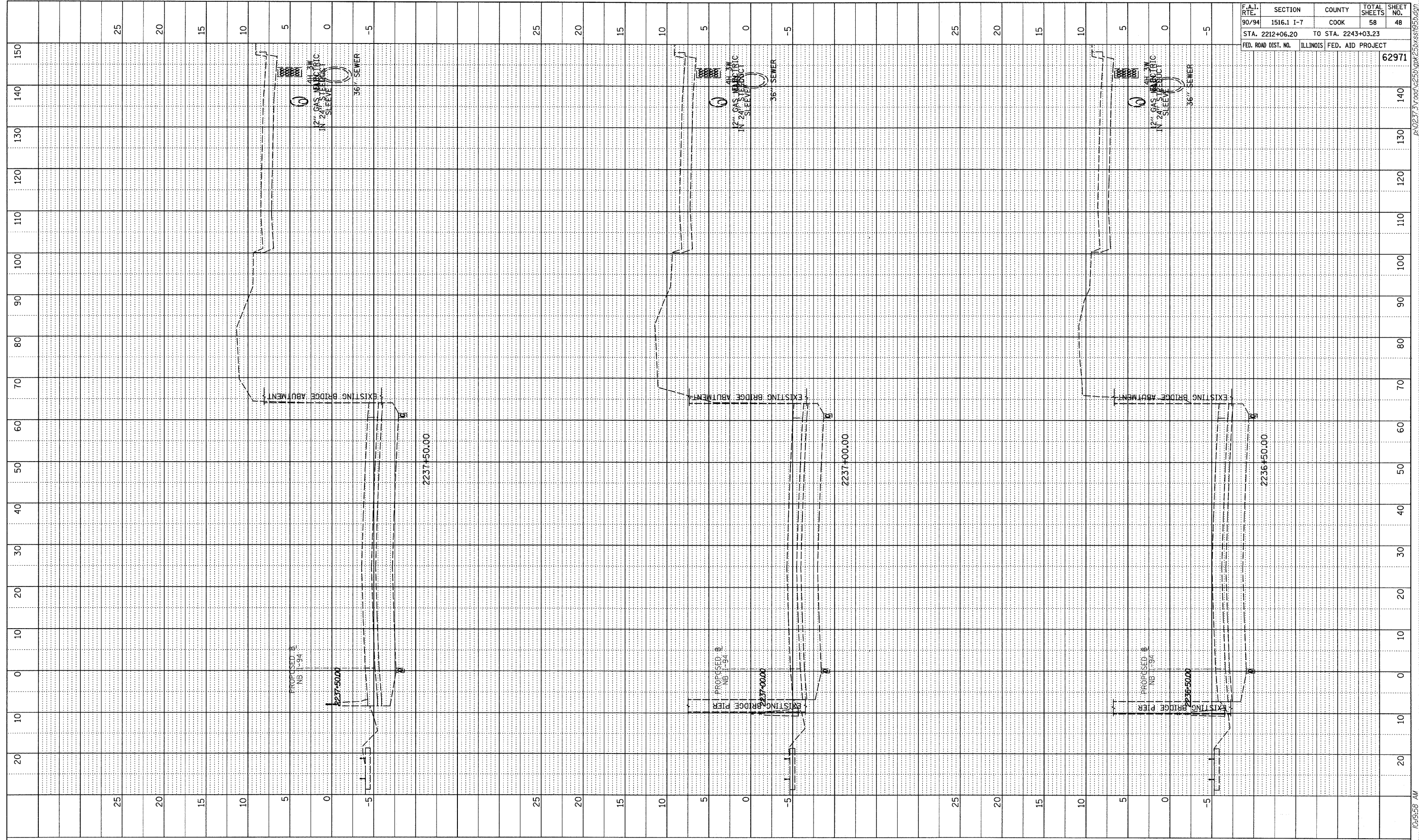

F.A.I. RTE.	SECTION	COUNTY	TOTAL SHEETS	SHEET NO.
90/94	1516.1 I-7	COOK	58	48
STA. 2212+06.20		TO STA. 2243+03.23		
FED. ROAD DIST. NO.	ILLINOIS	FED. AID PROJECT	62971	

TYLIN INTERNATIONAL

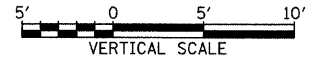

NB I-94 (DAN RYAN EXPRESSWAY)
STA. 2235+50 TO STA. 2237+50

10/17/2008 10:55 AM P:\0237\3\road\2235+50\gk\2235+50.dgn