

PROFILE SURVEYED BY DATE
 PLANS CHECKED BY DATE
 NOTE BOOK NO. DATE
 STRUCTURE NOTATIONS CRD

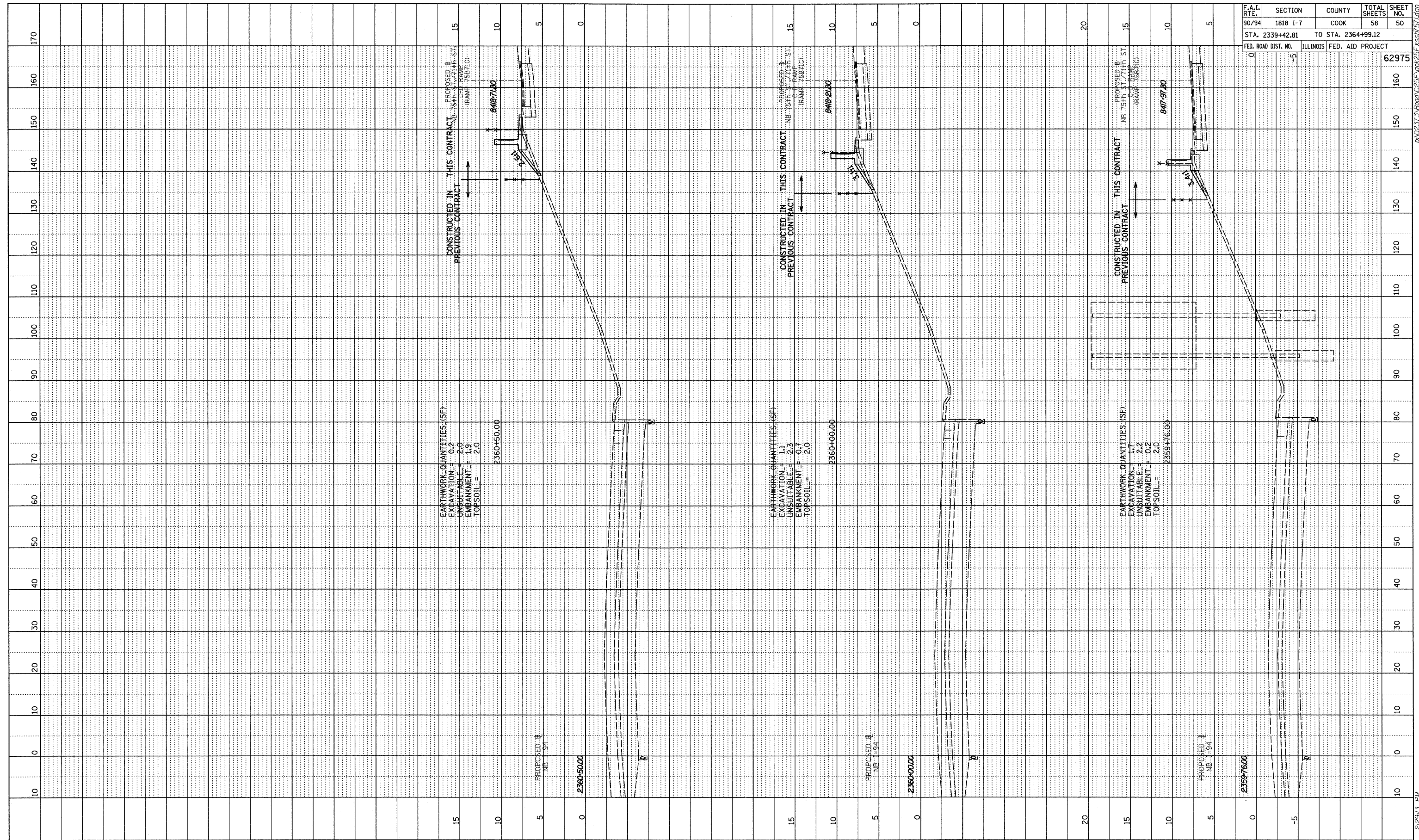

F.A.I. RTE.	SECTION	COUNTY	TOTAL SHEETS	SHEET NO.
90/94	1818 I-7	COOK	58	50
STA. 2339+42.81		TO STA. 2364+99.12		
FED. ROAD DIST. NO.		ILLINOIS FED. AID PROJECT		
				62975

TYLIN INTERNATIONAL

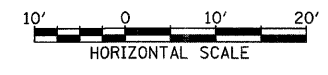

NB I-94 (DAN RYAN EXPRESSWAY)
 STA. 2359+76 TO STA. 2360+50

3/19/2009 2:29:43 PM