

PROFILE	SURVEYED	BY	DATE
	PLOTTED		
	CHECKED		
	BY		
	NO.		
	STRUCTURE		
	NOTATIONS		
	CHRD		

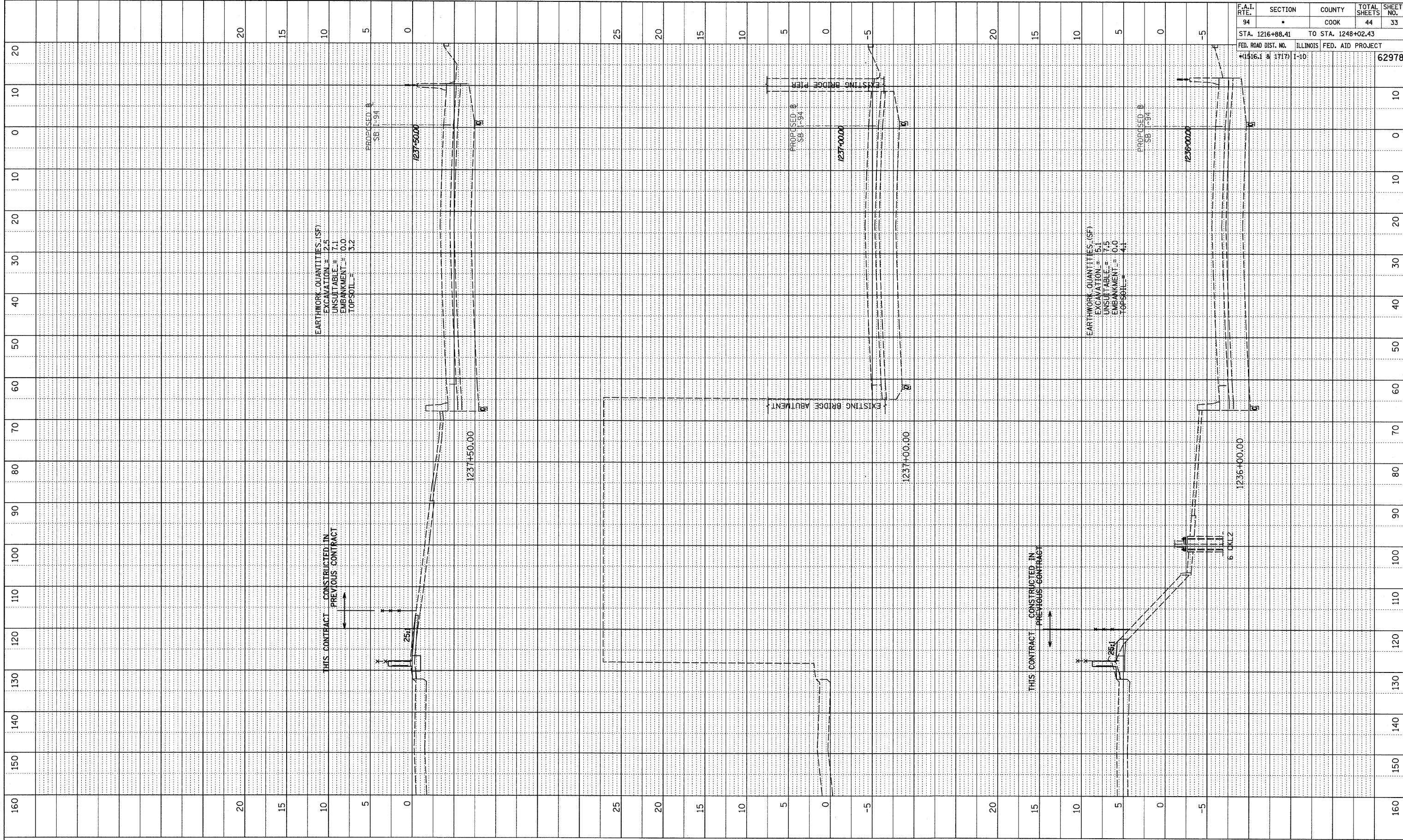

F.A.I. RTE.	SECTION	COUNTY	TOTAL SHEETS	SHEET NO.
94		COOK	44	33
STA. 1216+88.41		TO STA. 1248+02.43		
FED. ROAD DIST. NO.		ILLINOIS FED. AID PROJECT		
+1516.1 & 1717		I-10		62978

TYLIN INTERNATIONAL

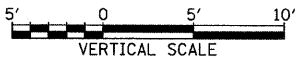

SB I-94 (DAN RYAN EXPRESSWAY)
STA. 1235+50 TO STA. 1237+00

1/15/2009 12:02:34 PM